

SAW Filter 810.0MHz

Model: TA0438A

Part No: MA07350

REV. NO.: 2

A. MAXIMUM RATING:

1. Operating Temperature: 0°C ~ 70°C
2. Storage Temperature: -40°C ~ +85°C

B. CHARACTERISTICS :

Balanced to Balanced operation

Terminating source impedance : $Z_s = 200\Omega$

Terminating load impedance : $Z_L = 200\Omega$

Characteristics	Value			Unit
	Min.	Typ.	Max.	
Center frequency F_c	-	810	-	MHz
Minimum Insertion loss 801.5~818.5 MHz IL_{min}	-	1.6	3.8	dB
Ripple 801.5~818.5 MHz	-	0.6	1.5	dB
Group Delay 801.5~818.5 MHz	-	0.07	0.11	μs
Group Delay Variation 801.5~818.5 MHz	-	23	75	ns
Attenuation:(Reference level from 0 dB)				
1) 660...760MHz	41	49	-	dB
2) 790MHz	17	29	-	dB
3) 830MHz	17	21	-	dB
4) 860...960MHz	38	43	-	dB

Note: IL_{min} is the minimum of the pass band attenuation.

C. MEASUREMENT CIRCUIT:

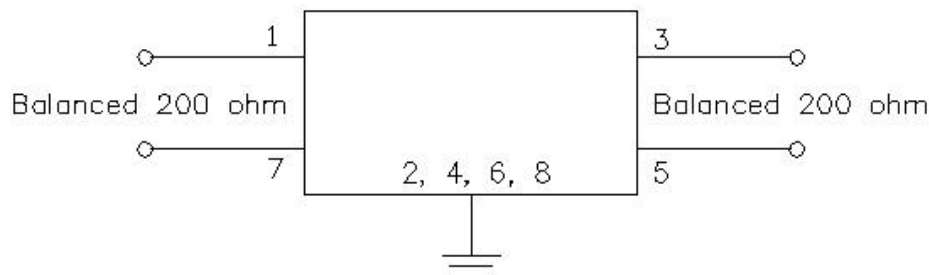

SAW Filter 810.0MHz
Part No: MA07350

Model: TA0438A
REV. NO.: 2

D. FREQUENCY CHARACTERISTICS:

Transfer Function:

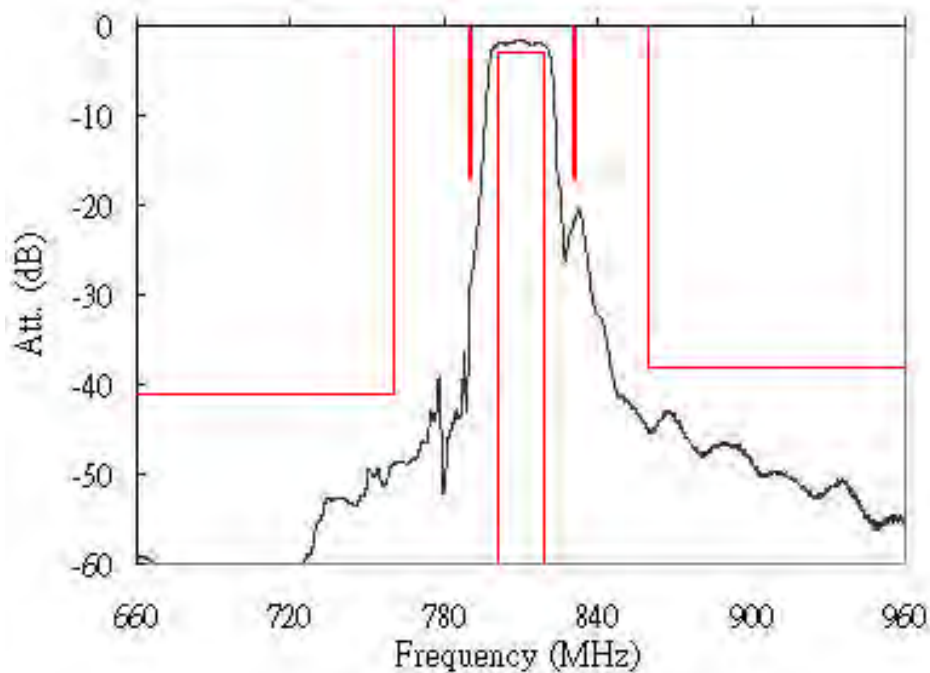
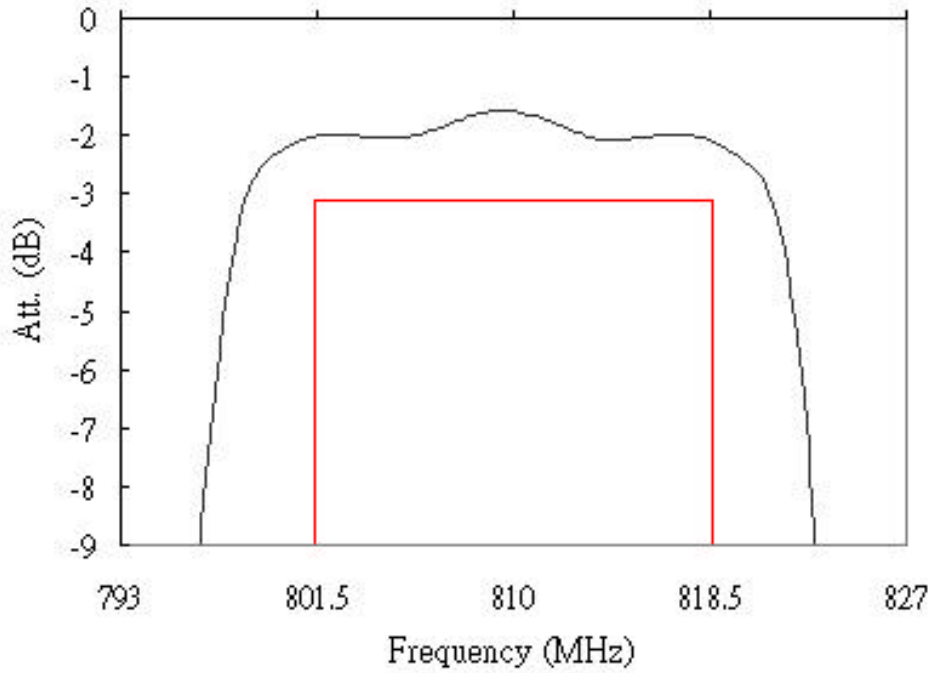

SAW Filter 810.0MHz
Part No: MA07350

Model: TA0438A
REV. NO.: 2

Wideband:

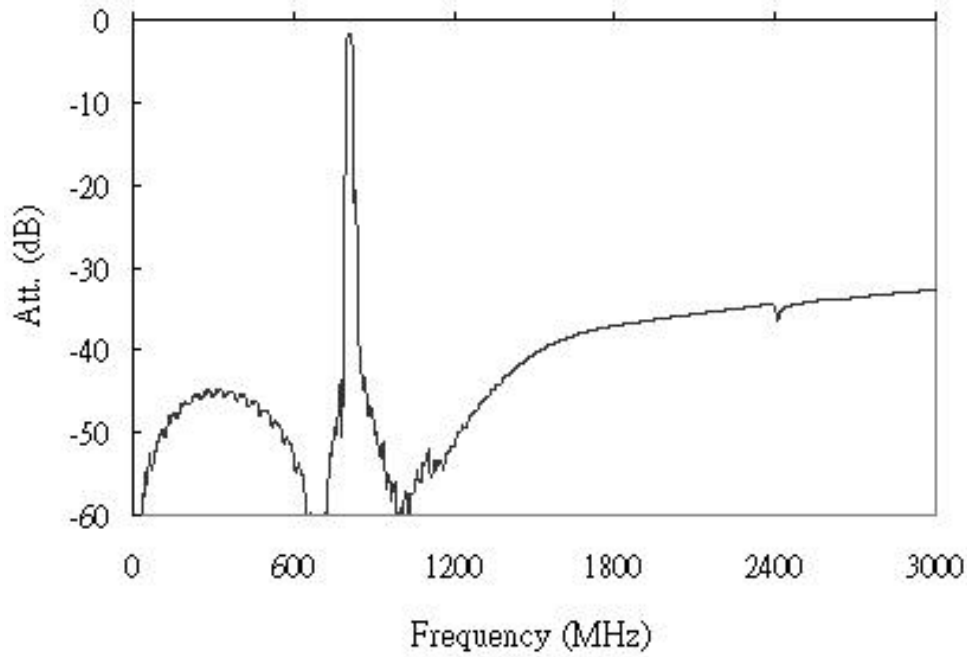

Group Delay:

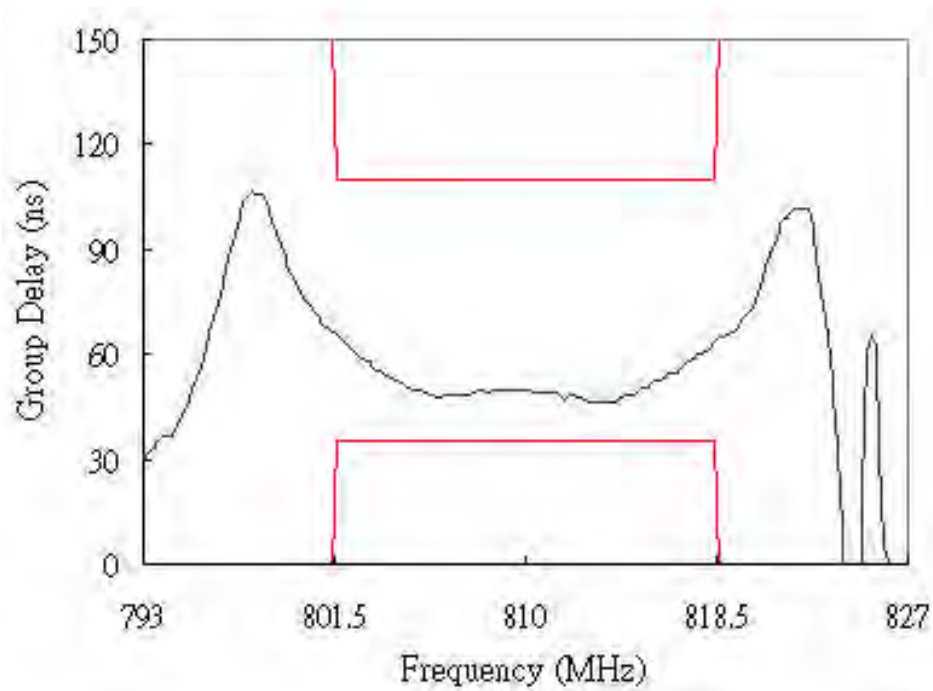

SAW Filter 810.0MHz
Part No: MA07350

Model: TA0438A
REV. NO.: 2

E. OUTLINE DRAWING:

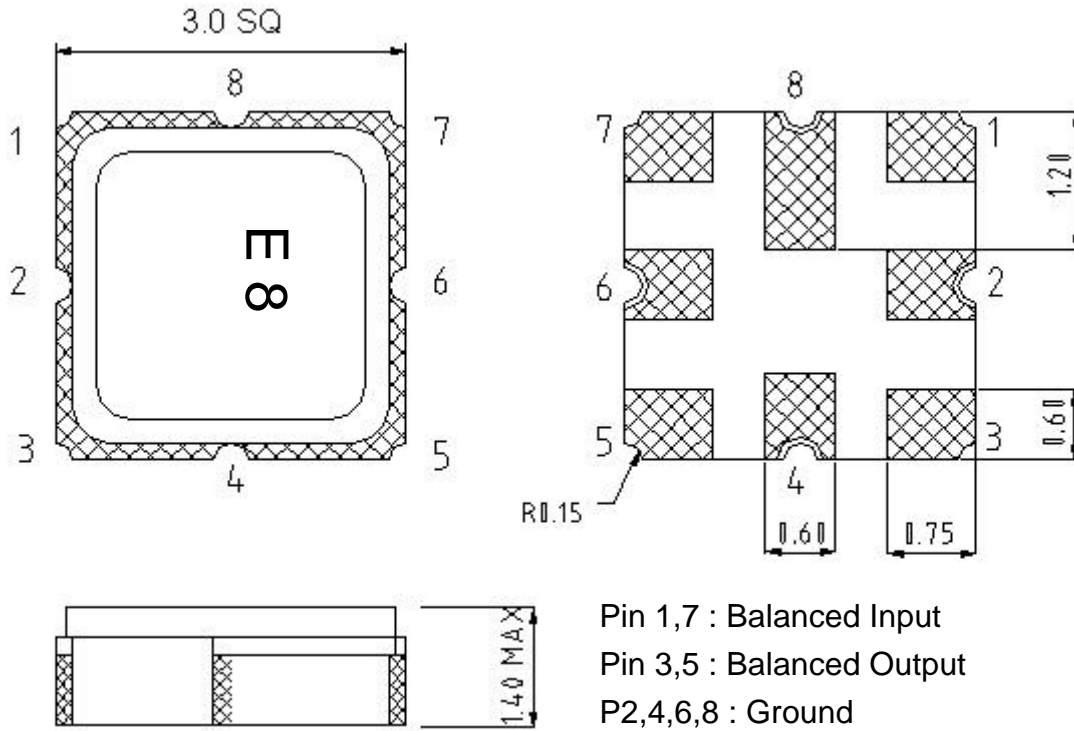

Unit : mm

F. PCB FOOTPRINT:

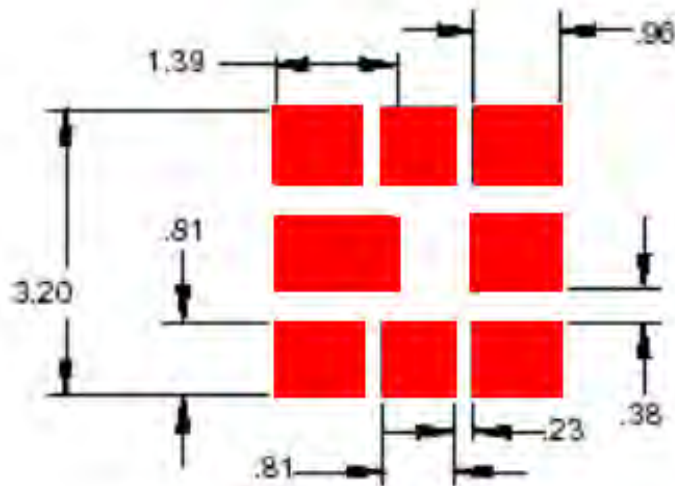

SAW Filter 810.0MHz
Part No: MA07350

Model: TA0438A
REV. NO.: 2

G. PACKING:

1. REEL DIMENSION

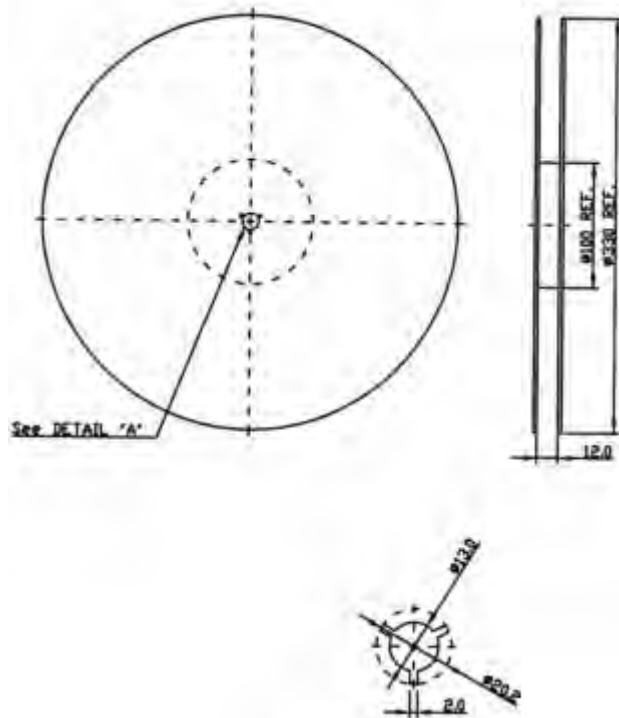

2. TAPE DIMENSION

