

**SAW Filter 1220MHz**  
**Part No: MA05463**

**Model: TA0292A**  
**Rev No: 2**

**A. MAXIMUM RATING:**

1. Input Power Level: 0dBm
2. DC voltage: 3V
3. Operating Temperature: -30°C to +85°C
4. Storage Temperature: -40°C to +85°C

**B. CHARACTERISTICS:**

Balanced to balanced operation

Terminating source impedance:  $Z_S = 200\Omega$

Terminating load impedance:  $Z_L = 200\Omega$

Item	Min.	Typ.	Max.
Center frequency Fc MHz	-	1220	-
Insertion loss 1206 ~ 1234MHz IL (dB)	-	4.0	5.7
Amplitude ripple 1206 ~ 1234MHz (dB)	-	1.9	3.5
Attenuation (Reference level from 0dB)			
300 ~ 1118MHz (dB)	40	59	-
1118 ~ 1146MHz (dB)	45	60	-
1300 ~ 2000 MHz (dB)	45	59	-
Group delay ripple (p-p) (ns)	-	15	-

**SAW Filter 1220MHz**  
**Part No: MA05463**

**Model: TA0292A**  
**Rev No: 2**

**C. MEASUREMENT CIRCUIT:**

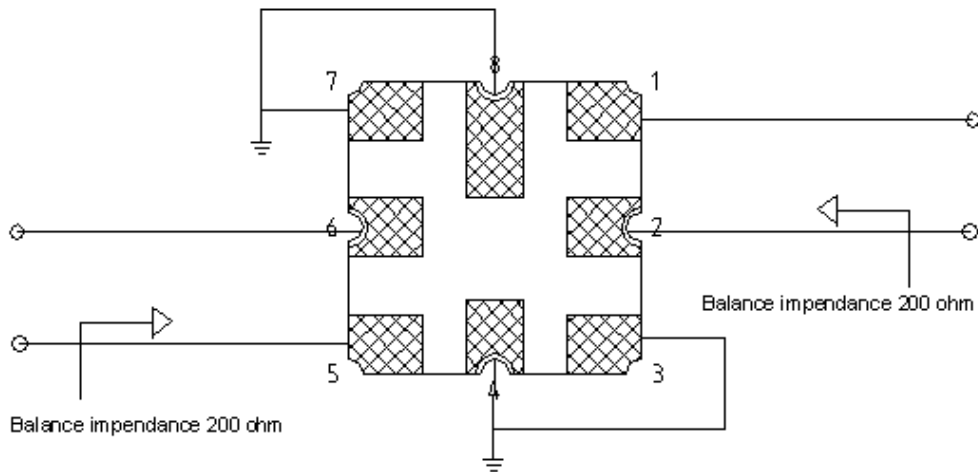

**D. OUTLINE DRAWING:**

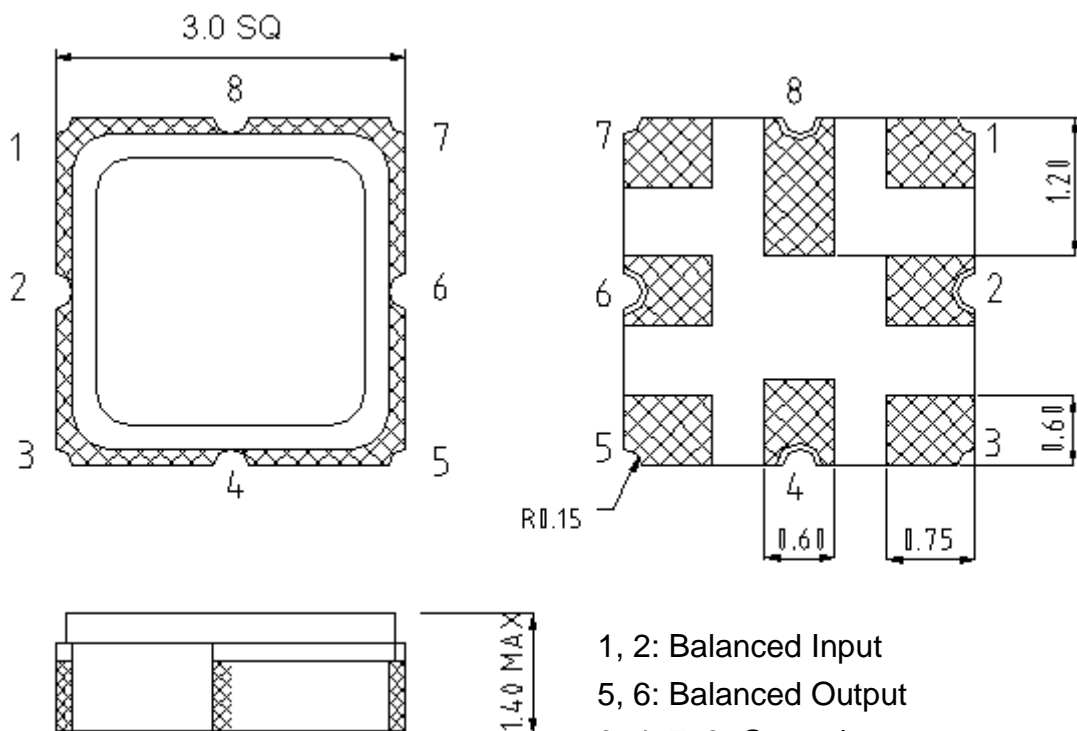

1, 2: Balanced Input  
 5, 6: Balanced Output  
 3, 4, 7, 8: Ground  
 Unit: mm

**SAW Filter 1220MHz**  
**Part No: MA05463**

**Model: TA0292A**  
**Rev No: 2**

**E. TRANSFER FUNCTION:**

Narrowband

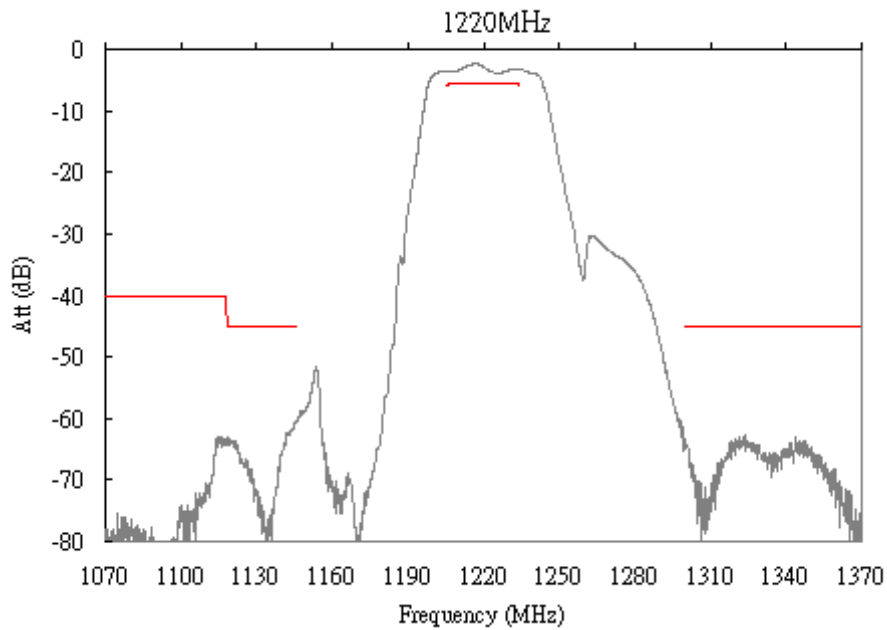

Wideband

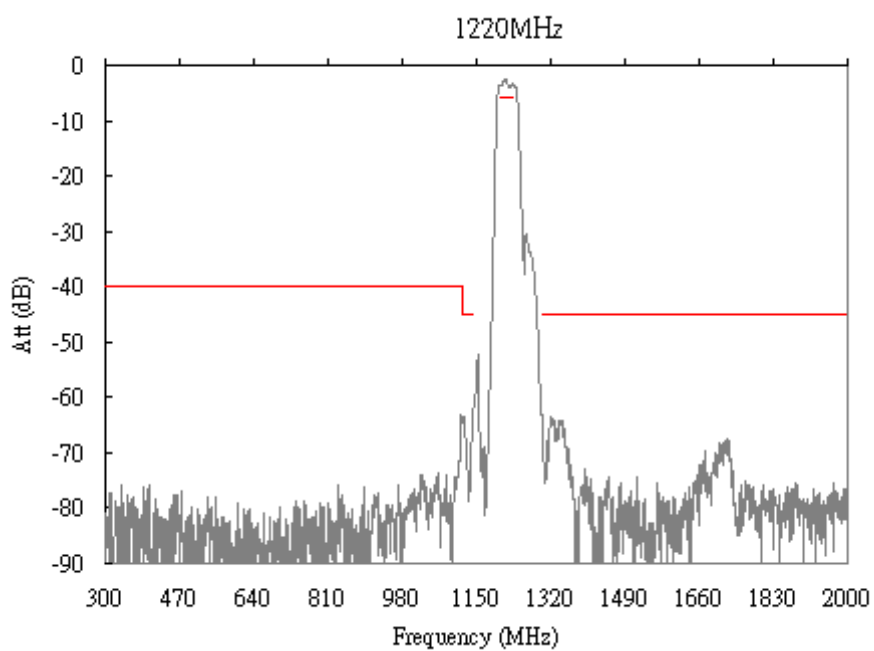

**SAW Filter 1220MHz**  
**Part No: MA05463**

**Model: TA0292A**  
**Rev No: 2**

**F. PACKING:**

1. REEL DIMENSION

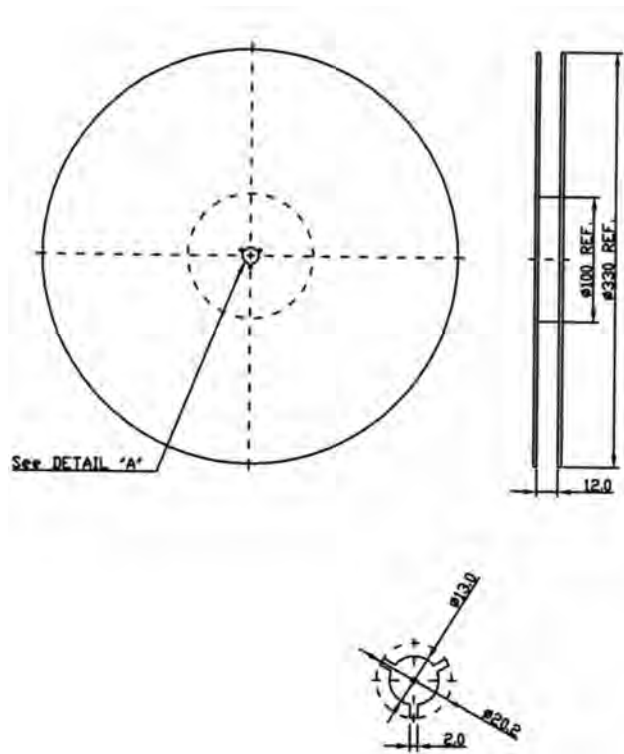

2. TAPE DIMENSION

