

SAW Filter 171MHz
Part No: MA05483

Model: TA0181A
Rev No: 2

A. MAXIMUM RATING:

1. Input Power Level: 0dBm
2. DC voltage: 10V
3. Operating Temperature: -10°C to +50°C
4. Storage Temperature: -40°C to +85°C

B. ELECTRICAL CHARACTERISTICS:

Characteristics	Specification	Note
Center frequency Fc (MHz)	171	1
IL (Within Fc ± 4MHz)	6.5 Max.	
Attenuation: (Reference level from 0dB) (dB)		
Fc -100MHz to -38.8MHz (dB)	50 Min.	1
Fc +38.8MHz to +100MHz (dB)	42 Min.	
Impedance at Fc: Input Z _{IN} = R _{IN} // C _{IN}	210Ω // 11pF	2
Output Z _{OUT} = R _{OUT} // C _{OUT}	210Ω // 11pF	2

Note 1: The standard definitions is in JIS C 6703

Note 2:

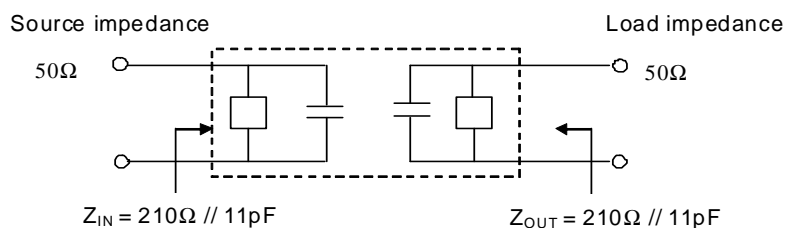

SAW Filter 171MHz
Part No: MA05483

Model: TA0181A
Rev No: 2

C. FREQUENCY CHARACTERISTICS:

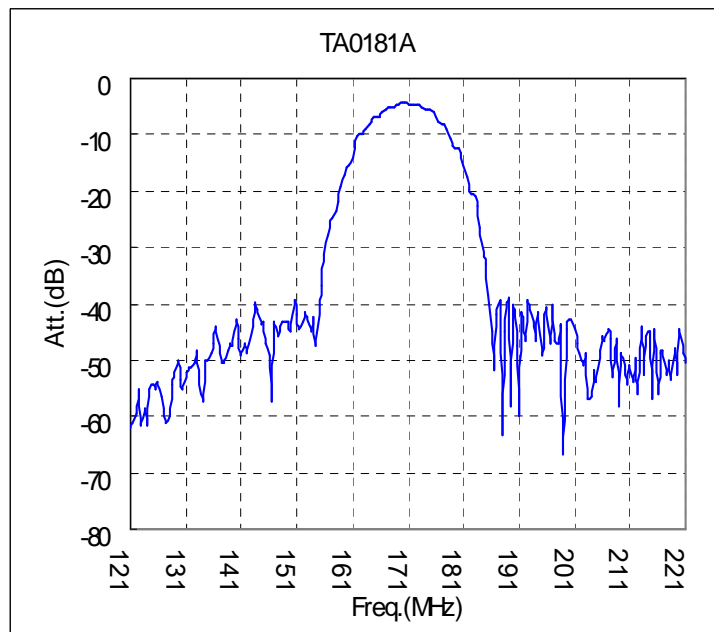
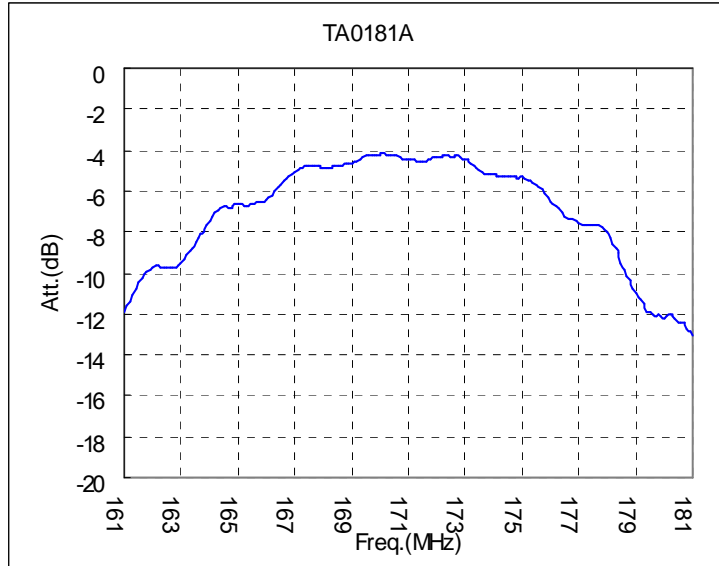

SAW Filter 171MHz
Part No: MA05483

Model: TA0181A
Rev No: 2

D. MEASUREMENT CIRCUIT:

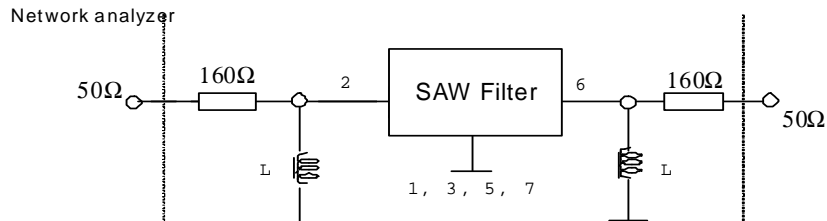

0dB Level



E. OUTLINE DRAWING:

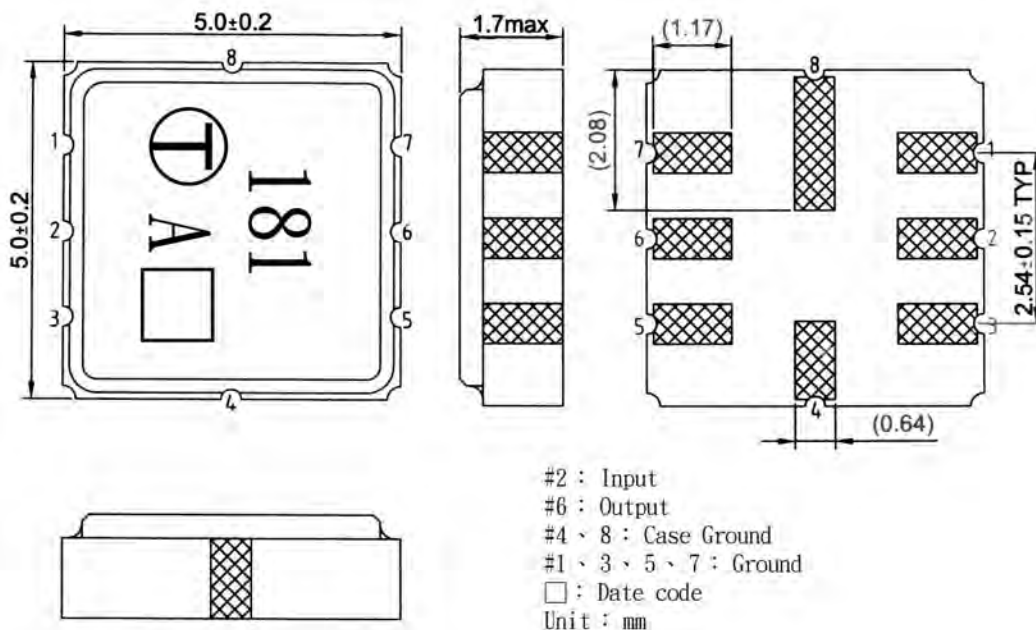

SAW Filter 171MHz
Part No: MA05483

Model: TA0181A
Rev No: 2

F. PACKING:

1. REEL DIMENSION

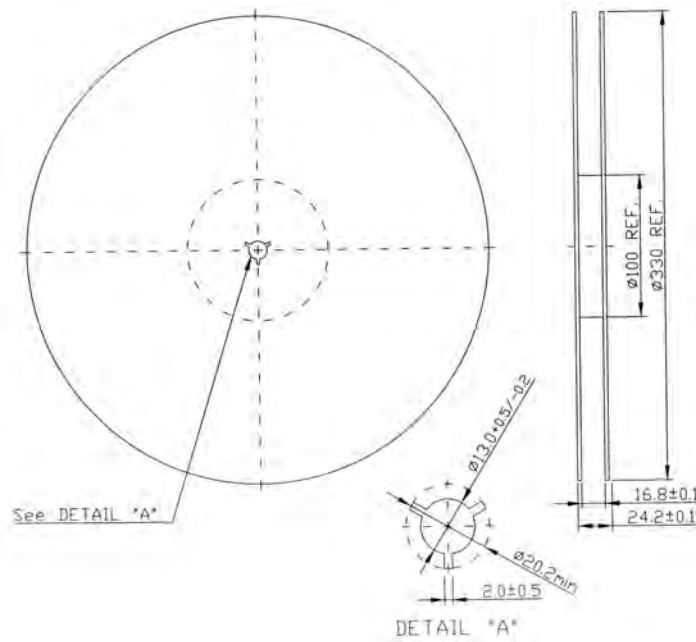

2. TAPE DIMENSION

