

**SAW Filter 1880MHz**  
**Part No: MA05678**

**Model: TA0294A**  
**Rev No: 2**

**A. MAXIMUM RATING:**

1. Input Power Level: 10dBm
2. DC voltage: 5V
3. Operating Temperature: -30°C to +85°C
4. Storage Temperature: -40°C to +85°C

**B. ELECTRICAL CHARACTERISTICS:**

Item	Min.	Typ.	Max.
Center frequency Fc (dB)	-	1880	-
Insertion loss (1850 ~ 1910MHz) IL (dB)	-	2.45	4.0
Amplitude ripple (1850 ~ 1910MHz) (dB)	-	1.2	2.5
Attenuation (Reference level from 0dB)			
D.C. ~ 1660MHz (dB)	20	32	-
1660 ~ 1721MHz (dB)	30	35	-
1721 ~ 1800MHz (dB)	20	37	-
1930 ~ 1990MHz (dB)	7	19	-
2000 ~ 2040MHz (dB)	25	37	-
2040 ~ 2480MHz (dB)	31	38	-
3700 ~ 3820MHz (dB)	25	35	-
Input / Output Return Loss (1850 ~ 1910MHz)	7.4	13	-
Source impedance Z <sub>S</sub> (Ω)	-	50	-
Load impedance Z <sub>L</sub> (Ω)	-	50	-

Note: The standard definitions is in JIS C 6703

**SAW Filter 1880MHz**

**Model: TA0294A**

**Part No: MA05678**

**Rev No: 2**

**C. MEASUREMENT CIRCUIT:**

HP Network analyzer

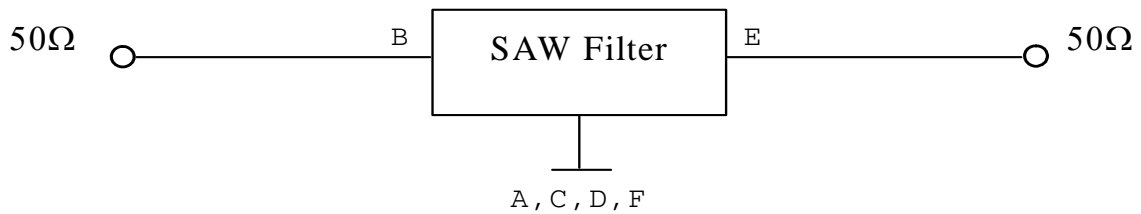

**D. OUTLINE DRAWING:**

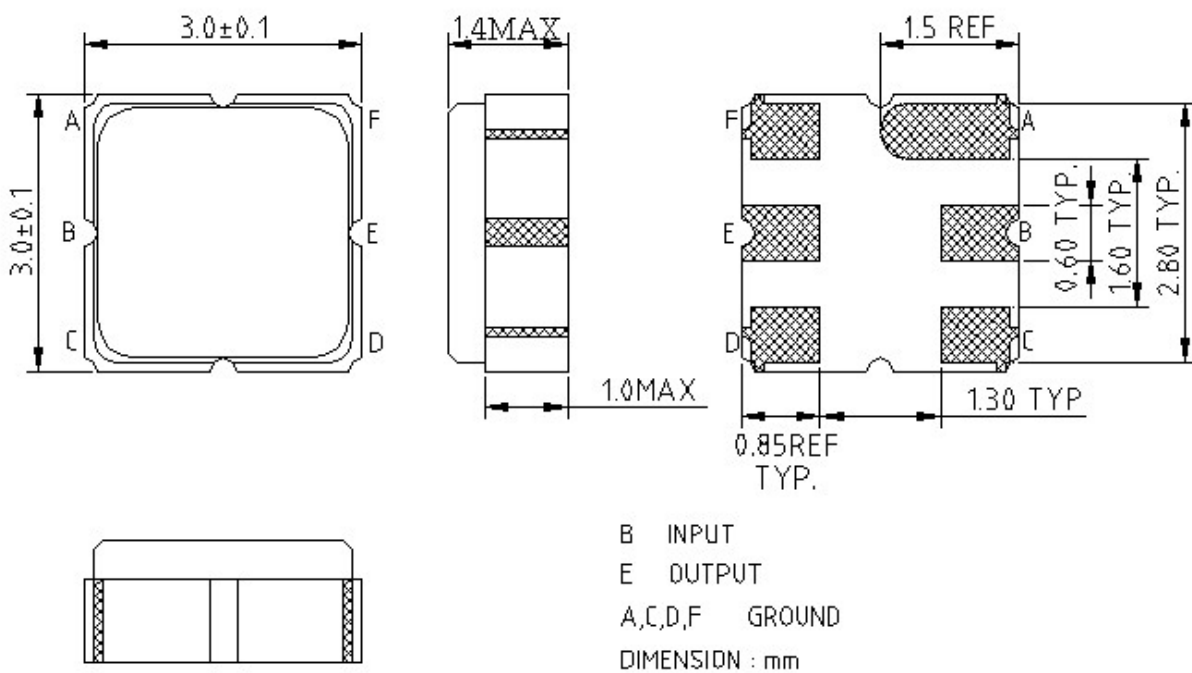

**SAW Filter 1880MHz**  
**Part No: MA05678**

**Model: TA0294A**  
**Rev No: 2**

**E. FREQUENCY CHARACTERISTICS:**

1. Transfer function

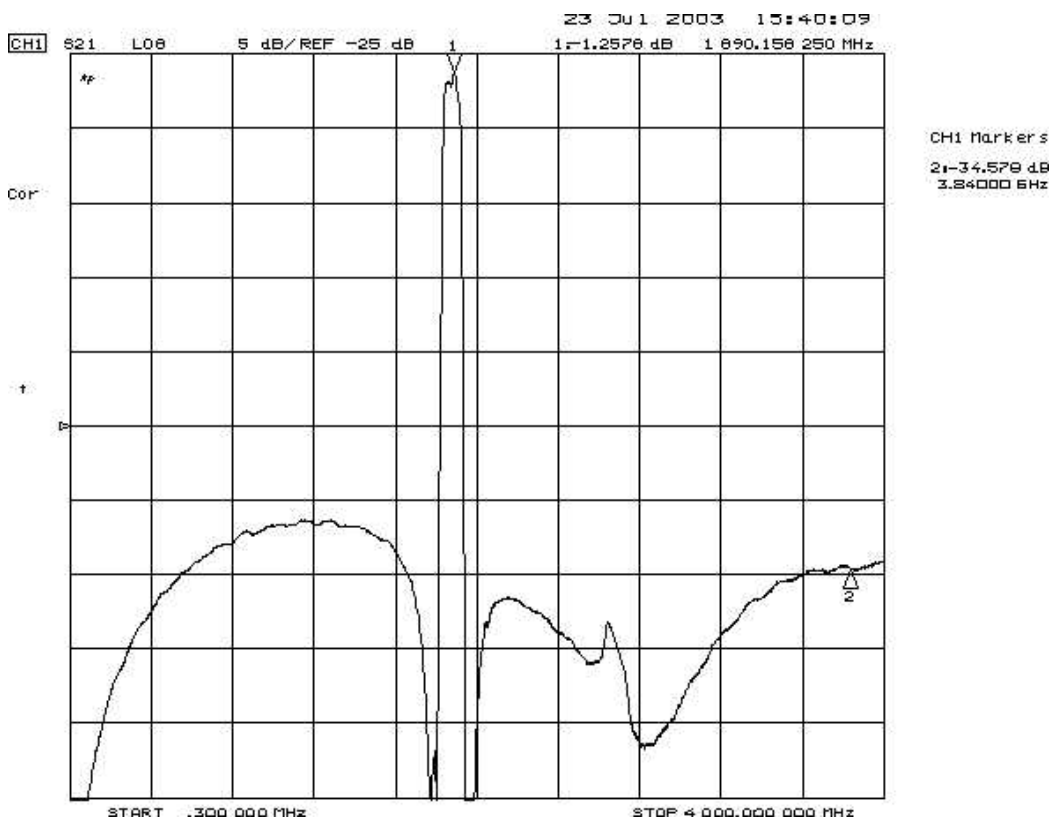
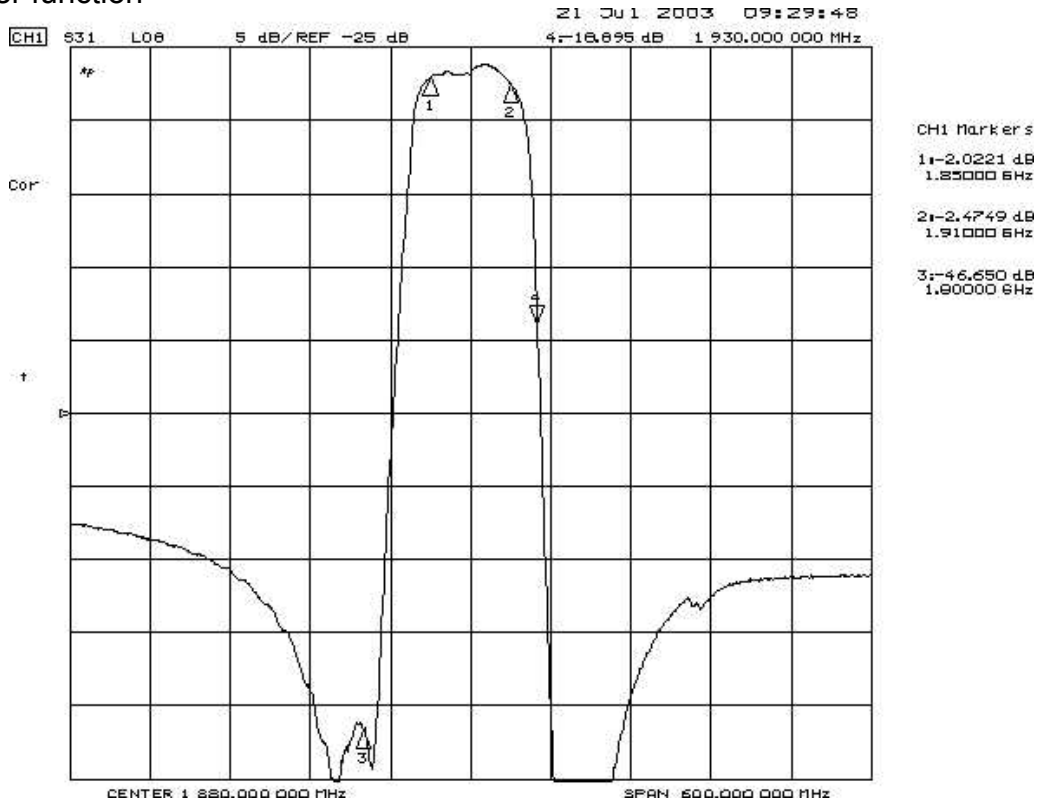

**SAW Filter 1880MHz**  
**Part No: MA05678**

**Model: TA0294A**  
**Rev No: 2**

2. Reflection Functions

S11

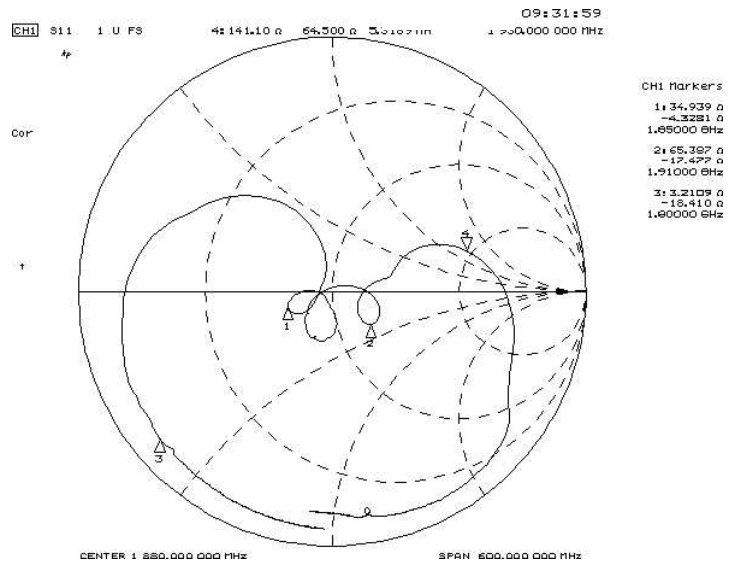
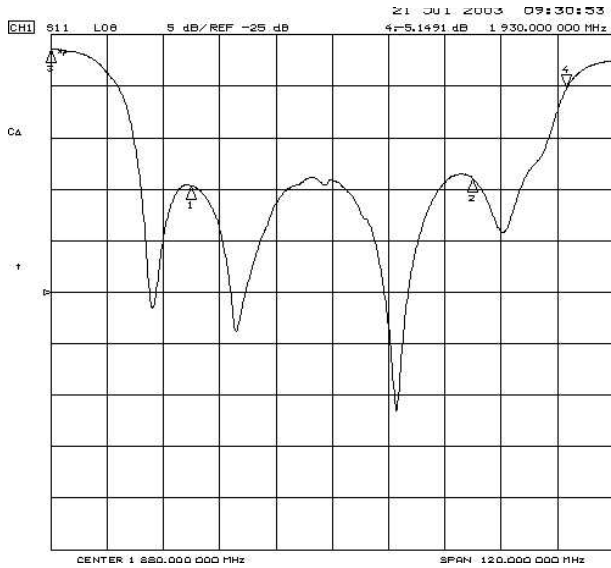

S22

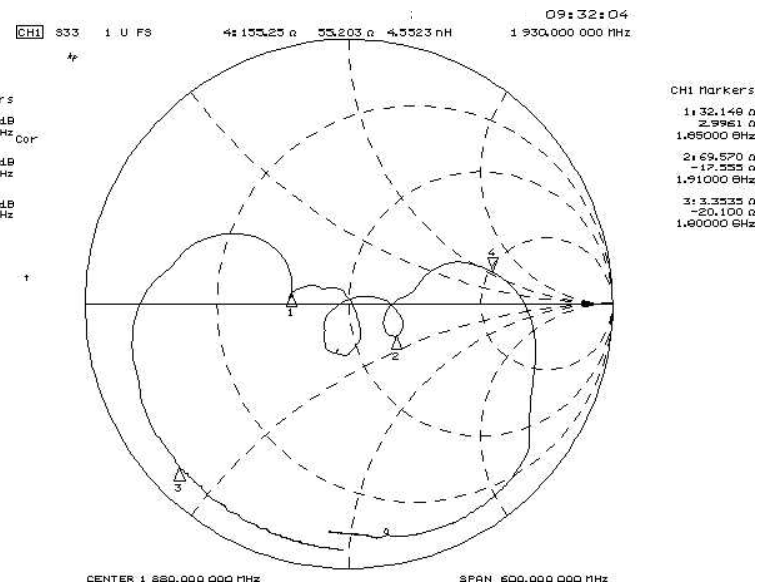
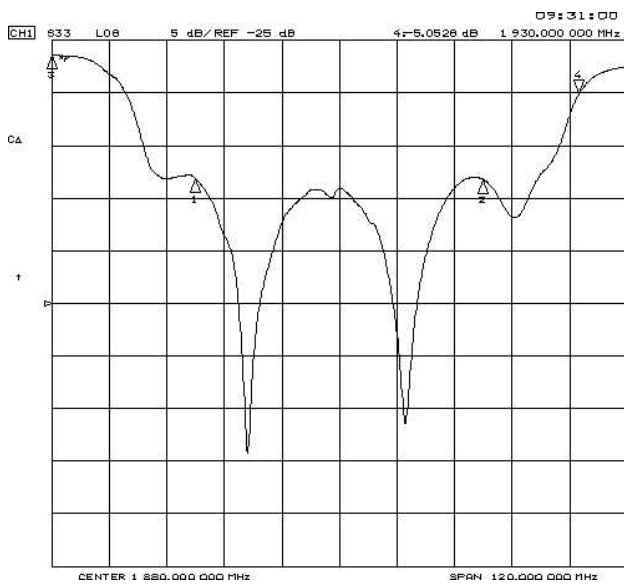

**SAW Filter 1880MHz**  
**Part No: MA05678**

**Model: TA0294A**  
**Rev No: 2**

**F. PACKING:**

1. Reel Dimension

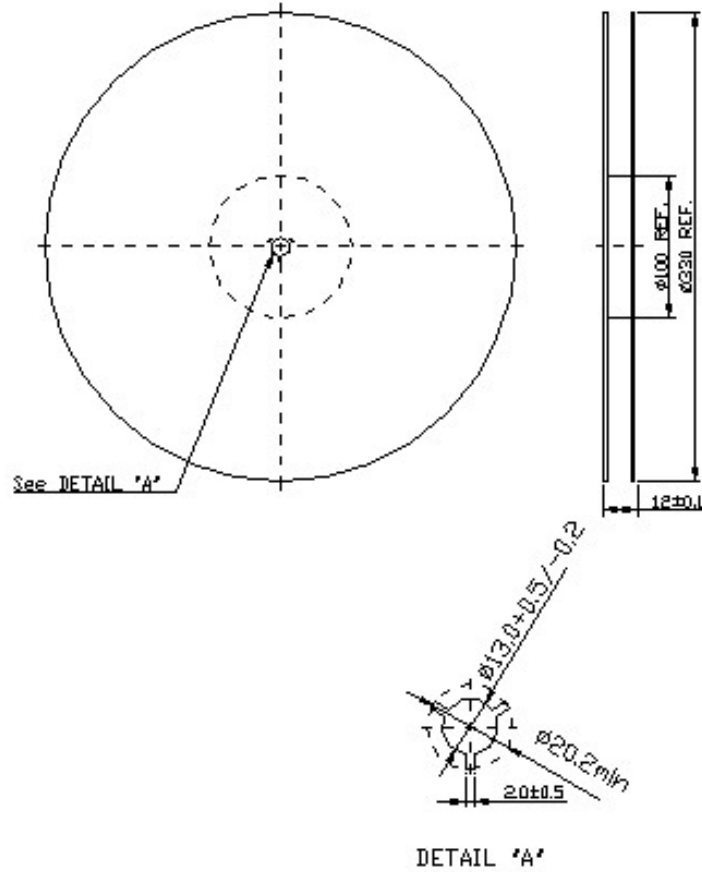

2. Tape Dimension

