

**SAW Filter 611.0MHz**  
**Part No: MA06409**

**Model: TA0341A**  
**Rev No. 1**

**A. MAXIMUM RATING:**

1. Input Power Level: 10dBm
2. DC voltage: 3V
3. Storage Temperature: -20°C to +50°C

**B. ELECTRICAL CHARACTERISTICS:**

Item	Unit	Min.	Typ.	Max.
Center frequency $F_c^1$	MHz	-	611	-
Insertion Loss IL	dB	-	2.7	5.0
3dB Bandwidth BW -3dB	MHz	7	7.8	-
Passband Ripple <sup>2</sup>	dB	-	1.0	2
Absolute Attenuation				
613.75MHz	dB	-	3.5	4.2
608.25MHz	dB	-	3.2	4.2
615.45MHz	dB	9	12	-
603.05MHz	dB	19	22	-
Operating Temperature Range	°C	-	25	-
Source impedance $Z_s$		-	50	-
Load impedance $Z_L$		-	50	-
Notes	No matching circuit required $F_c \pm 2.5\text{MHz}$ Peak-Peak All spec on room temperature only			

**SAW Filter 611.0MHz**  
**Part No: MA06409**

**Model: TA0341A**  
**Rev No. 1**

**C. FREQUENCY CHARACTERISTICS:**



**SAW Filter 611.0MHz**  
**Part No: MA06409**

**Model: TA0341A**  
**Rev No. 1**

**D. MEASUREMENT CIRCUIT:**

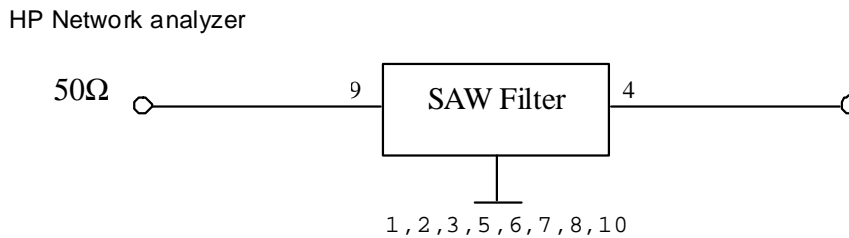

**E. OUTLINE DRAWING:**

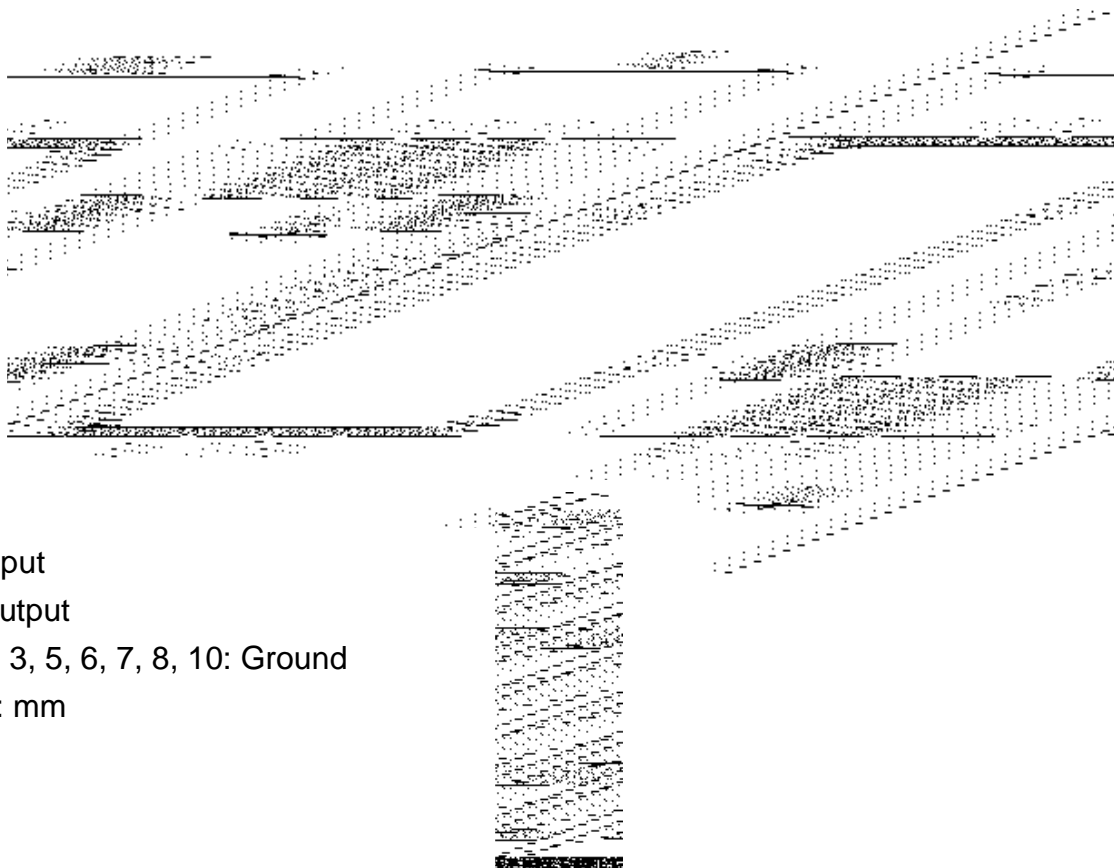

**SAW Filter 611.0MHz**  
**Part No: MA06409**

**Model: TA0341A**  
**Rev No. 1**

**F. PACKING:**

**1. REEL DIMENSION**

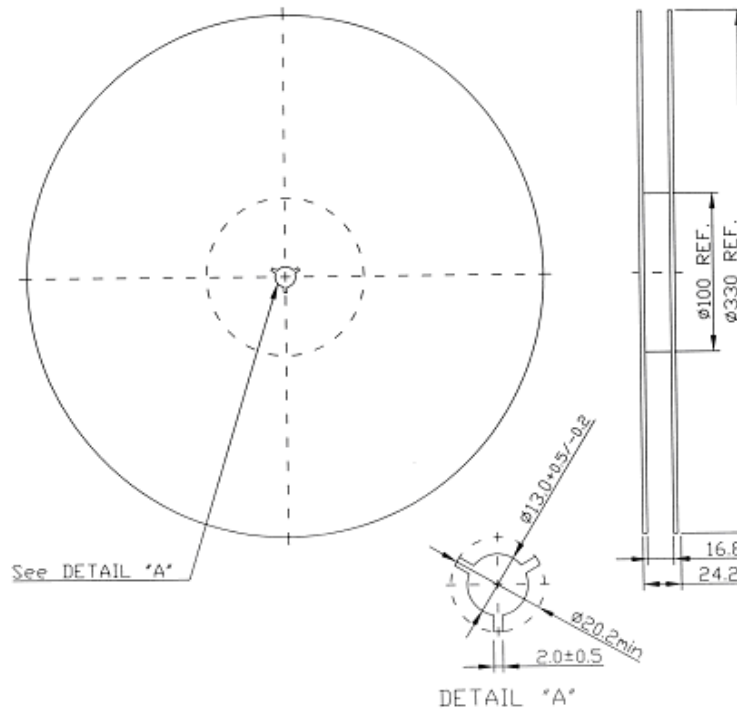

**2. TAPE DIMENSION**

