

SAW Filter 420.0MHz
Part No: MA06702

Model: TA0409A
Rev No: 1

A. MAXIMUM RATING:

1. Input Power Level: 10dBm
2. DC voltage: 5V
3. Operating Temperature: -25°C to +75°C
4. Storage Temperature: -40°C to +85°C

B. ELECTRICAL CHARACTERISTICS:

Reference temperature: 25°C

Item	Unit	Min.	Typ.	Max.
Center frequency Fc	MHz	-	420	-
Minimum Insertion Loss IL min (reference level)	dB	-	1.6	3.5
Ripple Fc ± 10MHz	dB		1.3	2.5
Relative Attenuation:(Reference level from IL min)				
320 to 340MHz	dB	45	60	-
365 to 385MHz	dB	40	58	-
Temperature coefficient of frequency	ppm/K	-	-37	-
Source impedance Z _S	Ω	-	50	-
Load impedance Z _L	Ω	-	50	-

Note: IL min is the minimum of the pass band attenuation. The center frequency Fc is the mean value of the upper and lower frequencies at the 2.5dB filter attenuation level relative to the IL min.

SAW Filter 420.0MHz
Part No: MA06702

Model: TA0409A
Rev No: 1

C. FREQUENCY CHARACTERISTICS:

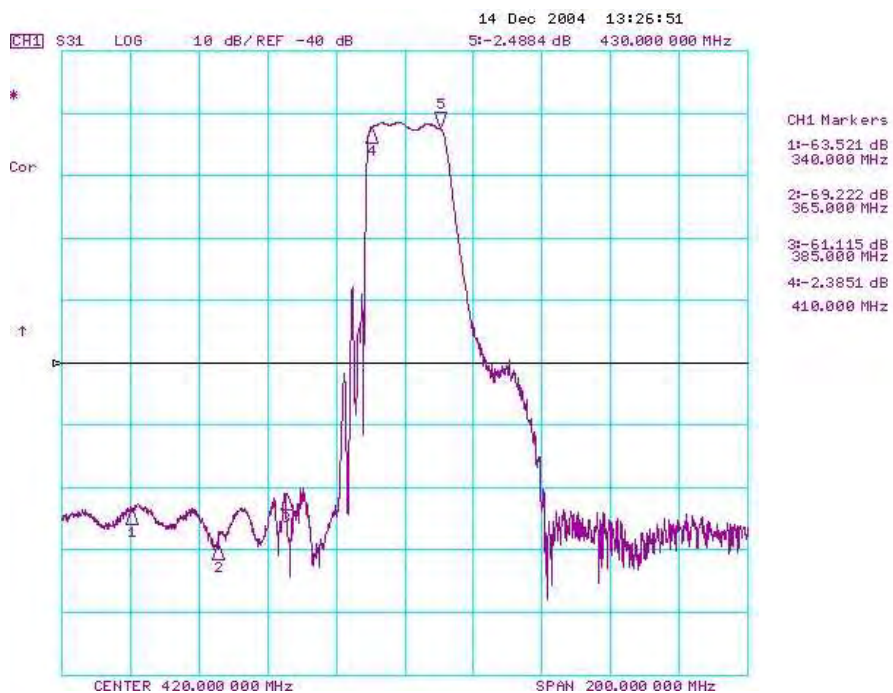

SAW Filter 420.0MHz
Part No: MA06702

Model: TA0409A
Rev No: 1

D. MEASUREMENT CIRCUIT:

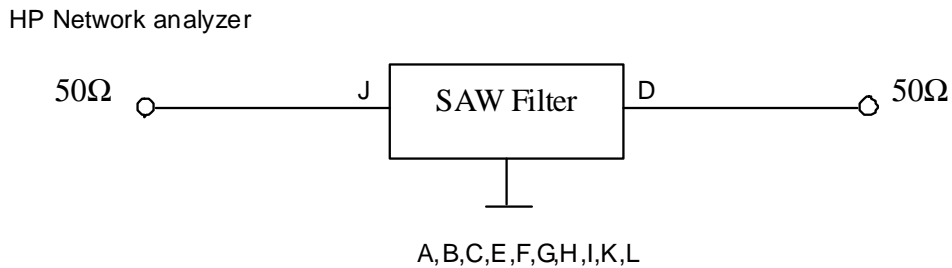

E. OUTLINE DRAWING:

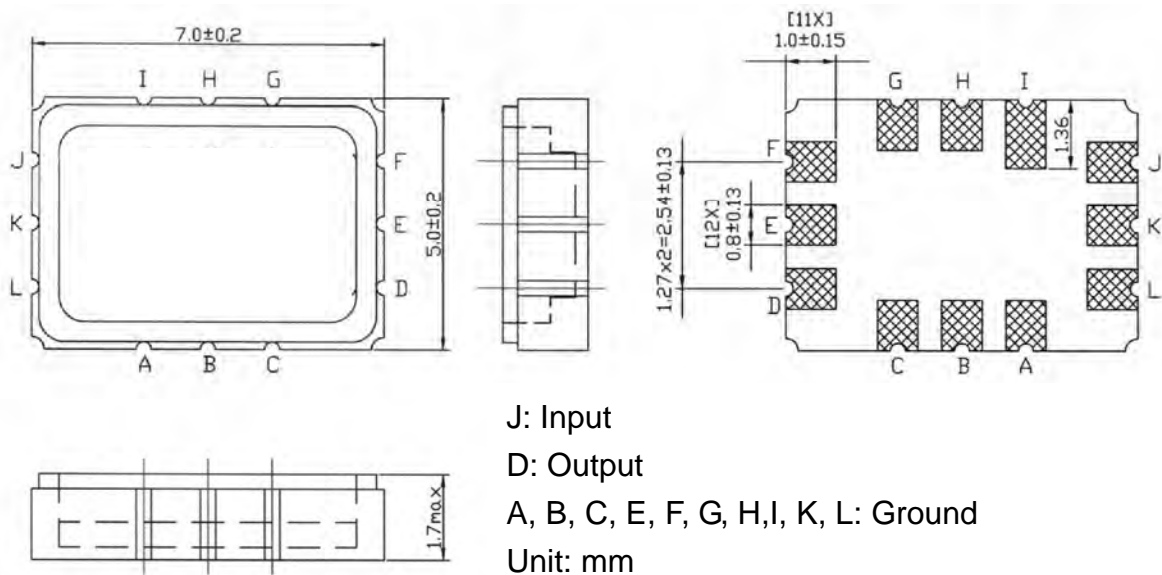

F. PCB FOOTPRINT:

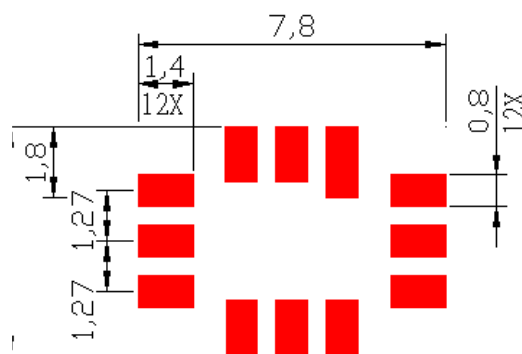

SAW Filter 420.0MHz
Part No: MA06702

Model: TA0409A
Rev No: 1

G. PACKING:

1. REEL DIMENSION

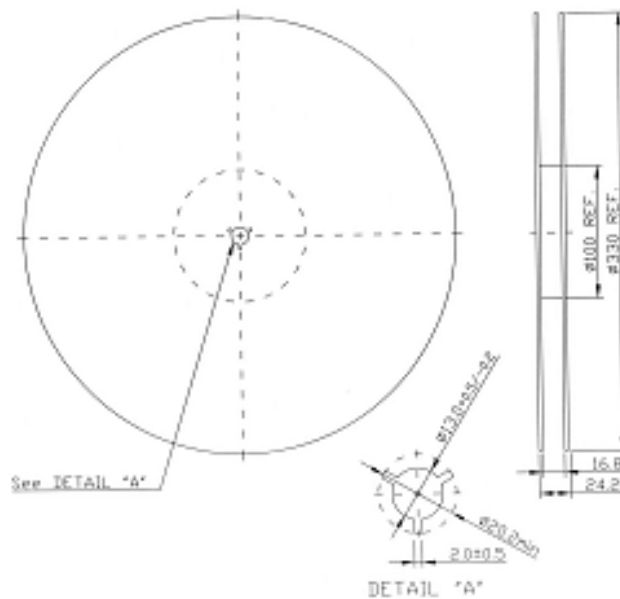

2. TAPE DIMENSION

