

SAW Filter 868.60MHz
Part No: MA07635

Model: TA0336A
Rev No: 1

A. MAXIMUM RATING:

1. Input Power Level: 0dBm
2. DC voltage: 0V
3. Operating Temperature: -45°C to +90°C
4. Storage Temperature: -45°C to +90°C

B. ELECTRICAL CHARACTERISTICS:

Reference temperature: 25°C

Item	Min.	Typ.	Max.	Note
Center frequency Fc (MHz)	-	868.69	-	1
Minimum IL (868.00 ~ 869.38MHz) (dB) IL min	-	3.3	4.7	
Pass band (relative to IL min)				
868.0 ~ 869.38MHz (dB)	-	1.5	3.0	1
867.92 ~ 869.46MHz (dB)	-	2.0	6.0	
Pass bandwidth (relative to IL min) BW3 (kHz)	-	1900	-	
Attenuation: (relative to IL min) (dB)				
10 ~ 700MHz (dB)	50	55	-	
700 ~ 830MHz (dB)	35	45	-	
830 ~ 850.25MHz (dB)	32	40	-	
850.25 ~ 865.27MHz (dB)	25	27	-	1
871.25 ~ 874.75MHz (dB)	11	15	-	
874.75 ~ 883.25MHz (dB)	15	20	-	
883.25 ~ 900MHz (dB)	30	32	-	
900 ~ 1000MHz (dB)	35	45	-	
Impedance at Fc: Input $Z_{IN} = R_{IN} // C_{IN}$ Output $Z_{OUT} = R_{OUT} // C_{OUT}$	117Ω // 3.7pF 117Ω // 3.7pF			

Note 1: The standard definitions is in JIS C 6703

SAW Filter 868.60MHz
Part No: MA07635

Model: TA0336A
Rev No: 1

C. FREQUENCY CHARACTERISTICS:

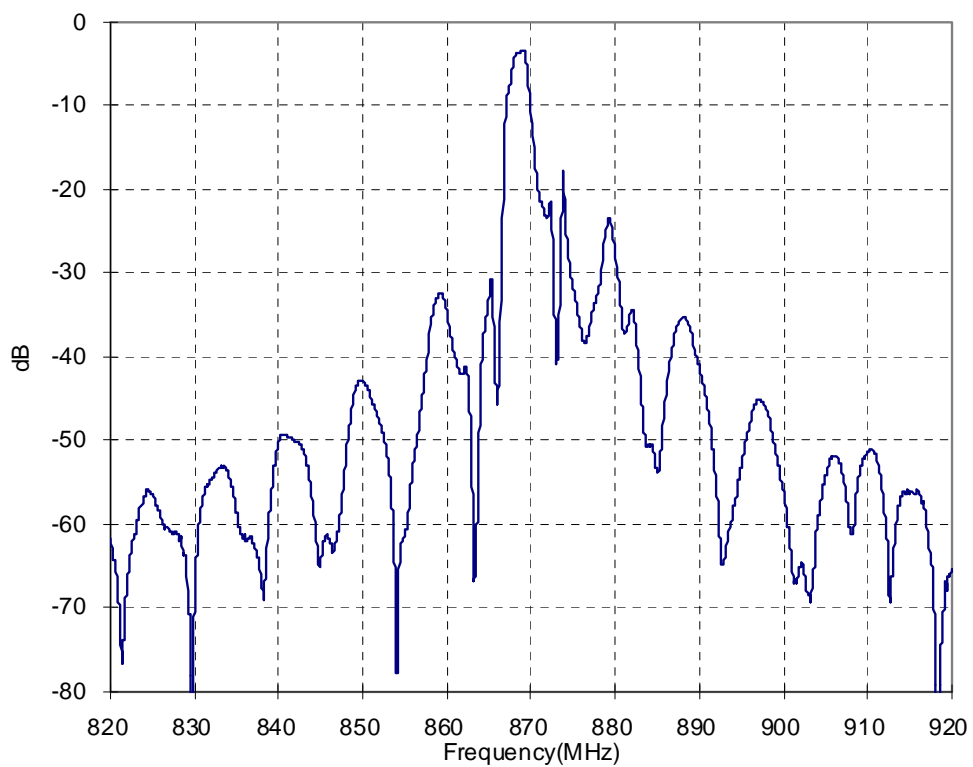
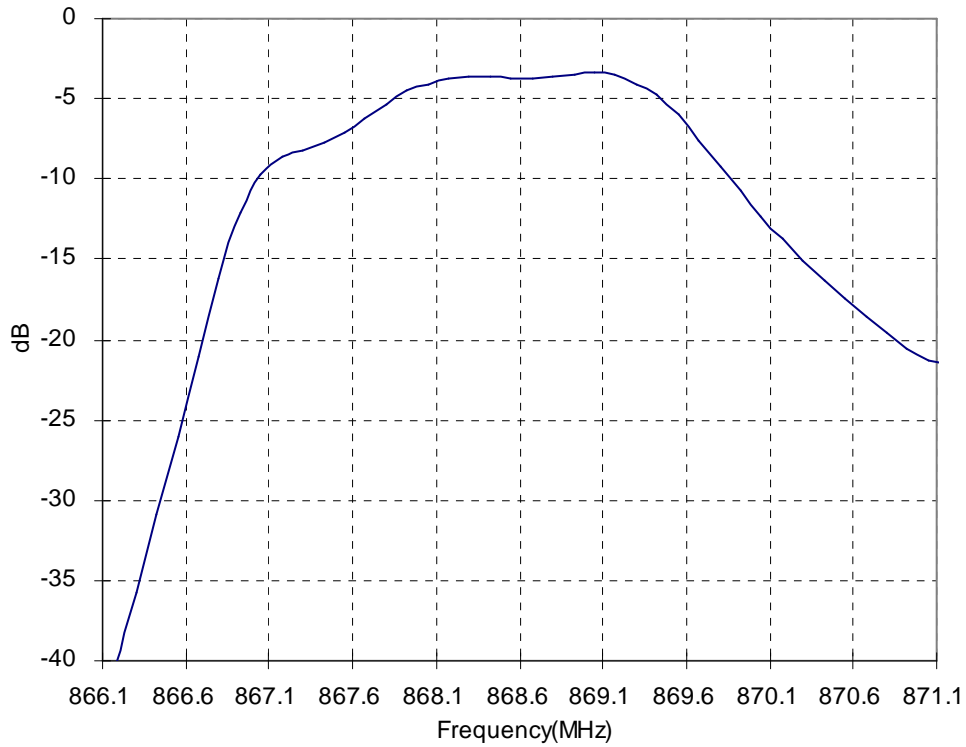

SAW Filter 868.60MHz
Part No: MA07635

Model: TA0336A
Rev No: 1

D. MEASUREMENT CIRCUIT:

HP Network analyzer

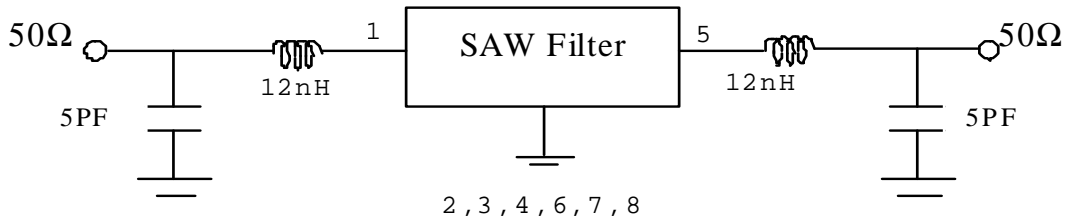

E. OUTLINE DRAWING:

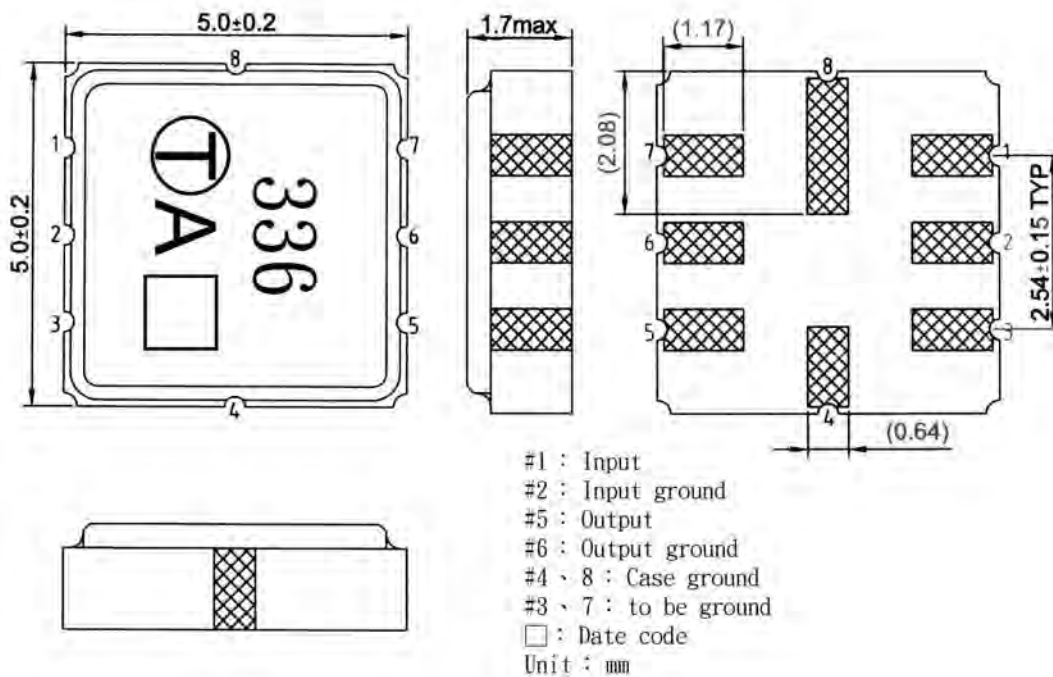

SAW Filter 868.60MHz
Part No: MA07635

Model: TA0336A
Rev No: 1

F. PACKING:

1. REEL DIMENSION

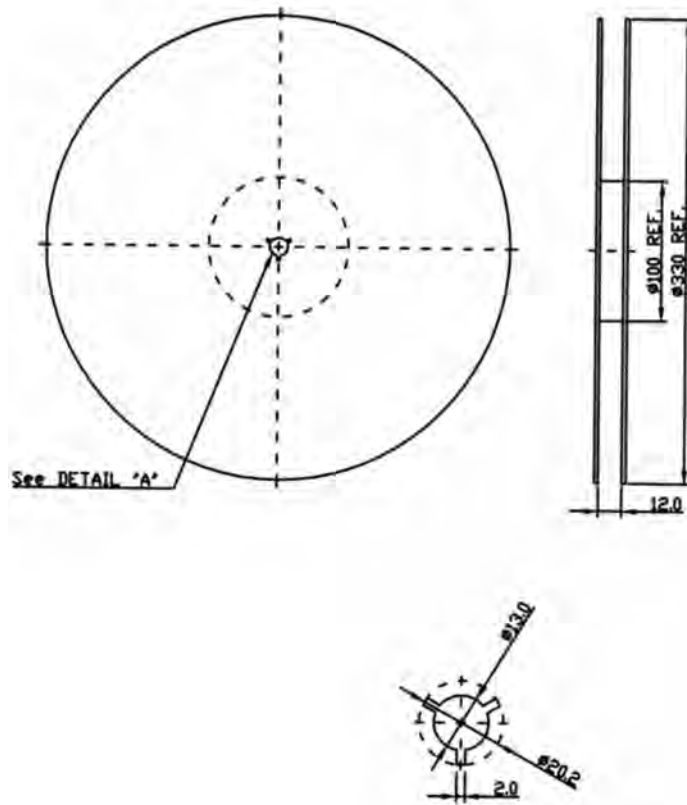

2. TAPE DIMENSION

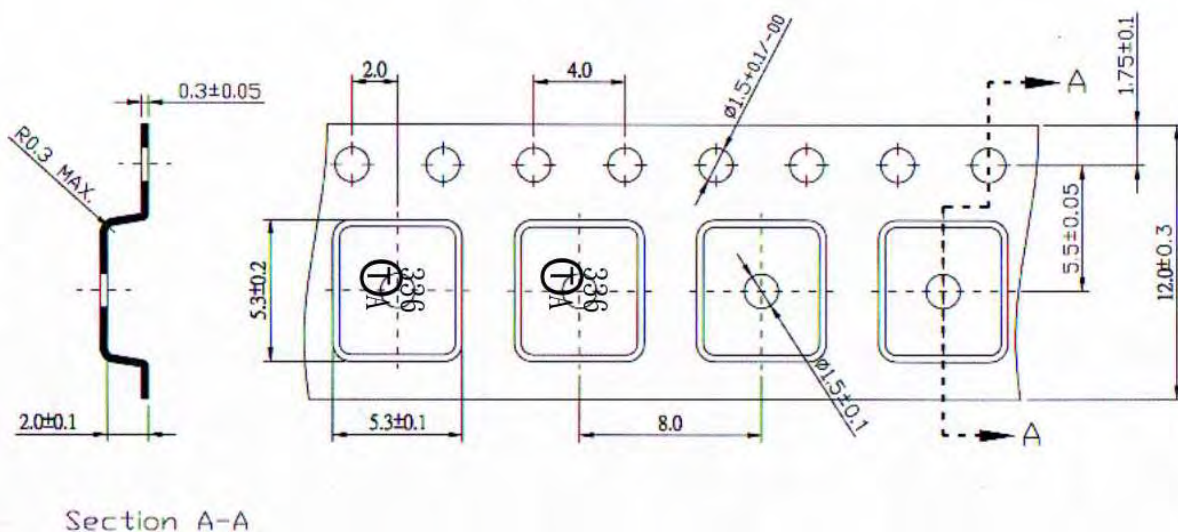

Section A-A