

SAW Filter 426.1MHz
Part No: MA07760

Model: TA0192A
Rev No: 1

A. MAXIMUM RATING:

1. Input Power Level: 10dBm
2. DC voltage: 0V
3. Operating Temperature: -10°C to +60°C
4. Storage Temperature: -20°C to +75°C

B. ELECTRICAL CHARACTERISTICS:

Characteristics	Min.	Typ.	Max.
Center frequency Fc (dB)	-	426.1	-
Insertion loss (within 426.012 ~ 426.150MHz) IL (dB)	-	2.5	3.5
Ripple Deviation (p-p) (within 426.012 ~ 426.150MHz) (dB)	-	0.1	1.5
Absolute Attenuation			
Within 382.012 ~ 384.150MHz (dB)	50.0	68.0	-
Within 468.012 ~ 470.150MHz (dB) (Plus Image Frequency)	50.0	68.0	-
Source impedance Z_S (Ω)	-	53 - j 29.44	-
Load impedance Z_L (Ω)	-	53 - j 29.44	-

Note 1: The standard definitions is in JIS C 6703

Note 2:

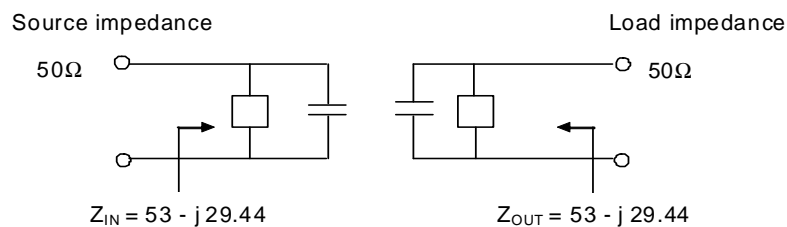

SAW Filter 426.1MHz
Part No: MA07760

Model: TA0192A
Rev No: 1

C. MEASUREMENT CIRCUIT:

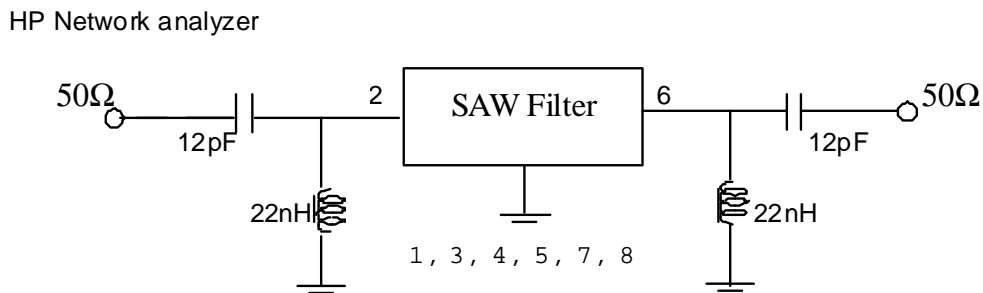

D. OUTLINE DRAWING:

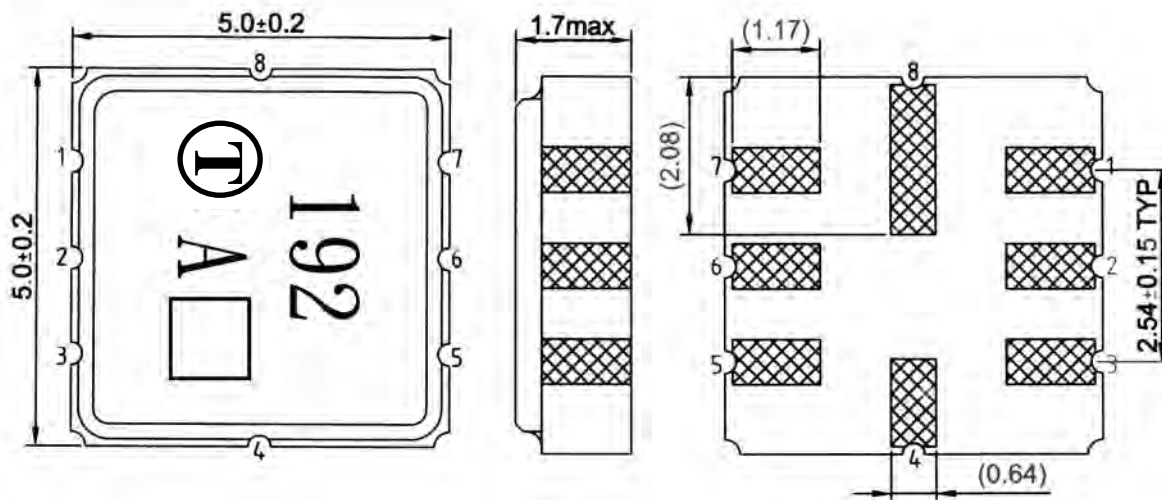

- #2 : Input
 - #6 : Output
 - #1、3、5、7 : Ground
 - #4、8 : Case Ground
 - : Date code
- Unit : mm

SAW Filter 426.1MHz
Part No: MA07760

Model: TA0192A
Rev No: 1

E. FREQUENCY CHARACTERISTICS:

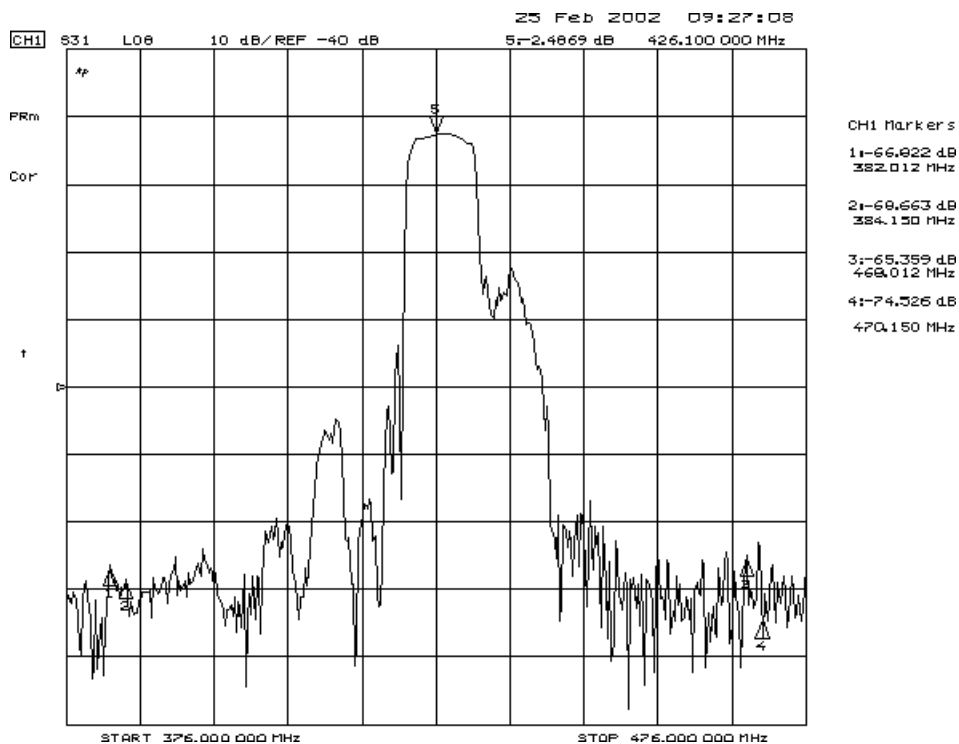
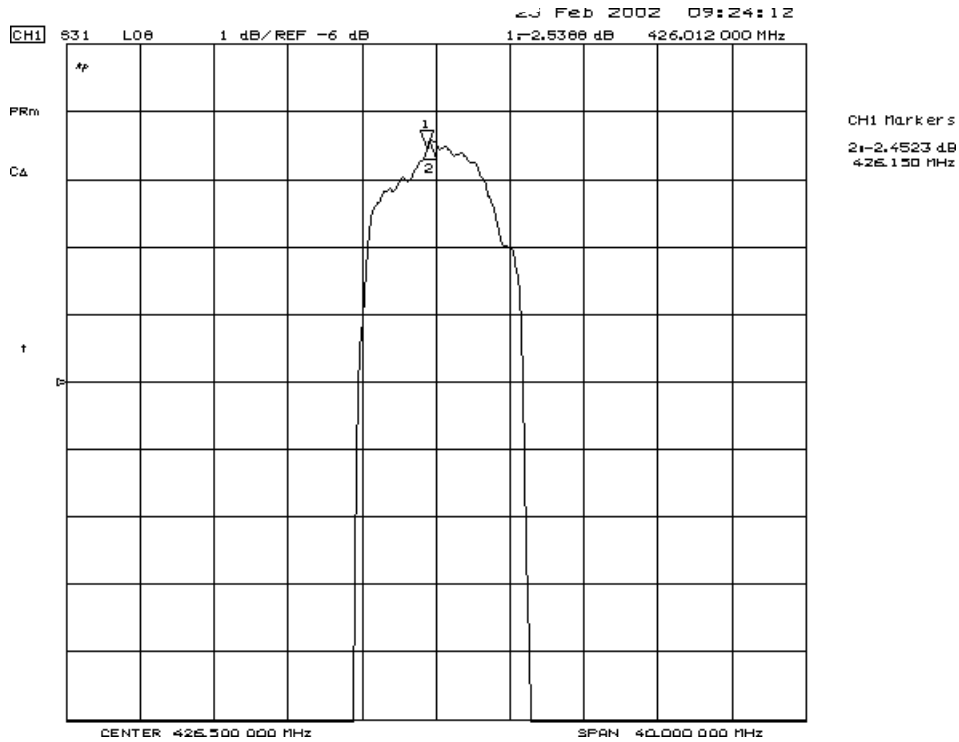

SAW Filter 426.1MHz
Part No: MA07760

Model: TA0192A
Rev No: 1

F. PACKING:

1. REEL DIMENSION

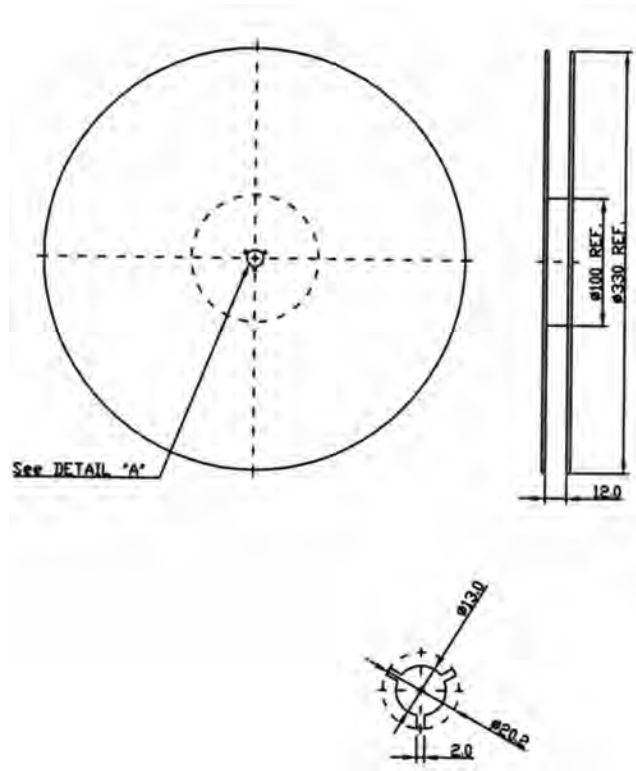

2. TAPE DIMENSION

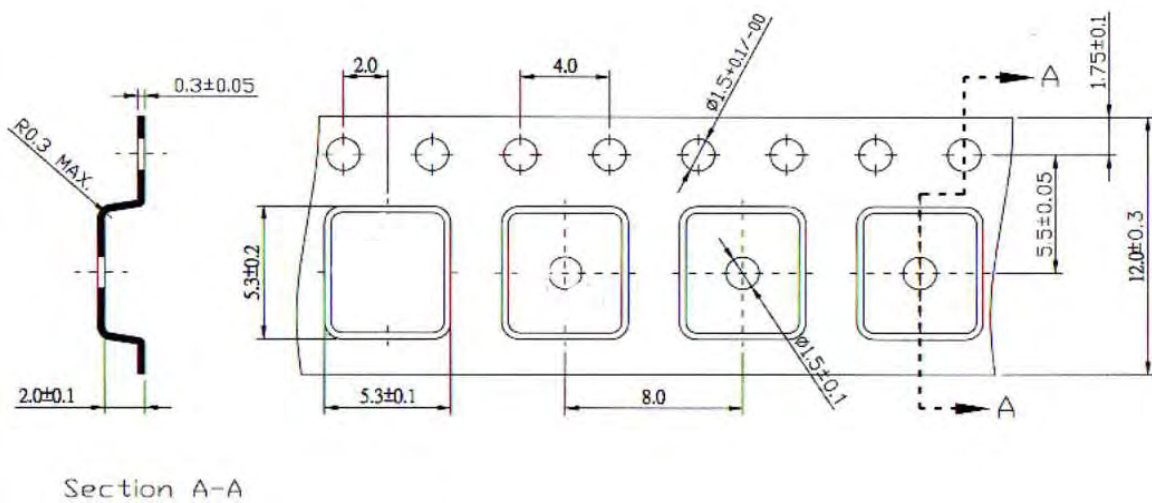

Section A-A