

**SAW Filter 326.40MHz**

**Model: TB0191A**

**Part No: MA08024**

**REV. NO.: 1**

**A. MAXIMUM RATING:**

1. Input Power Level: 10 dBm
2. Operate Temperature: -30°C to 80°C

**B. ELECTRICAL CHARACTERISTICS:**

Item	Unit	Min.	TST	Max.
Center frequency, <b>F<sub>c</sub></b>	MHz	-	326.4	-
Minimum Insertion Loss, <b>IL</b>	dB	-	12	17
2dB Lower Frequency	MHz		318.2	318.9
2dB Upper Frequency	MHz	333.9	335.0	-
2dB Bandwidth	MHz	15	16.8	-
40dB Lower Frequency	MHz	313.9	315.7	-
40dB Upper Frequency	MHz		338.0	338.9
40 dB Bandwidth	MHz	-	22.3	-
Input VSWR (318.9-333.9MHz)	-	-	1.3	2
Output VSWR (318.9-333.9MHz)	-	-	1.67	2
Group Delay ripple (318.9-333.9MHz)	nS	-	60	100
Amplitude ripple (323.9-328.9MHz)	dB	-	0.5	1
Attenuation:(Reference level from Min IL)				
10~276.4MHz	dB	50	60	60
276.4MHz~306.4MHz	dB	45	53	51
346.4MHz~376.4MHz	dB	45	56	56
376.4MHz~450MHz	dB	50	64	64

**SAW Filter 326.40MHz**

**Model: TB0191A**

**Part No: MA08024**

**REV. NO.: 1**

**C. TEST Circuit:**

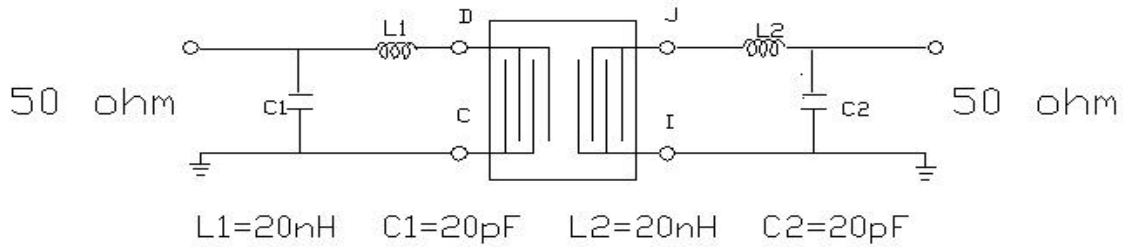

**D. OUTLINE DRAWING:**

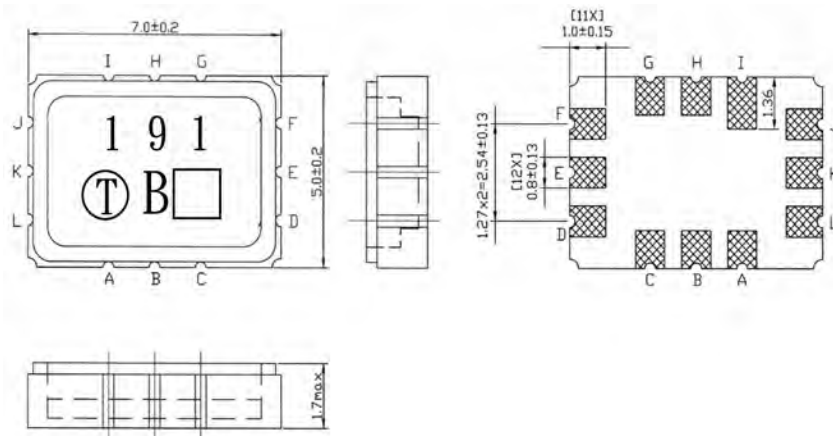

Pin D : Unbalanced Input  
 Pin J : Unbalanced Output  
 Pin A, B, C, E, F, G, H, I, K, L : To be Ground  
 Unit : mm

**E. PCB FOOTPRINT:**

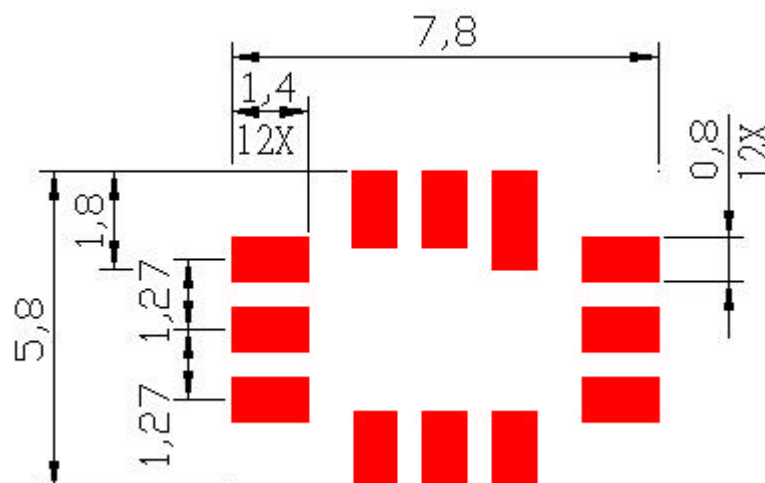

**SAW Filter 326.40MHz**

**Model: TB0191A**

Part No: **MA08024**

REV. NO.: 1

**F. FREQUENCY CHARACTERISTICS:**

(1) wide band of Response:

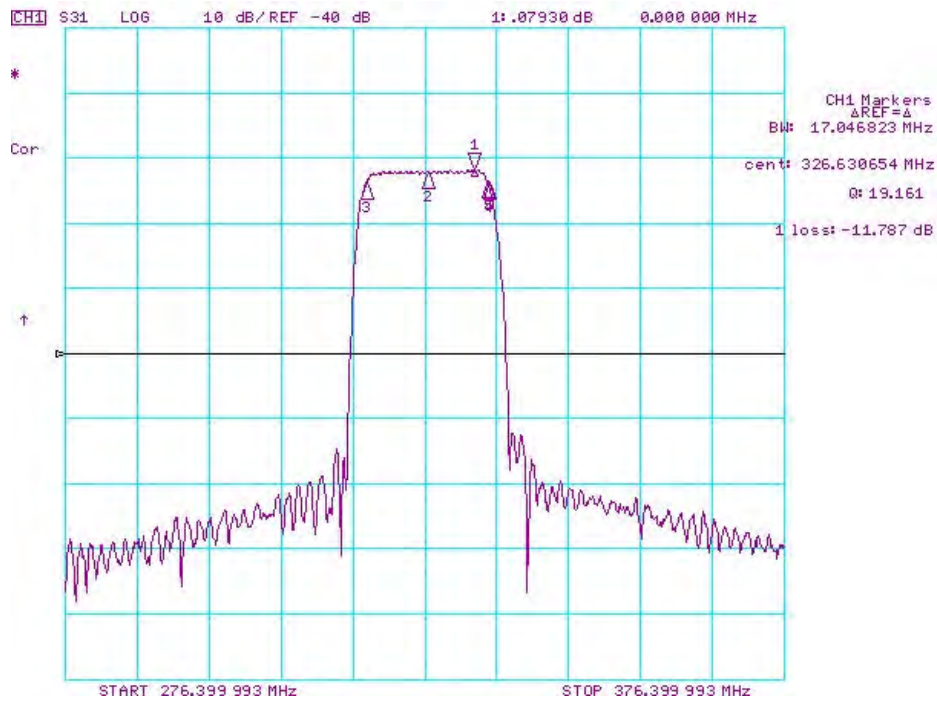

Fig-1 S21 Response Horizontal: 10MHz/Div Vertical: 10dB/Div

(2) Passband of Response:

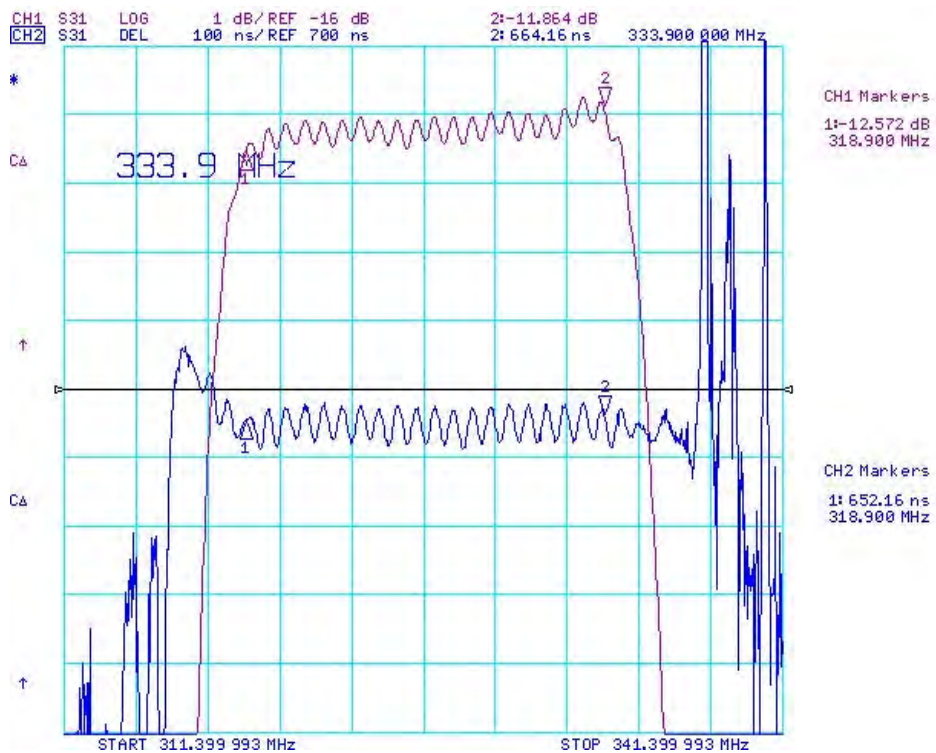

Fig-2 S21 Response Horizontal: 3MHz/Div Vertical: 1dB/Div 100ns/Div

**SAW Filter 326.40MHz**

**Model: TB0191A**

**Part No: MA08024**

**REV. NO.: 1**

**G. PACKING:**

**1. REEL DIMENSION**

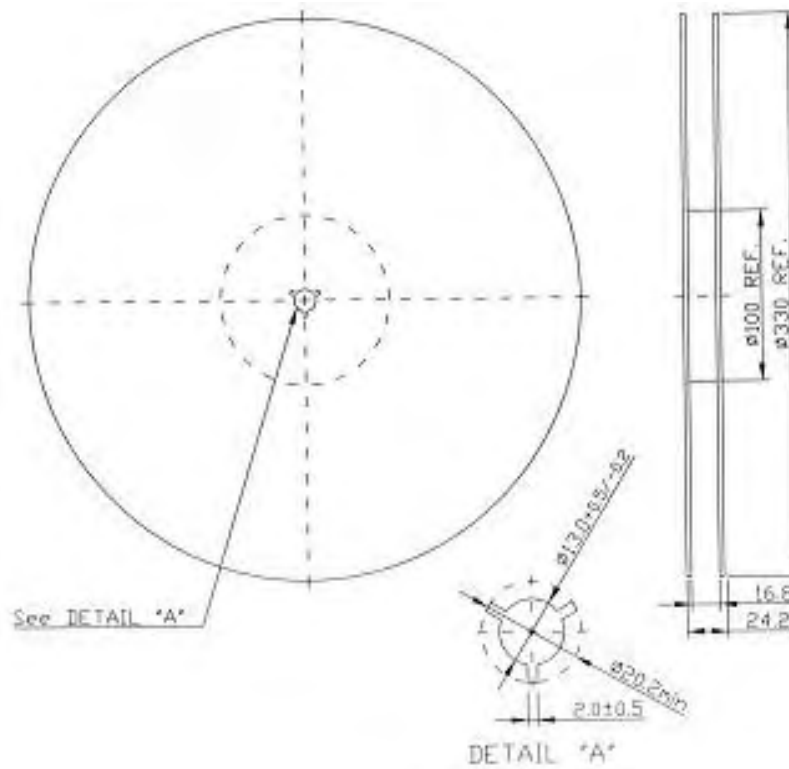

**2. TAPE DIMENSION**

