

400MHz SAW Filter

Model: TB0299A

Part No: MA08120

REV NO.: 1

A. MAXIMUM RATING:

1. Input Power Level : 0dBm
2. Operating Temperature: -40°C to 85°C
3. Storage Temperature: -40°C to 85°C

B. ELECTRICAL CHARACTERISTICS:

Item	Unit	Min.	Type.	Max.	Note
Center frequency, Fc	MHz	-	400	-	-
Insertion Loss, IL	dB	-	7.5	10	-
Passband width, BW3	MHz	4.5	7.3	-	-
Amplitude Ripple in Fc±1MHz	dB	-	0.8	1	-
Group delay ripple in Fc±1MHz	nS	-	70	100	-
Phase Linearity in Fc±1MHz	deg		1.7	4	
Attenuation:(Ref level from Min IL)					
10 MHz to 370 MHz	dB	35	38	-	-
370 MHz to 387 MHz	dB	30	33	-	-
413 MHz to 430 MHz	dB	30	32	-	-
430 MHz to 600 MHz	dB	35	40	-	-

C. MEASUREMENT CIRCUIT:

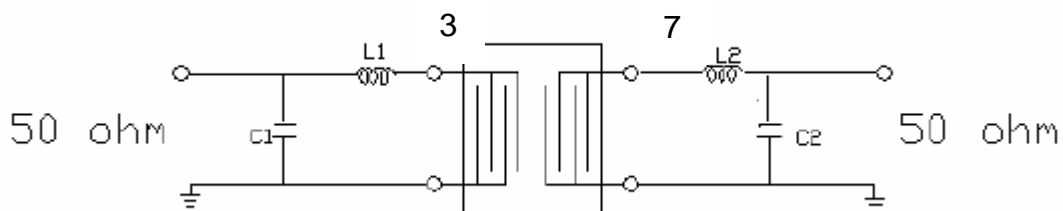

**Input L1=18nH, C1=12pF
 Output L2=18nH, C2=15pF**

400MHz SAW Filter
Part No: MA08120

Model: TB0299A
REV NO.: 1

D. FREQUENCY CHARACTERISTICS:

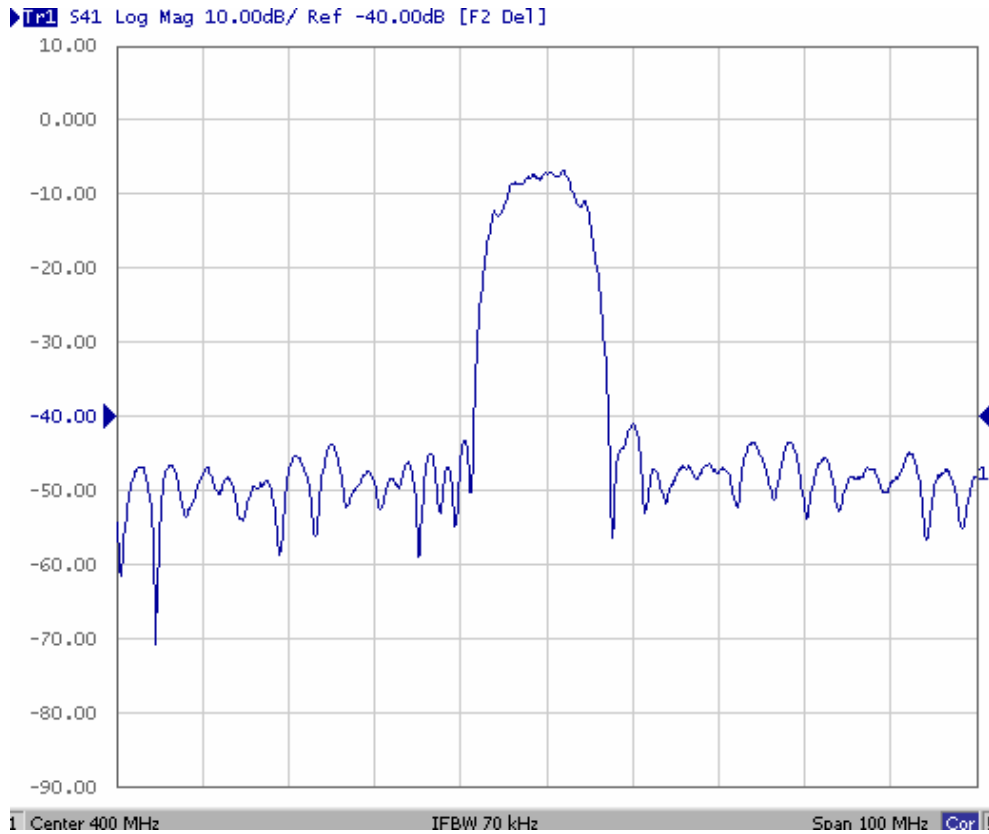

Fig-1 S21 Response Horizontal: 10MHz/Div. Vertical: 10dB/Div

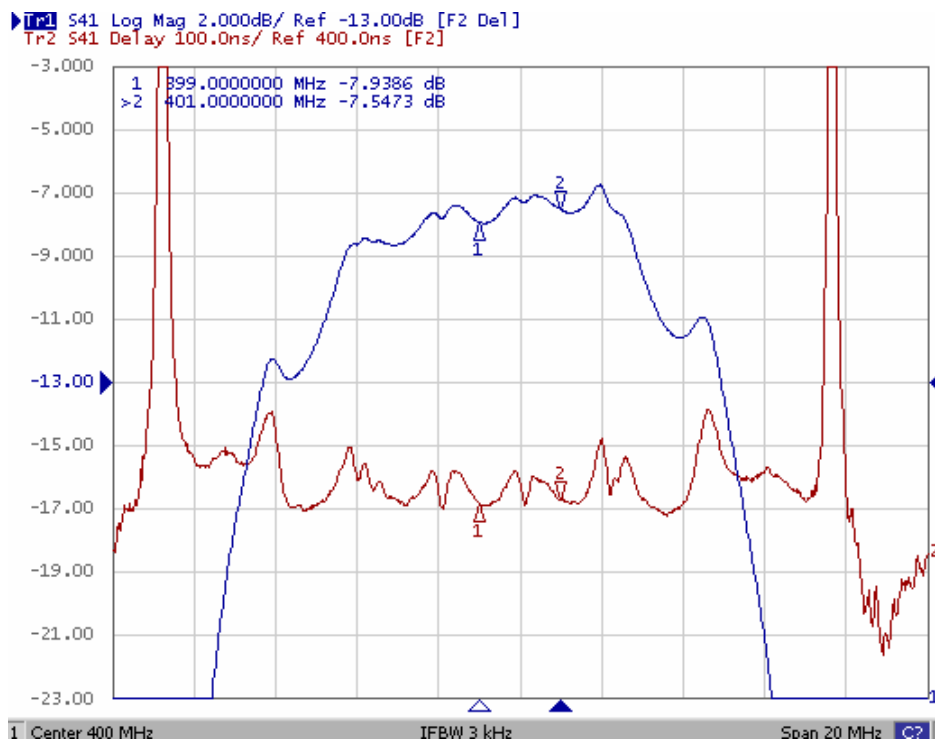
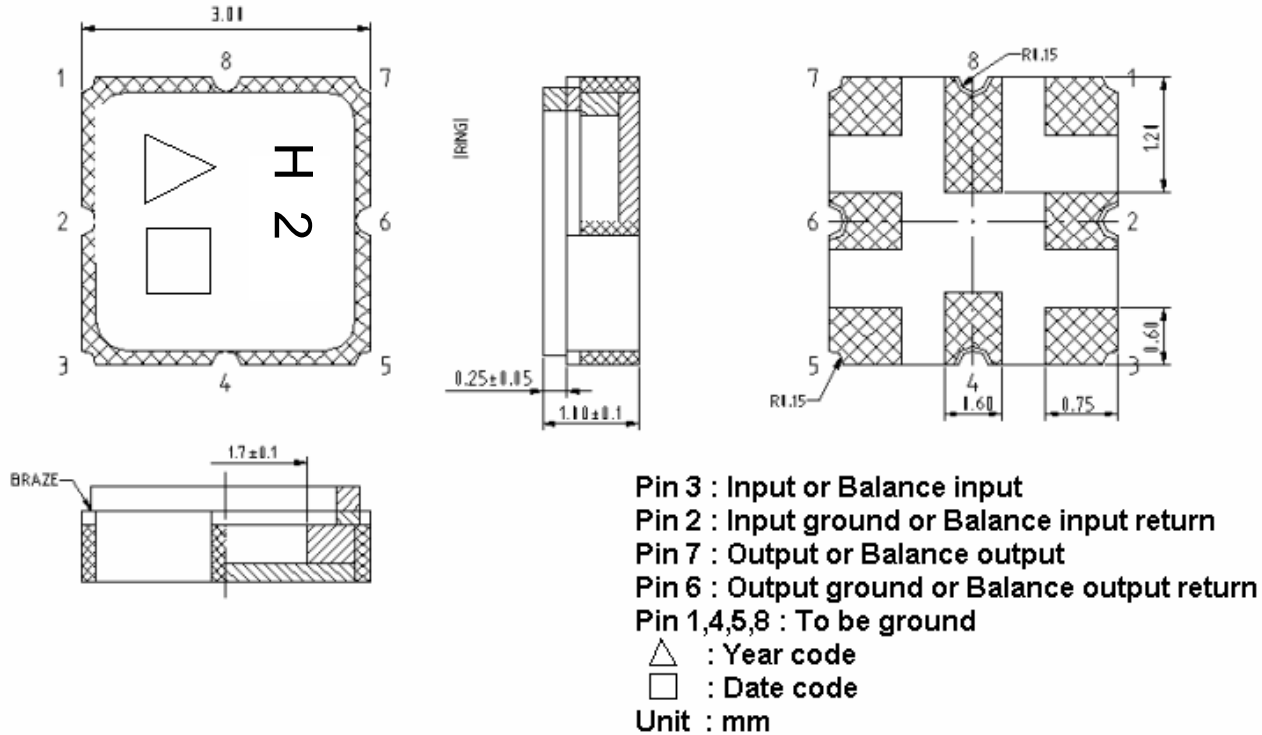

Fig-2 Horizontal: 2M Hz/Div Vertical: 2dB/Div. Vertical: 100ns/Div

400MHz SAW Filter
Part No: MA08120

Model: TB0299A
REV NO.: 1

E. OUTLINE DRAWING:



F. PCB FOOTPRINT

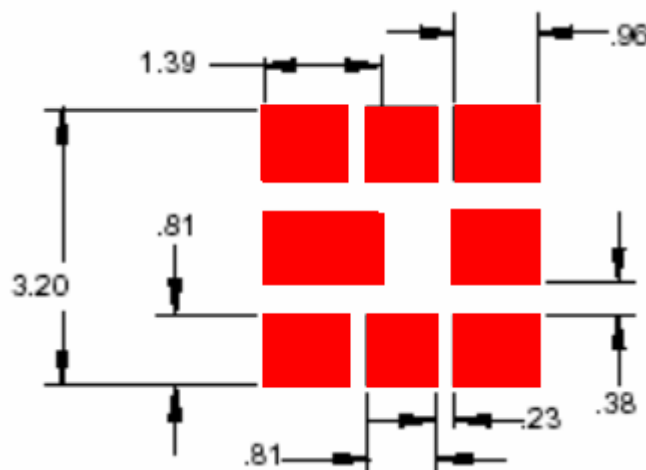

400MHz SAW Filter
Part No: MA08120

Model: TB0299A
REV NO.: 1

G. PACKING:

1. REEL DIMENSION

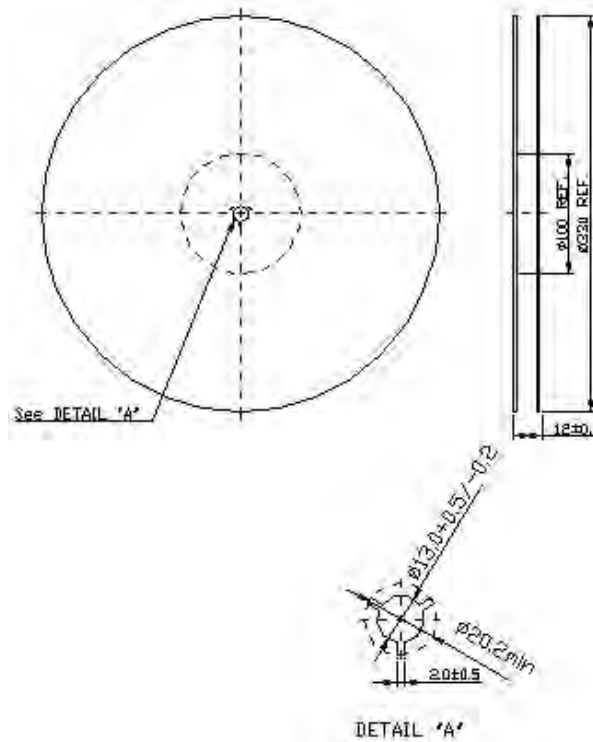

2. TAPE DIMENSION

