

SAW Filter 300.0MHz

Model: TB0296A

Part No: **MA08559**

REV. NO.: 1

A. MAXIMUM RATING:

1. Input Power Level: 0 dBm
2. Operating Temperature: -40°C to 85°C
3. Storage Temperature: -40°C to 85°C

B. ELECTRICAL CHARACTERISTICS:

Item	Unit	Min.	Type.	Max.	Note
Center frequency, Fc	MHz	-	300	-	-
Insertion Loss, IL	dB	-	8.3	10	-
Passband width, BW3	MHz	4.5	7.3	-	-
Amplitude Ripple in Fc±1MHz	dB	-	0.8	1	-
Group delay ripple in Fc±1MHz	nS	-	70	100	-
Phase Linearity in Fc±1MHz	deg		1.6	4	
Attenuation:(Reference level from Min IL)					
10 MHz to 270 MHz	dB	35	38	-	-
270 MHz to 287 MHz	dB	25	28	-	-
313 MHz to 330 MHz	dB	25	32	-	-
330 MHz to 500 MHz	dB	35	40	-	-

C. MEASUREMENT CIRCUIT:

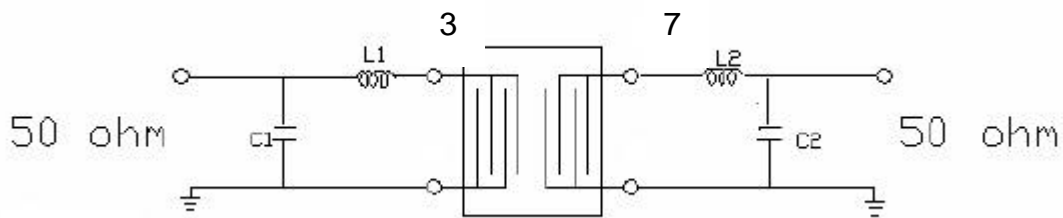

**Input L1=39nH, C1=20pF
 Output L2=47nH, C2=18pF**

SAW Filter 300.0MHz
Part No: **MA08559**

Model: TB0296A
REV. NO.: 1

C. FREQUENCY CHARACTERISTICS :

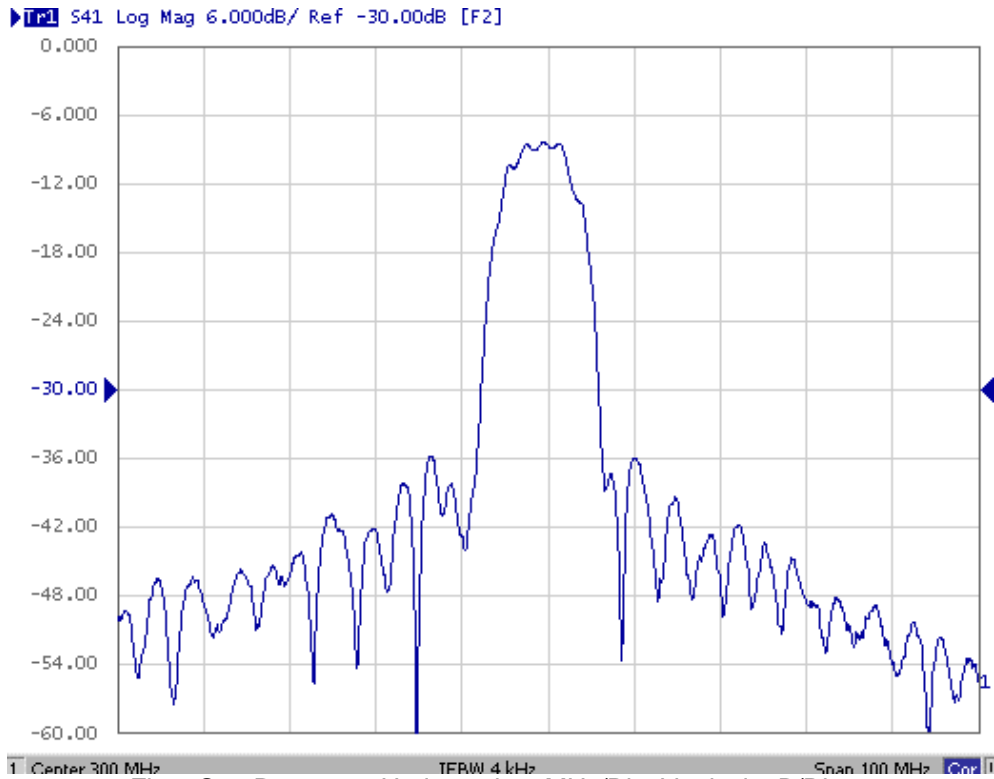

Fig-1 S21 Response Horizontal: 10MHz/Div. Vertical: 6B/Div

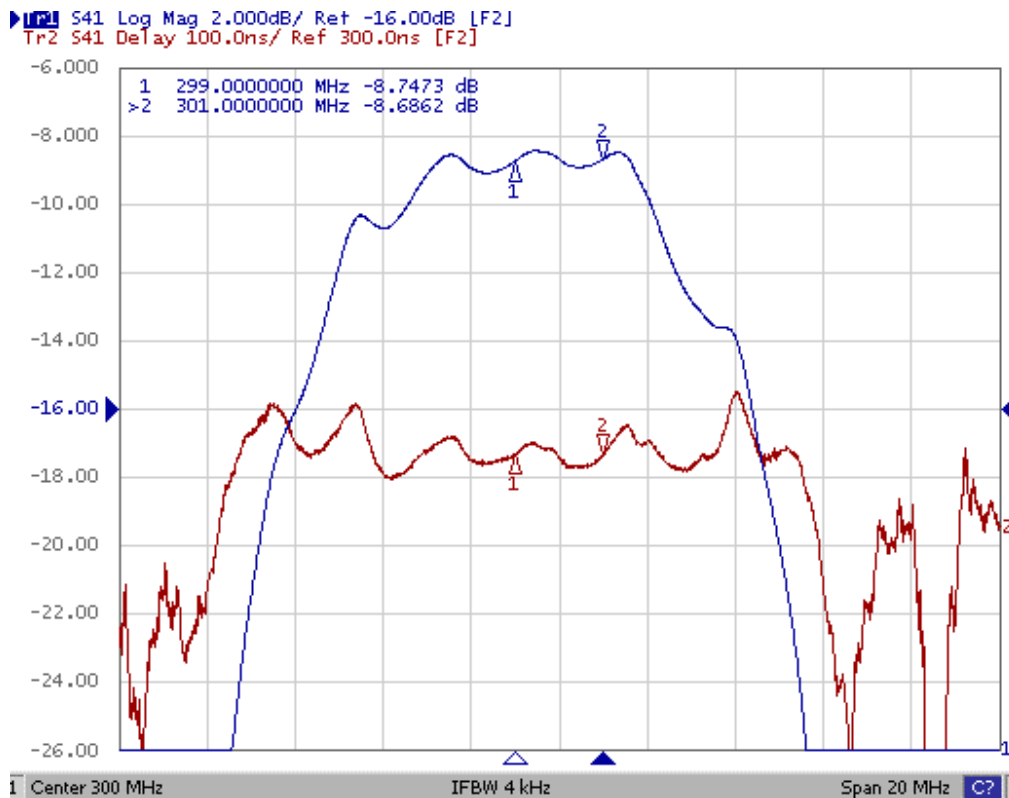
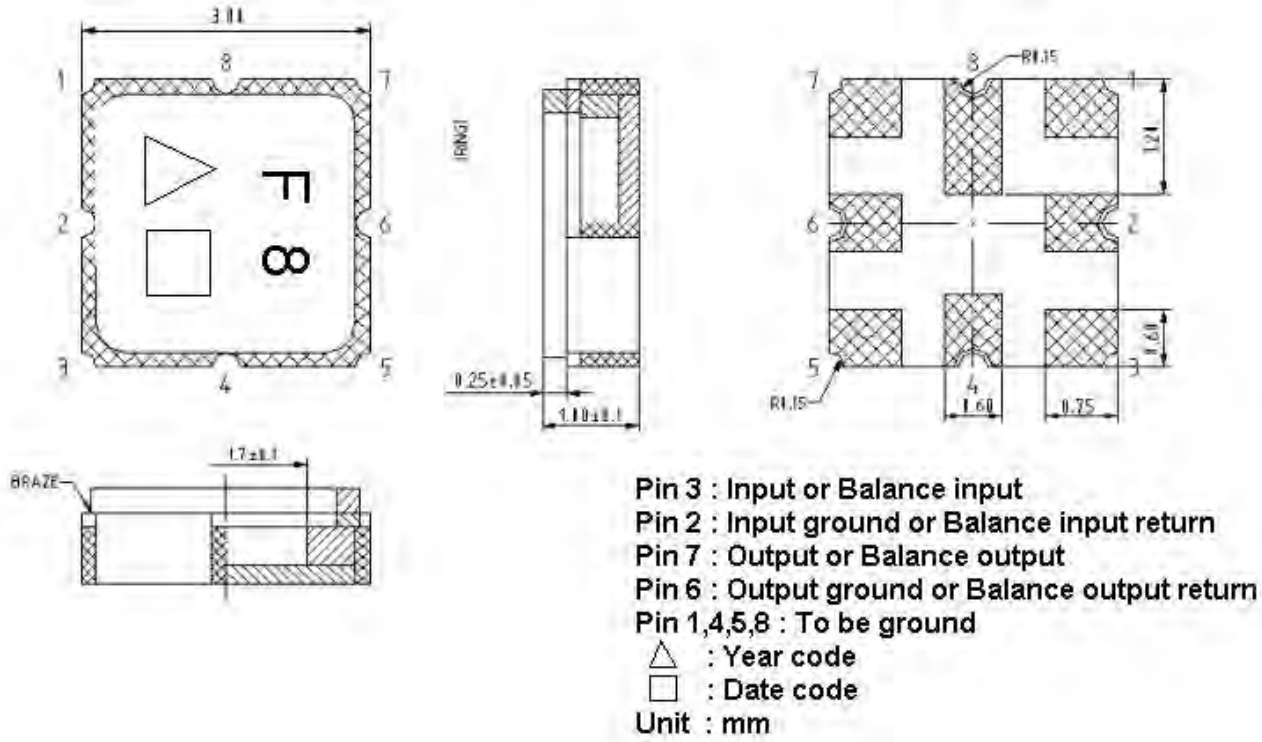

Fig-2 Horizontal: 2M Hz/Div Vertical: 2dB/Div. Vertical: 100Div

SAW Filter 300.0MHz
Part No: MA08559

Model: TB0296A
REV. NO.: 1

E. OUTLINE DRAWING:



F. PCB FOOTPRINT

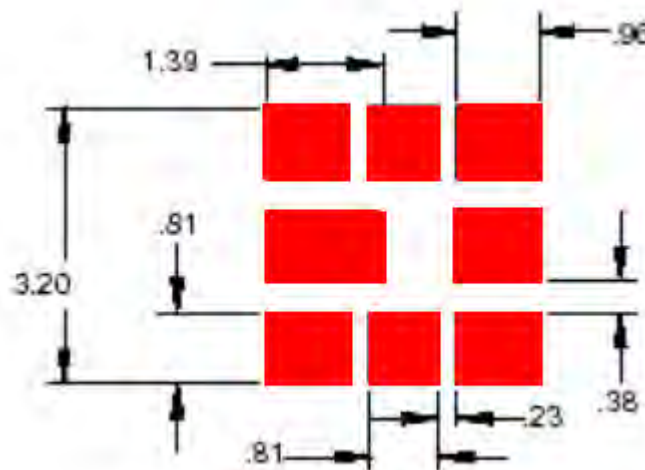

SAW Filter 300.0MHz

Model: TB0296A

Part No: MA08559

REV. NO.: 1

G. PACKING:

1. REEL DIMENSION

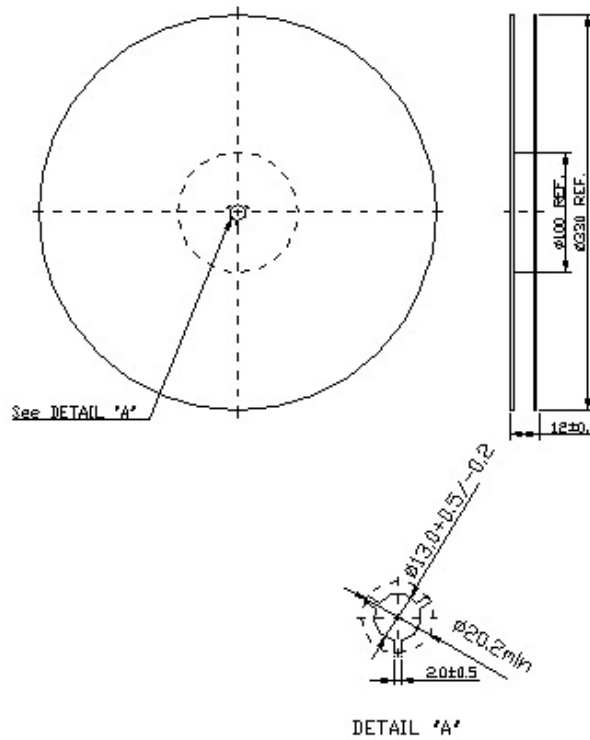

2. TAPE DIMENSION

