

SAW Filter 221.60MHz
Part No: MA08628

Model: TA0576A
Rev No: 2

A. MAXIMUM RATING:

1. Input Power Level: 15dBm
2. DC voltage: 5V
3. Operating Temperature: -40°C to +85°C
4. Storage Temperature: -40°C to +85°C

B. ELECTRICAL CHARACTERISTICS:

Item	Unit	Min.	Typ	Max.
Center frequency Fc	MHz	-	221.6	-
Minimum Insertion Loss IL min (reference level)	dB	-	1.95	3.0
Amplitude ripple 218.1 ~ 225.1MHz	dB	-	1.1	2.2
3dB Bandwidth BW -3dB	MHz	7	10	-
Attenuation (Reference level from IL min)				
10 ~ Fc -35MHz	dB	38	43	-
Fc +35 ~ 500MHz	dB	38	50	-
Source impedance Z _S	Ω	-	50	-
Load impedance Z _L	Ω	-	50	-

Note: IL min is the minimum of the pass band attenuation. The center frequency Fc is the mean value of the upper and lower frequencies at the 3dB filter attenuation level relative to the IL min.

C. MEASUREMENT CIRCUIT:

HP Network analyzer

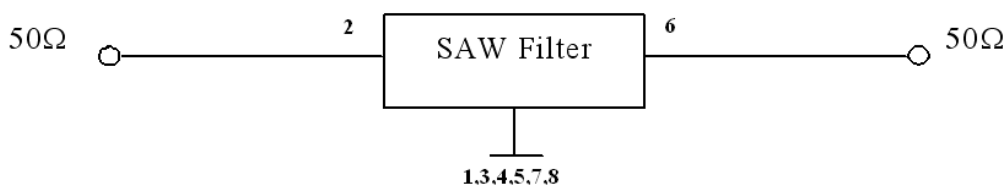

SAW Filter 221.60MHz
Part No: MA08628

Model: TA0576A
Rev No: 2

D. FREQUENCY CHARACTERISTICS:

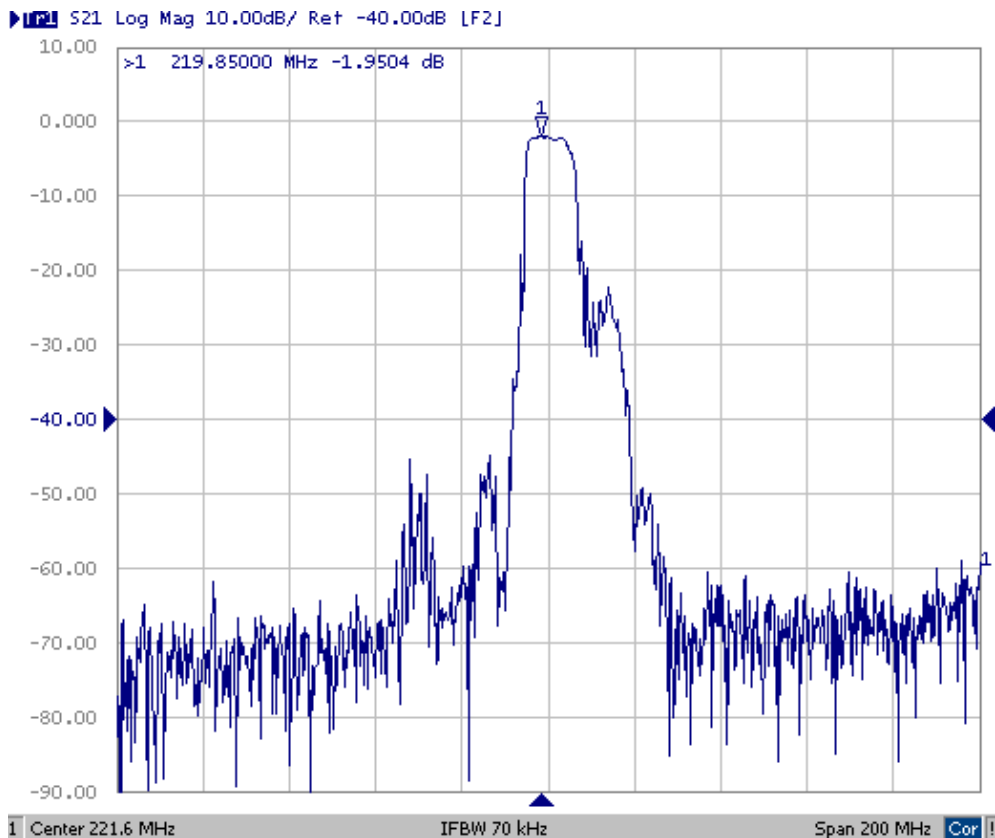
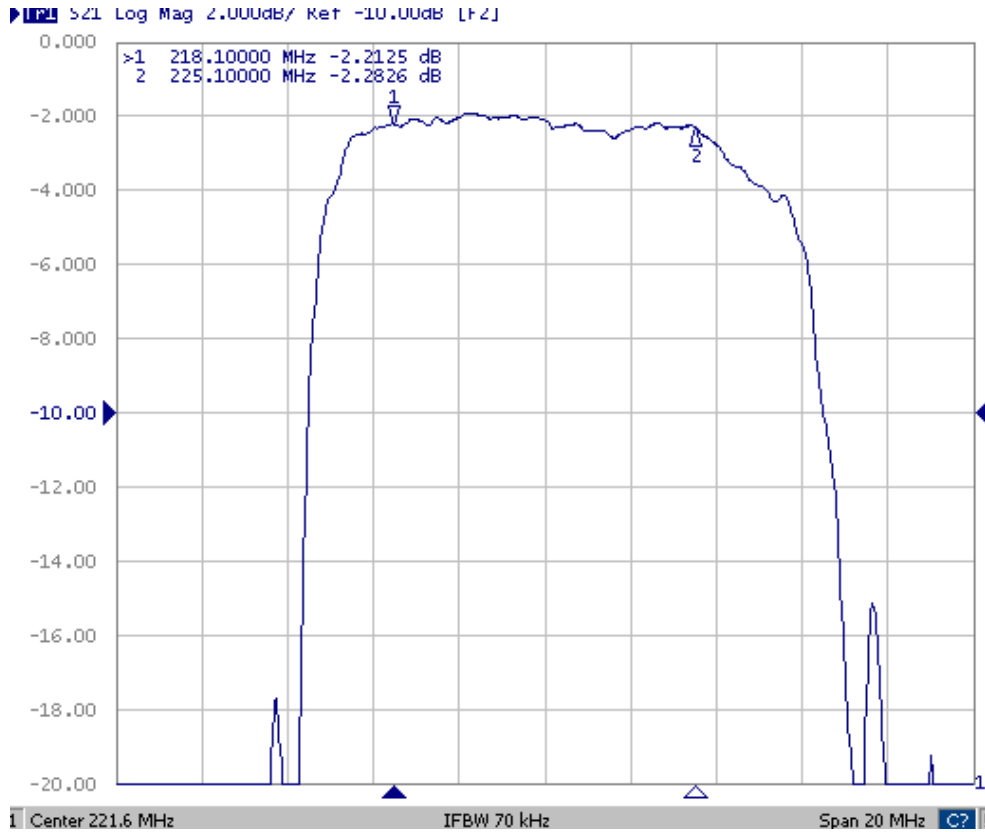

SAW Filter 221.60MHz

Model: TA0576A

Part No: MA08628

Rev No: 2

E. OUTLINE DRAWING:

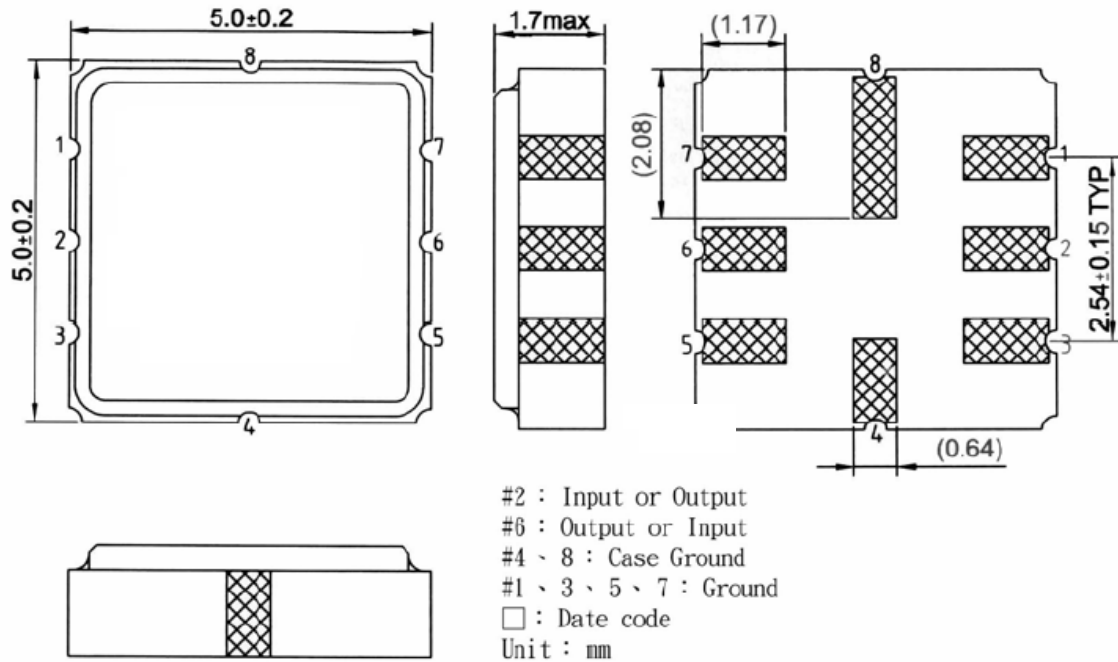

F. PCB FOOTPRINT:

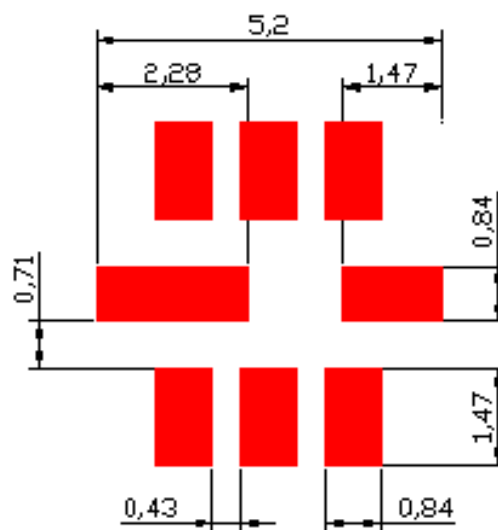

SAW Filter 221.60MHz
Part No: MA08628

Model: TA0576A
Rev No: 2

G. PACKING:

1. Reel Dimension 7" = 1000, 13" = 3000

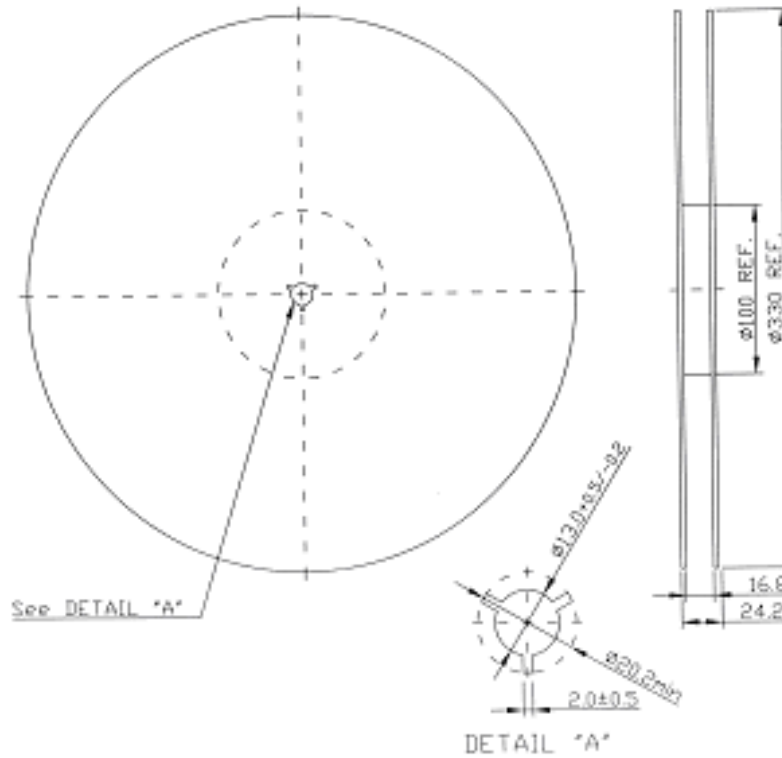

2. Tape Dimension

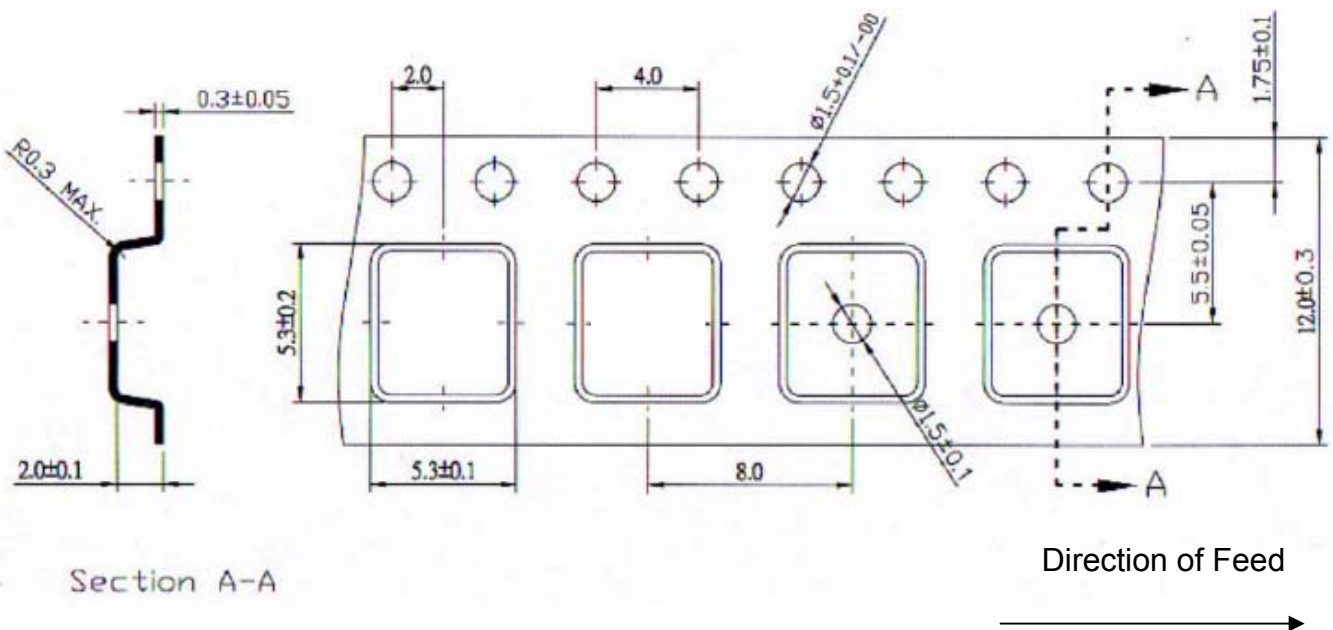

SAW Filter 221.60MHz
Part No: MA08628

Model: TA0576A
Rev No: 2

H. RECOMMENDED REFLOW PROFILE:

