

868.50MHz SAW Filter

Model: TA0538A

Part No: MA08872

REV NO.: 1

A. MAXIMUM RATING:

1. Input Power Level: 10 dBm
2. DC voltage: 5 V
3. Operating Temperature: -40°C to 85°C
4. Storage Temperature: -40°C to +85°C

B. CHARACTERISTICS:

Item				Min.	Typ.	Max.
Center frequency	Fc	MHz		-	868.5	-
Insertion loss	868 ~ 869.2 MHz	IL	dB	-	2.4	4.0
Amplitude ripple	868 ~ 869.2 MHz		dB	-	0.1	1.4
Attenuation (Reference level from 0dB)						
	10 ~ 800	MHz	dB	40	48	-
	800 ~ 838	MHz	dB	35	46	-
	905 ~ 915	MHz	dB	35	48	-
	915 ~ 970	MHz	dB	38	46	-
Source impedance	Zs		Ω	-	50	-
Load impedance	ZL		Ω	-	50	-

Note1. No matching network required for operation at 500

868.50MHz SAW Filter

Model: TA0538A

Part No: MA08872

REV NO.: 1

C. TRANSFER FUNCTION:

Widek

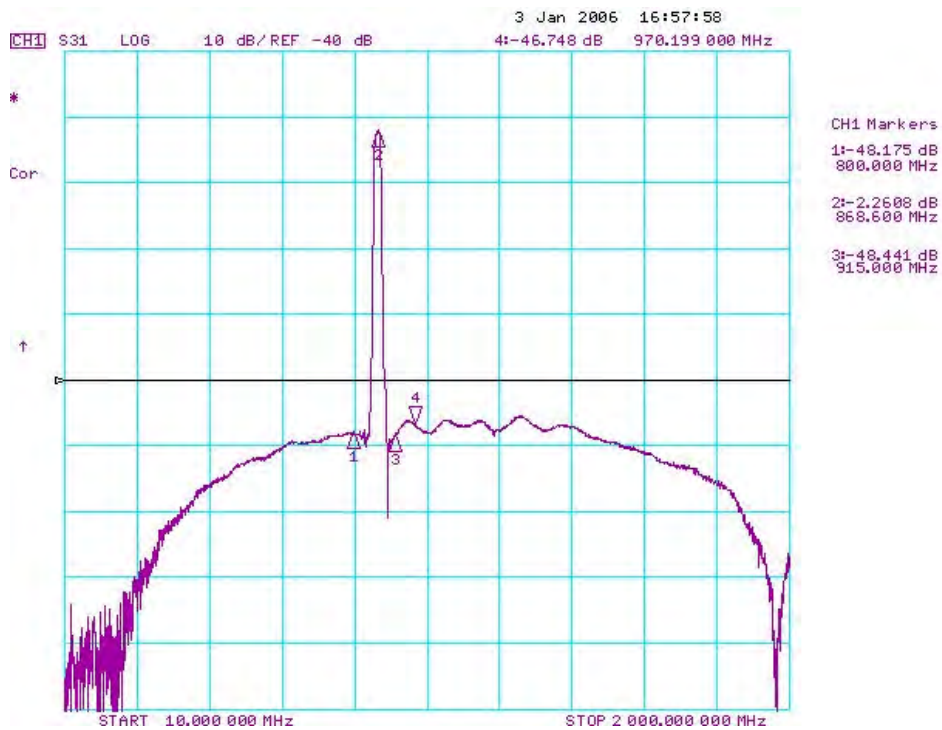
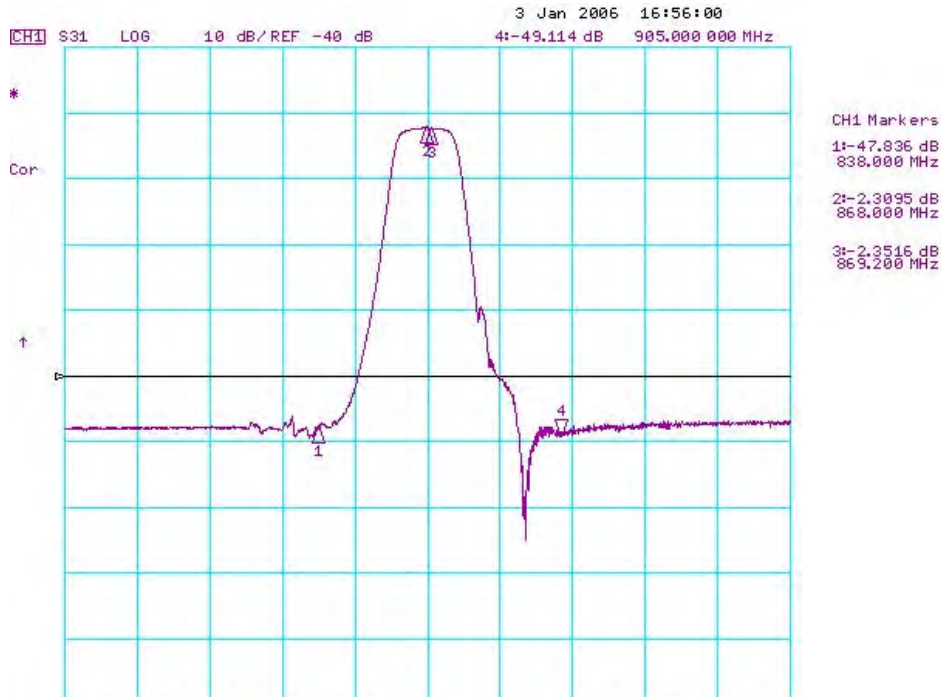

868.50MHz SAW Filter

Model: TA0538A

Part No: MA08872

REV NO.: 1

D. MEASUREMENT CIRCUIT:

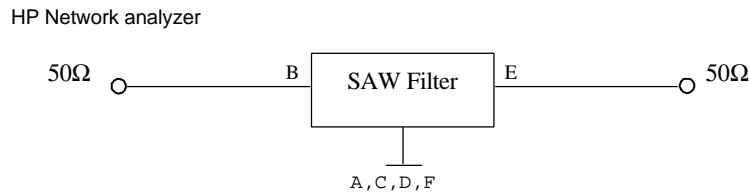

E. OUTL

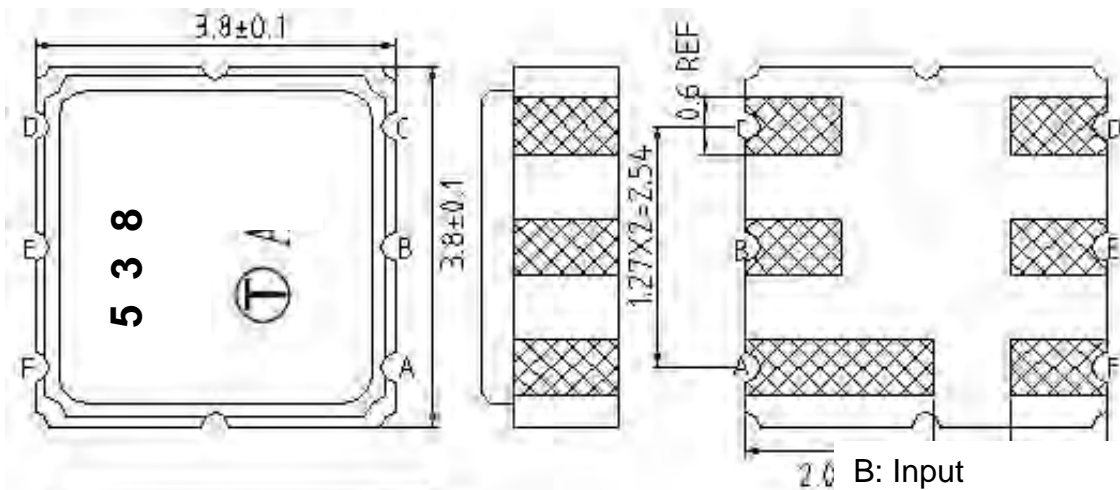

F.

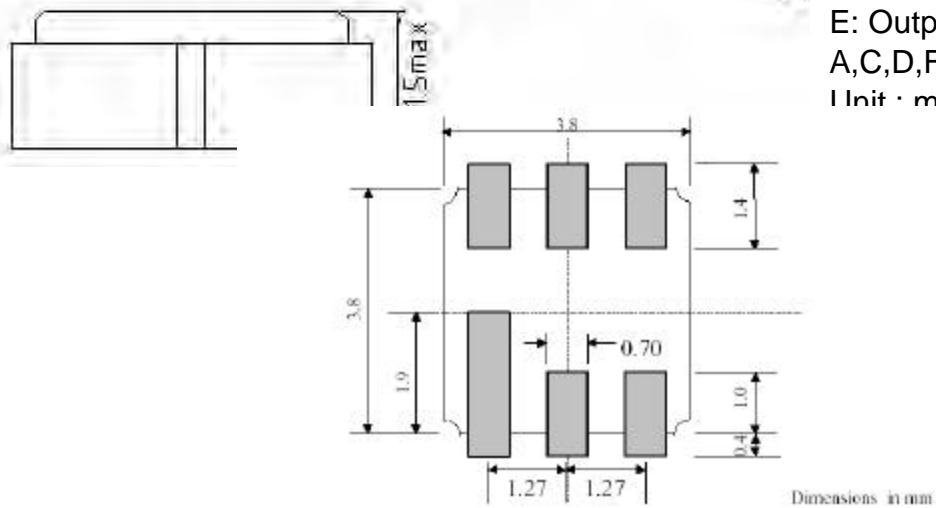

868.50MHz SAW Filter

Model: TA0538A

Part No: MA08872

REV NO.: 1

G. PACKING:

1. REEL DIMENSION

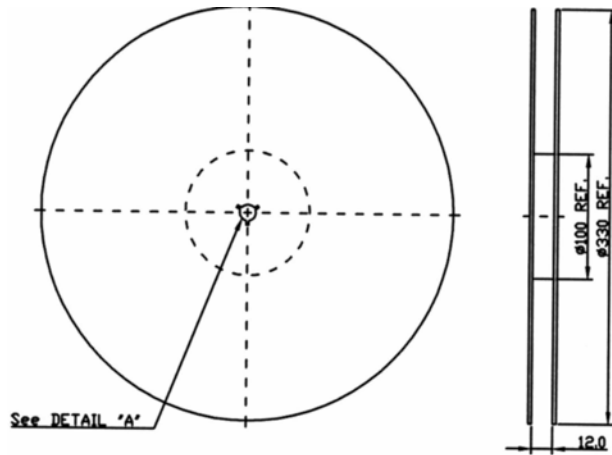

2. TAPE DIMENSION

