

**SAW Filter 164.1750MHz**

**Model: TB0482A**

**Part No: MA08915**

**REV. NO.: 1**

**A. MAXIMUM RATING:**

1. Input Power Level: 15 dBm
2. DC Voltage : 5V
3. Operating Temperature: -40°C to +85°C
4. Storage Temperature: -50°C to +95°C

**B. ELECTRICAL CHARACTERISTICS:**

Item	Unit	Min.	Typ.	Max.	Note
Center frequency Fc	MHz	-	164.175	-	-
Insertion loss at center frequency ILc	dB	-	3.6	7.0	-
Ripple (164.17125 ~ 164.17875 MHz)	dB	-	±0.3	±1	-
Attenuation (relative to ILc)					
163.175 ~ 163.2775 MHz	dB	30	50	-	-
163.2775 ~ 164.075 MHz	dB	7	20	-	-
164.275 ~ 165.0725 MHz	dB	7	20	-	-
165.0725 ~ 165.175 MHz	dB	30	50	-	-
Temperature coefficient of frequency TCf		-0.034 ppm/C <sup>2</sup>			

Note1. Considering -20 KHz frequency shift from -40°C to +85°C

**SAW Filter 164.1750MHz**

**Model: TB0482A**

**Part No: MA08915**

**REV. NO.: 1**

**C. OUTLINE DRAWING:**

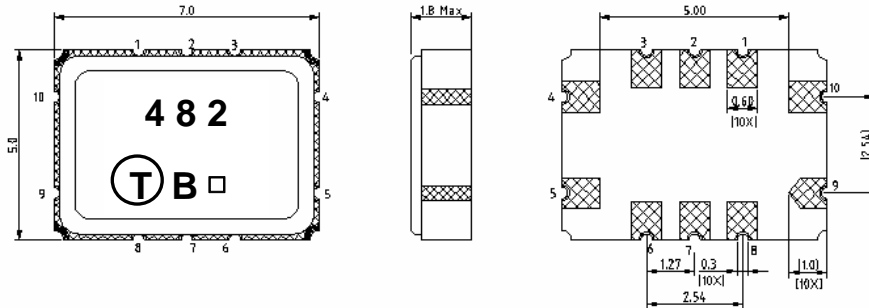

**Pin configuration**

- #9 Input
  - #4 Output
  - #10 Balance input or input ground
  - #5 Balance output or output ground
  - #1,2,3,6,7,8 To be grounded
- Unit mm

**D. MEASUREMENT CIRCUIT:**

50 Ohm Test circuit ( single-ended / single-ended )

HP Network analyzer

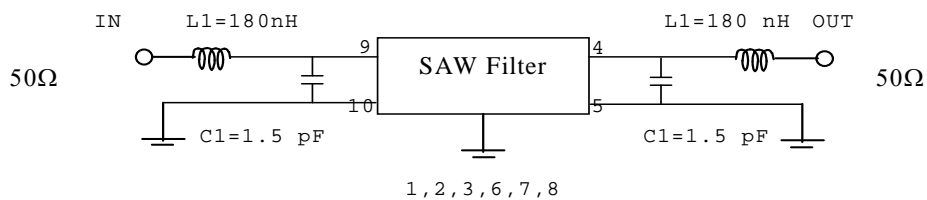

**E. PCB FOOTPRINT:**

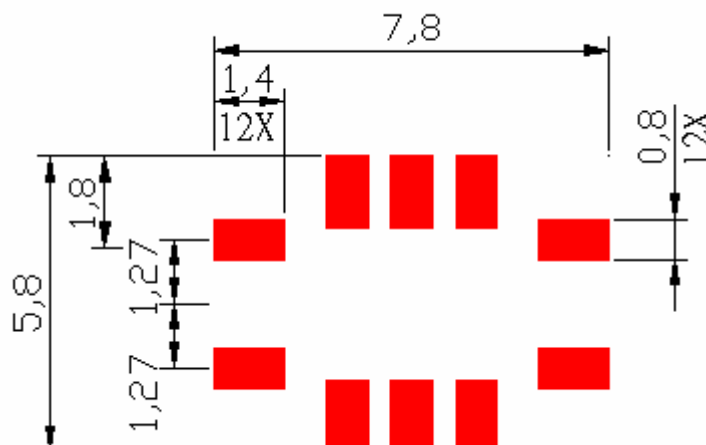

**SAW Filter 164.1750MHz**  
**Part No: MA08915**

**Model: TB0482A**  
**REV. NO.: 1**

**F. FREQUENCY CHARACTERISTICS:**

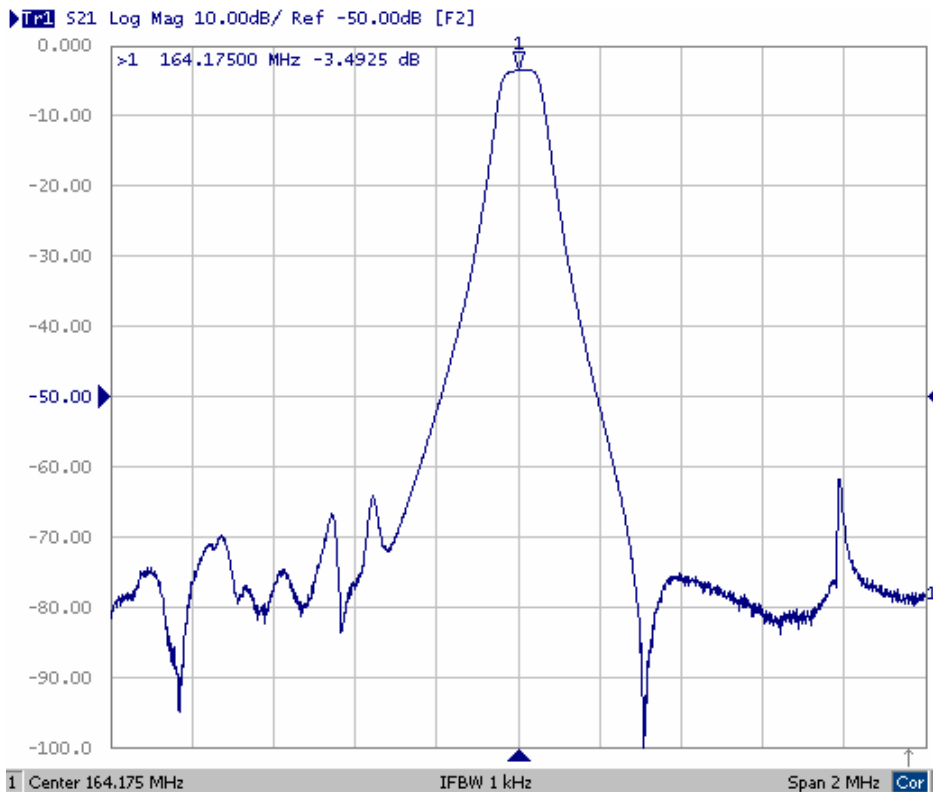
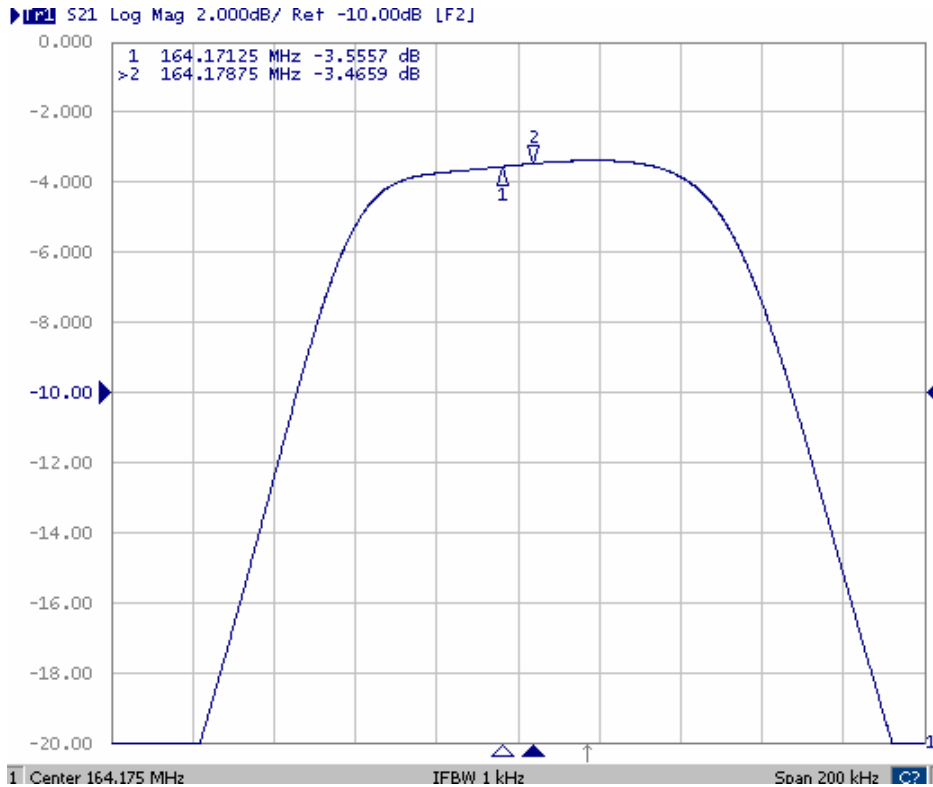

**SAW Filter 164.1750MHz**  
**Part No: MA08915**

**Model: TB0482A**  
**REV. NO.: 1**

**G. PACKING:**

**1. REEL DIMENSION**

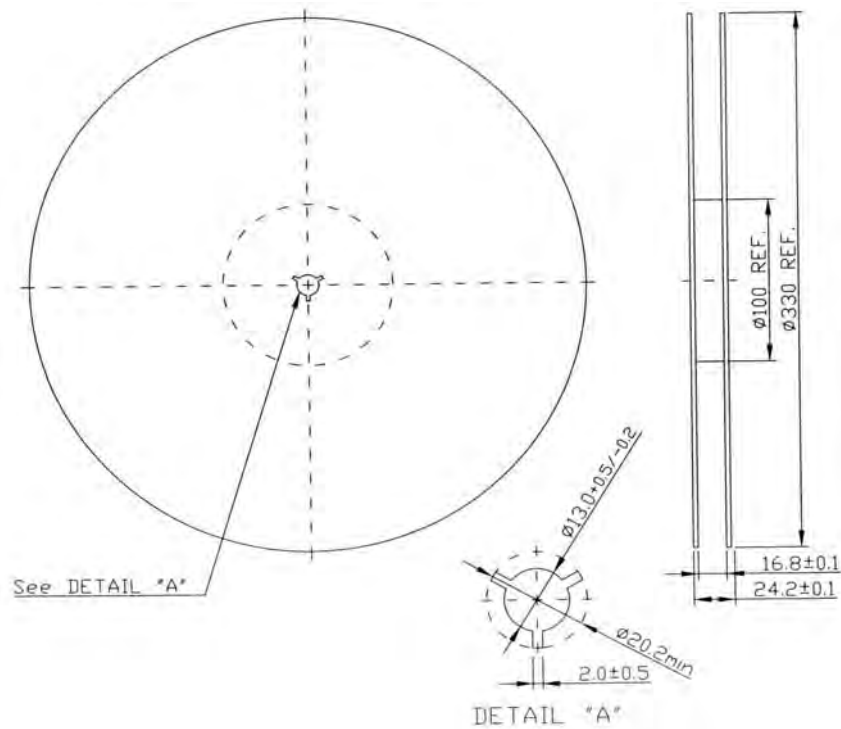

**2.TAPE DIMENSION**

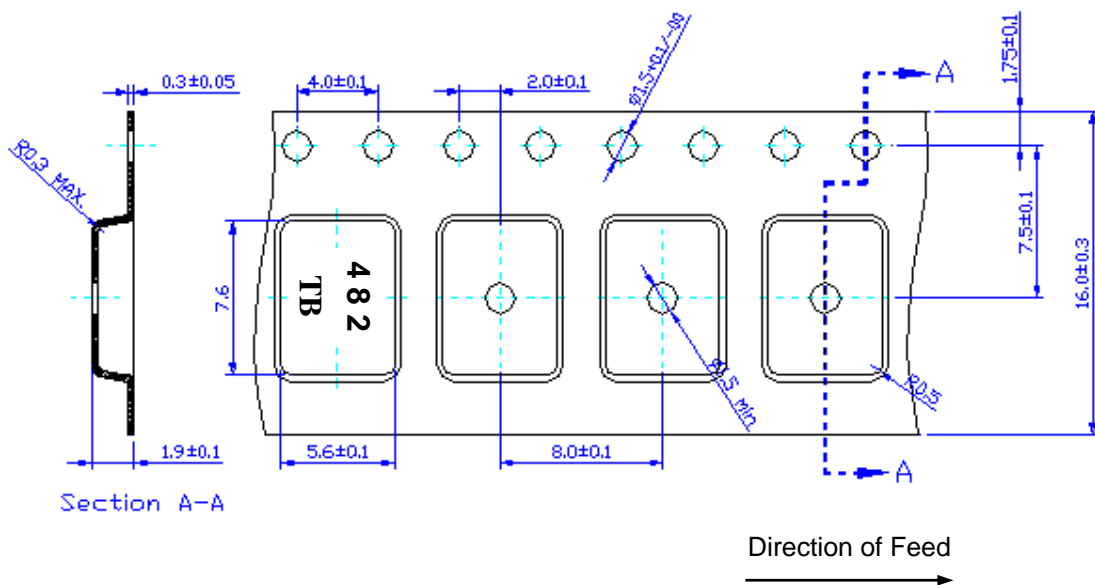

**SAW Filter 164.1750MHz**

**Model: TB0482A**

**Part No: MA08915**

**REV. NO.: 1**

**H. RECOMMENDED REFLOW PROFILE :**

