

366.50MHz SAW Filter

Model: **TB0489A**

Part No: **MA08949**

REV NO.: 1

A. MAXIMUM RATING:

1. Operating Temperature: -20 °C ~ 70 °C
2. Storage Temperature: -40 °C ~ +85 °C

B. CHARACTERISTICS:

Characteristics	Value			Note
	Min.	Typ.	Max.	
Center frequency F_C MHz	-	366.5	-	-
Minimum Insertion loss I.L. dB	-	12.5	13.5	-
3dB BW MHz	23	27	-	-
Amplitude Ripple ($F_C \pm 10.5\text{MHz}$) dB	-	0.6	1.0	-
Relative Rejection (Reference to Minimum Insertion loss)				
$F_C \pm 33.5\text{MHz}$ dB	30	42	-	-
$F_C \pm 55.5\text{MHz}$ dB	45	52	-	-
Temp Coefficient ppm/K	-	-94	-	-

Matching:

1. The input of the filter will be matched to 50 ohm
2. The output of the filter will be matched to 50 ohm

366.50MHz SAW Filter
Part No: MA08949

Model: TB0489A
REV NO.: 1

C.FREQUENCY CHARACTERISTICS:

(1) S21 Response:(span 200MHz)

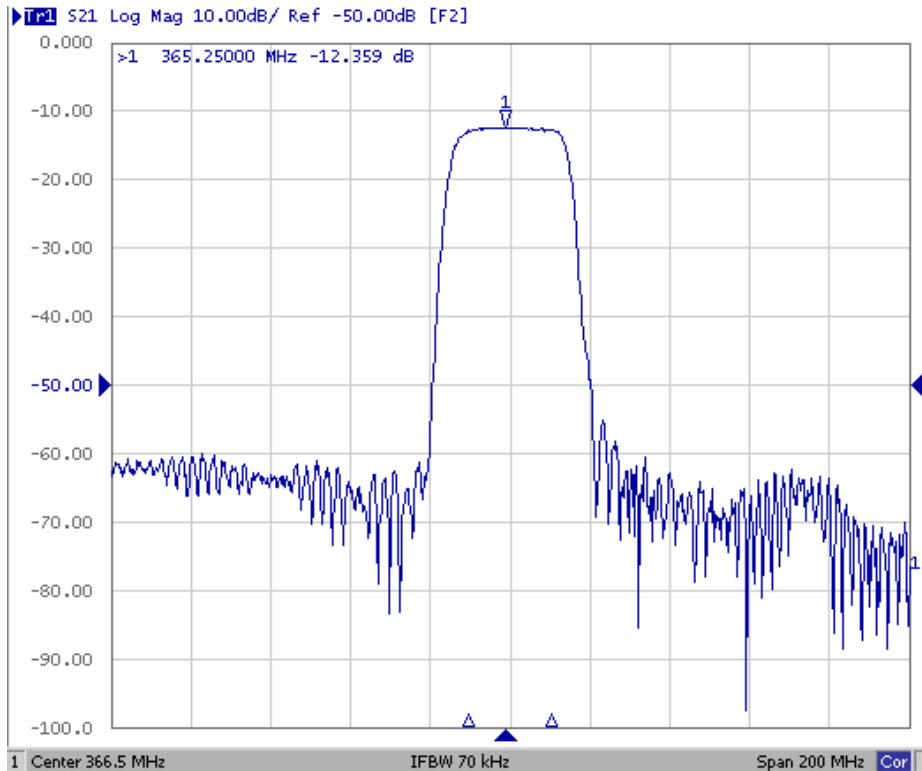

(2) Passband of Response: (span: 40MHz)

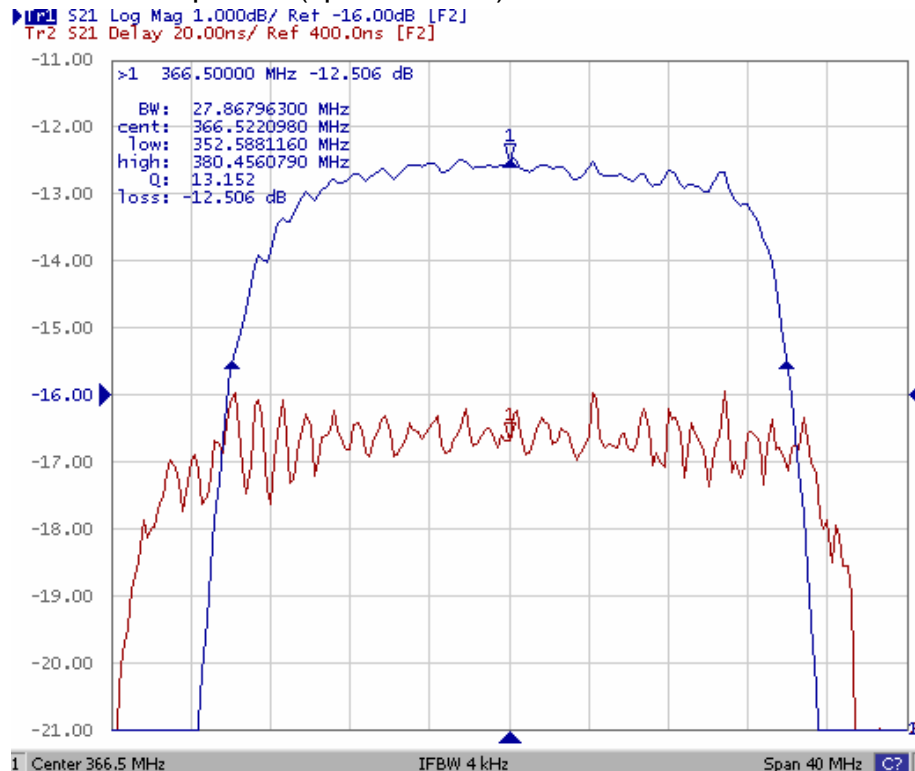

366.50MHz SAW Filter

Model: **TB0489A**

Part No: **MA08949**

REV NO.: 1

D. TEST CIRCUIT:

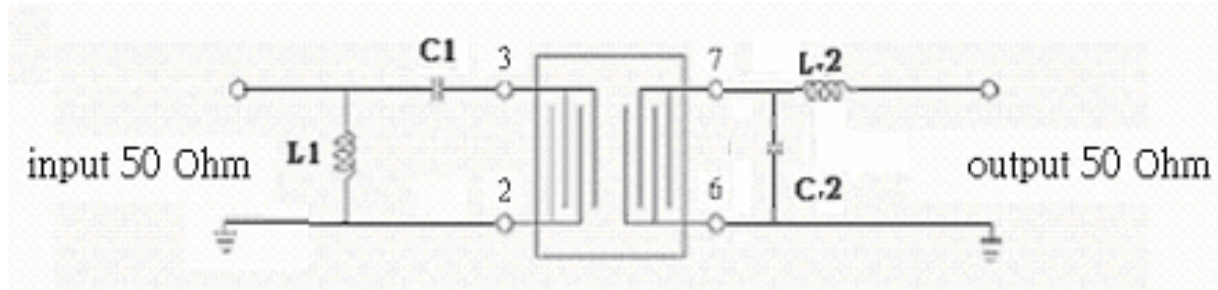

L1=27nH, C1=18pF, L2=10nH, C2=10pF

E. OUTLINE DRAWING:

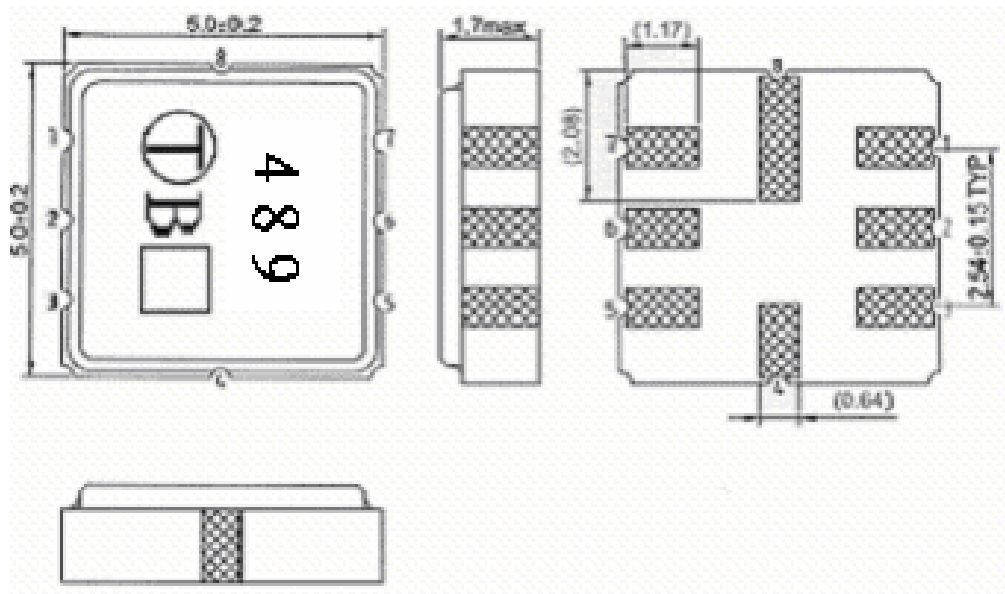

- Pin 1: RF input
- Pin 5: RF output
- Pin 4,8: Case Ground
- Pin 2,3,6,7: Ground
- Unit : mm

366.50MHz SAW Filter
Part No: **MA08949**

Model: **TB0489A**
REV NO.: 1

F. PACKING:

1. REEL DIMENSION

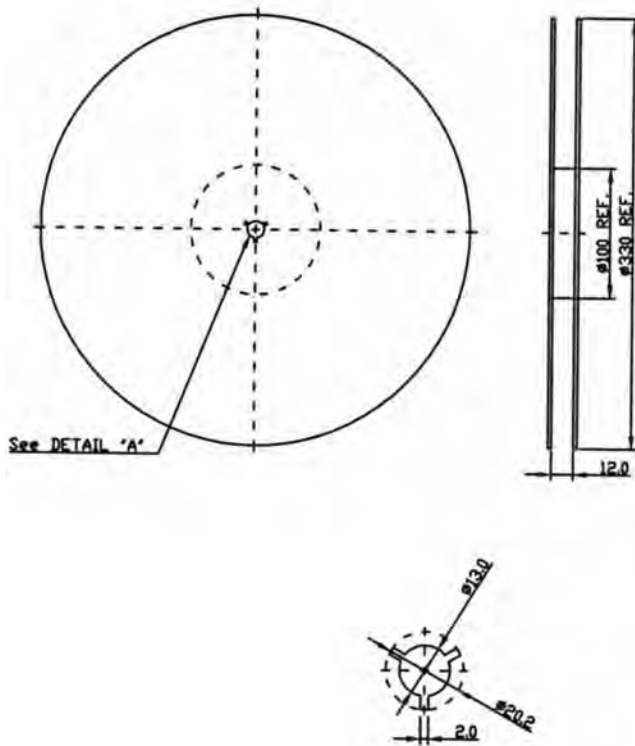

2. TAPE DIMENSION

