

600.0MHz SAW Filter
Part No: MA08996

Model: TB0353A
REV NO.: 1

A. MAXIMUM RATING:

1. Input Power Level : 0 dBm
2. Operating Temperature: -40°C to 85°C
3. Storage Temperature: -40°C to 85°C

B. ELECTRICAL CHARACTERISTICS:

Item	Unit	Min.	Type.	Max.	Note
Center frequency, Fc	MHz	-	600	-	-
Insertion Loss, IL	dB	-	9	10	-
Passband width, BW3	MHz	4.5	8.3	-	-
Amplitude Ripple in $F_{c\pm 1MHz}$	dB	-	0.75	1	-
Group delay ripple in $F_{c\pm 1MHz}$	nS	-	80	100	-
Phase Linearity in $F_{c\pm 1MHz}$	deg		2.5	4	
Attenuation:(Ref level from Min IL)					
10 MHz to 604.5 MHz	dB	35	41	-	-
604.5 MHz to 629.5 MHz	dB	30	37	-	-
659.5 MHz to 684.5 MHz	dB	30	35	-	-
684.5 MHz to 900 MHz	dB	35	37	-	-

C. MEASUREMENT CIRCUIT:

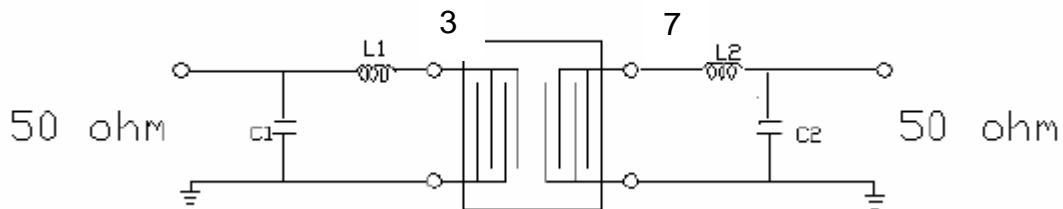

Input L1=4.7nH, C1=10pF
Output L2=6.8nH, C2=10pF

600.0MHz SAW Filter
Part No: MA08996

Model: TB0353A
REV NO.: 1

D. FREQUENCY CHARACTERISTICS:

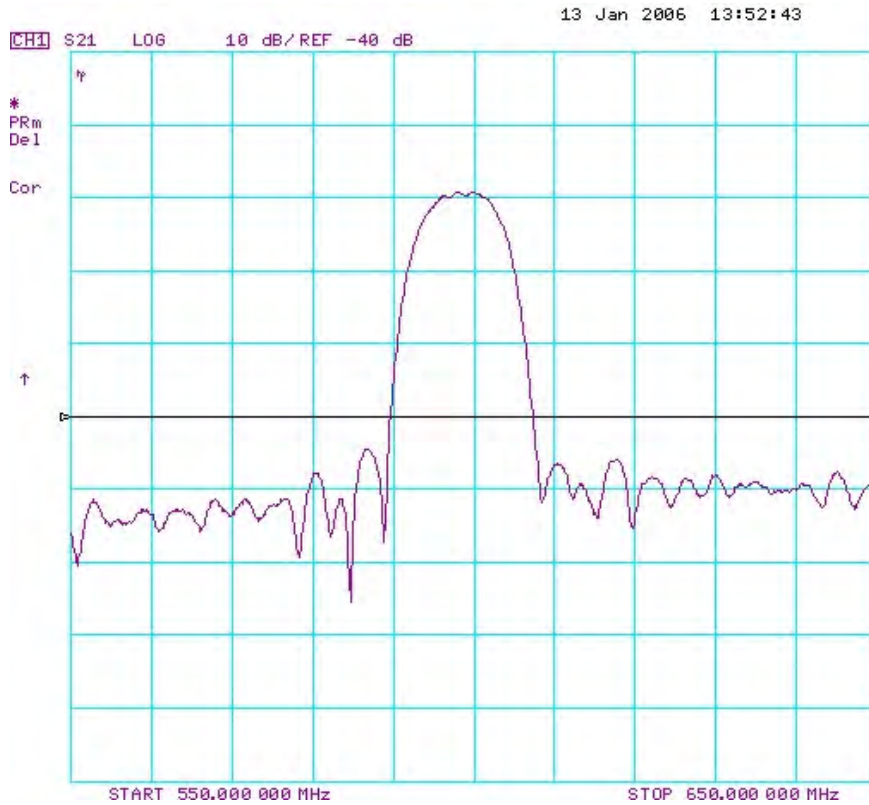

Fig-1 S21 Response Horizontal: 10MHz/Div. Vertical: 10dB/Div

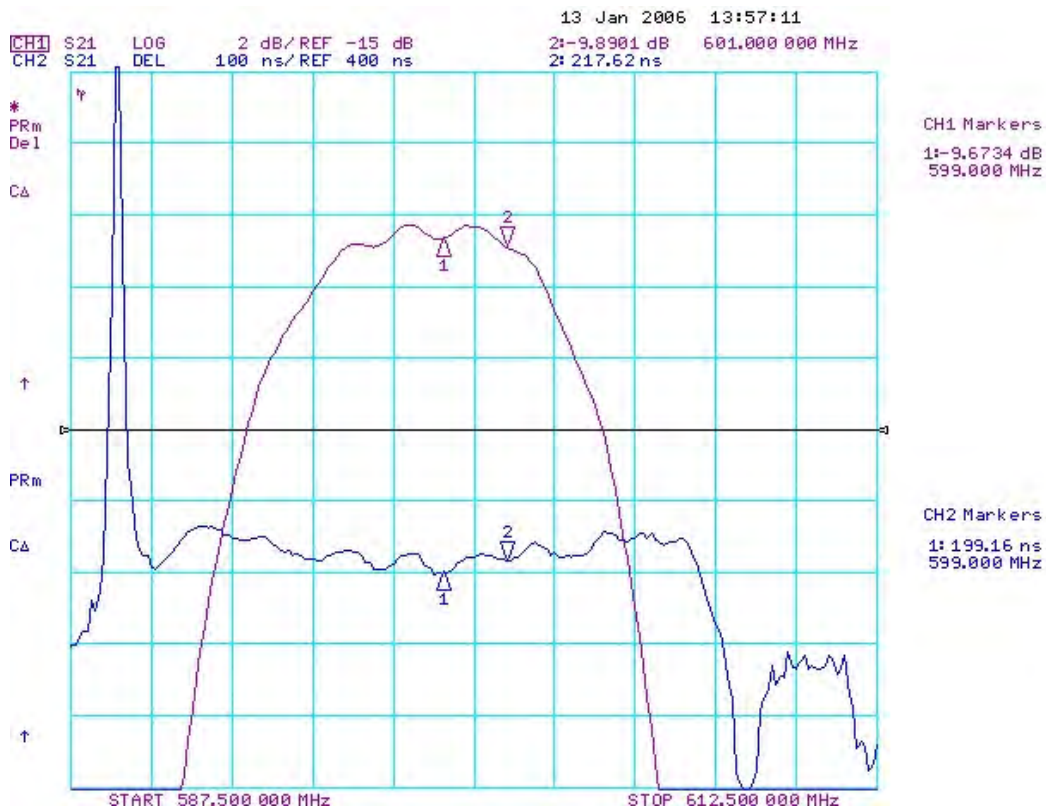
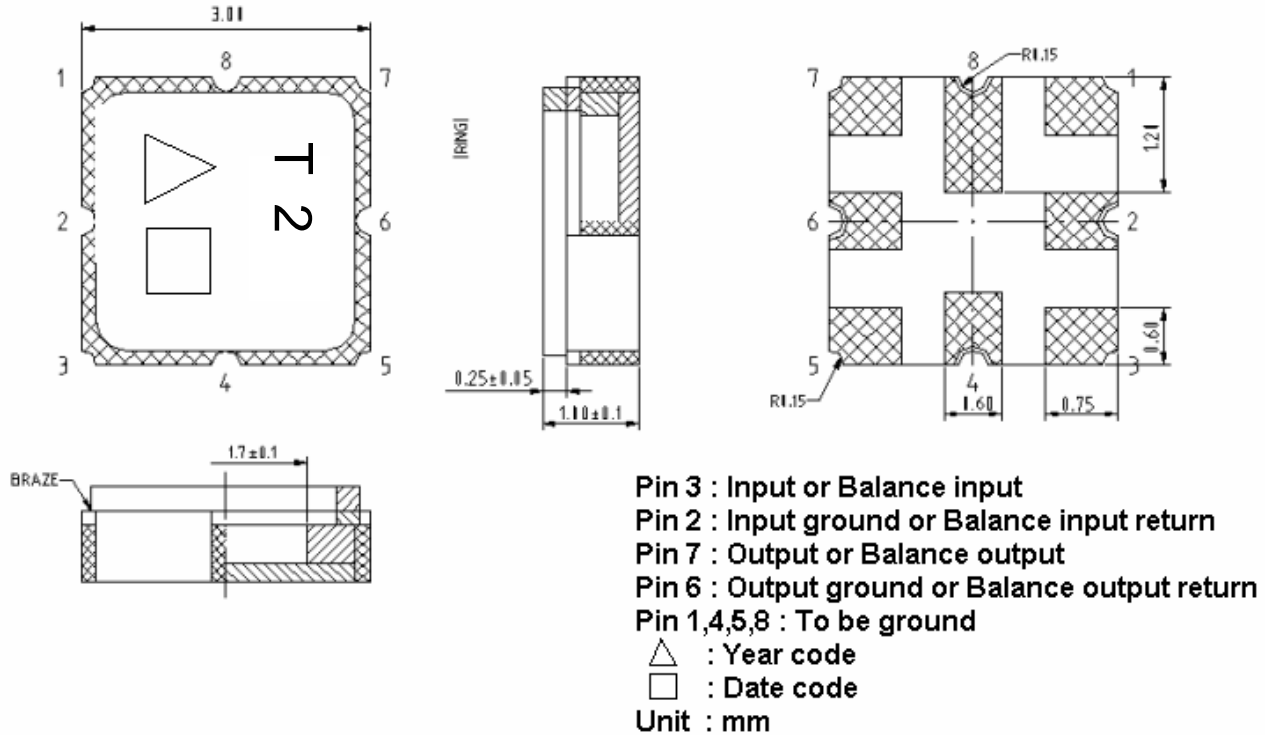

Fig-2 Horizontal: 2.5M Hz/Div Vertical: 2dB/Div. Vertical: 100ns/Div

600.0MHz SAW Filter
Part No: MA08996

Model: TB0353A
REV NO.: 1

E. OUTLINE DRAWING:



F. PCB FOOTPRINT

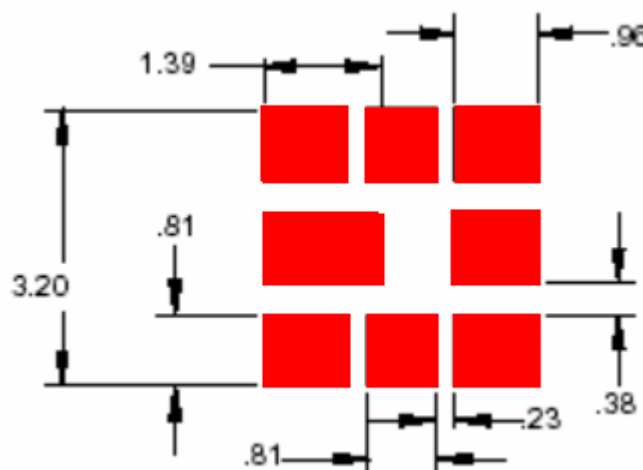

600.0MHz SAW Filter
Part No: MA08996

Model: TB0353A
REV NO.: 1

G. PACKING:

1. REEL DIMENSION

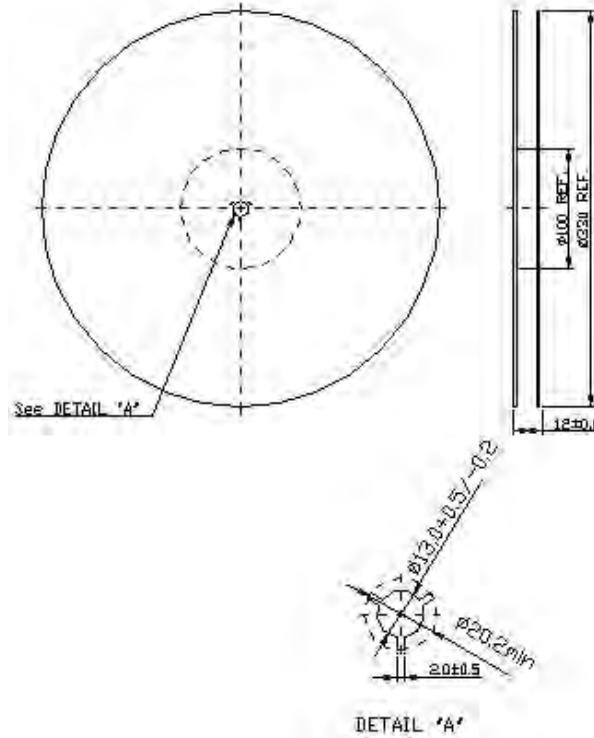

2. TAPE DIMENSION

