

**SAW Filter 315.00MHz**

**Model: TA0657A**

**Part No: MA09183**

**Rev no: 2**

**A. MAXIMUM RATING:**

**Electrostatic Sensitive Device (ESD)**

1. Input Power Level: 15dBm
2. DC voltage: 3V
3. Operating Temperature: -40°C to 85°C
4. Storage Temperature: -40°C to +85°C

**B. CHARACTERISTICS:**

Item	Unit	Min.	Typ.	Max.
Center frequency Fc	MHz	-	315	-
Maximum Insertion loss 314.70 ~ 315.30MHz IL	dB	-	1.52	2.5
Amplitude ripple 314.70 ~ 315.30MHz	dB	-	0.4	1.2
VSWR 314.70 ~ 315.30MHz	-	-	1.4	1.6
Attenuation (Reference level from Max IL dB)				
270.0 ~ 286.0 MHz	dB	55	65	-
293.0 ~ 293.9 MHz	dB	53	60	-
304.0 ~ 304.6 MHz	dB	48	60	-
325.4 ~ 326.0 MHz	dB	24	30	-
336.1 ~ 337.0 MHz	dB	36	52	-
357.5 ~ 358.7 MHz	dB	50	60	-
Source impedance Z <sub>S</sub>	Ω	-	50	-
Load impedance Z <sub>L</sub>	Ω	-	50	-
Temperature coefficient	ppm/k	-	-36	-

Note: No matching network required for operation at 50Ω

**C. MEASUREMENT CIRCUIT:**

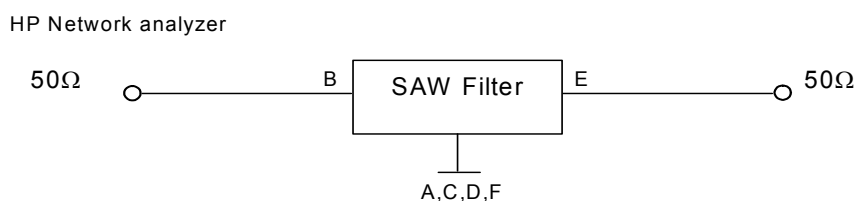

**SAW Filter 315.00MHz**  
**Part No: MA09183**

**Model: TA0657A**  
**Rev no: 2**

**D. FREQUENCY CHARACTERISTICS:**

Transfer Function

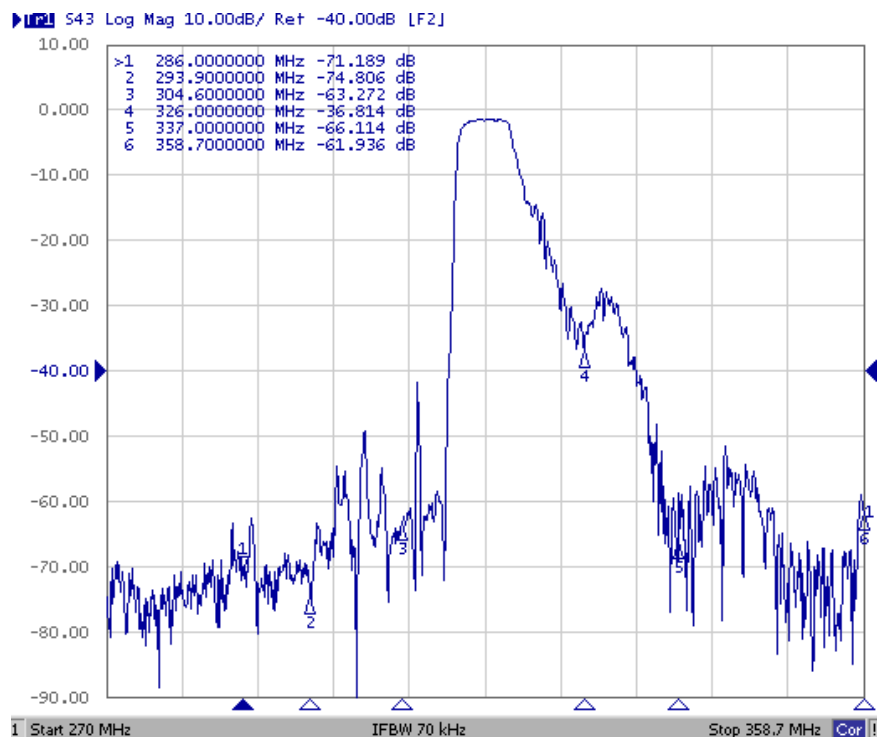
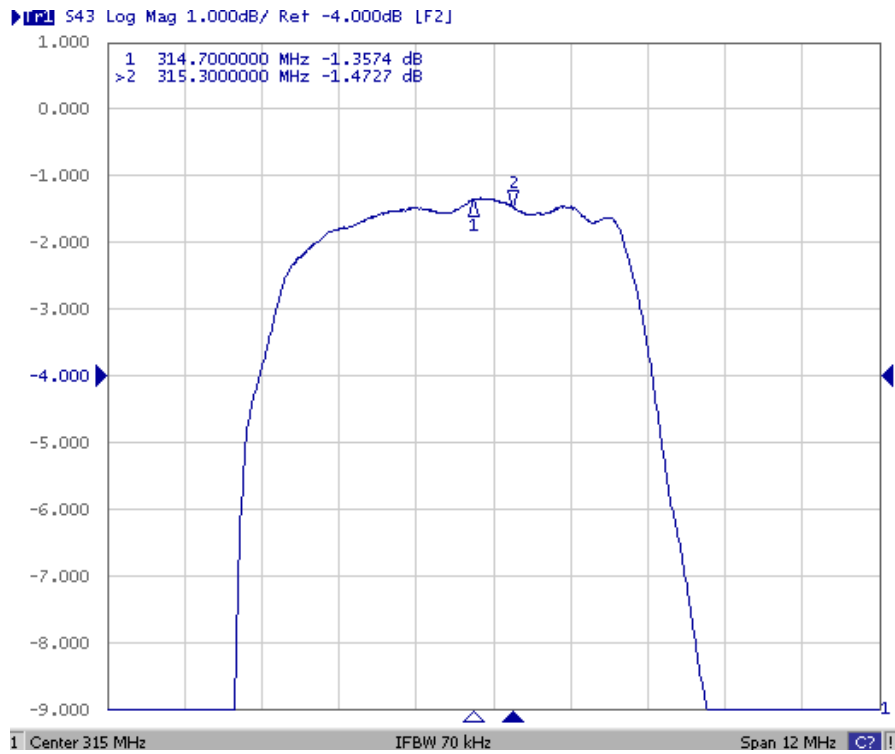

**SAW Filter 315.00MHz**  
**Part No: MA09183**

**Model: TA0657A**  
**Rev no: 2**

**E. OUTLINE DRAWING:**

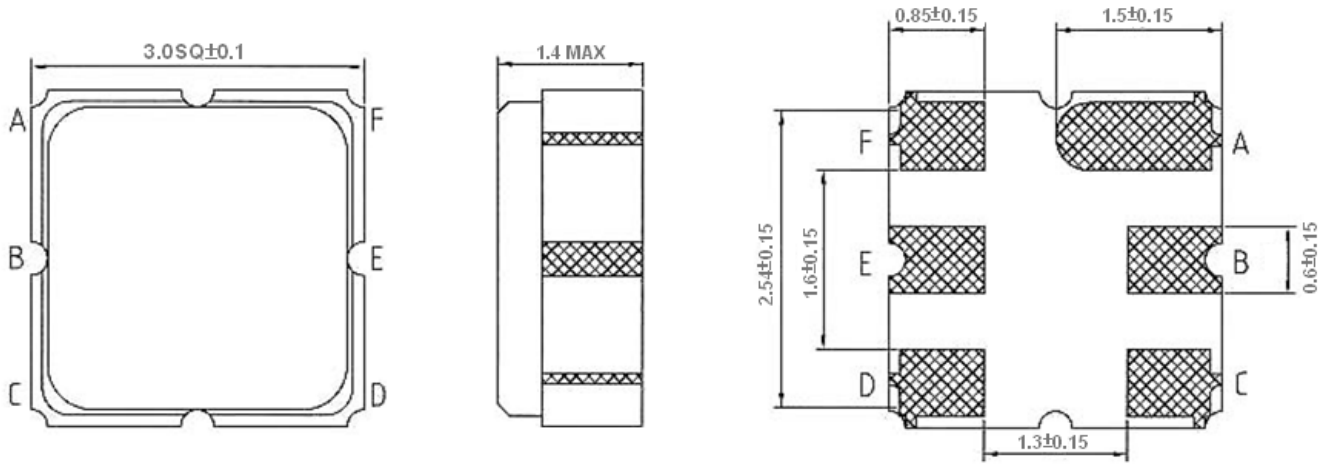

B: Input  
E: Output  
A, C, D, F: Ground  
Unit: mm

**F. PCB FOOTPRINT:**

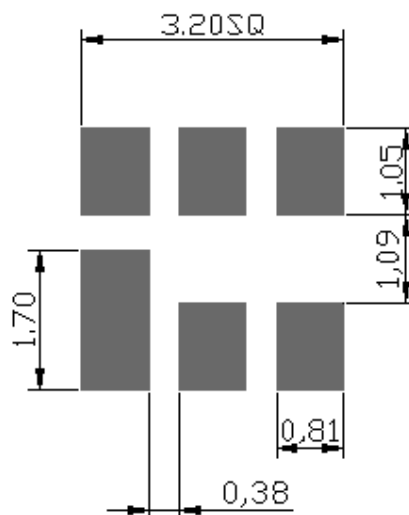

**SAW Filter 315.00MHz**  
**Part No: MA09183**

**Model: TA0657A**  
**Rev no: 2**

**G. PACKING:**

1. Reel Dimension (Please refer to FR-75D10 for packing quantity)

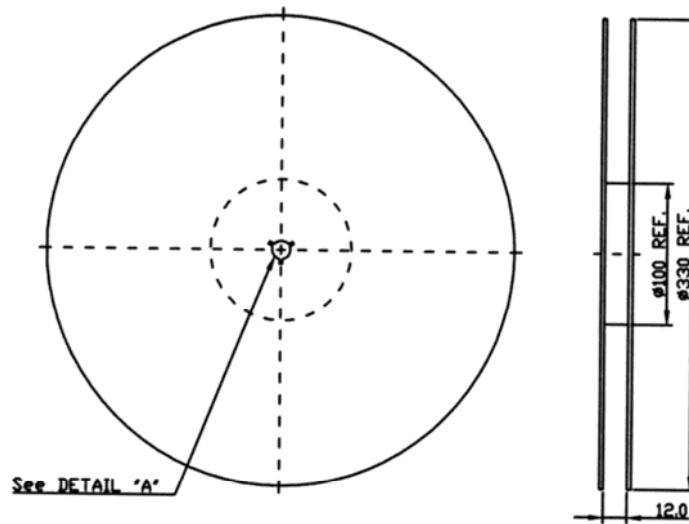

2. Tape Dimension

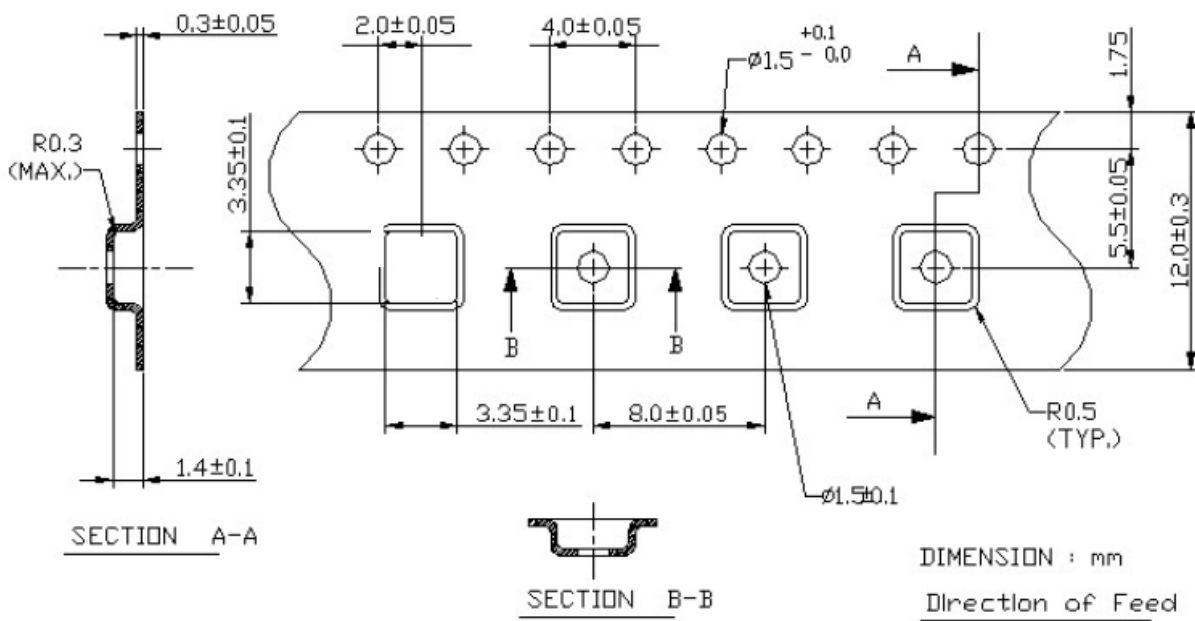

**SAW Filter 315.00MHz**  
**Part No: MA09183**

**Model: TA0657A**  
**Rev no: 2**

**H. RECOMMENDED REFLOW PROFILE:**

