433.920MHz SAW Filter**Model: TA0537A****Part No: MA09246****REV NO.: 2**

A. MAXIMUM RATING:

1. Input Power Level: 10 dB_m
2. DC voltage: 3 V
3. Operating Temperature: -10°C to +60°C
4. Storage Temperature: -40°C to +85°C

B. ELECTRICAL CHARACTERISTICS:

Item	Unit	Min.	Typical	Max.
Center frequency Fc	MHz	-	433.92	-
Insertion loss 433.05 ~ 434.79 MHz IL	dB	-	1.9	3.7
Amplitude ripple 433.05 ~ 434.79 MHz	dB	-	0.3	1.5
Attenuation (Reference level from 0 dB)				
389.0 ~ 392.0 MHz	dB	42	54	-
411.0 ~ 414.0 MHz	dB	40	50	-
454.0 ~ 457.0 MHz	dB	40	51	-
475.5 ~ 478.5 MHz	dB	42	52	-
Source impedance Z _s	Ω	-	50	-
Load impedance Z _L	Ω	-	50	-

Note1. No matching network required for operation at 50Ω

433.920MHz SAW Filter
Part No: MA09246

Model: TA0537A
REV NO.: 2

C. FREQUENCY CHARACTERISTICS:

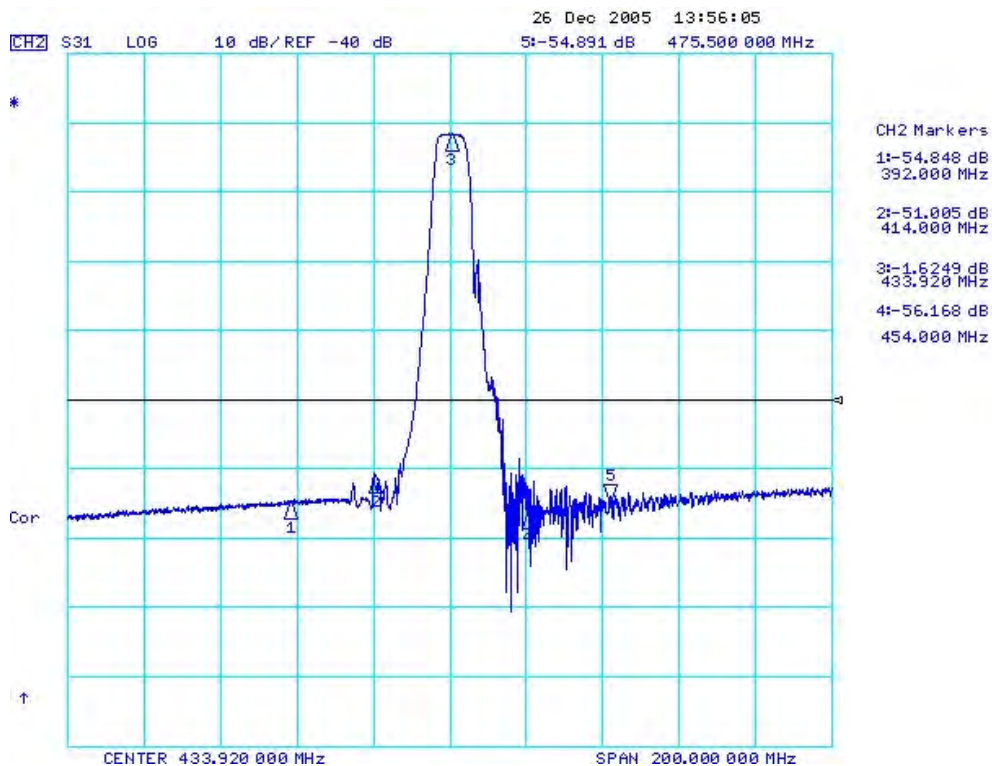

433.920MHz SAW Filter

Model: TA0537A

Part No: MA09246

REV NO.: 2

D. MEASUREMENT CIRCUIT:

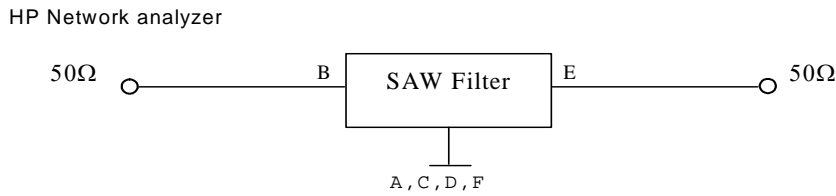

E. OUTLINE DRAWING:

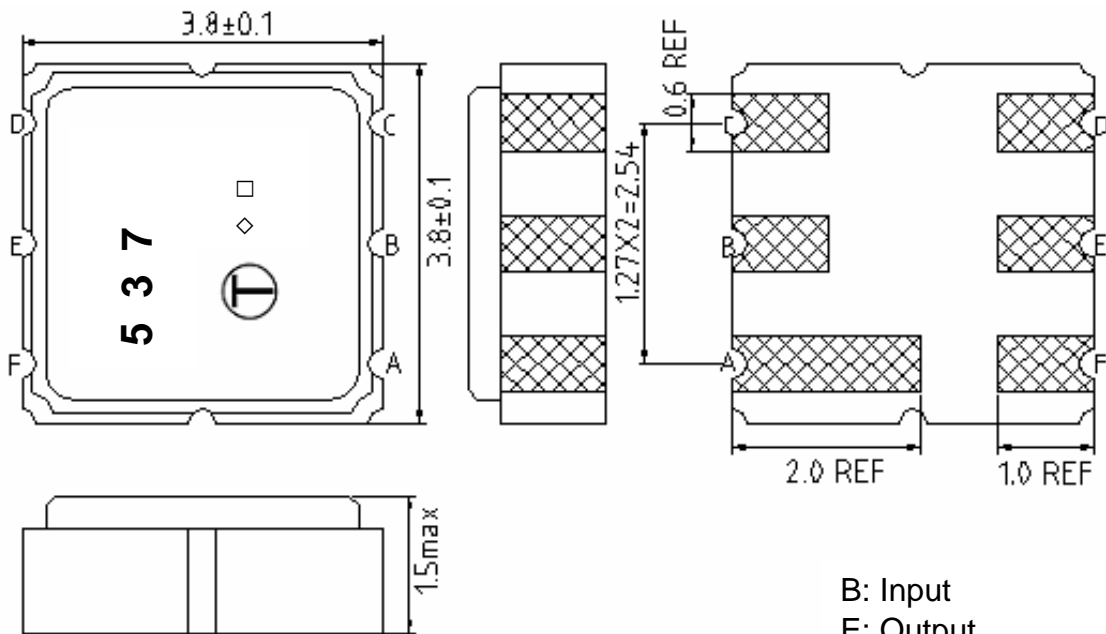

B: Input
 E: Output
 A,C,D,F: Ground
 Unit : mm
 ⬠ : Year Code
 ⬠ : Date code

	Odd Year	Even Year
Year Code	A	a

433.920MHz SAW Filter

Model: TA0537A

Part No: MA09246

REV NO.: 2

F. PCB FOOTPRINT:

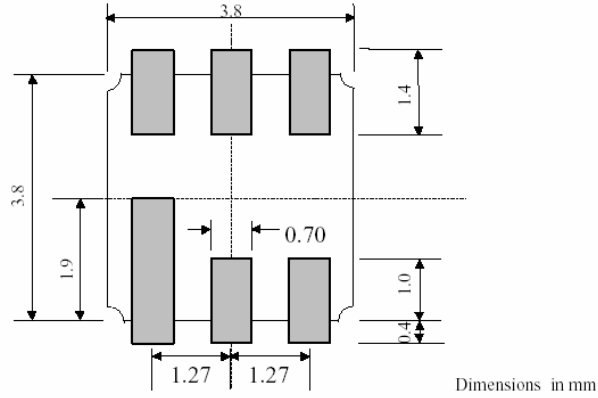

G. PACKING:

1. REEL DIMENSION

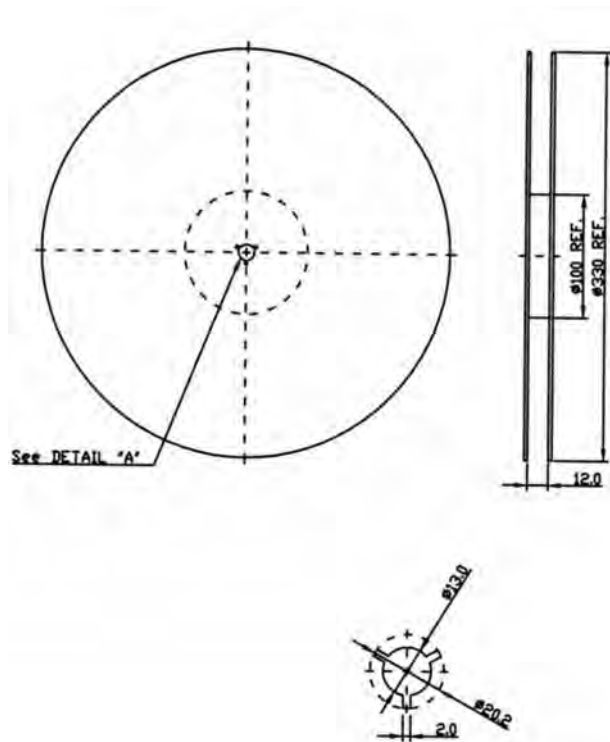

433.920MHz SAW Filter
Part No: **MA09246**

Model: **TA0537A**
REV NO.: 2

2. TAPE DIMENSION

