

**1885MHz SAW Filter**

**Model: TA0629A**

**Part No: MA09482**

**REV NO.: 1**

**A. MAXIMUM RATING:**

1. Input Power Level: 10 dBm
2. DC voltage: 3 V
3. Operating Temperature: -30°C to +85°C
4. Storage Temperature: -40°C to +85°C

**B. ELECTRICAL CHARACTERISTICS:**

Item	Min.	Typ.	Max.
Center frequency $F_c$ (dB)	-	1885	-
Insertion loss within 1850 ~1920 MHz IL (dB)	-	2.4	3.8
Amplitude ripple (p-p) within 1850 ~ 1920 MHz (dB)	-	1.2	2.5
Attenuation (Reference level from 0 dB)			
D.C. ~ 1542.5 MHz (dB)	14.0	24.5	-
1542.5 ~ 1752.5 MHz (dB)	15.0	26.0	-
1752.5 ~ 1827.5 MHz (dB)	10.0	17.5	-
1962.5 ~ 3162.5 MHz (dB)	17.0	30.0	-
3162.5 ~ 4000 MHz (dB)	14.0	30.0	-
VSWR within 1850 ~1920 MHz	-	1.9	2.6
Source impedance $Z_s$ ( $\Omega$ )	-	50	-
Load impedance $Z_L$ ( $\Omega$ )	-	50	-

**C. MEASUREMENT CIRCUIT:**

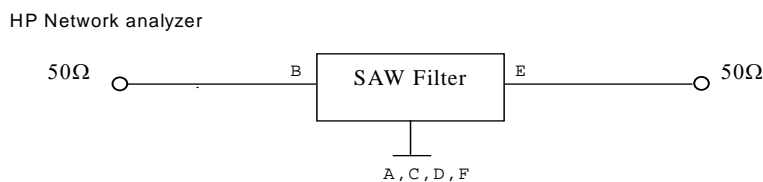

**1885MHz SAW Filter**  
**Part No: MA09482**

**Model: TA0629A**  
 REV NO.: 1

**D.OUTLINE DRAWING:**

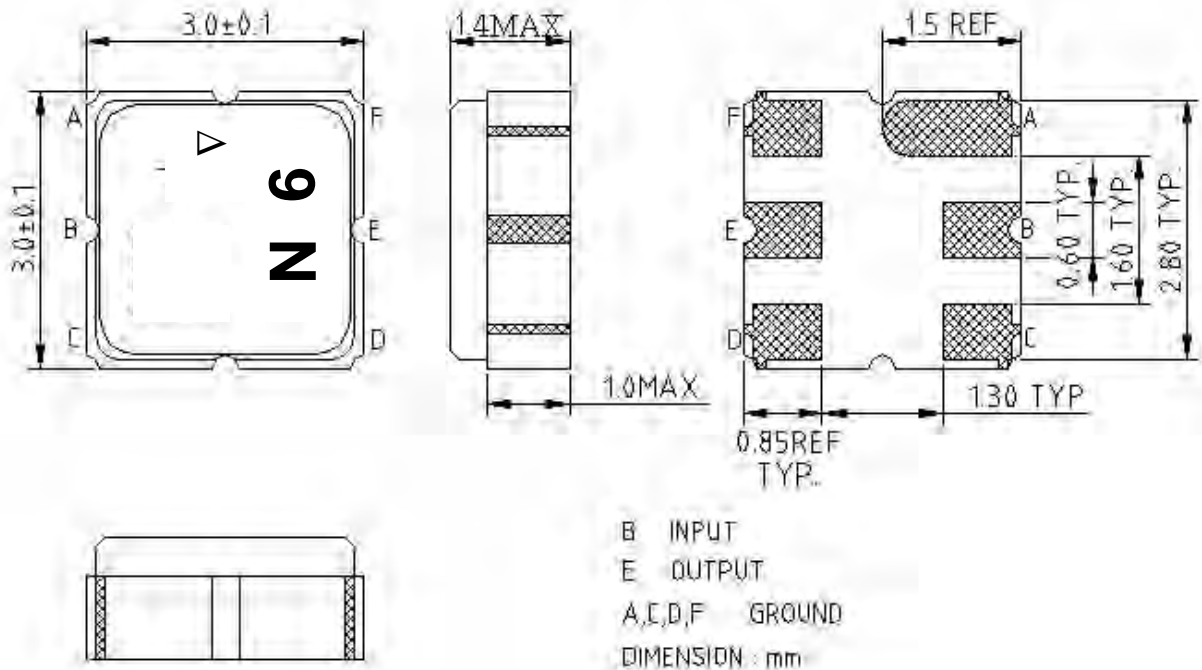

$\Delta$  : Year Code(2007→7,...2009→9)

: Date Code

**E. PCB Footprint :**

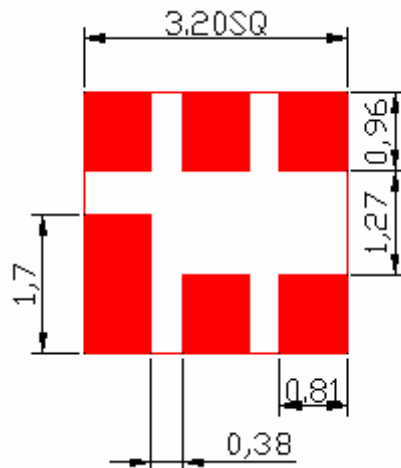

**1885MHz SAW Filter**  
**Part No: MA09482**

**Model: TA0629A**  
**REV NO.: 1**

**F. FREQUENCY CHARACTERISTICS:**

**Transfer function**

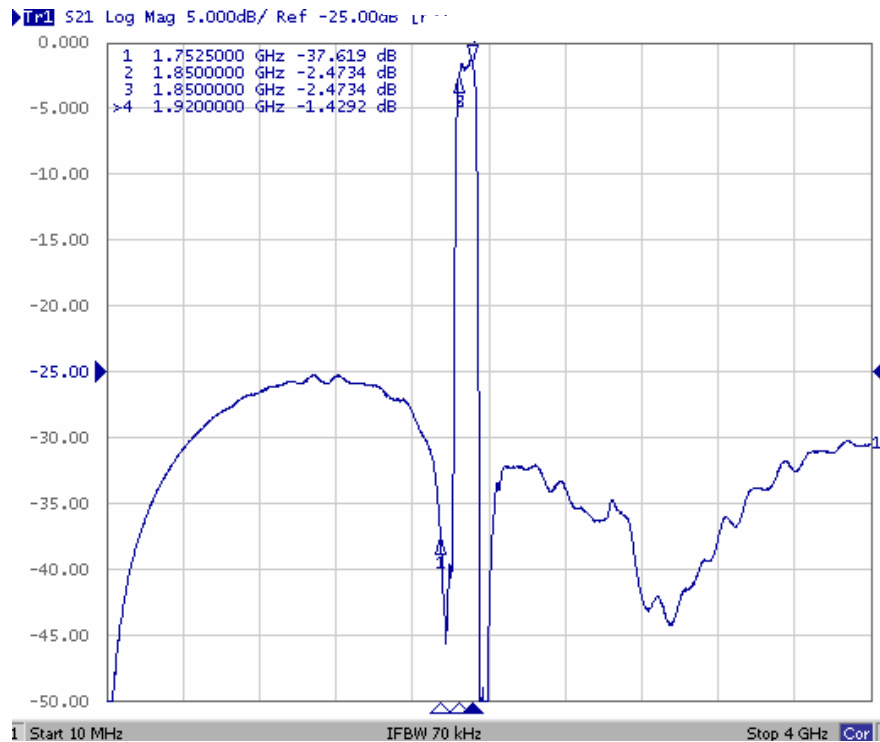
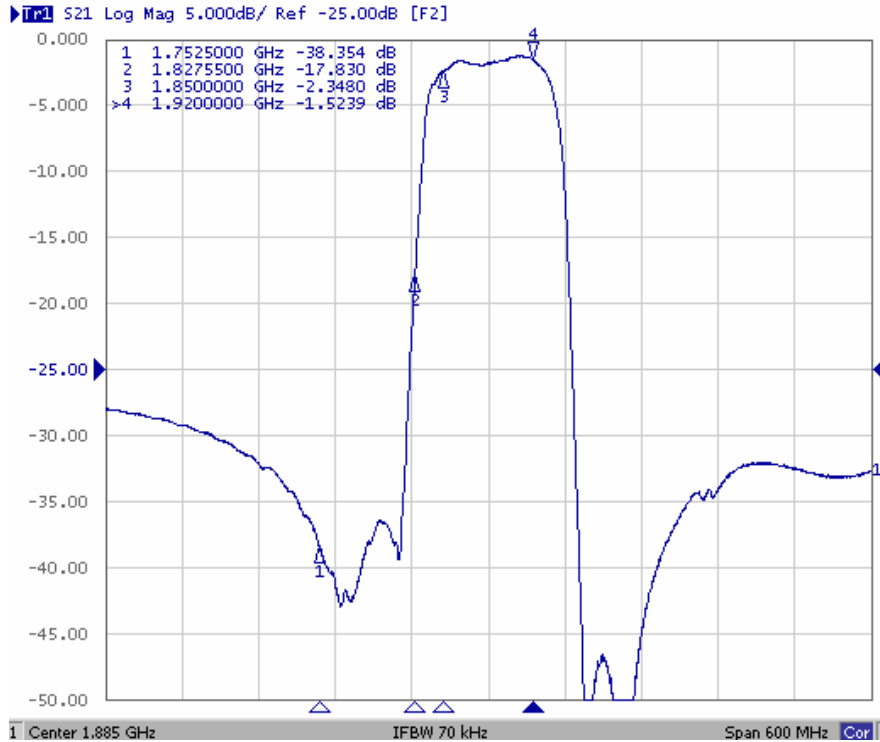

**1885MHz SAW Filter**  
**Part No: MA09482**

**Model: TA0629A**  
**REV NO.: 1**

**Reflection Functions:**

**S11 VSWR**

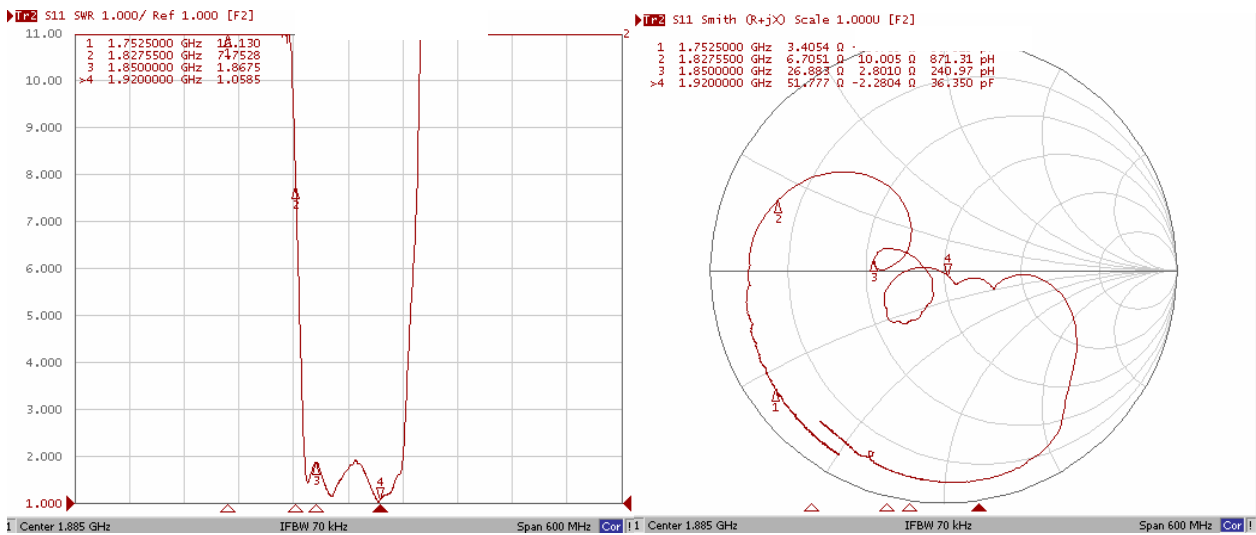

**S22 VSWR**

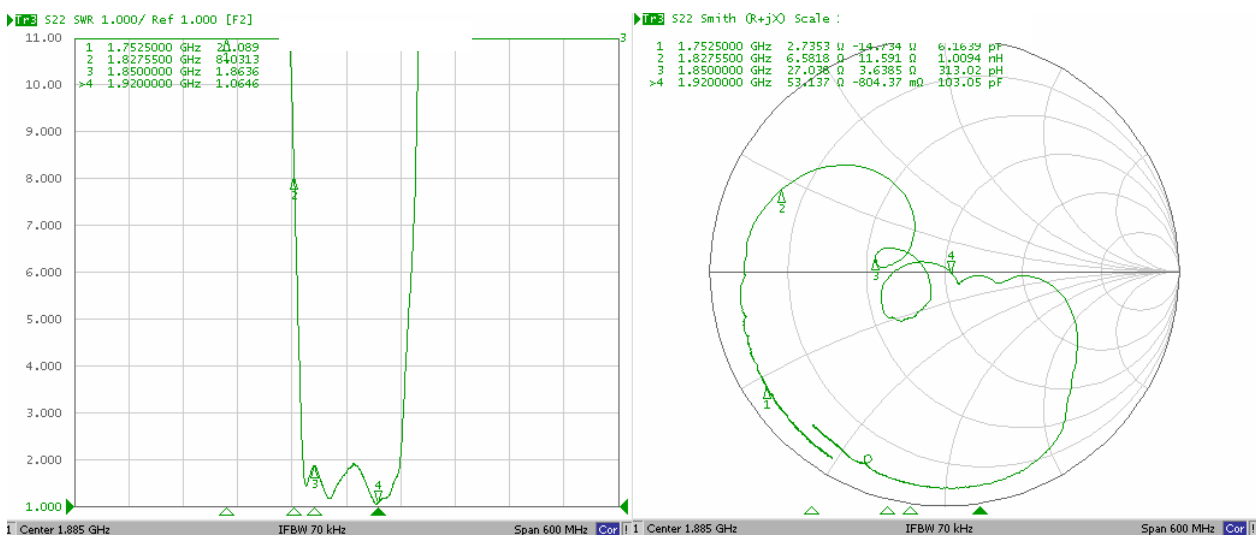

**1885MHz SAW Filter**  
**Part No: MA09482**

**Model: TA0629A**  
 REV NO.: 1

**G. PACKING:**

1. REEL DIMENSION

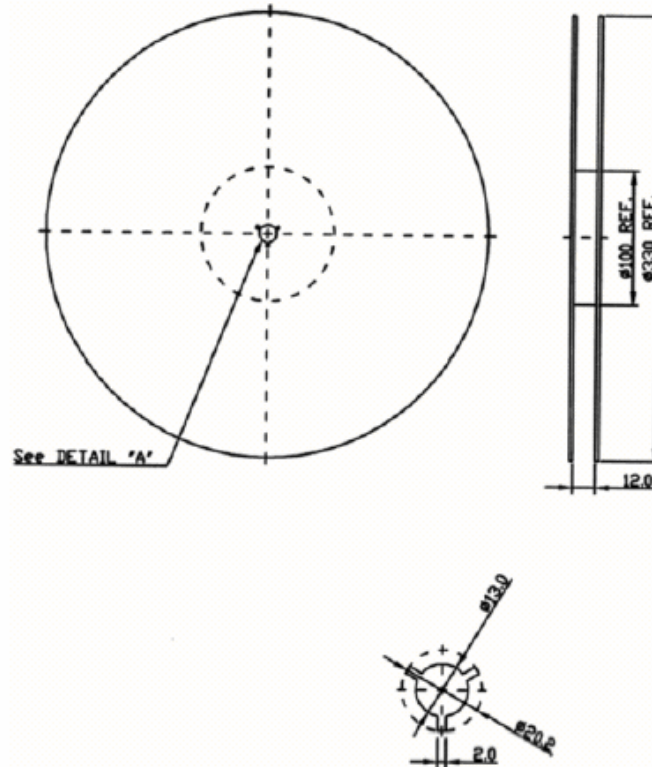

2. TAPE DIMENSION

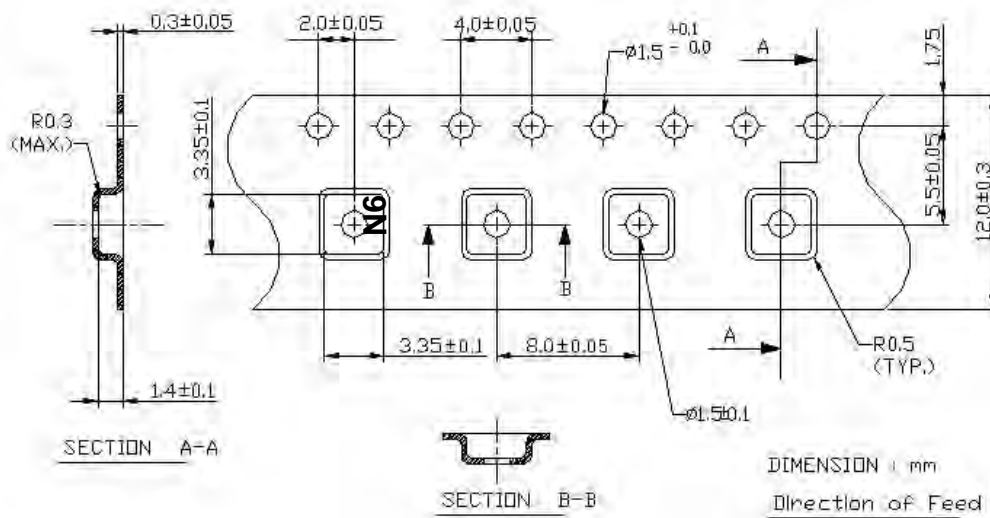

**1885MHz SAW Filter**  
**Part No: MA09482**

**Model: TA0629A**  
**REV NO.: 1**

**H. RECOMMENDED REFLOW PROFILE:**

