

**SAW Filter: 135.53MHz**  
**Part No: MA09494**

**Model: TB0557A**  
**Rev No: 1**

**A. MAXIMUM RATING:**

1. Input Power Level: 10dBm
2. DC Voltage: 5V
3. Operating Temperature: -20°C to +75°C
4. Storage Temperature: -30°C to +85°C

**B. ELECTRICAL CHARACTERISTICS:**

Item	Unit	Min.	Typ.	Max.	Note
Center frequency Fc	MHz	-	135.53	-	-
Minimum Insertion loss IL	dB	-	3.3	5.3	-
Passband Ripple (Fc ± 10kHz)	dB	-	0.3	1.5	-
Passband Ripple (Fc ± 13kHz)	dB	-	0.5	3	-
3dB Bandwidth	KHz	-	87	-	-
Group delay deviation (Fc ± 13kHz)	μ sec	-	2	10	-
Relative Attenuation (relative to 0dB)					
Fc ± 120kHz ~ Fc ± 240kHz	dB	20	36	-	-
Fc ± 240kHz ~ Fc ± 1000kHz	dB	50	52	-	-
Fc ± 330kHz	dB	50	62	-	-
Fc ± 660kHz	dB	50	63	-	-
Temperature coefficient of frequency	-0.032ppm/C <sup>2</sup>				

Note. Considering -11kHz frequency shift from -20°C to +75°C

**SAW Filter: 135.53MHz**  
**Part No: MA09494**

**Model: TB0557A**  
**Rev No: 1**

**C. OUTLINE DRAWING:**

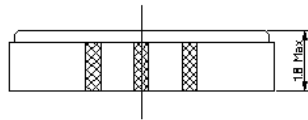
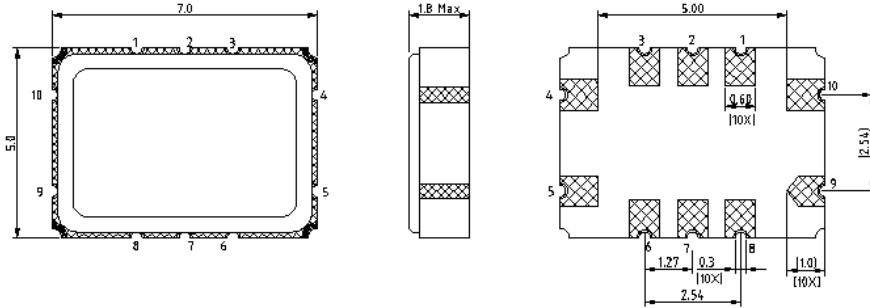

- 9: Input
  - 4: Output
  - 10: Balance input or input ground
  - 5: Balance output or output ground
  - 1, 2, 3, 6, 7, 8: To be grounded
- Unit: mm

**D. MEASUREMENT CIRCUIT:**

50Ω Test circuit (single-ended / single-ended)

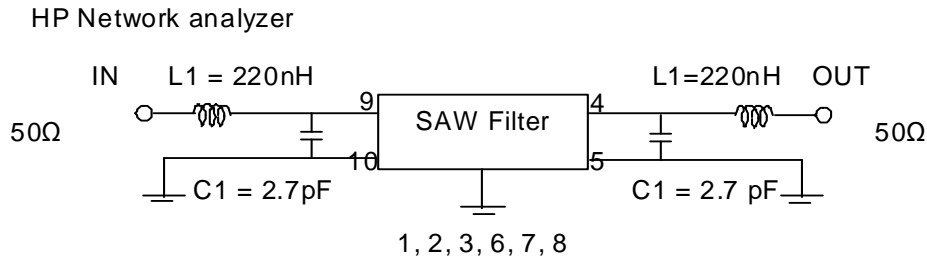

**E. PCB FOOTPRINT:**

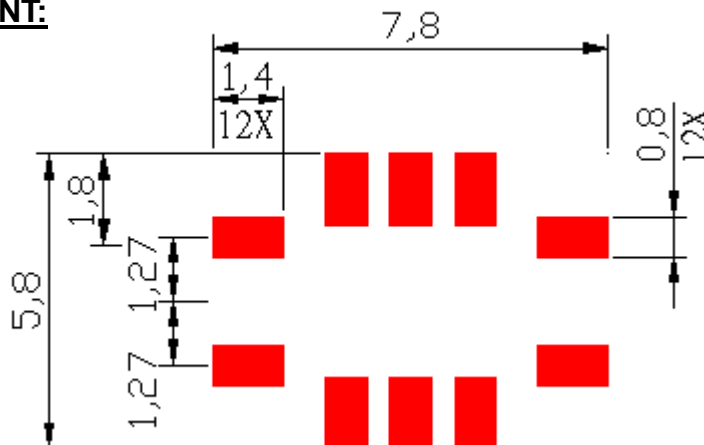

**SAW Filter: 135.53MHz**  
**Part No: MA09494**

**Model: TB0557A**  
**Rev No: 1**

**F. FREQUENCY CHARACTERISTICS:**

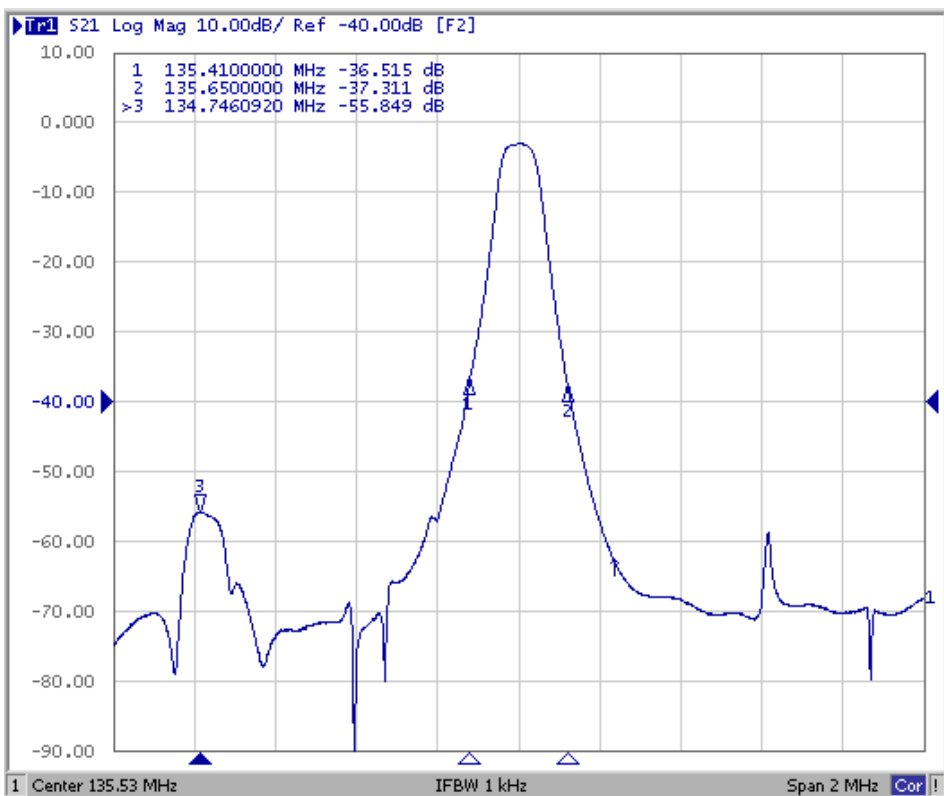
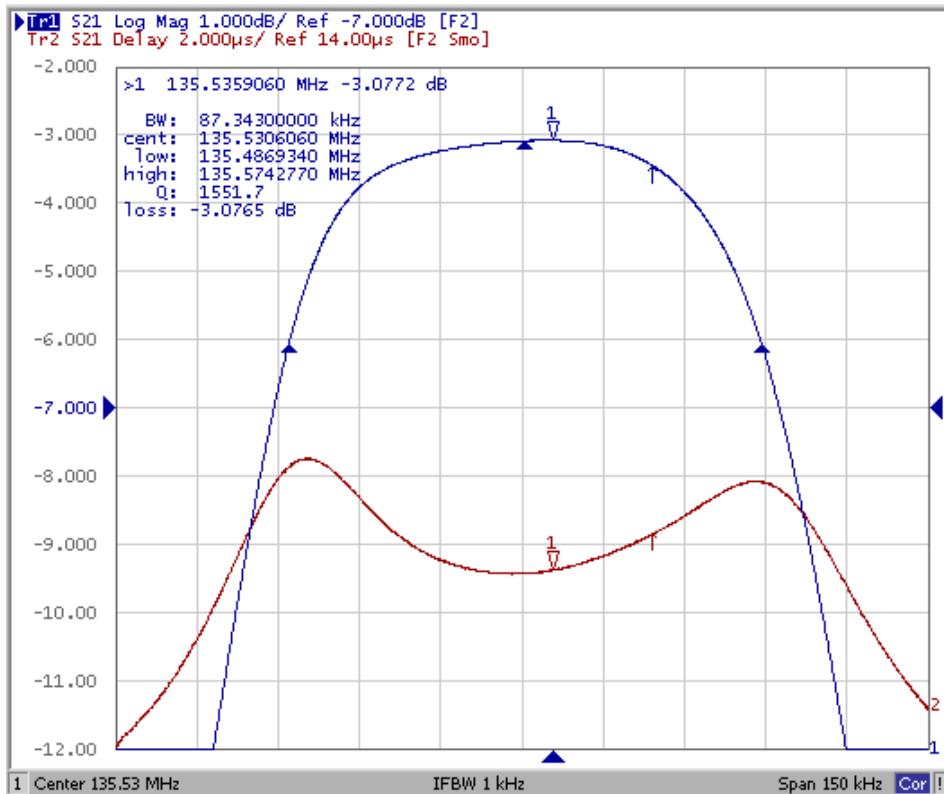

**SAW Filter: 135.53MHz**  
**Part No: MA09494**

**Model: TB0557A**  
**Rev No: 1**

**G. PACKING:**

**1. REEL DIMENSION**

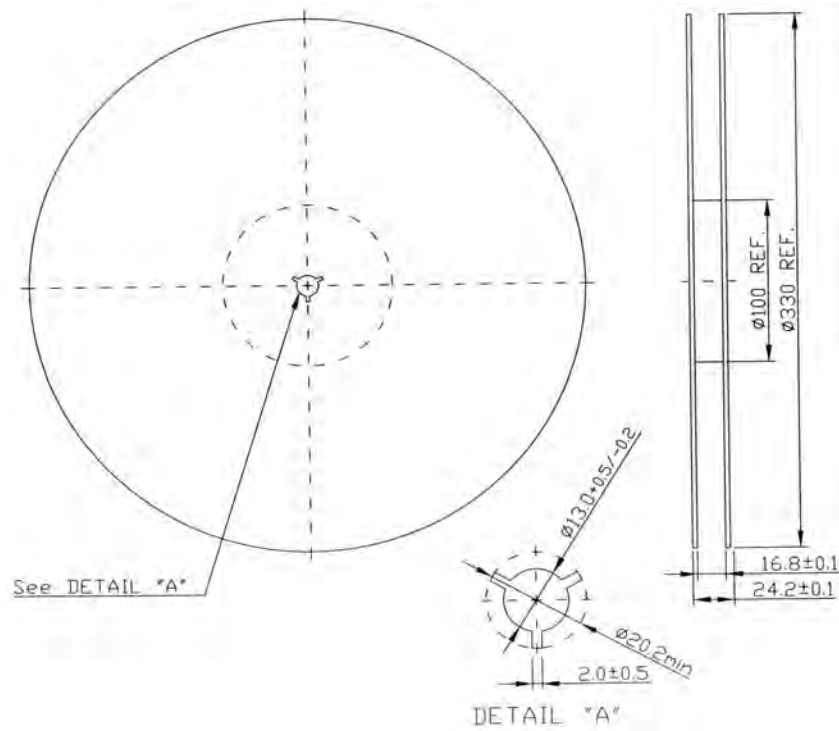

**2. TAPE DIMENSION**

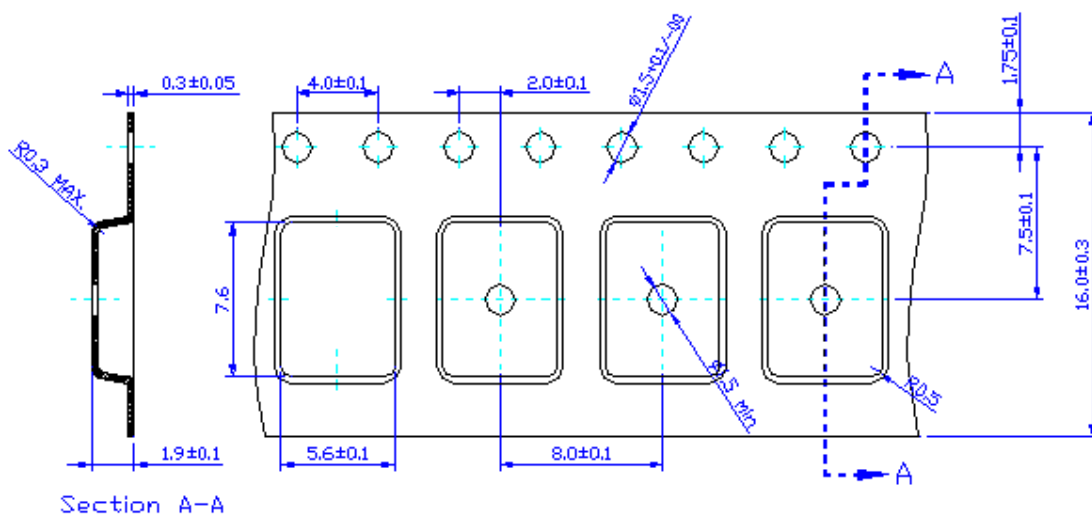

**SAW Filter: 135.53MHz**  
**Part No: MA09494**

**Model: TB0557A**  
**Rev No: 1**

**H. RECOMMENDED REFLOW PROFILE:**

