

SAW Filter 300MHz
Part No: MP01606

Model: TB0633A
Rev No: 1

A. MAXIMUM RATING:

1. Input Power Level: 20dBm
2. DC Voltage: 5V
3. Operating Temperature: 0°C to +80°C
4. Storage Temperature: -40°C to +85°C

B. ELECTRICAL CHARACTERISTICS:

Item	Unit	Min.	Type.	Max.	Note
Center frequency Fc	MHz	-	300	-	-
Min Insertion loss (Fc ± 50kHz) ILc	dB	-	3.7	7.0	-
Passband Ripple (Fc ± 50kHz)	dB	-	0.4	2	-
Return Loss (Fc ± 50kHz) RL	dB	9.4	13.5	-	-
Attenuation (relative to ILc)					
Fc -25 to Fc -1-1.6MHz	dB	50	62	-	-
Fc -1.6 to Fc -0.6MHz	dB	28	62	-	-
Fc +0.6 to Fc +1.6MHz	dB	28	53	-	-
Fc +1.6 to Fc +25MHz	dB	50	57	-	-
Temperature coefficient of frequency TCf		-0.033 ppm / C ²			

SAW Filter 300MHz
Part No: MP01606

Model: TB0633A
Rev No: 1

C. OUTLINE DRAWING:

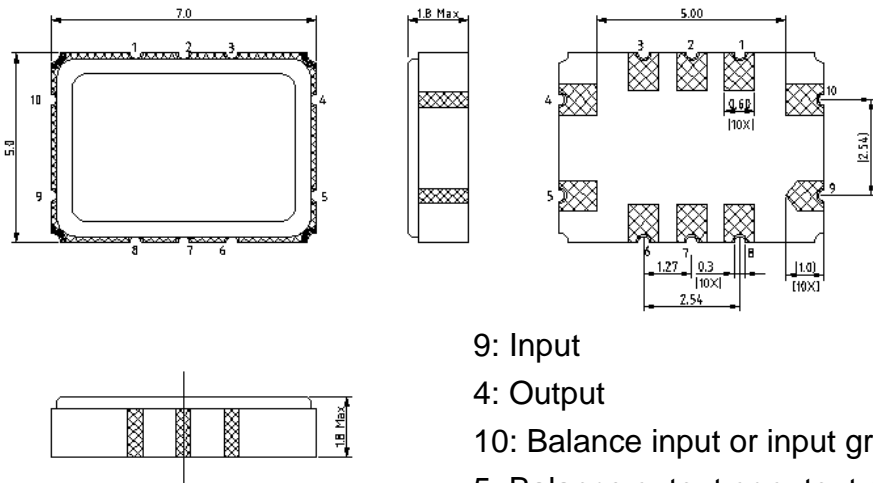

- 9: Input
 - 4: Output
 - 10: Balance input or input ground
 - 5: Balance output or output ground
 - 1, 2, 3, 6, 7, 8: To be grounded
- Unit: mm

D. MEASUREMENT CIRCUIT:

50Ω Test circuit (single-ended / single-ended)

HP Network analyzer

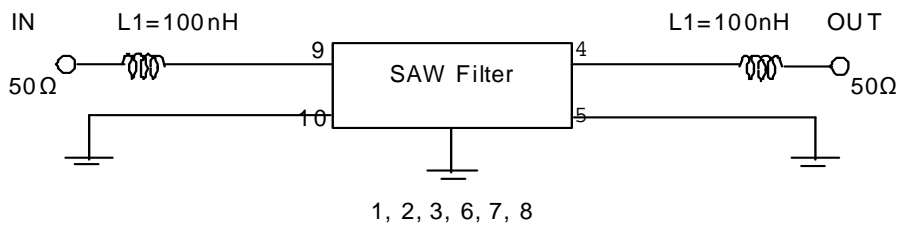

E. PCB FOOTPRINT:

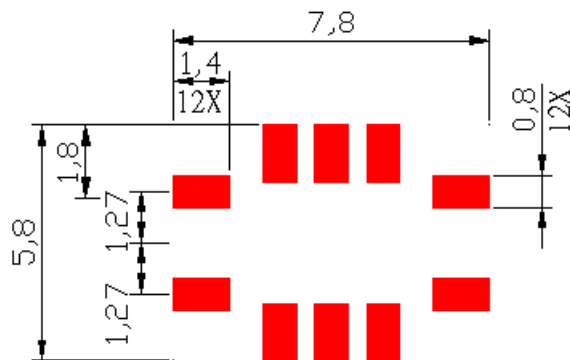

SAW Filter 300MHz
Part No: MP01606

Model: TB0633A
Rev No: 1

F. FREQUENCY CHARACTERISTICS:

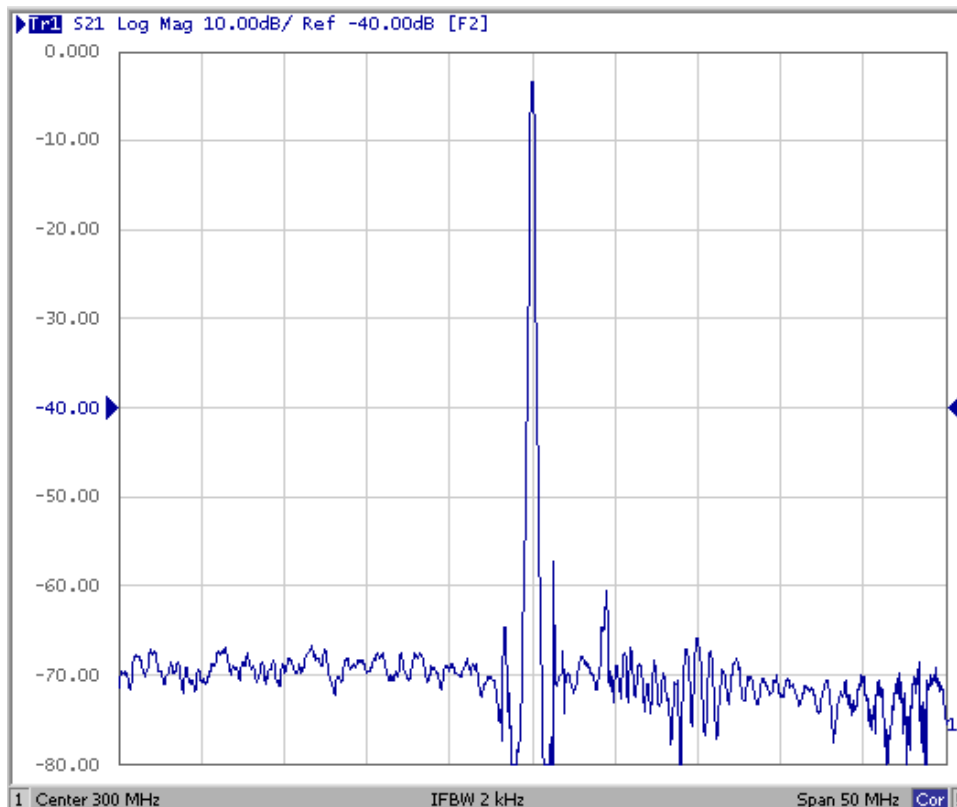
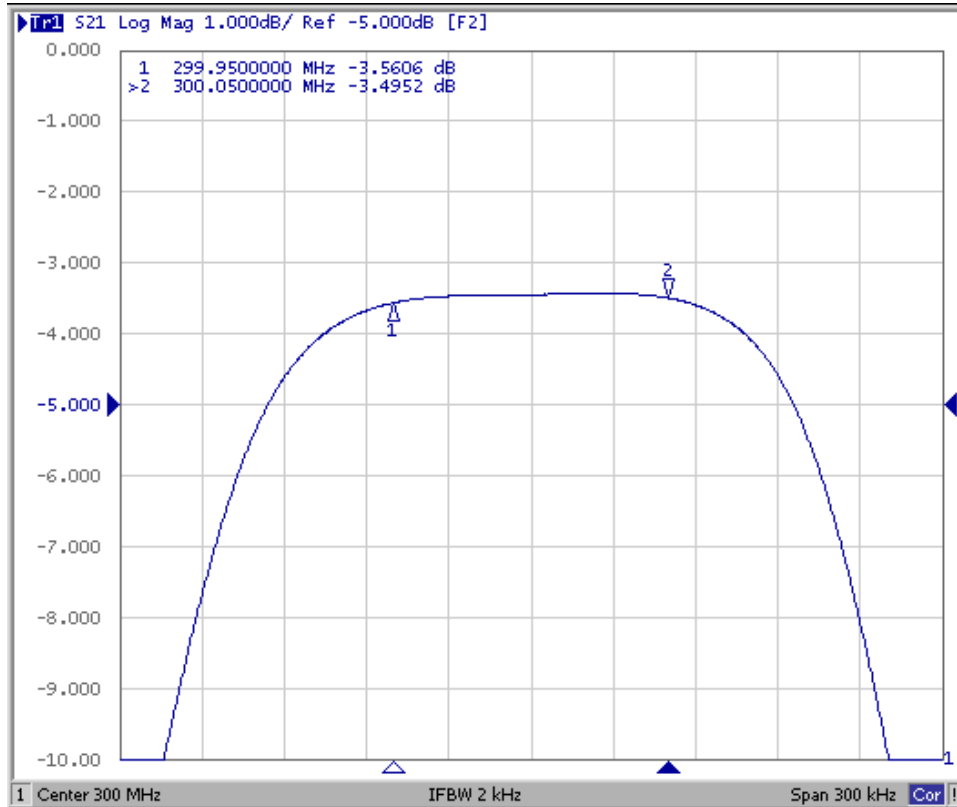

SAW Filter 300MHz
Part No: MP01606

Model: TB0633A
Rev No: 1

Reflection Functions

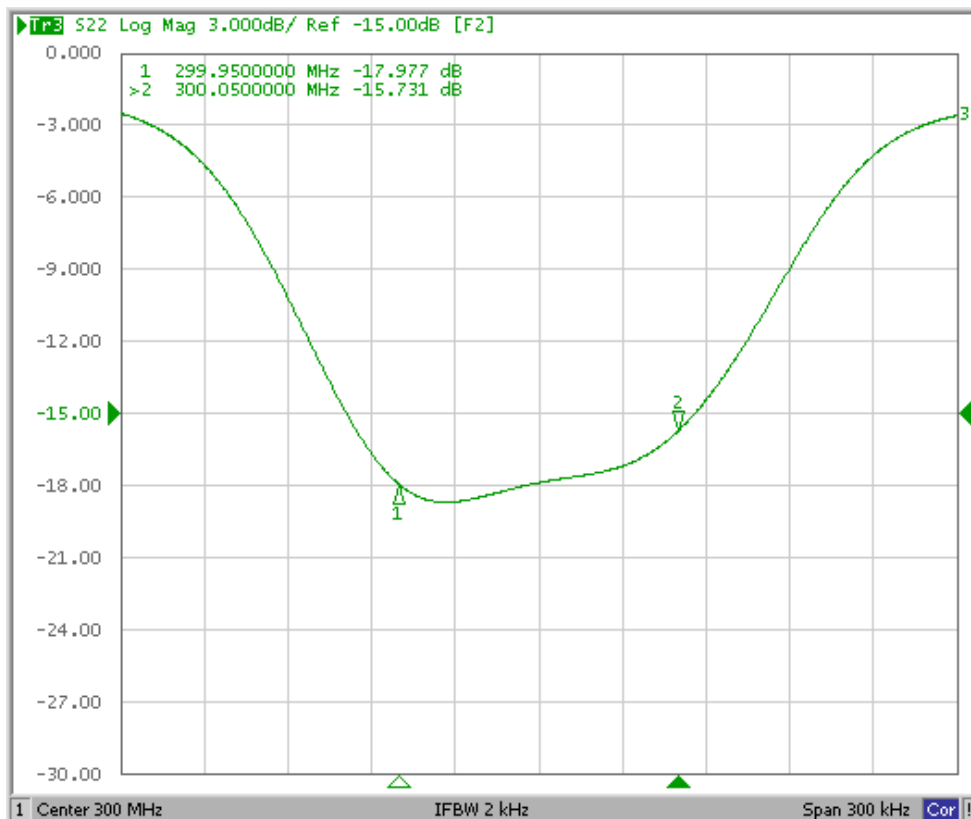
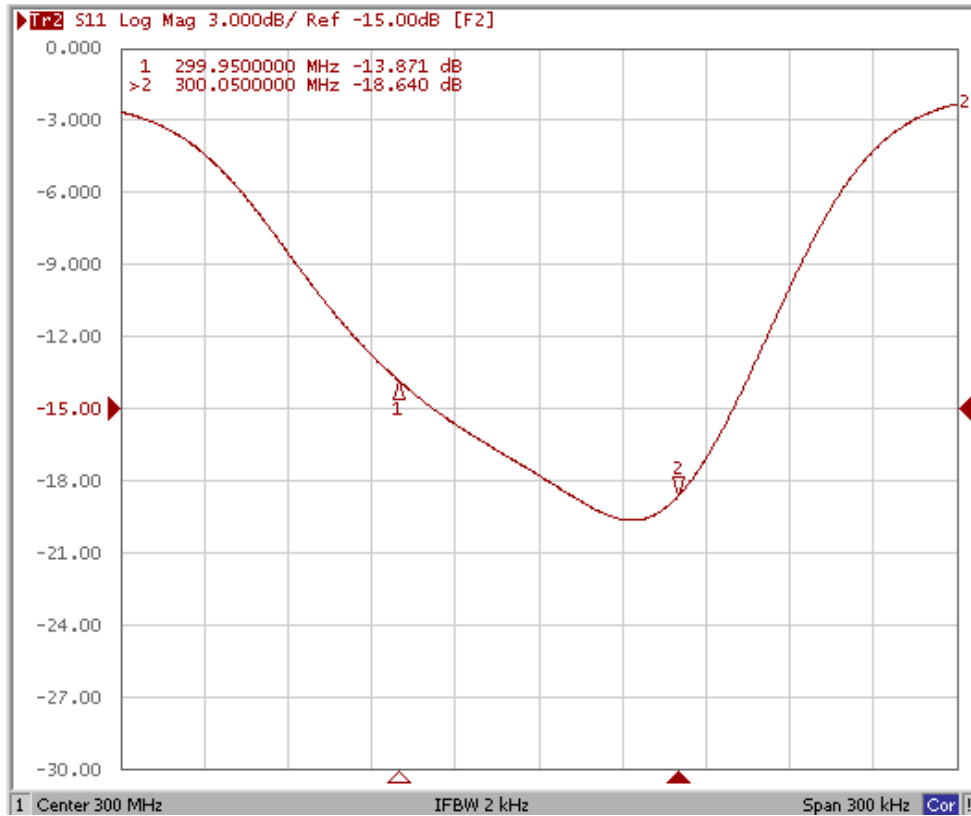

SAW Filter 300MHz
Part No: MP01606

Model: TB0633A
Rev No: 1

G. PACKING:

1. REEL DIMENSION

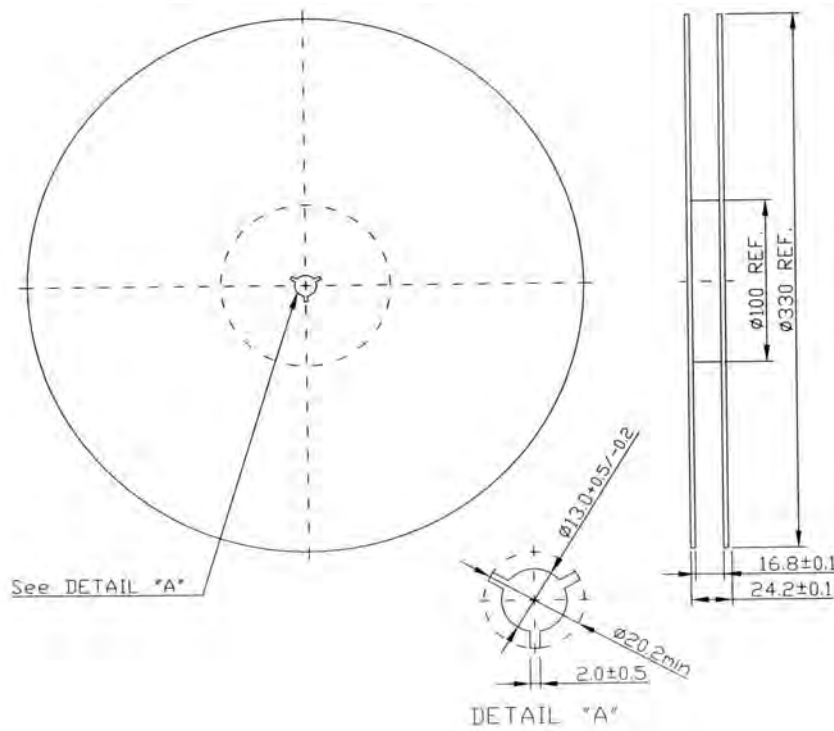

2. TAPE DIMENSION

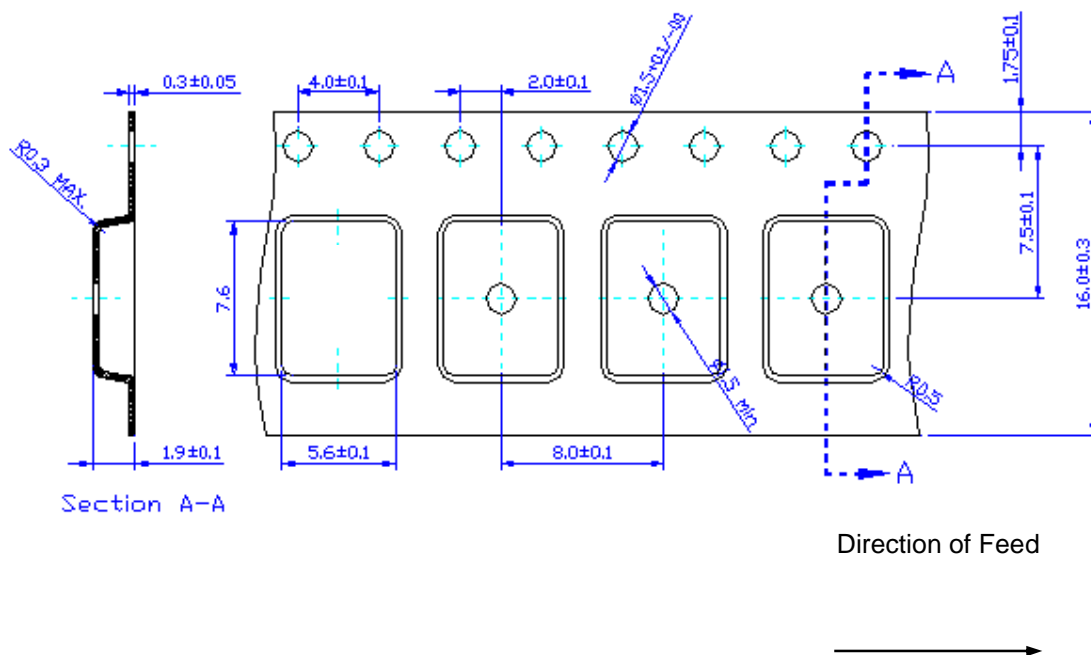

SAW Filter 300MHz
Part No: MP01606

Model: TB0633A
Rev No: 1

H. RECOMMENDED REFLOW PROFILE:

