

83.16MHz SAW Filter

Model: TB0586A

Part No: MP01724

REV NO.: 2

A. MAXIMUM RATING:

1. Input Power Level: 10 dBm
2. DC Voltage : 5V
3. Operating Temperature: -20°C to +70°C
4. Storage Temperature: -40°C to +85°C

B. ELECTRICAL CHARACTERISTICS: (Ambient temperature : 25°C)

Item	Unit	Min.	Type.	Max.	Note
Center frequency, Fc	MHz	-	83.16	-	-
Minimum Insertion loss IL	dB	-	2.9	5.0	-
Pass band ripple Fc±15 kHz	dB	-	0.5	1.5	-
Group Delay Variation Fc±15 kHz	µs	-	4	10	-
Relative Attenuation (relative to 0 dB)					
Fc-1000 kHz ~ Fc- 120 kHz	dB	40	50	-	-
Fc- 120 kHz ~ Fc- 60 kHz	dB	17	28	-	-
Fc+ 60 kHz ~ Fc+ 120 kHz	dB	17	28	-	-
Fc+ 120 kHz ~ Fc+1000 kHz	dB	40	56	-	-
Temperature coefficient of frequency TCf		-0.033 ppm/C ²			

Note1. Considering -6 KHz frequency shift from -20°C to +70°C

83.16MHz SAW Filter

Model: TB0586A

Part No: MP01724

REV NO.: 2

C. OUTLINE DRAWING:

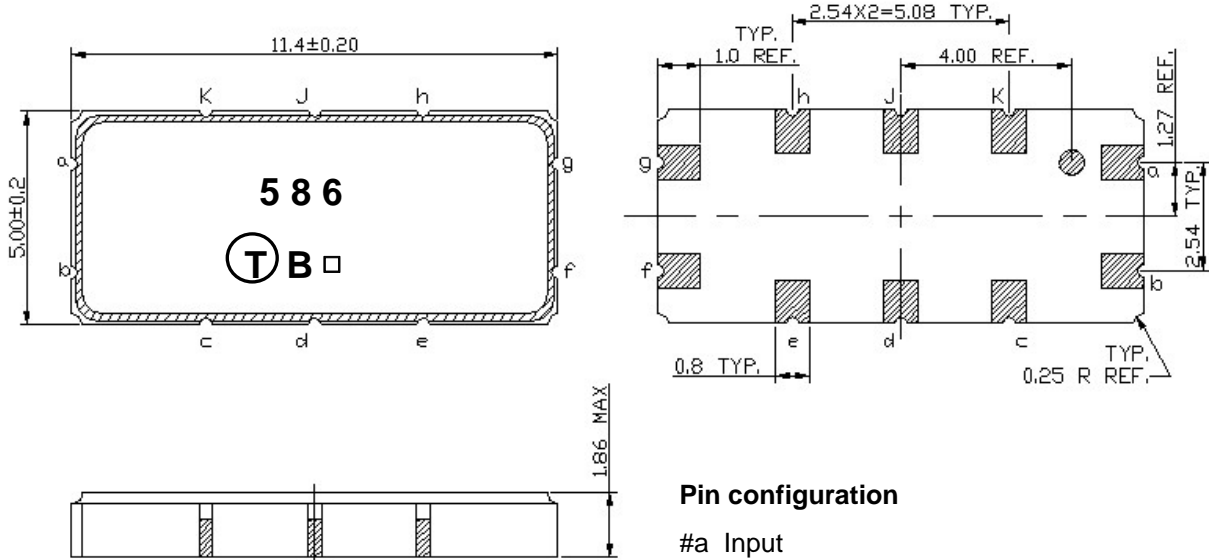

Pin configuration

- #a Input
 - #b Input RF-Return
 - #f Output
 - #g Output RF-Return
 - #c,d,e,h,j,k To be grounded
- Unit mm

Product Year Code

Year	2001 2005	2002 2006	2003 2007	2004 2008
Product Code	B	b	<u>B</u>	<u>b</u>

D. MEASUREMENT CIRCUIT:

50 Ohm Test circuit (single-ended / single-ended)

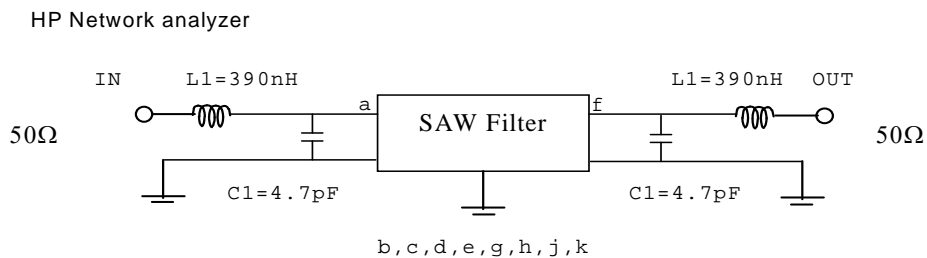

83.16MHz SAW Filter
Part No: MP01724

Model: TB0586A
REV NO.: 2

E. FREQUENCY CHARACTERISTICS:

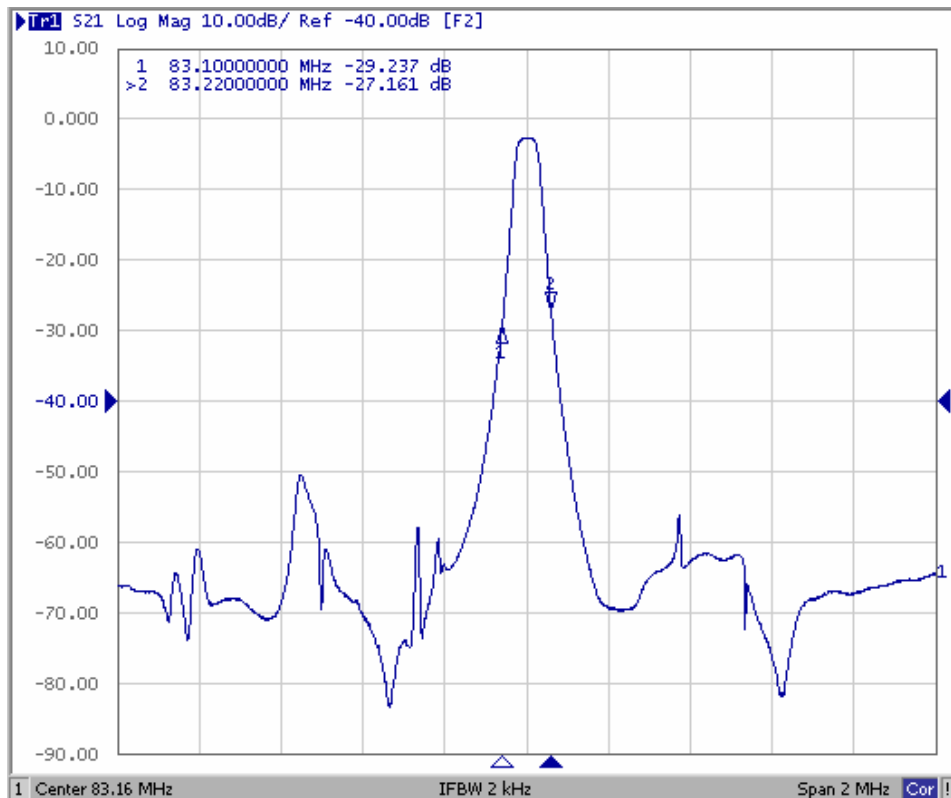
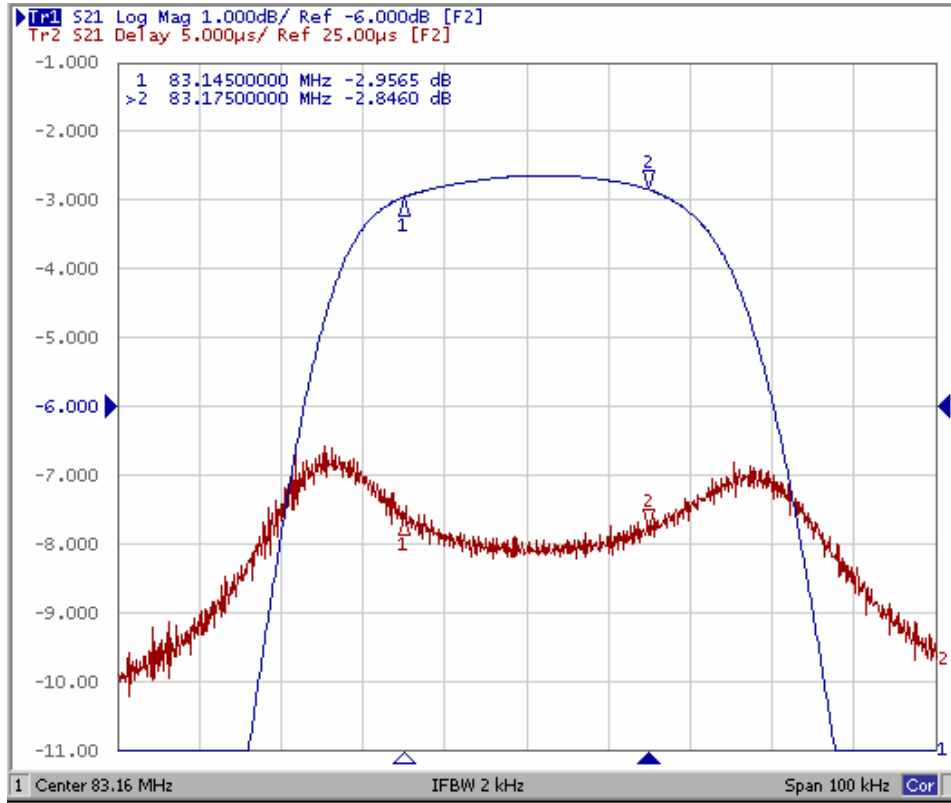

83.16MHz SAW Filter

Model: TB0586A

Part No: MP01724

REV NO.: 2

F. PACKING:

1. REEL DIMENSION

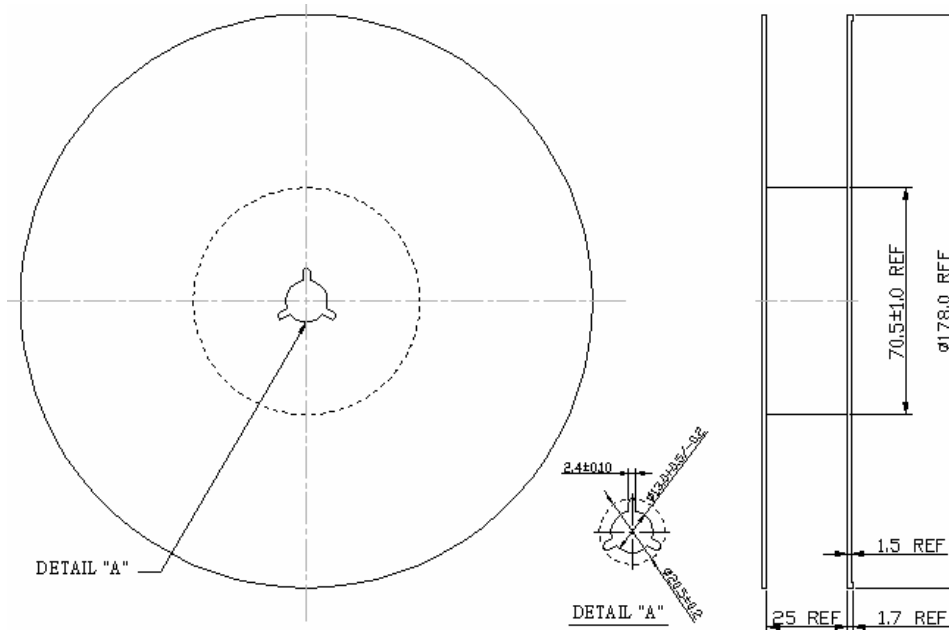

2. TAPE DIMENSION

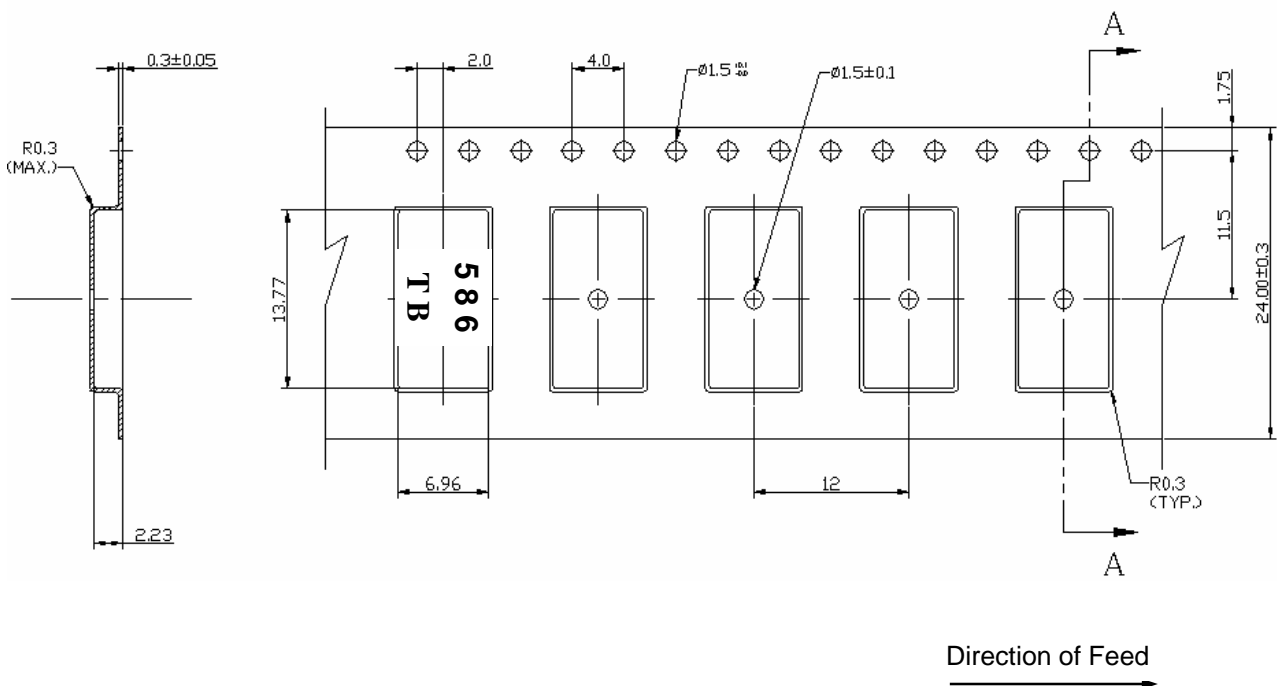

83.16MHz SAW Filter

Model: TB0586A

Part No: MP01724

REV NO.: 2

G. RECOMMENDED REFLOW PROFILE:

