

**SAW Filter 240MHz**

**Model: TB0376A**

**Part No: MP02165**

**REV NO.: 2**

**A. MAXIMUM RATING:**

1. Input Power Level: 10 dBm
2. Operating Temperature: -40°C ~ +85°C
3. Storage Temperature: -40°C ~ +85°C

**B. CHARACTERISTICS:**

Characteristics	Value			Note.
	Min.		Max.	
Center frequency $F_c$ MHz	239.5	240.0	240.5	-
Maximum Insertion loss I.L. dB	-	12.0	14.0	-
1dB Bandwidth MHz	10.5	10.9		
3dB Bandwidth MHz	-	12.2	13.3	
40dB Bandwidth MHz	-	18.0	20.0	
Passband Ripple at any 200kHz within 11MHz dB	-	0.6	1	-
Group Delay Ripple (234.5 ~245.5MHz) nS	-	75	200	-
Temp Coefficient ppm/°C		-23		
Attenuation:( Reference level from minimum insertion loss)				
1) 100 ~ 223 MHz	40	43	-	-
2) 257MHz ~ 500 MHz dB	42.5	46	-	-

**C. TEST CIRCUIT:**

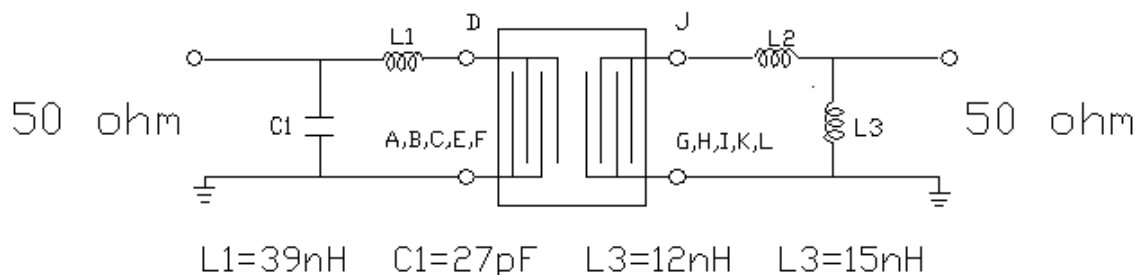

**SAW Filter 240MHz**

**Model: TB0376A**

**Part No: MP02165**

**REV NO.: 2**

**D. OUTLINE DRAWING:**

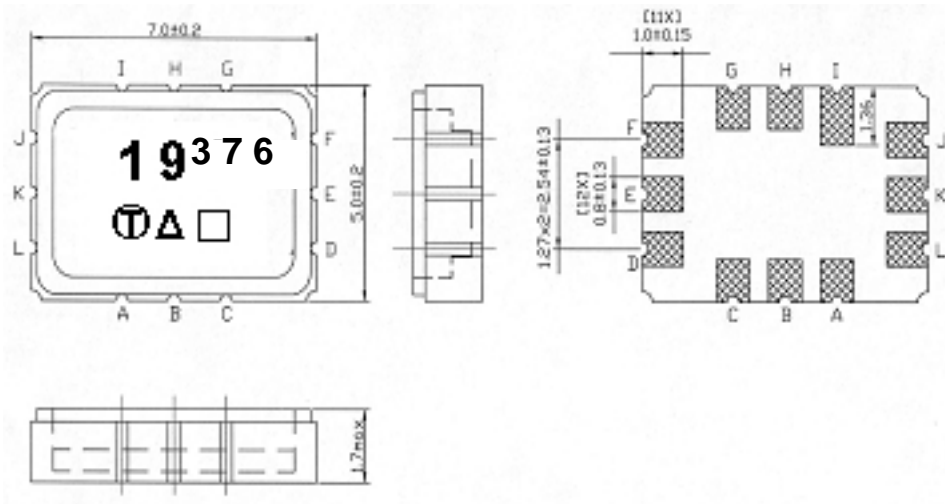

- Pin D : Unbalanced Input
- Pin J : Unbalanced Output
- Pin A, B, C, E, F, G, H, I, K, L : To be Ground

**E. PCB FOOTPRINT:**

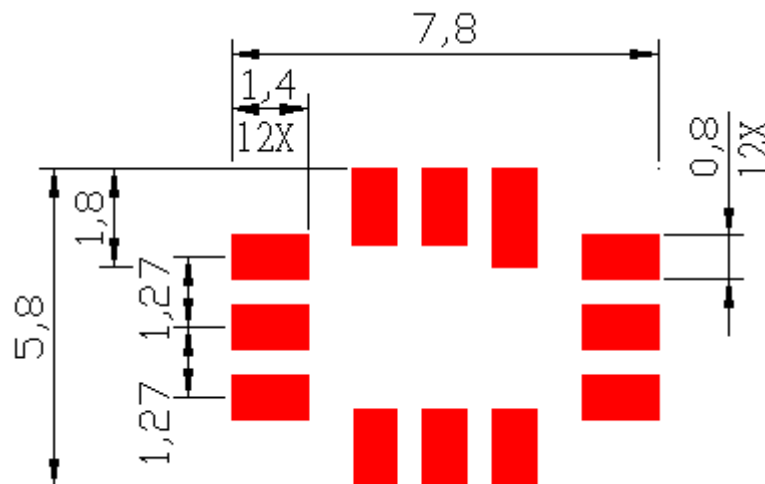

**SAW Filter 240MHz**  
**Part No: MP02165**

**Model: TB0376A**  
**REV NO.: 2**

**F. FREQUENCY CHARACTERISTICS:**

(1) wide band of Response:

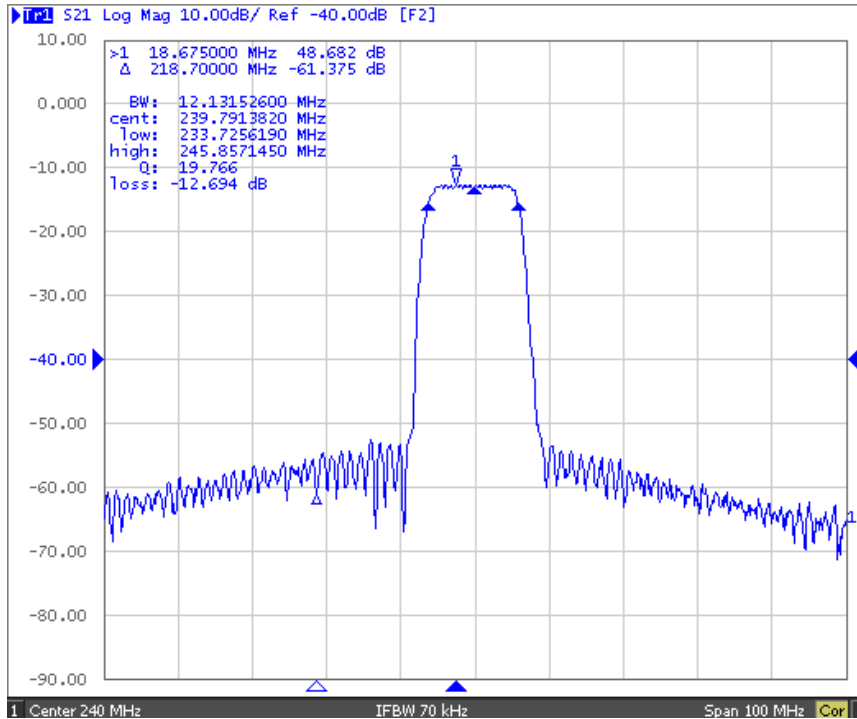

Fig-1 S21 Response Horizontal: 10MHz/Div. Vertical: 10dB/Div

(2) Passband of Response:

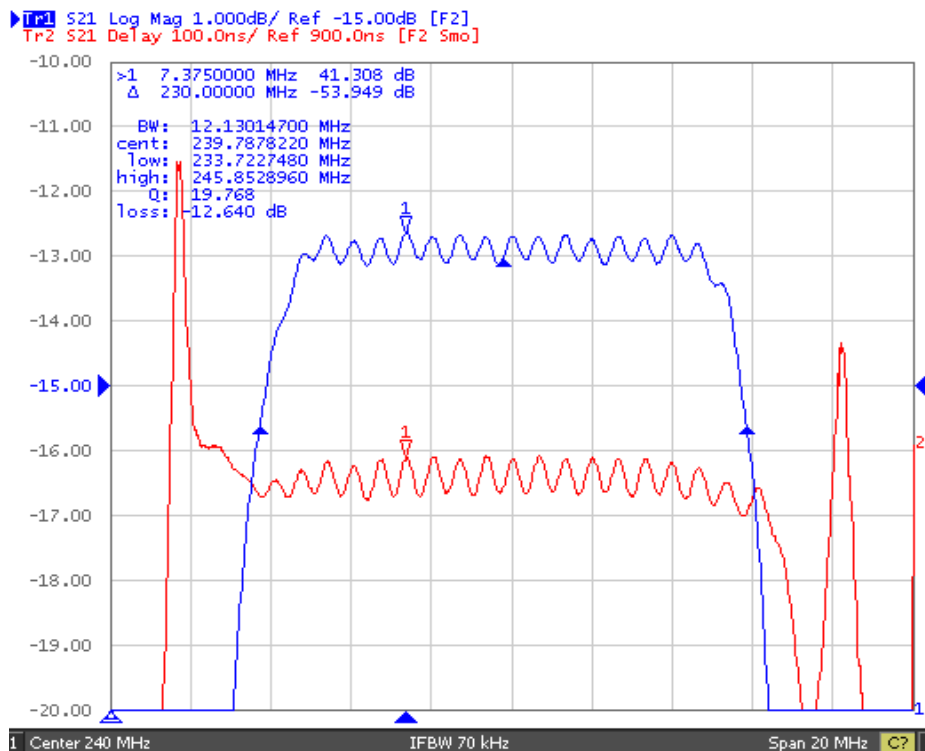

Fig-2 Group Delay and Ripple, Horizontal:2MHz/Div. Vertical: 1 dB/Div Vertical: 100nS/Div

**SAW Filter 240MHz**  
Part No: **MP02165**

Model: **TB0376A**  
REV NO.: 2

**G. PACKING:**

(1). REEL DIMENSION

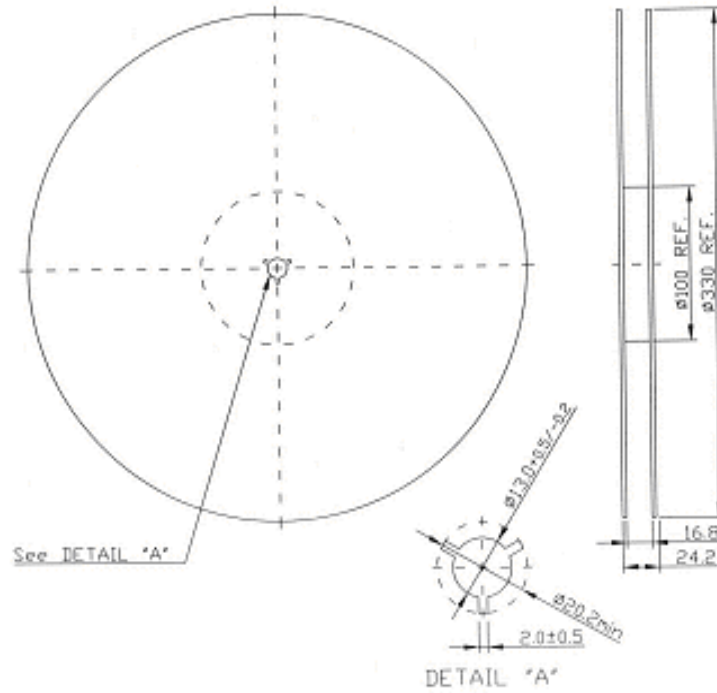

(2). TAPE DIMENSION

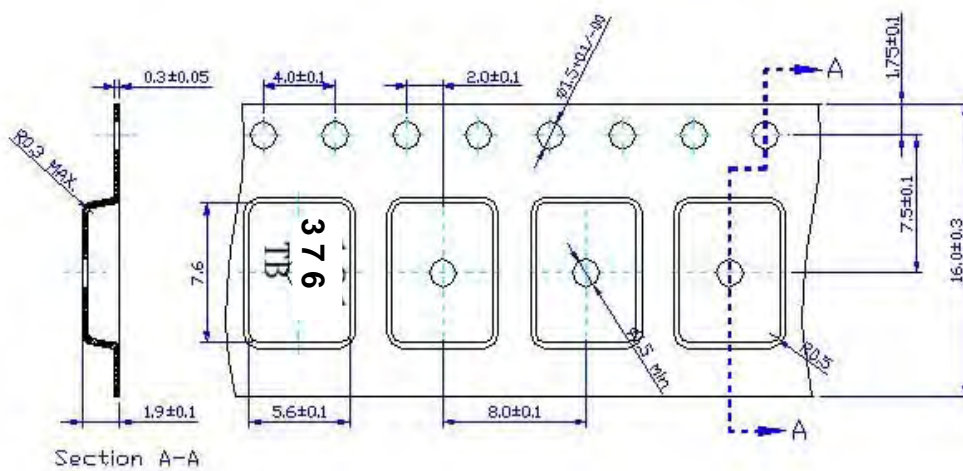

**SAW Filter 240MHz**  
**Part No: MP02165**

**Model: TB0376A**  
**REV NO.: 2**

**H. RECOMMENDED REFLOW PROFILE:**

