

SAW Filter 899MHz

Model: TA1083A

Part No: MP02646

REV. NO.: 1

A. MAXIMUM RATING:

1. Input Power Level: 10 dBm
2. DC voltage: 5 V
3. Operating Temperature: -30°C to +80°C
4. Storage Temperature: -40°C to +85°C

B. ELECTRICAL CHARACTERISTICS:

Item	Unit	Min.	Typ.	Max.
Center frequency Fc	MHz	-	899	-
Insertion Loss (895~903 MHz) IL	dB	-	2.6	3.5
Amplitude Ripple (895~903 MHz)	dB	-	0.4	2.0
Input/Output VSWR (895~903 MHz)	-	-	1.7	2.2
Attenuation (Reference level from 0 dB)				
10 ~ 869 MHz	dB	37	53	-
930 ~ 935 MHz	dB	37	53	-
935 ~ 960 MHz	dB	37	54	-
960 ~ 1600 MHz	dB	35	53	-
1600 ~ 2600 MHz	dB	31	36	-

C. MEASUREMENT CIRCUIT:

HP Network analyzer

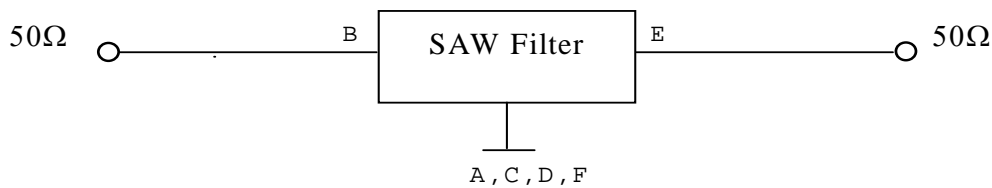

SAW Filter 899MHz
Part No: MP02646

Model: TA1083A
REV. NO.: 1

D. FREQUENCY CHARACTERISTICS:

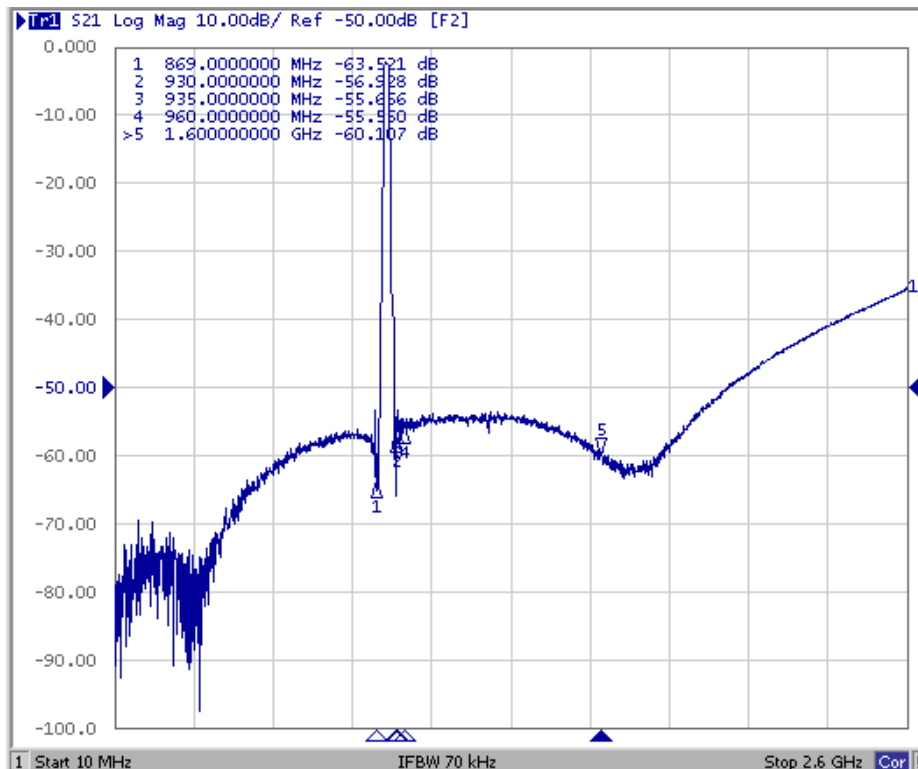
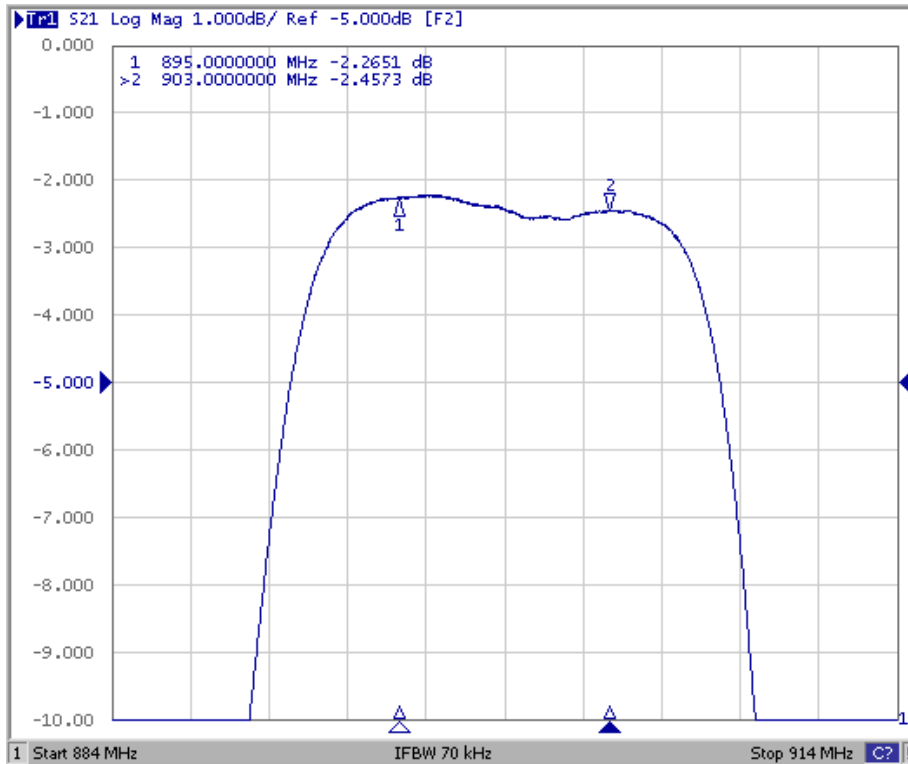

SAW Filter 899MHz
Part No: MP02646

Model: TA1083A
REV. NO.: 1

Reflection Functions:

S11

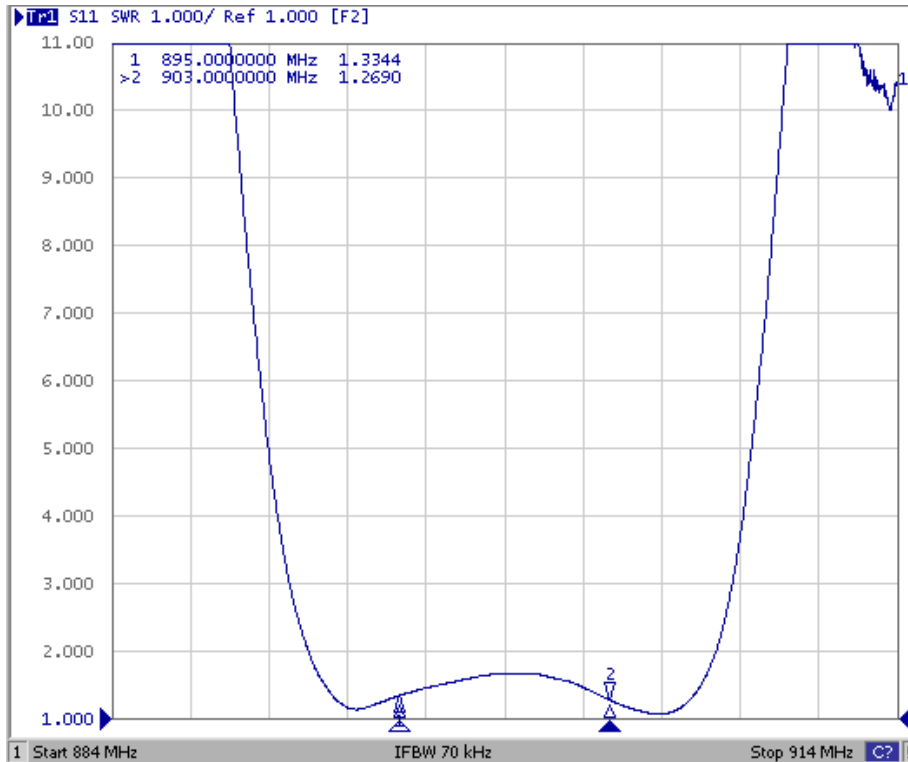

S22

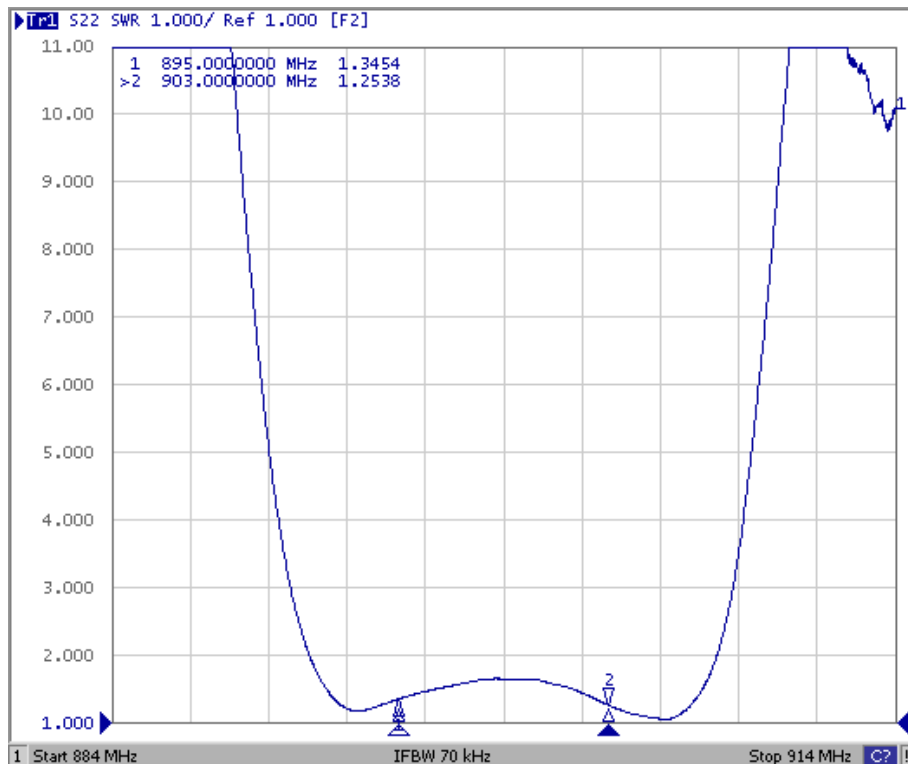

SAW Filter 899MHz
Part No: MP02646

Model: TA1083A
REV. NO.: 1

E. OUTLINE DRAWING:

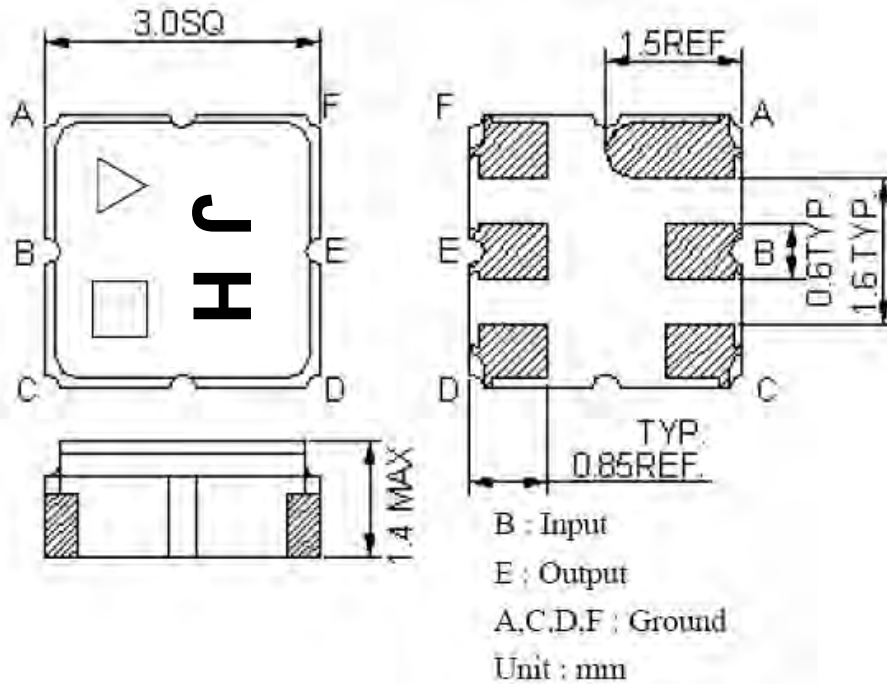

- △ : Year Code (2006->6, ..., 2009->9)
- : Date Code (W01->A, W02->B, ..., W27->a, ..., W52->z)

F. PCB FOOTPRINT:

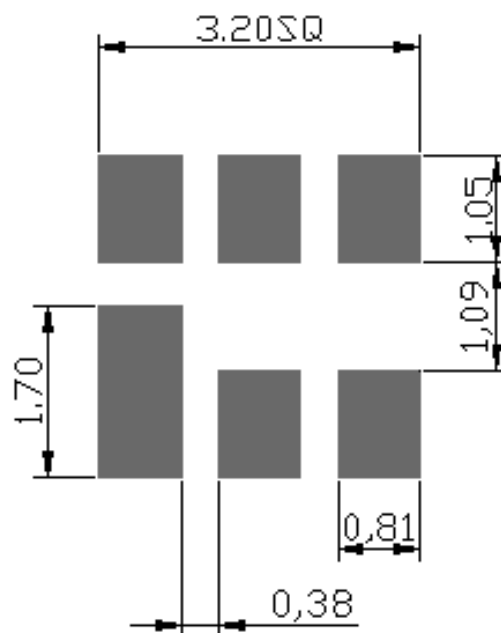

SAW Filter 899MHz
Part No: MP02646

Model: TA1083A
REV. NO.: 1

G. PACKING:

1. REEL DIMENSION

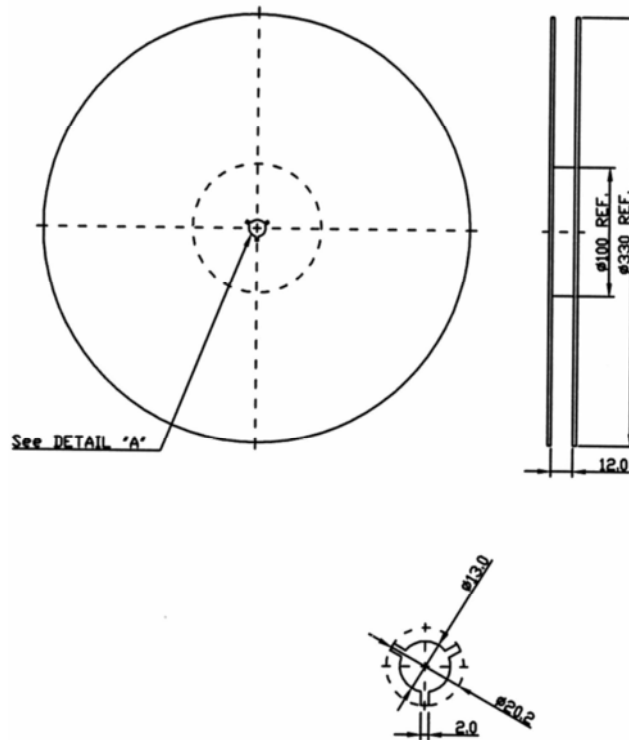

2. TAPE DIMENSION

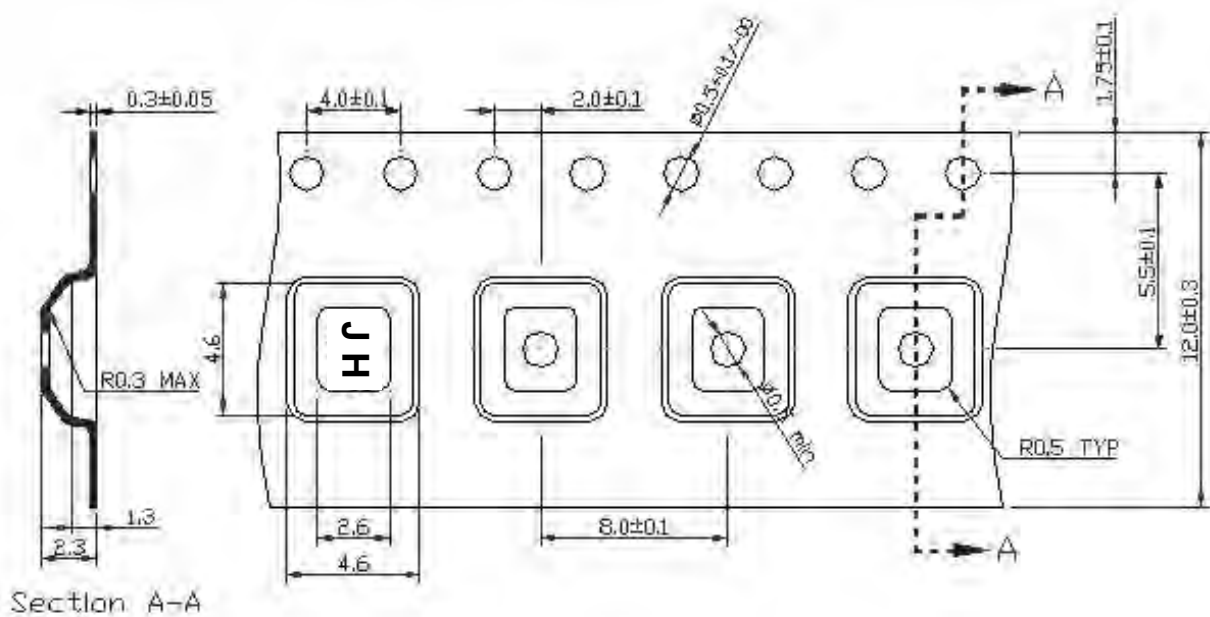

SAW Filter 899MHz

Model: TA1083A

Part No: MP02646

REV. NO.: 1

H. RECOMMENDED REFLOW PROFILE:

