SAW Filter 130.06MHz

Model: TB0682A

Part No: MP02832

REV. NO: 1

A. MAXIMUM RATING:

1. Operating Temperature: -10°C ~ 50°C
2. Storage Temperature: -40°C ~ +85°C
3. Input Power Level: 10dBm

B. CHARACTERISTICS:

1. Ambient Temperature: 25°C

Characteristics	Value			Note
	Min.	Typ.	Max.	
Center frequency Fc MHz	-	130.06	-	-
Minimum Insertion loss IL dB	-	7.3	8.5	-
1dB Bandwidth kHz	-	167	-	-
3dB Bandwidth kHz	160	239	250	-
40dB Bandwidth kHz	-	692	850	-
Passband Ripple Fc ± 40kHz dB	-	0.4	1.0	-
Temp Coefficient ppm/K ²	-	-0.036	-	-

SAW Filter 130.06MHz
Part No: **MP02832**

Model: TB0682A
REV. NO: 1

C. FREQUENCY CHARACTERISTICS:

1. S21 Response

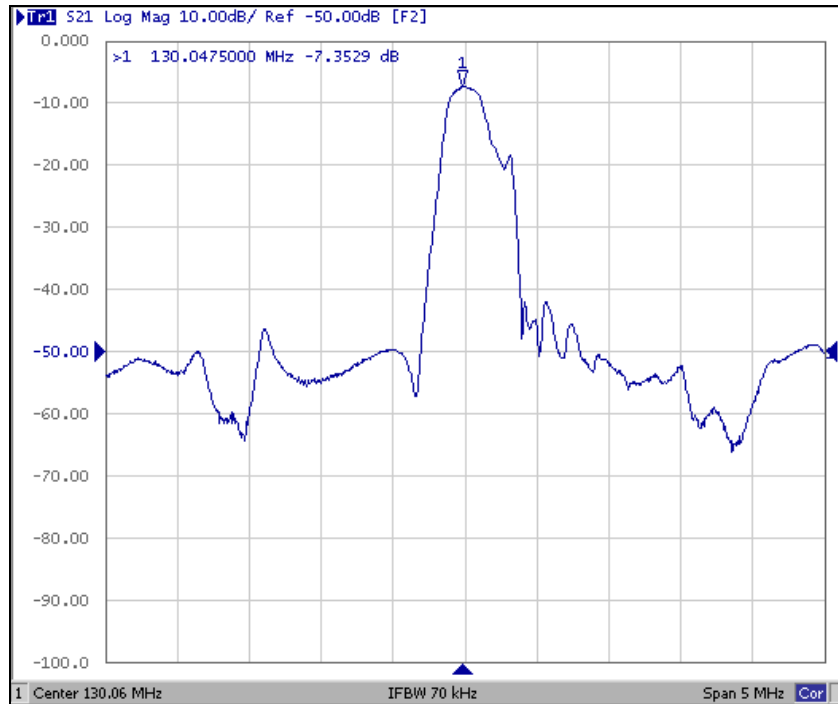

Fig1. Horizontal: 0.5MHz/Div Vertical: 10dB/Div

2. Passband Response and Group Delay Response

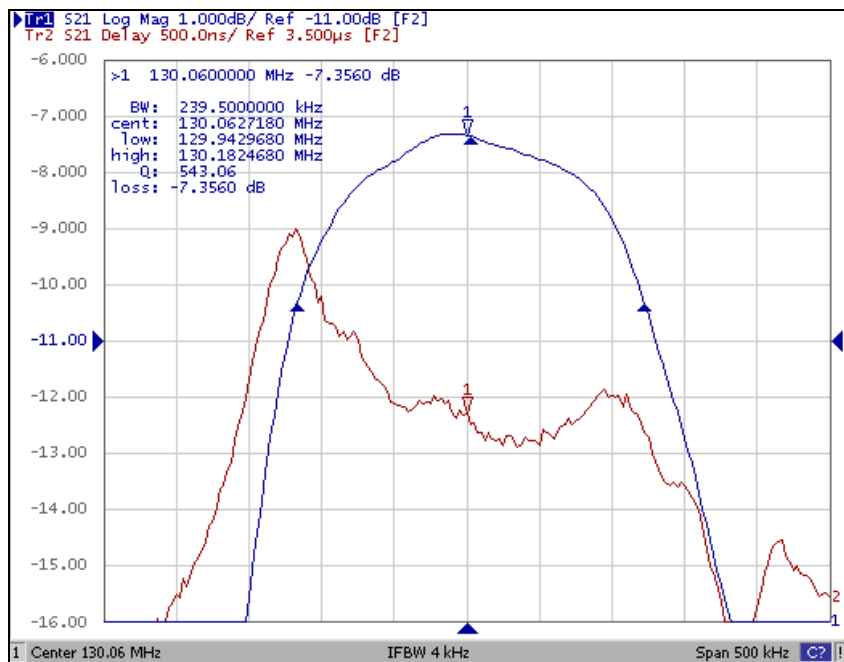

Fig2. Horizontal: 0.05MHz/Div Vertical 1: 1dB/Div
Vertical 2: 500nS/Div

SAW Filter 130.06MHz

Model: TB0682A

Part No: MP02832

REV. NO: 1

D. OUTLINE DRAWING:

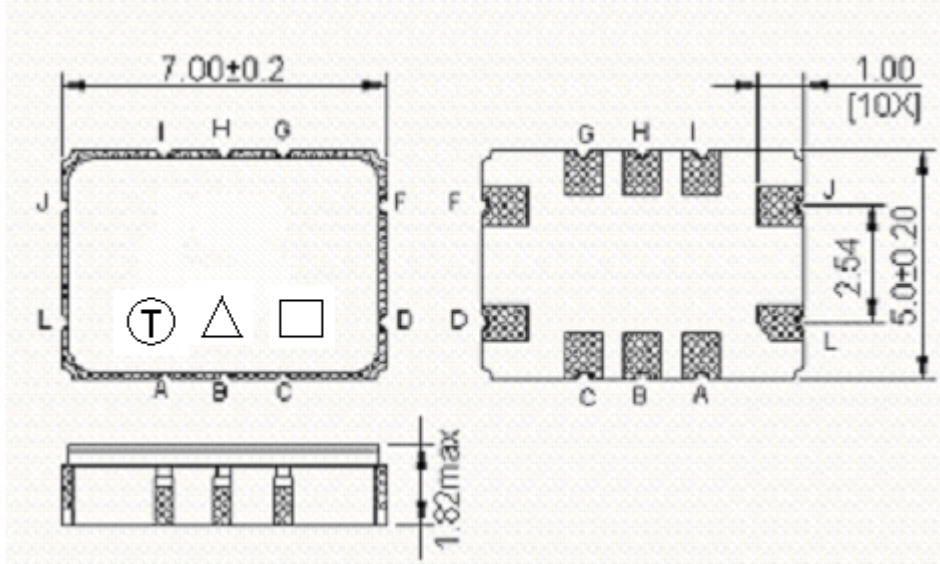

- Pin J - RF input
- Pin L - RF input ground
- Pin D - RF output
- Pin F - RF output ground
- Pin A, B, C, G, H, I – Ground

E. MATCHING CIRCUIT:

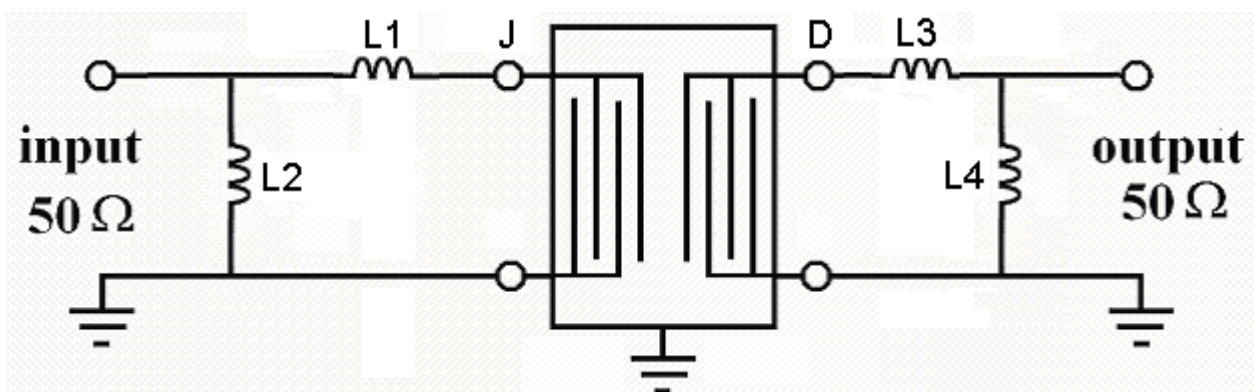

$L1 = 130\text{nH}$, $L2 = 56\text{pF}$, $L3 = 127\text{nH}$, $L4 = 56\text{pF}$

SAW Filter 130.06MHz

Model: TB0682A

Part No: MP02832

REV. NO: 1

F. PCB FOOTPRINT:

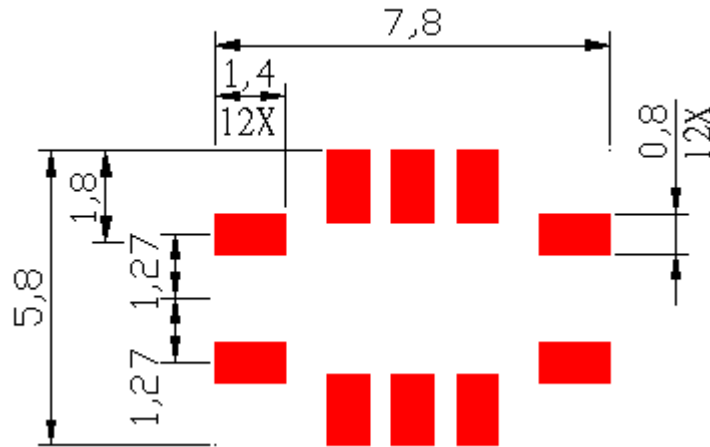

SAW Filter 130.06MHz
Part No: **MP02832**

Model: TB0682A
REV. NO: 1

G. PACKING:

1. Reel Dimension

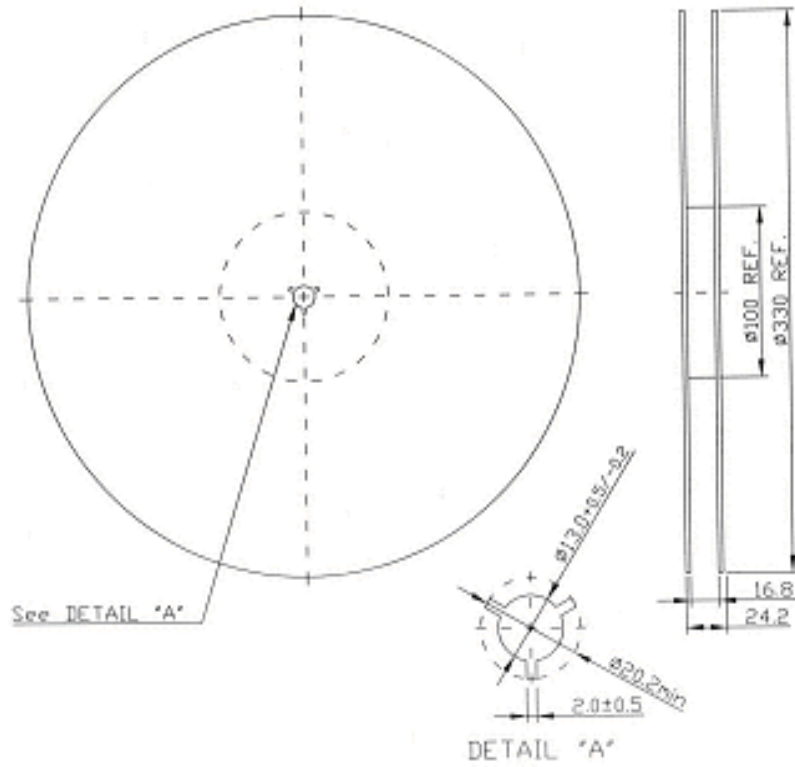

2. Tape Dimension

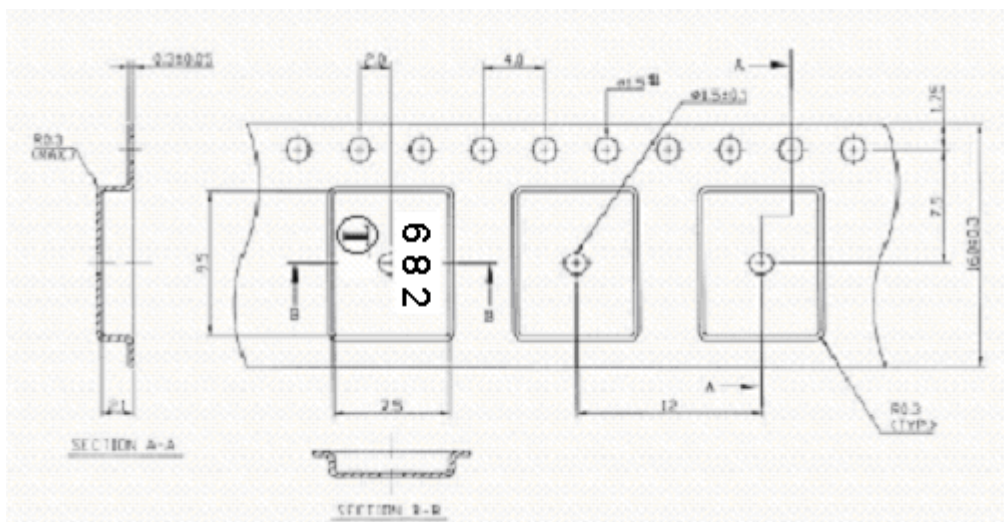

SAW Filter 130.06MHz

Model: TB0682A

Part No: MP02832

REV. NO: 1

H. RECOMMENDED REFLOW PROFILE:

