

SAW Filter 193.70MHz
Part No: MP03499

Model: TB0416A
Rev No: 1

A. MAXIMUM RATING:

1. Operating Temperature: -40°C ~ +85°C
2. Storage Temperature: -40°C ~ +85°C
3. Input Power Level: 10dBm

B. CHARACTERISTICS:

Ambient Temperature: 25°C

Characteristics	Value			Note
	Min.	Typ.	Max.	
Center frequency Fc MHz	-	193.7	-	-
Minimum Insertion loss IL dB	-	16.0	18.0	-
1dB Bandwidth MHz	10.0	11.7	-	-
3dB Bandwidth MHz	12.0	12.6	-	-
20dB Bandwidth MHz	-	14.7	15.7	-
Group Delay Ripple (Fc ± 5.0MHz) nsec	-	78	200	-
Passband Ripple (Fc ± 5.0MHz) dB	-	0.7	1.0	-
Relative Rejection (Reference to Minimum Insertion loss)				
10MHz ~ 180MHz dB	35	41	-	-
230MHz ~ 550MHzdB	38	43	-	-
550MHz ~ 600MHzdB	30	39	-	-
600MHz ~ 900MHz dB	40	48	-	-
Temp Coefficient ppm/°C	-	23	-	-

SAW Filter 193.70MHz
Part No: MP03499

Model: TB0416A
Rev No: 1

C. FREQUENCY CHARACTERISTICS:

1. S21 Response

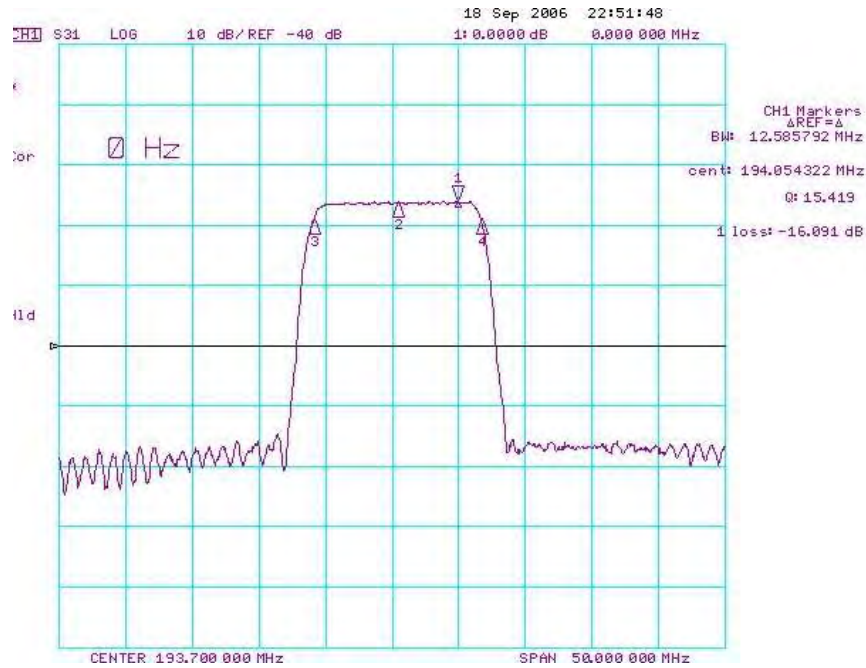

Fig. 1. Horizontal: 50MHz/Div, Vertical: 10dB/Div

2. Passband Response

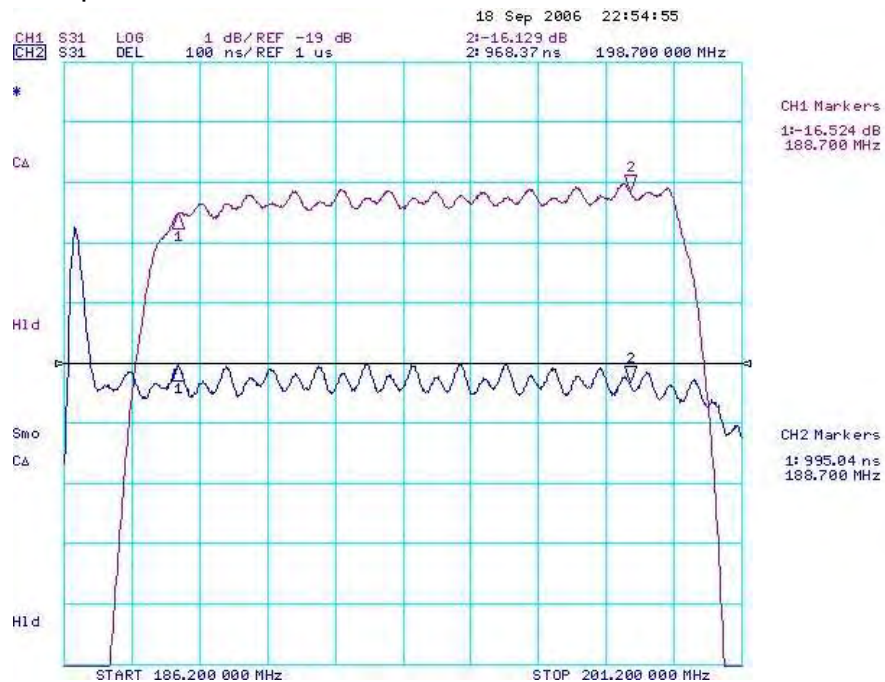
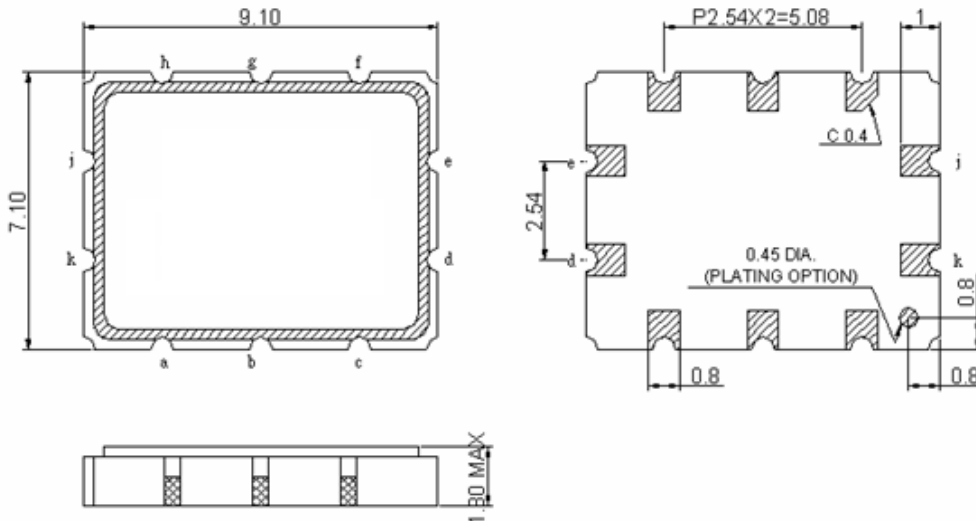

Fig. 2. Horizontal: 1.5MHz/Div, Vertical 1: 1dB/Div, Vertical 2: 100nS/Div

SAW Filter 193.70MHz
Part No: MP03499

Model: TB0416A
Rev No: 1

D. OUTLINE DRAWING:



H: RF Input
 C: RF Output
 A, B, D, E, F, G, J, K: To be ground
 Unit: mm

E. MATCHING CIRCUIT:

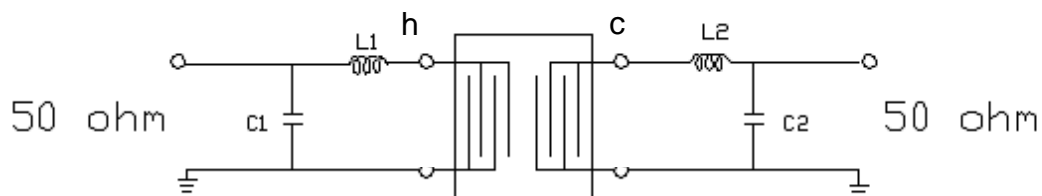

L1 = 33nH, C1 = 34pF, L2 = 33nH, C2 = 22pF

SAW Filter 193.70MHz
Part No: MP03499

Model: TB0416A
Rev No: 1

F. PACKING:

1. REEL DIMENSION

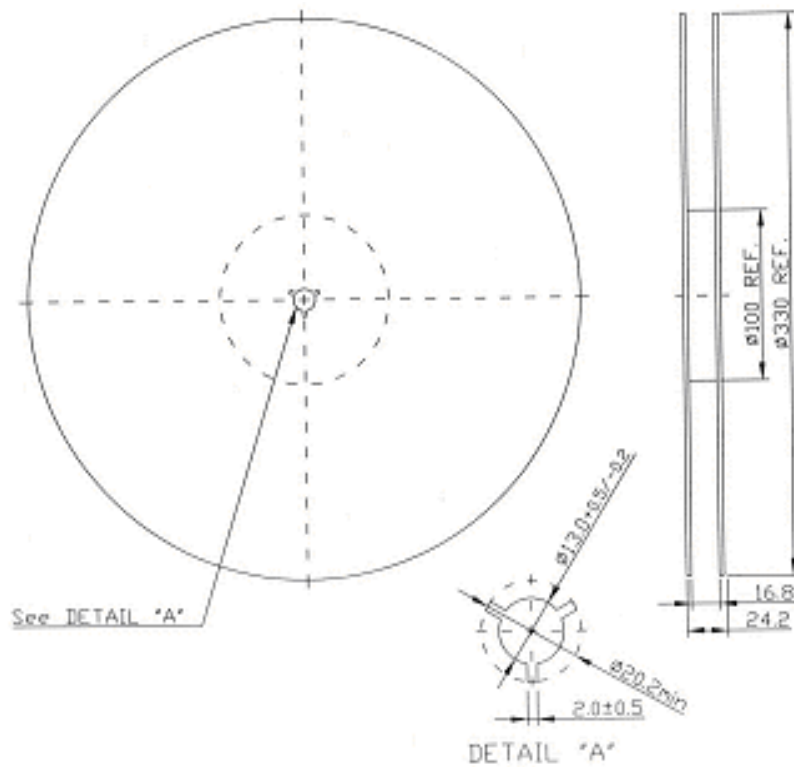

2. TAPE DIMENSION

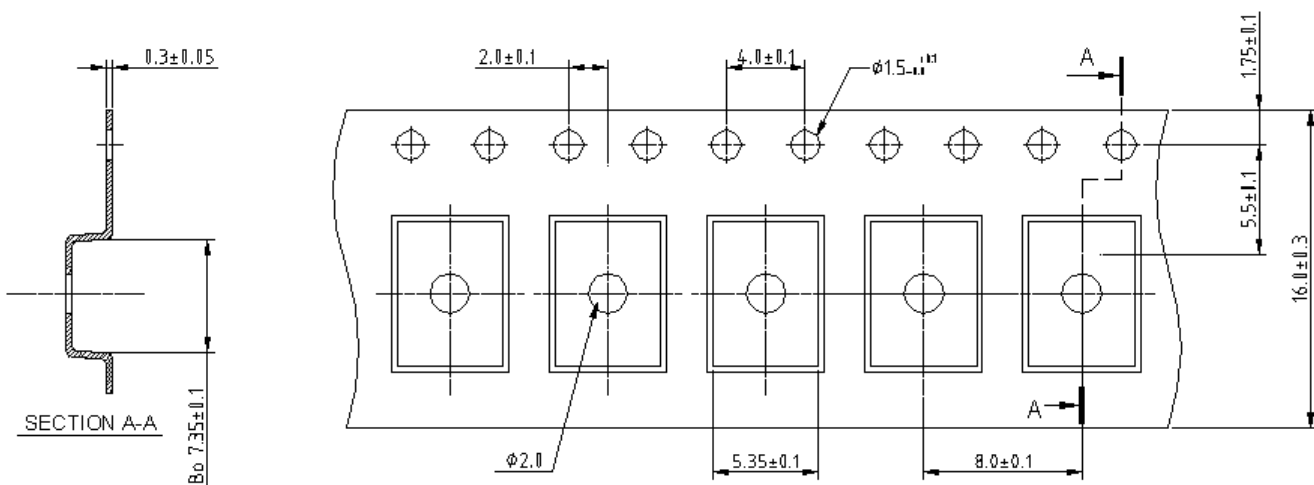

SAW Filter 193.70MHz
Part No: MP03499

Model: TB0416A
Rev No: 1

G. RECOMMENDED REFLOW PROFILE:

