

SAW Filter 490.0MHz
Part No: MP03883

Model: TB0715A
Rev No: 1

A. MAXIMUM RATING:

1. Input Power Level: 10dBm
2. Operating Temperature: -20°C ~ +70°C
3. Storage Temperature: -40°C ~ +85°C

B. CHARACTERISTICS:

Ambient Temperature: 25°C

Characteristics	Value			Note
	Min.	Typ.	Max.	
Center frequency Fc MHz	-	490	-	-
Minimum Insertion loss IL dB	-	10.9	15.0	-
3dB Bandwidth MHz	15.0	16.2	-	-
40dB Bandwidth	-	27.5	28.0	-
Amplitude Ripple (Fc ± 5.0MHz) dB	-	0.3	1.0	-
Group-delay Ripple (Fc ± 6.0MHz) nsec	-	12	40	-
Temp Coefficient ppm/°C	-	-18	-	-
Attenuation (Reference level from Minimum insertion loss)				
506MHz dB	45	49	-	-

SAW Filter 490.0MHz
Part No: MP03883

Model: TB0715A
Rev No: 1

C. FREQUENCY CHARACTERISTICS:

1. S21 Response :(span 200MHz)

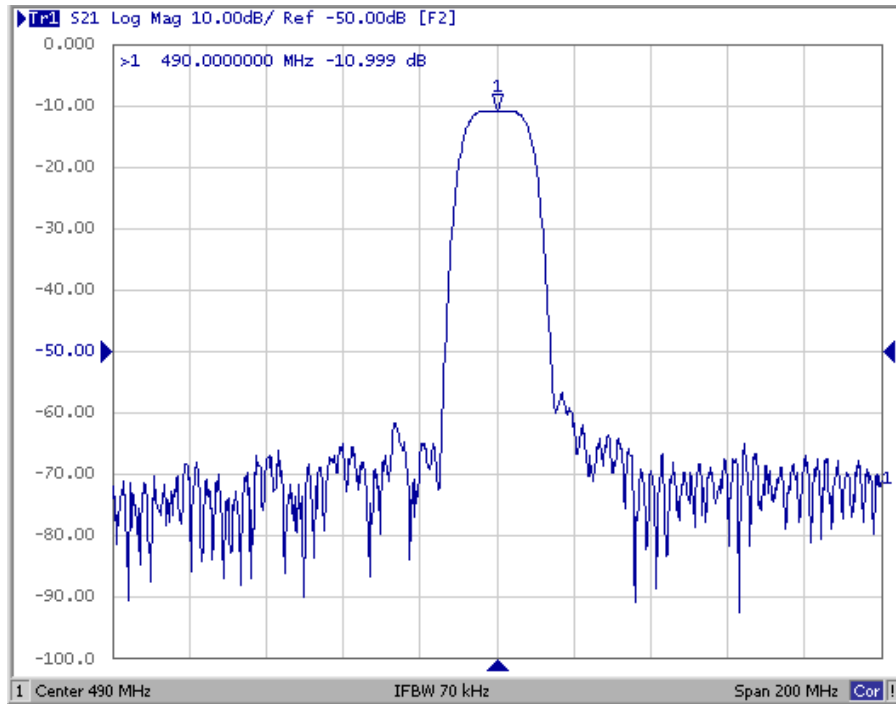

2. Passband of Response: (span: 20MHz)

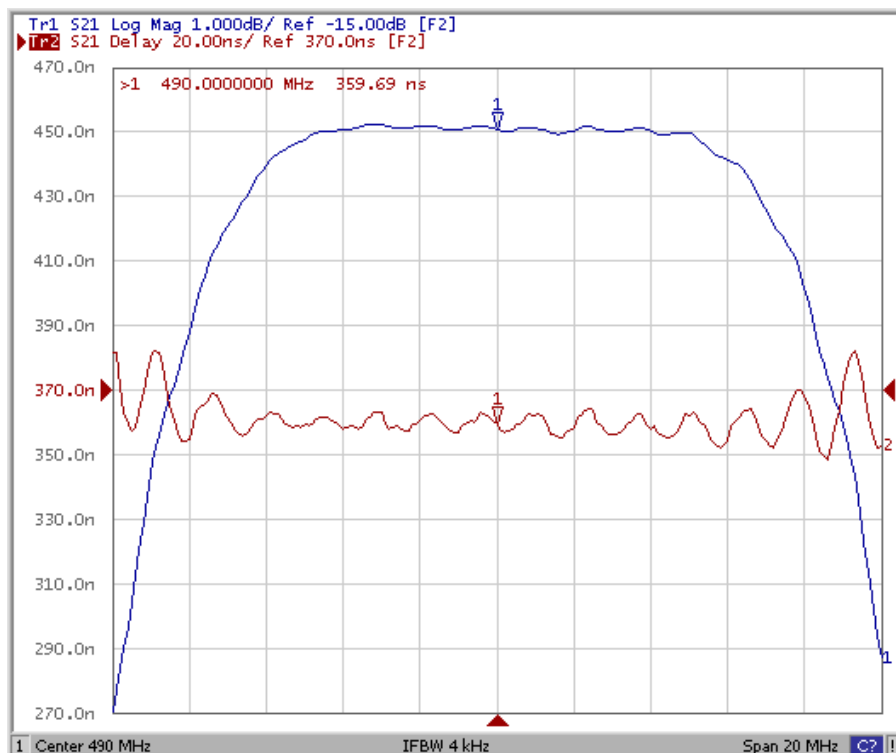

SAW Filter 490.0MHz
Part No: MP03883

Model: TB0715A
Rev No: 1

3. S11 Smith Chart: (span 200MHz)

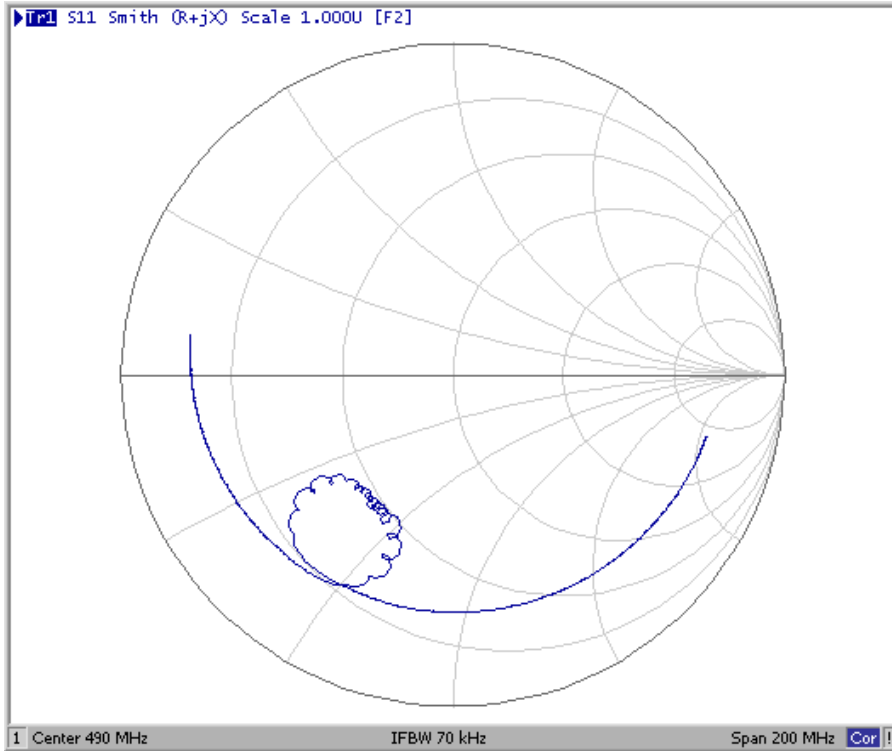

4. S22 Smith Chart: (span 200MHz)

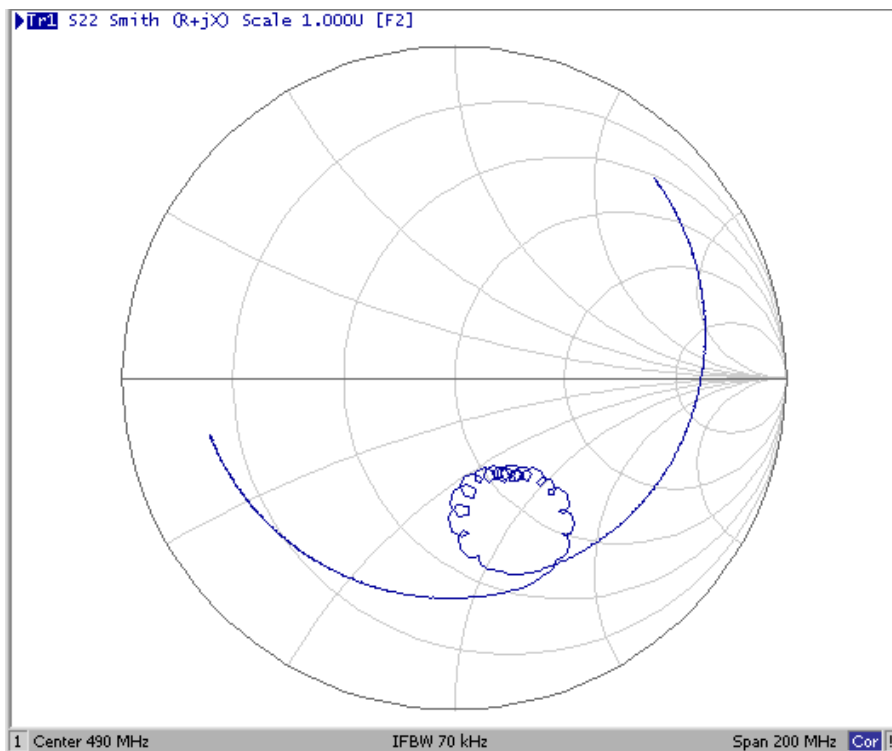

SAW Filter 490.0MHz
Part No: MP03883

Model: TB0715A
Rev No: 1

D. TEST CIRCUIT:

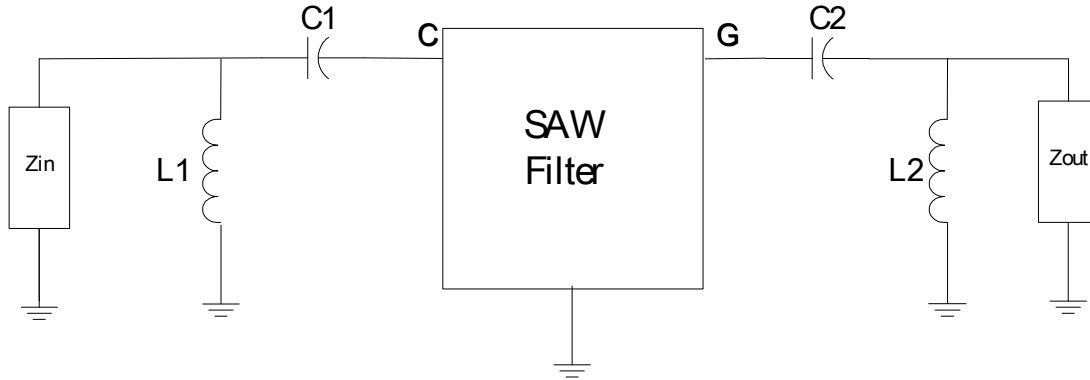

Z_{IN} and Z_{OUT} are 50Ω , $L1 = 15nH$, $C1 = 24p$, $L2 = 12nH$, $C2 = 24p$,

E. OUTLINE DRAWING:

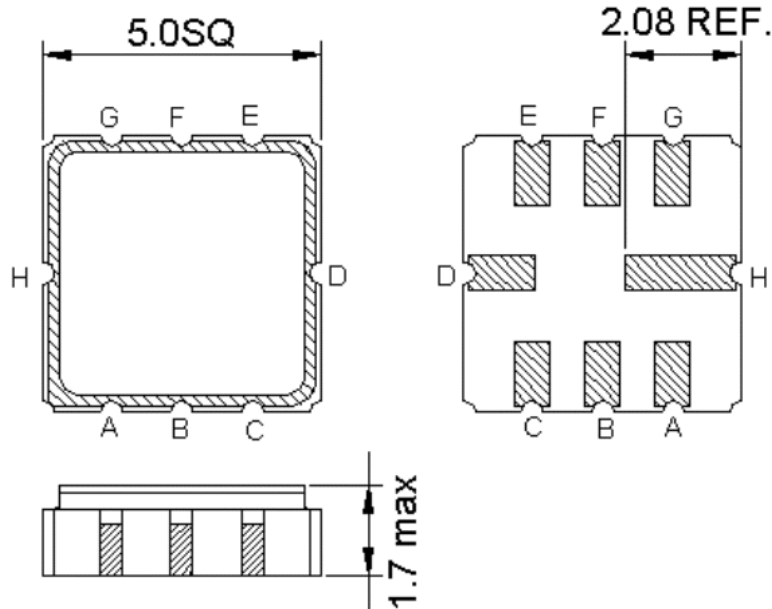

C: RF input
 G: RF output
 H, D: Case Ground
 A, B, E, F: Ground
 Unit: mm

SAW Filter 490.0MHz
Part No: MP03883

Model: TB0715A
Rev No: 1

F. PACKING:

1. REEL DIMENSION

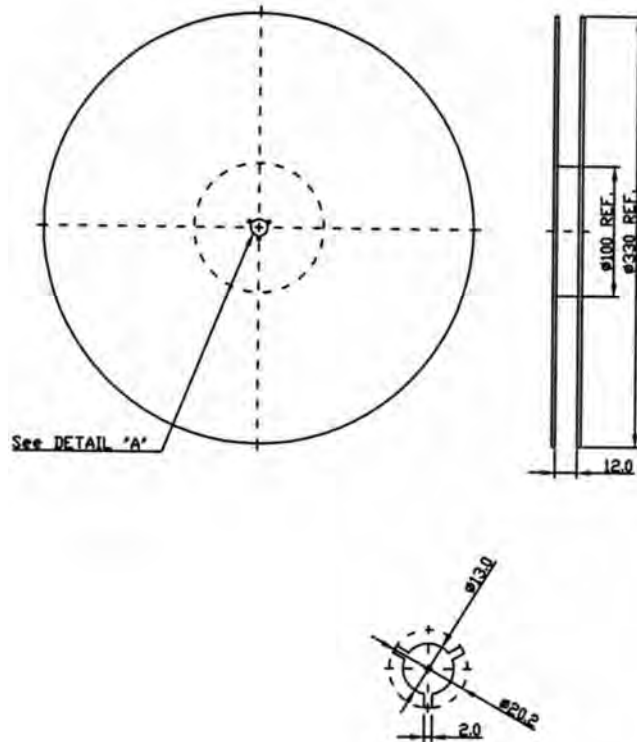

2. TAPE DIMENSION

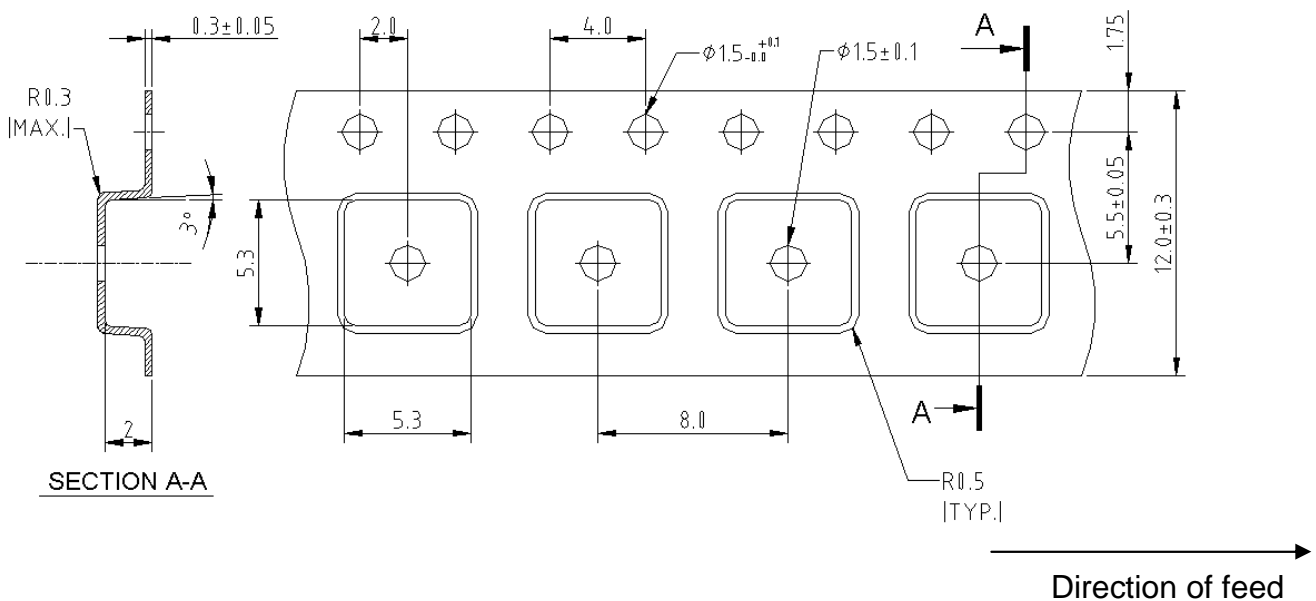

SAW Filter 490.0MHz
Part No: MP03883

Model: TB0715A
Rev No: 1

G. RECOMMENDED REFLOW PROFILE:

