

SAW Filter 2120.0MHz
Part No: MP04485

Model: TA0653A
Rev No: 1

A. MAXIMUM RATING:

1. Input Power Level: 10dBm
2. DC voltage: 3V
3. Operating Temperature: -30°C to +85°C
4. Storage Temperature: -40°C to +85°C

B. ELECTRICAL CHARACTERISTICS:

Item	Min.	Typ.	Max.
Center frequency Fc (dB)	-	2120	-
Insertion loss within 2110 ~ 2130MHz IL (dB)	-	2.4	4
Amplitude ripple (p-p) within 2110 ~ 2130MHz (dB)	-	0.7	2.0
Attenuation (Reference level from 0dB)			
DC ~ 500MHz (dB)	20	32	-
500 ~ 1900MHz (dB)	18	28	-
1900 ~ 2040MHz (dB)	22	33	-
2220 ~ 2300MHz (dB)	24	36	-
2300 ~ 4000MHz (dB)	22	34	-
VSWR within 2110 ~ 2130MHz	-	1.7	2.5
Source impedance Z _S (Ω)	-	50	-
Load impedance Z _L (Ω)	-	50	-

C. MEASUREMENT CIRCUIT:

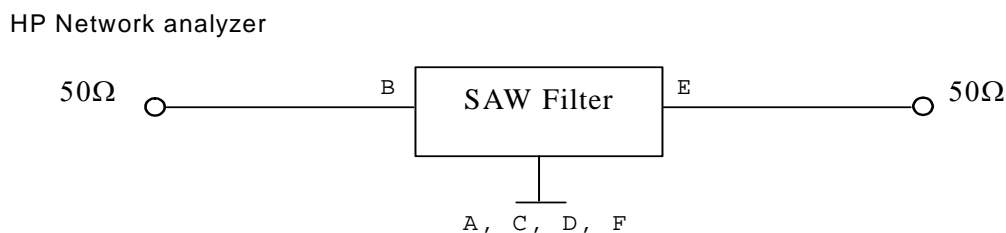

SAW Filter 2120.0MHz
Part No: MP04485

Model: TA0653A
Rev No: 1

D. OUTLINE DRAWING:

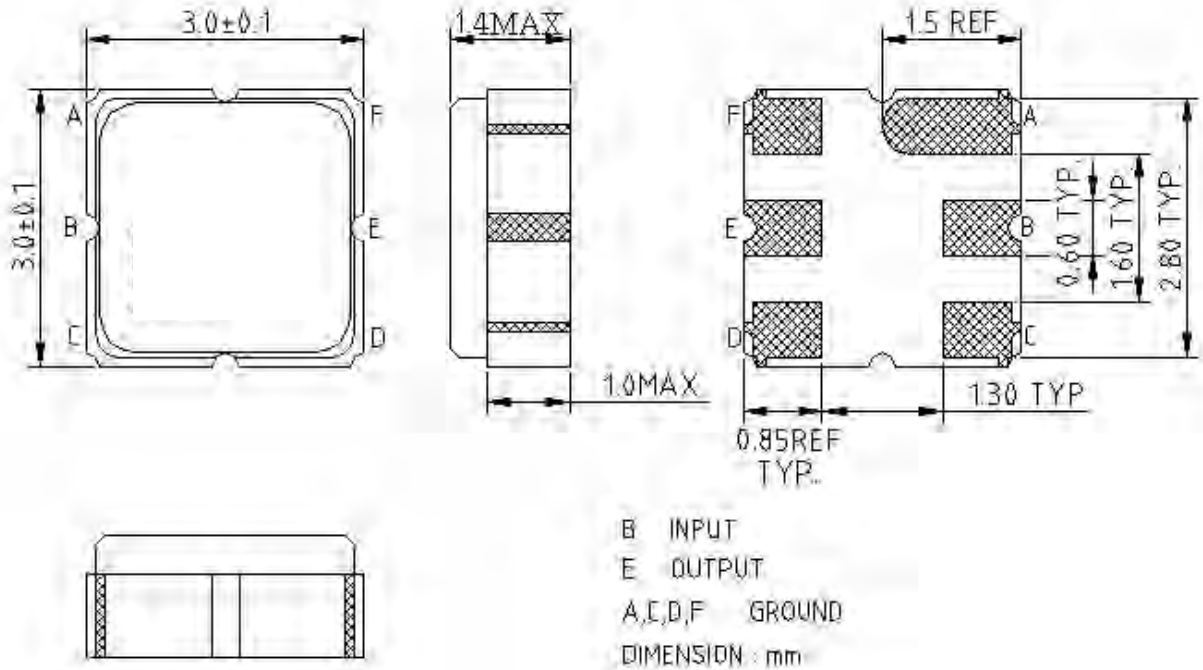

E. PCB FOOTPRINT:

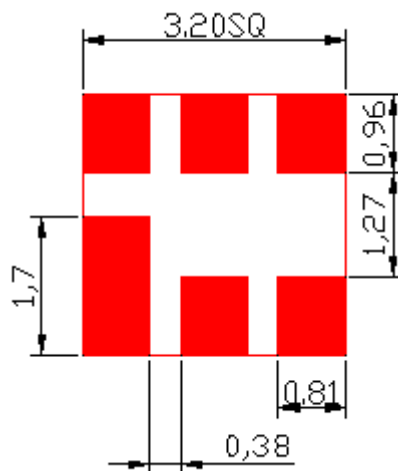

SAW Filter 2120.0MHz
Part No: MP04485

Model: TA0653A
Rev No: 1

F. FREQUENCY CHARACTERISTICS:

1. Transfer functions

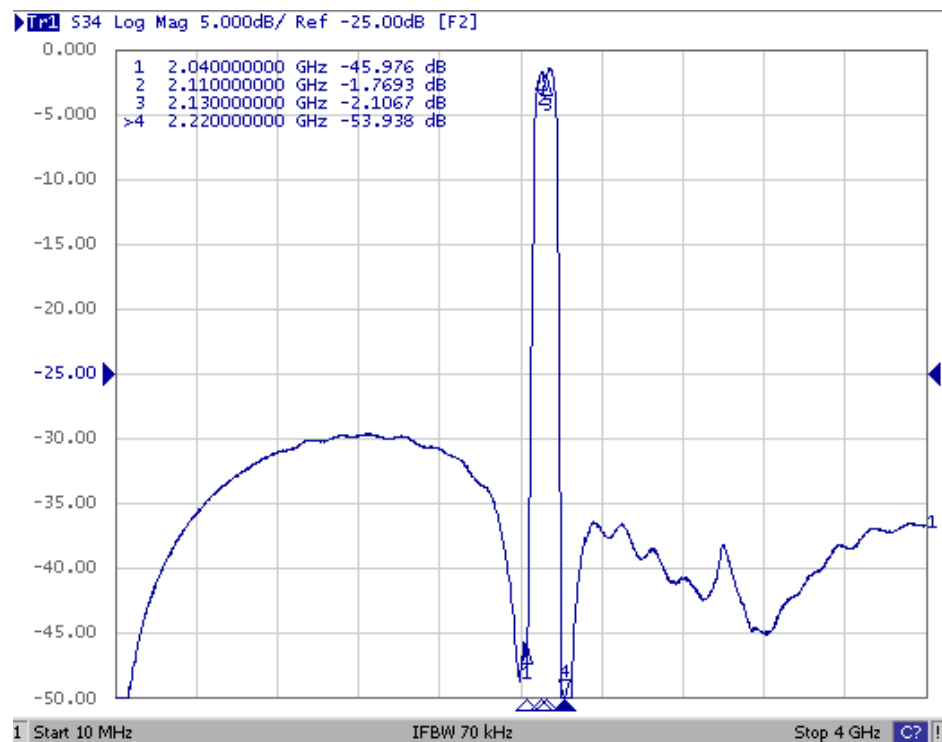
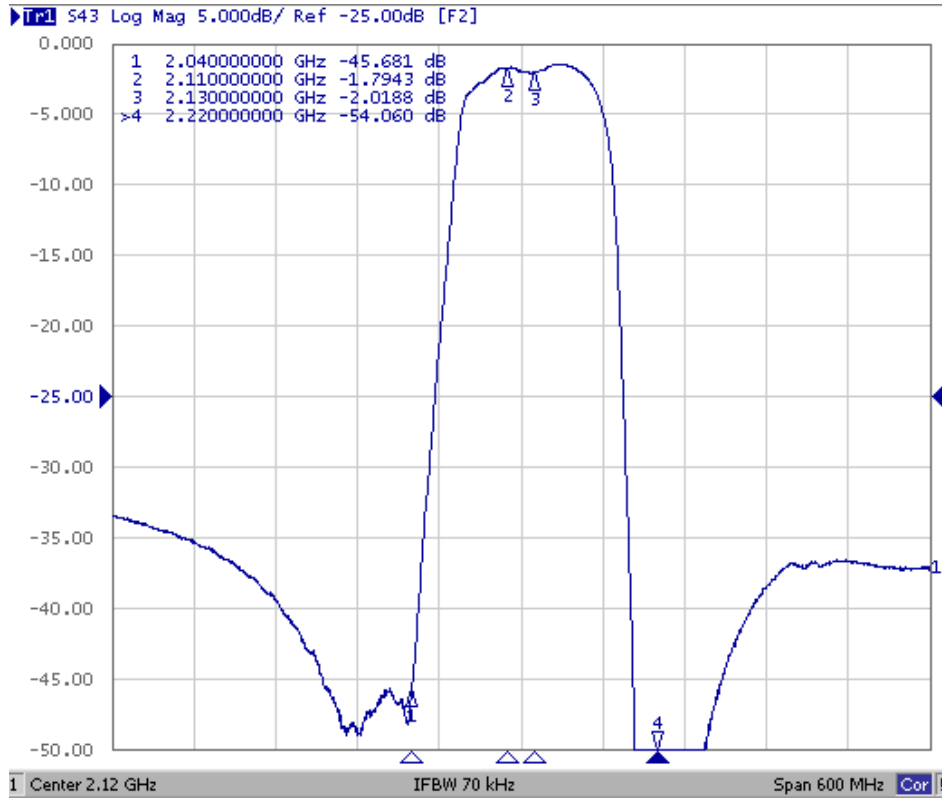

SAW Filter 2120.0MHz
Part No: MP04485

Model: TA0653A
Rev No: 1

2. Reflections Functions

S11 VSWR

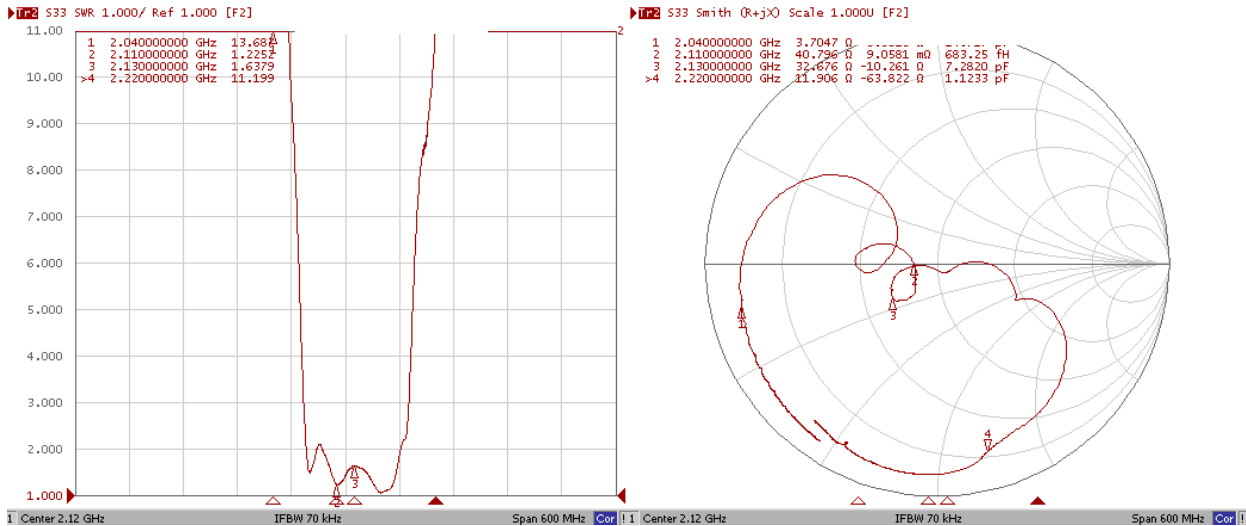

S22 VSWR

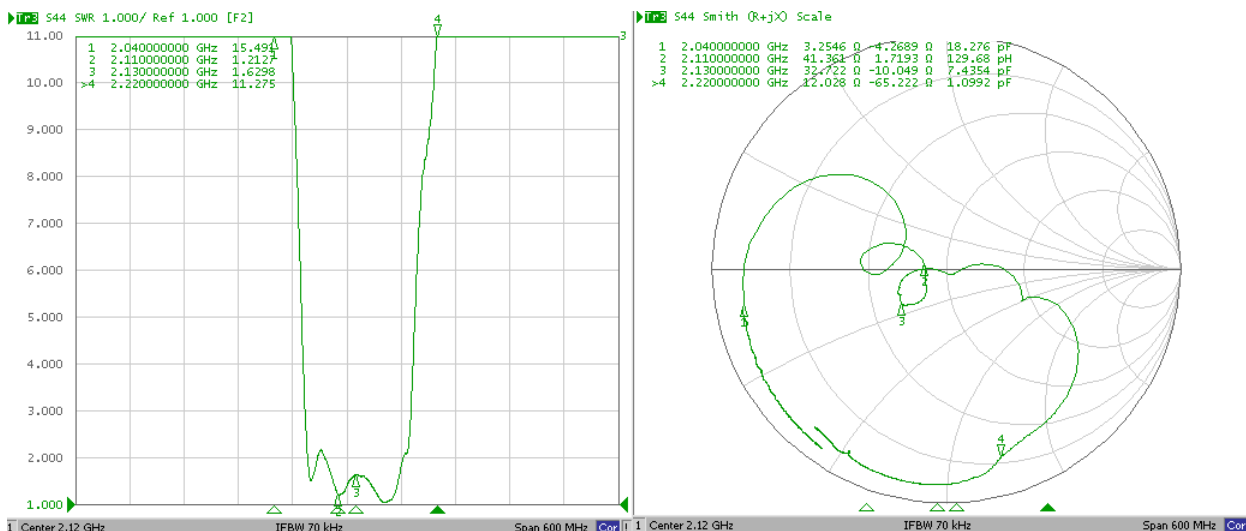

SAW Filter 2120.0MHz
Part No: MP04485

Model: TA0653A
Rev No: 1

G. PACKING:

1. Reel Dimension

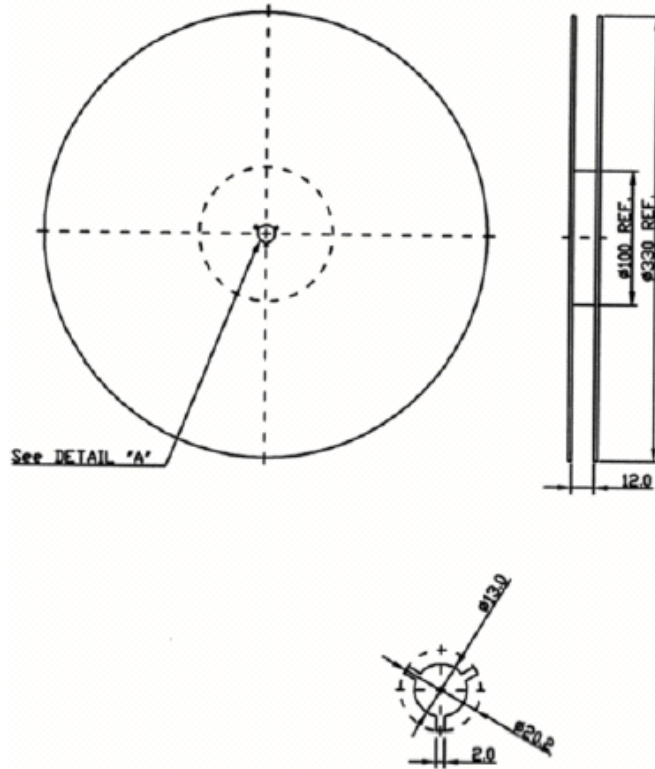

2. Tape Dimension

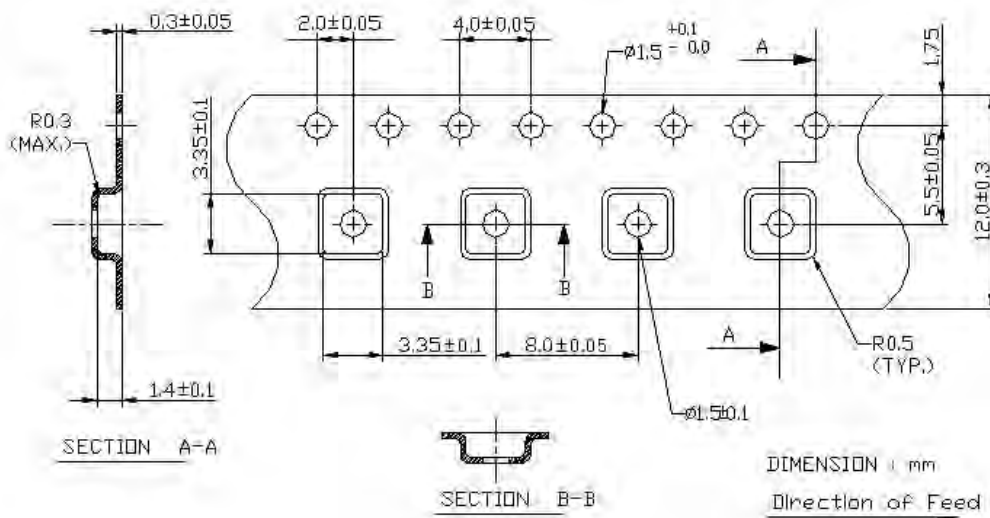

SAW Filter 2120.0MHz
Part No: MP04485

Model: TA0653A
Rev No: 1

H. RECOMMENDED REFLOW PROFILE:

