

SAW Filter 169.43750MHz
Part No: MP05369

Model: TB1064A
Rev No: 1

A. MAXIMUM RATING:

Electrostatic Sensitive Device (ESD)

1. Input Power Level: 10dBm
2. DC voltage: 5 V
3. Operating Temperature: -20°C to +70°C
4. Storage Temperature: -40°C to +85°C

B. ELECTRICAL CHARACTERISTICS:

Item	Unit	Min.	Typ.	Max.	Note
Center frequency Fc	MHz	-	169.4375	-	-
Insertion loss at center frequency IL c	dB	-	3	5	-
Ripple (169.43375 ~ 169.44125MHz)	dB	-	0.1	±1	-
Attenuation (reference level from IL c)					
Fc -4 to Fc -0.92MHz	dB	40	60	-	-
Fc -0.92 to Fc -0.31MHz	dB	30	55	-	-
Fc +0.31 to Fc +0.92MHz	dB	30	55	-	-
Fc +0.92 to Fc +4MHz	dB	40	42	-	-
Temperature coefficient of frequency TCf	-0.033 ppm/C ²				

Note: Considering -12kHz frequency shift from -20°C to +70°C

SAW Filter 169.43750MHz
Part No: MP05369

Model: TB1064A
Rev No: 1

C. OUTLINE DRAWING:

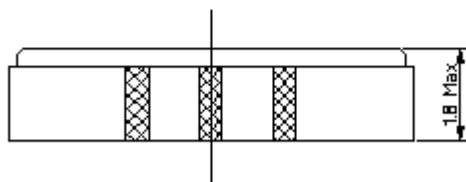
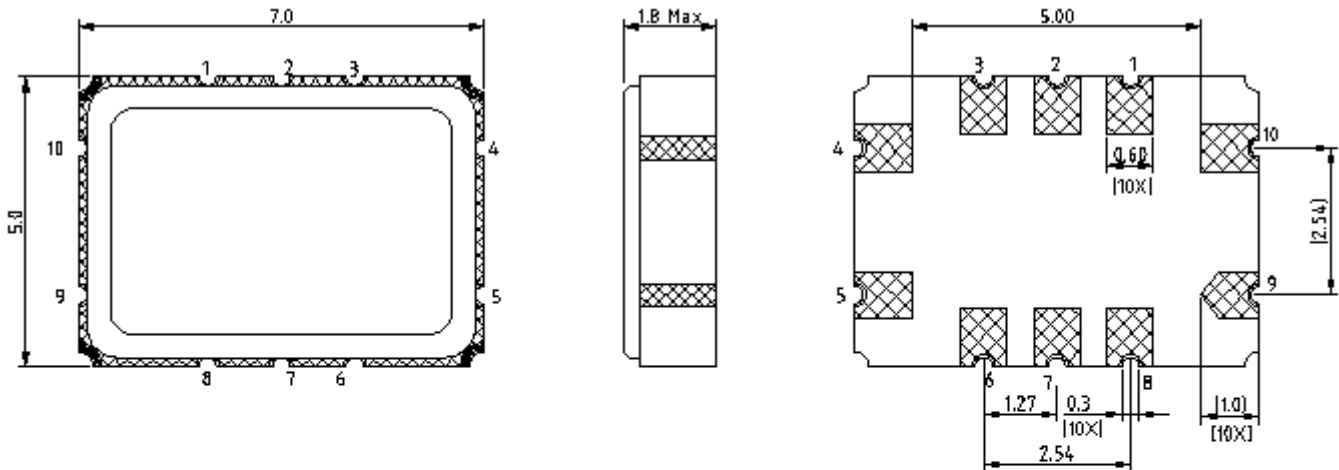

- 9: Input
- 4: Output
- 10: Balance input or input ground
- 5: Balance output or output ground
- 1, 2, 3, 6, 7, 8: To be grounded

D. MEASUREMENT CIRCUIT:

50Ω Test circuit (single-ended / single-ended)

HP Network analyzer

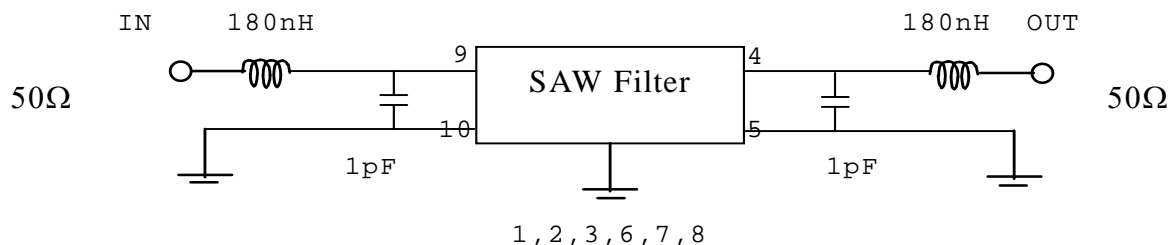

SAW Filter 169.43750MHz
Part No: MP05369

Model: TB1064A
Rev No: 1

E. FREQUENCY CHARACTERISTICS:

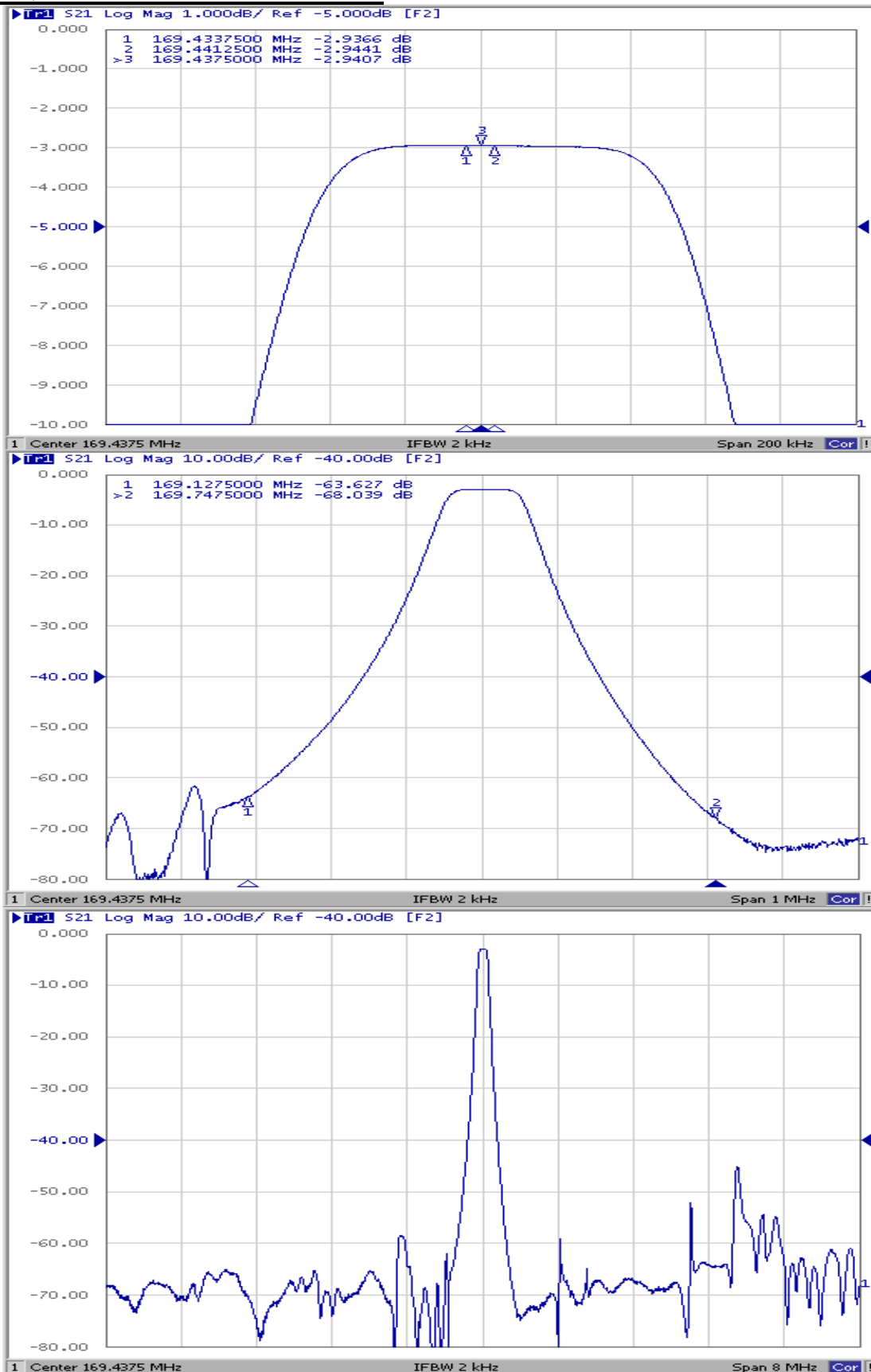

SAW Filter 169.43750MHz
Part No: MP05369

Model: TB1064A
Rev No: 1

F. PACKING:

1. Reel Dimension

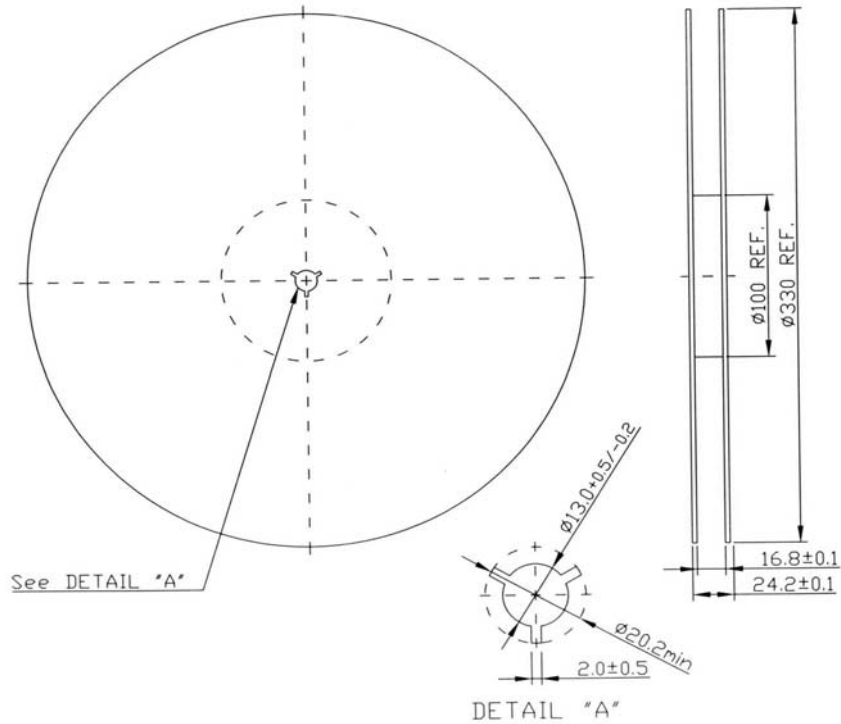

2. Tape Dimension

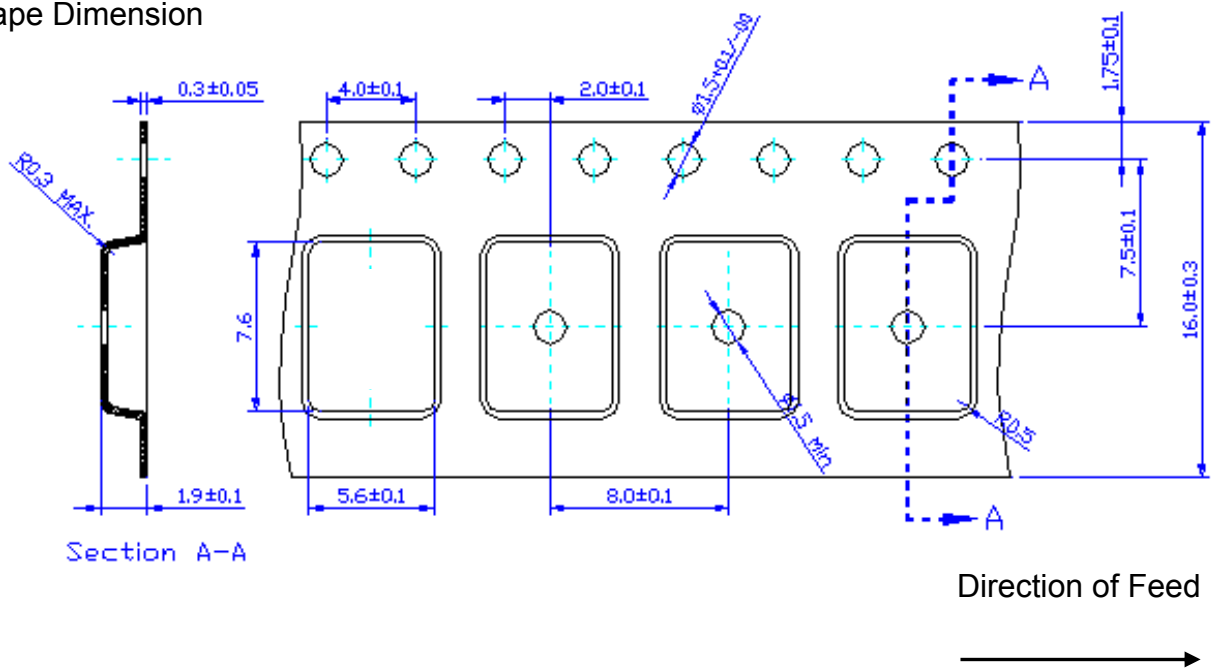

SAW Filter 169.43750MHz
Part No: MP05369

Model: TB1064A
Rev No: 1

G. RECOMMENDED REFLOW PROFILE:

1. Preheating shall be fixed at 150 ~ 180°C for 60 ~ 90 seconds.
2. Ascending time to preheating temperature 150°C shall be 30 seconds min.
3. Heating shall be fixed at 220°C for 50 ~ 80 seconds and at 245 ~ 260°C peak (min. 10 sec).
4. Time: 2 times.

