

**SAW Filter: 413.0MHz**  
**Part No: MP05383**

**Model: TA1663A**  
**Rev No: 1**

**A. MAXIMUM RATING:**

**Electrostatic Sensitive Device (ESD)**

1. Input Power Level: 15dBm
2. DC Voltage: 3V
3. Operating Temperature: -40°C to +85°C
4. Storage Temperature: -40°C to +85°C

**B. ELECTRICAL CHARACTERISTICS:**

Item	Unit	Min.	Typ.	Max.
Center frequency Fc	MHz	-	413	-
Insertion Loss (412 ~ 414MHz) IL	dB	-	1.5	3.0
Amplitude Ripple (412 ~ 414MHz)	dB	-	0.2	1.5
VSWR (412 ~ 414MHz)	-	-	1.3	2.2
Attenuation (Reference level from 0dB)				
10 ~ 400MHz	dB	50	56	-
400 ~ 405MHz	dB	10	47	-
425 ~ 430MHz	dB	20	37	-
430 ~ 440MHz	dB	30	40	-
440 ~ 800MHz	dB	50	59	-
800 ~ 1000MHz	dB	45	56	-
Temperature coefficient of frequency	ppm/°C	-	-36	-

**C. MEASUREMENT CIRCUIT:**

HP Network analyzer

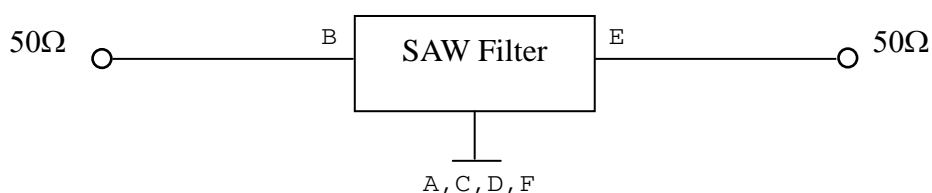

**SAW Filter: 413.0MHz**  
**Part No: MP05383**

**Model: TA1663A**  
**Rev No: 1**

**D. OUTLINE DRAWING:**

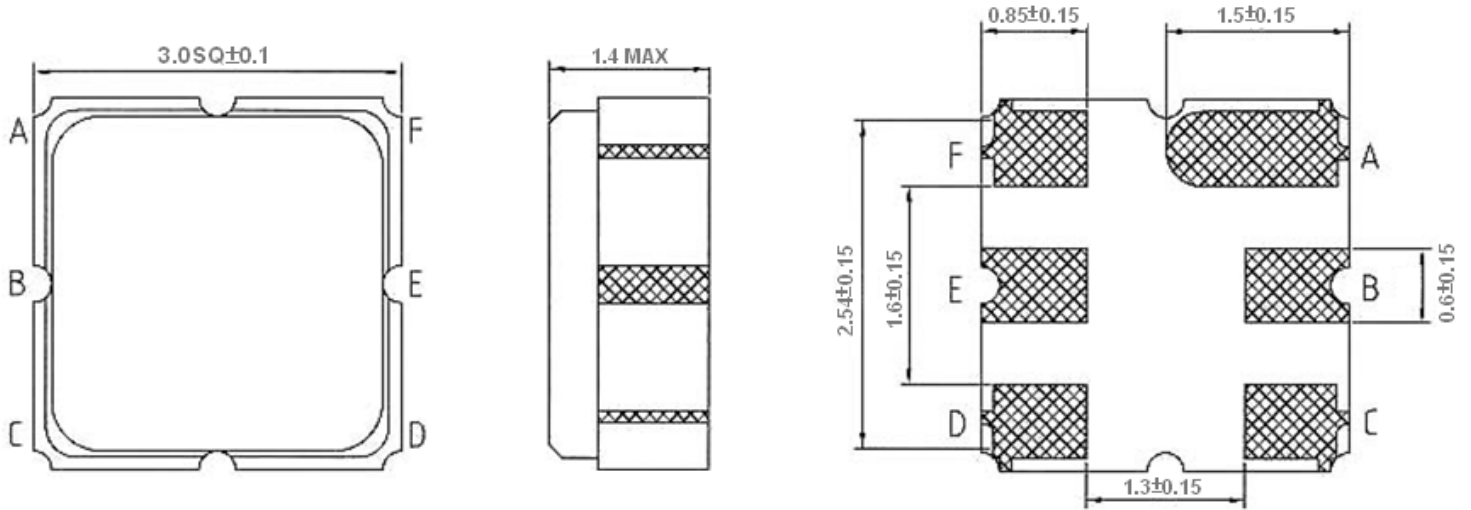

B: Input  
 E: Output  
 A, C, D, F: Ground  
 Unit: mm

**E. PCB FOOTPRINT:**

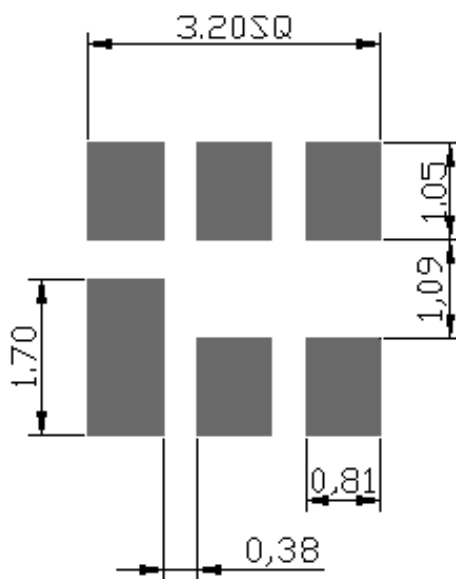

**SAW Filter: 413.0MHz**  
**Part No: MP05383**

**Model: TA1663A**  
**Rev No: 1**

**F. FREQUENCY CHARACTERISTICS:**

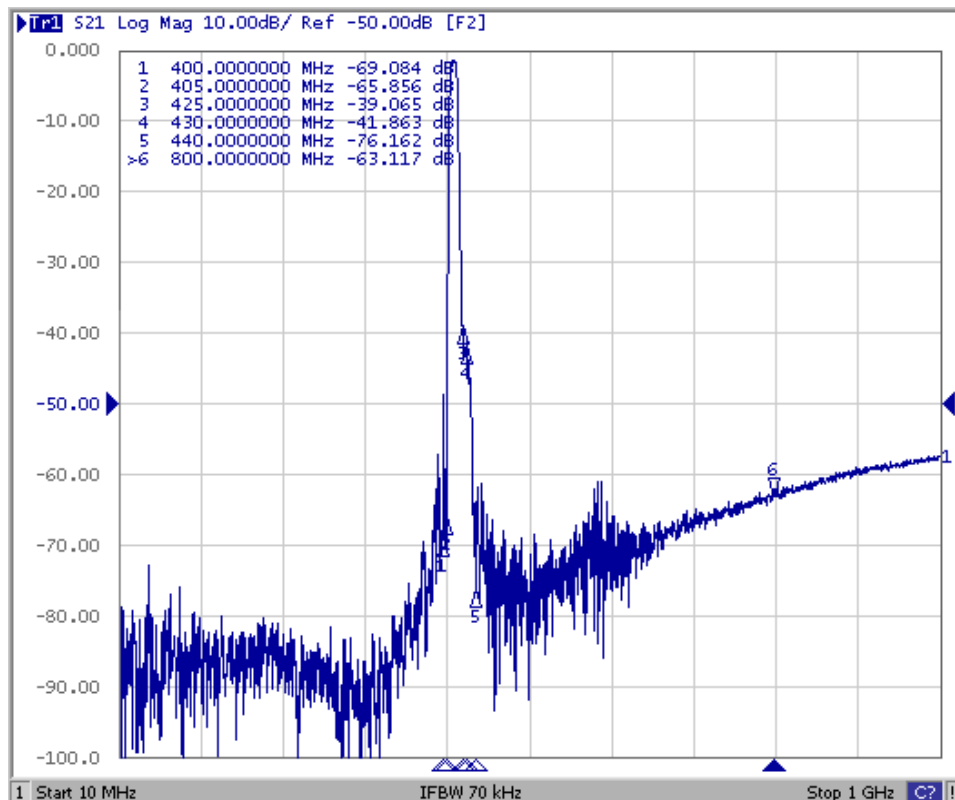
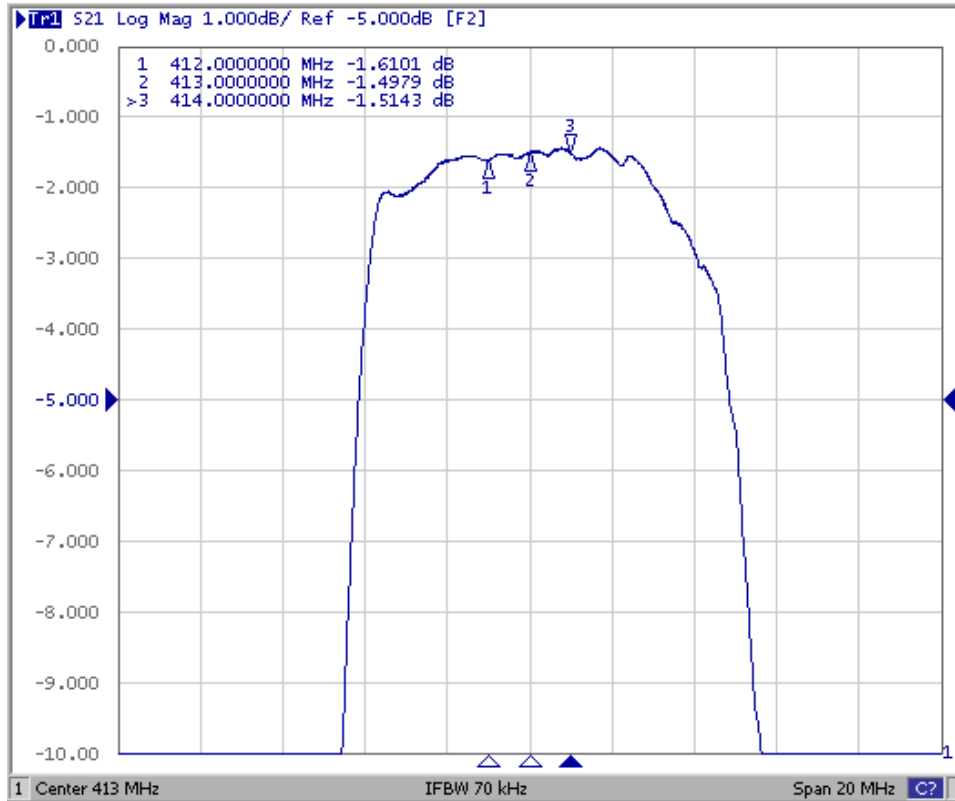

**SAW Filter: 413.0MHz**  
**Part No: MP05383**

**Model: TA1663A**  
**Rev No: 1**

Reflection Functions

S11

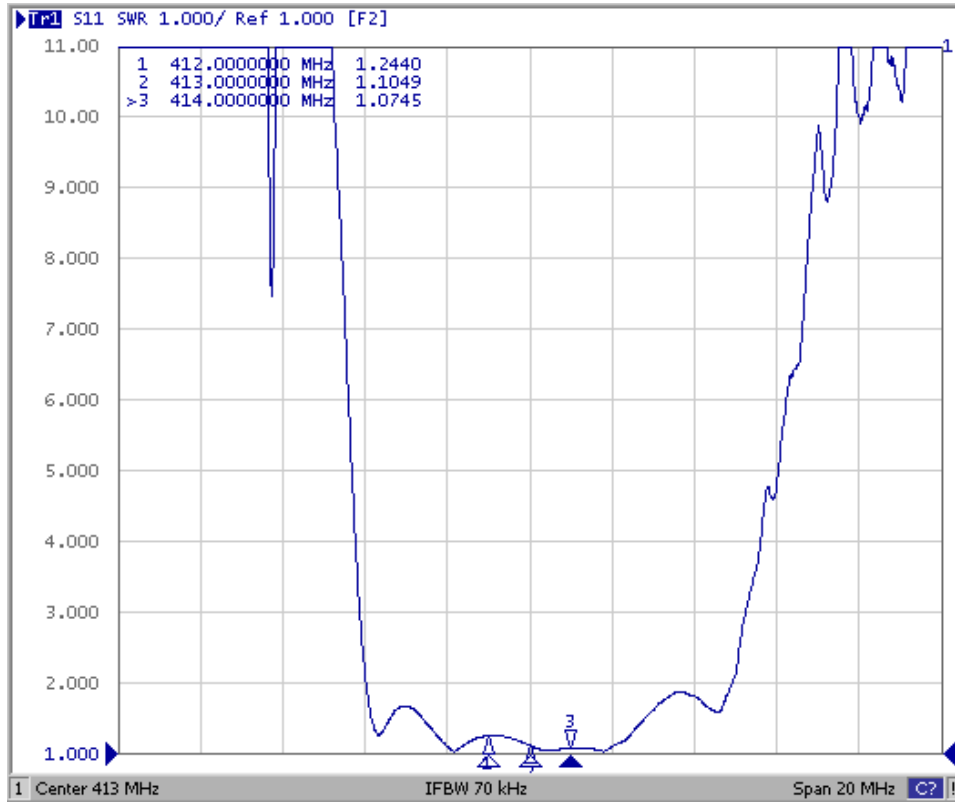

S22

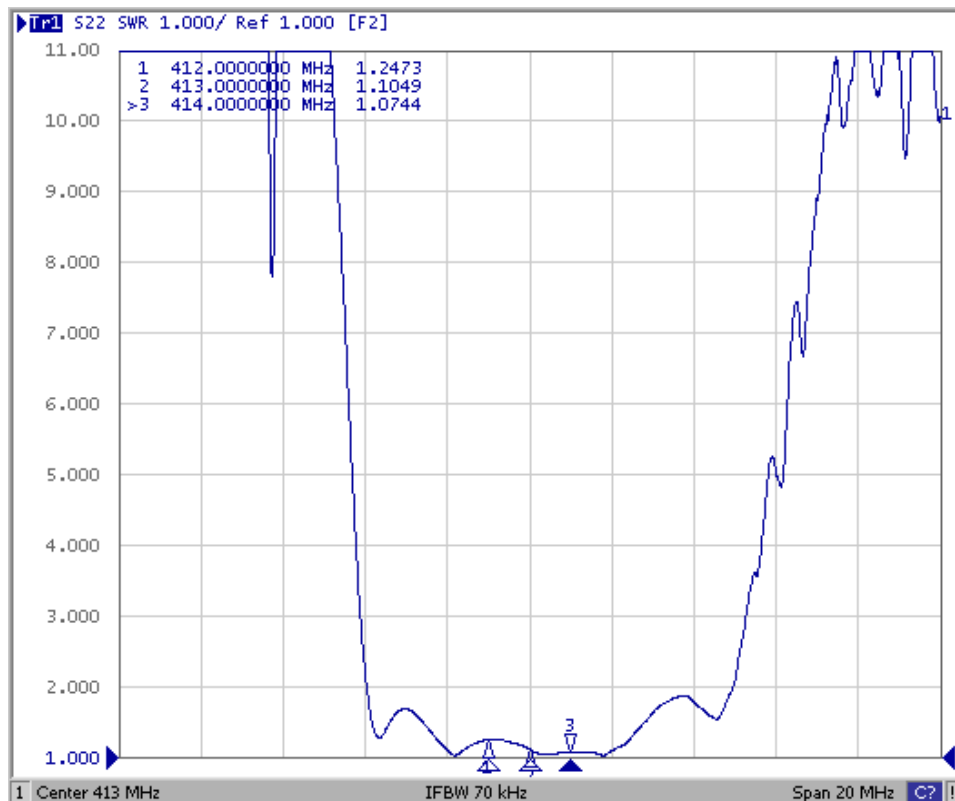

**SAW Filter: 413.0MHz**  
**Part No: MP05383**

**Model: TA1663A**  
**Rev No: 1**

**G. PACKING:**

1. Reel Dimension

(Please refer to FR-75D10 for packing quantity)

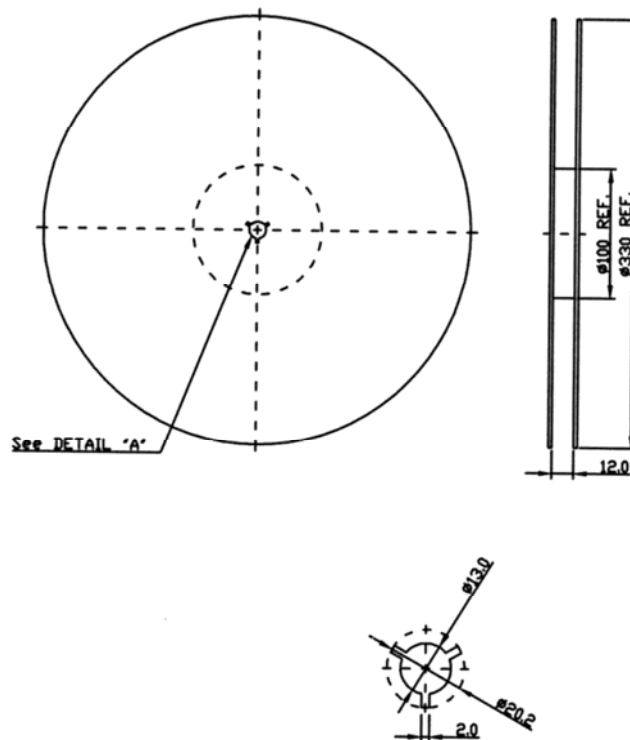

2. Tape Dimension

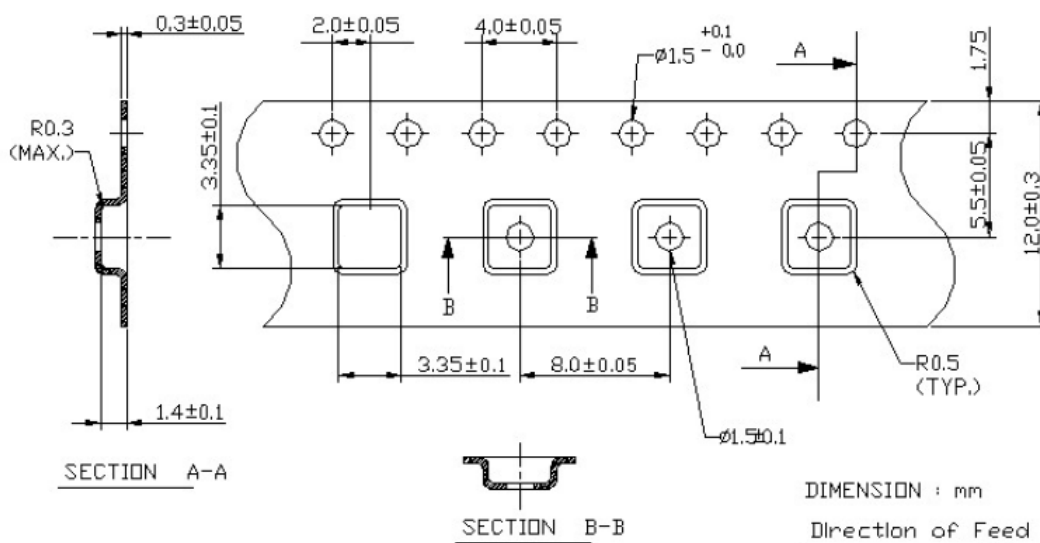

**SAW Filter: 413.0MHz**  
**Part No: MP05383**

**Model: TA1663A**  
**Rev No: 1**

**H. RECOMMENDED REFLOW PROFILE:**

