

SAW Filter: 1579.50MHz
Part No: MP05601

Model: TA1621A
Rev No: 1

A. MAXIMUM RATING:

Electrostatic Sensitive Device (ESD)

1. Input Power Level: 10dBm
2. DC Voltage: 3V
3. Operating Temperature: -40°C to +85°C
4. Storage Temperature: -40°C to +85°C

B. ELECTRICAL CHARACTERISTICS:

Item	Unit	Min.	Typ.	Max.
Center frequency Fc	dB	-	1579.5	-
Insertion loss within 1551 ~ 1608MHz IL	dB	-	2.1	3.8
Amplitude ripple (p-p) within 1551 ~ 1608MHz	dB	-	1.1	2.5
VSWR within 1551 ~ 1608MHz	-	-	1.8	2.5
Attenuation (Reference level from 0dB)				
10.000 ~ 1490.0MHz	dB	17	25	-
1700.0 ~ 2300.0MHz	dB	23	28	-
2300.0 ~ 3000.0MHz	dB	20	28	-
Temperature Coefficient of Frequency	ppm/°C	-	-36	-
Source impedance Z _S	Ω	-	50	-
Load impedance Z _L	Ω	-	50	-

SAW Filter: 1579.50MHz
Part No: MP05601

Model: TA1621A
Rev No: 1

C MEASUREMENT CIRCUIT:

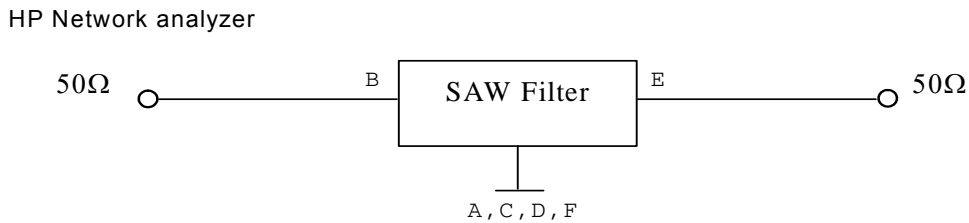

D. OUTLINE DRAWING:

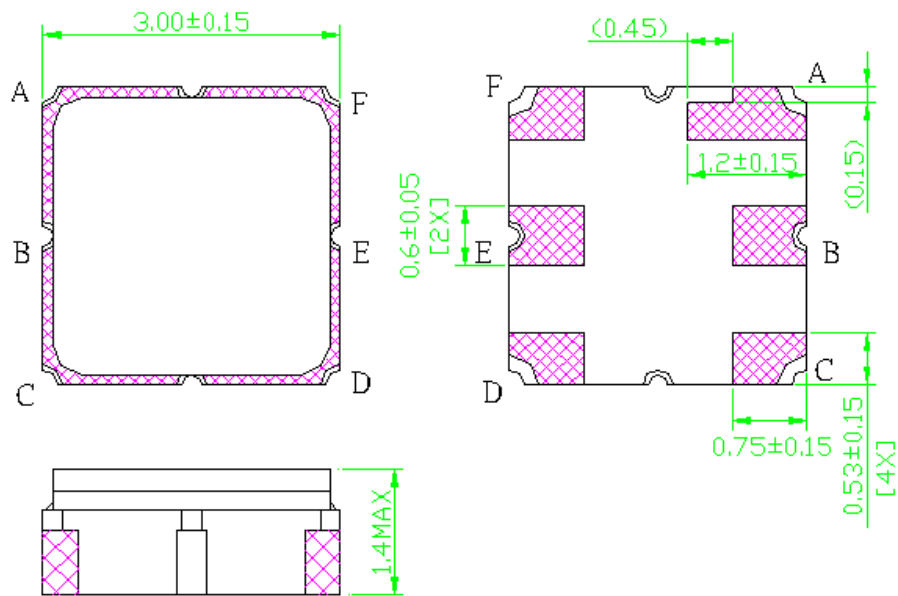

B: Input
 E: Output
 A, C, D, F: Ground
 Unit: mm

E. PCB FOOTPRINT:

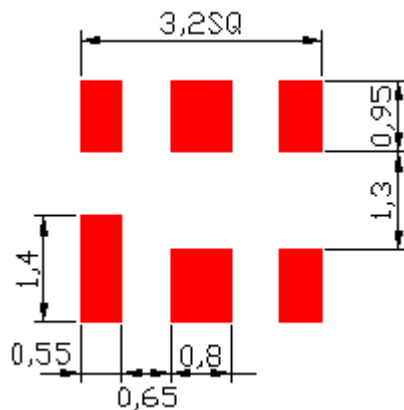

SAW Filter: 1579.50MHz
Part No: MP05601

Model: TA1621A
Rev No: 1

F. FREQUENCY CHARACTERISTICS:

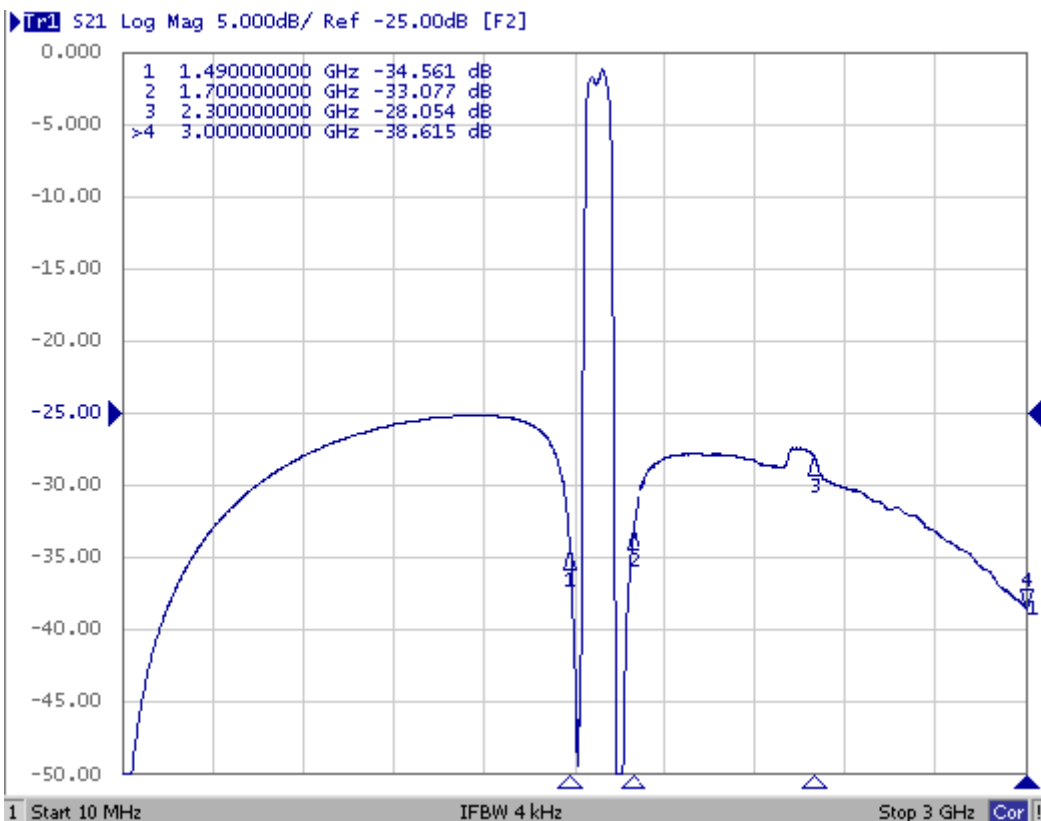
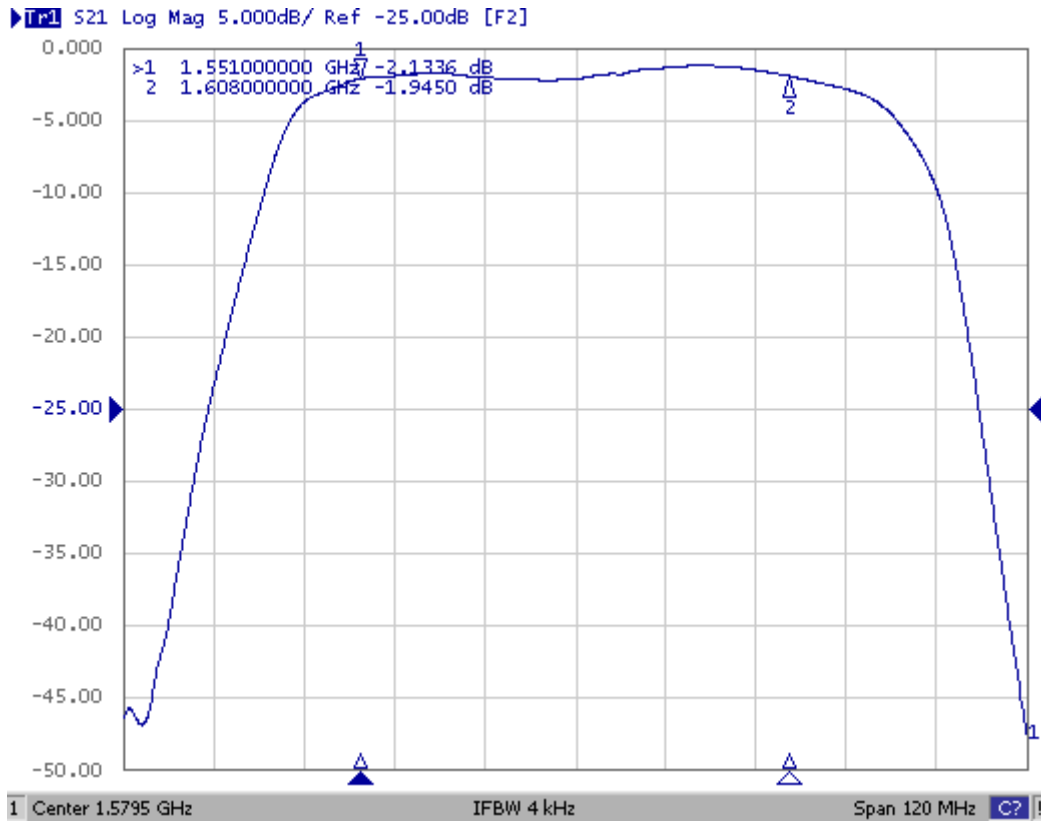

SAW Filter: 1579.50MHz
Part No: MP05601

Model: TA1621A
Rev No: 1

1. VSWR_S11:

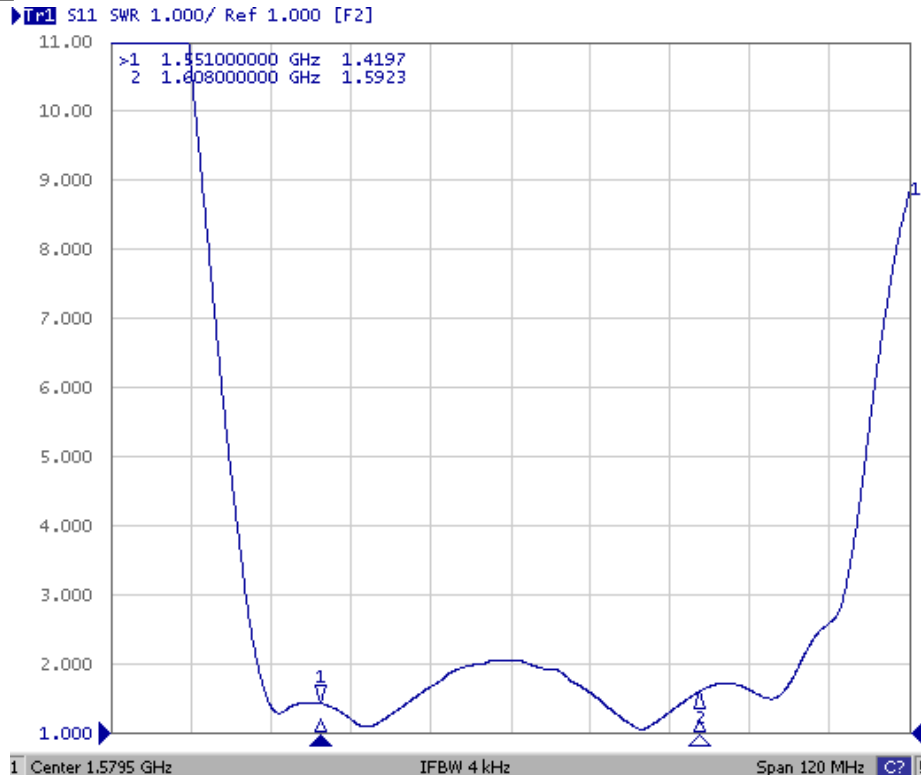

2. VSWR_S22:

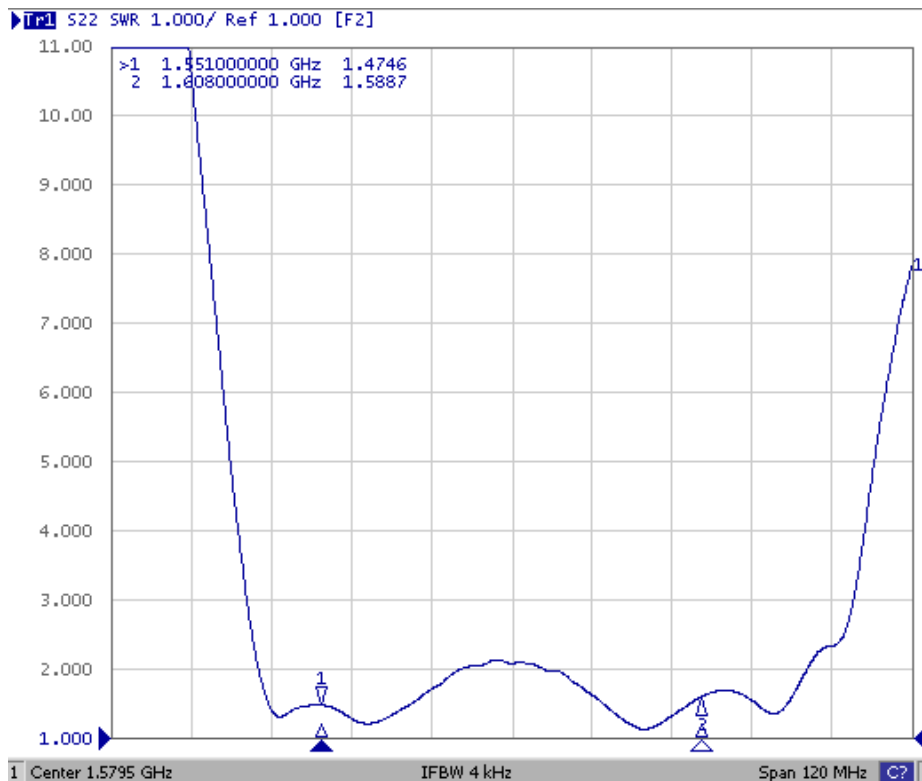

SAW Filter: 1579.50MHz
Part No: MP05601

Model: TA1621A
Rev No: 1

G. PACKING:

1. Reel Dimension

(Please refer to FR-75D10 for packing quantity)

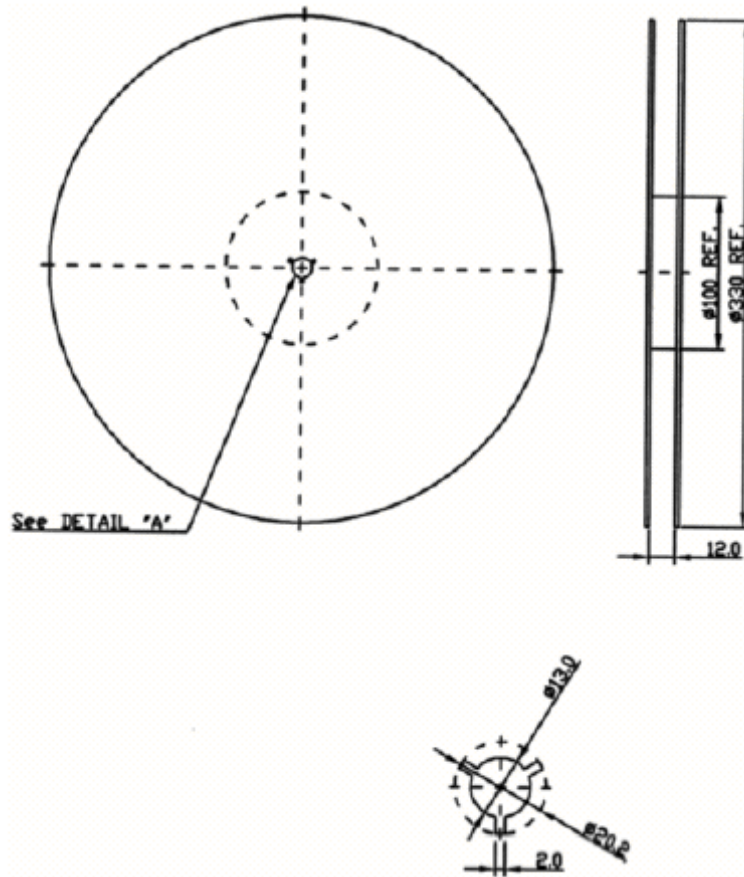

SAW Filter: 1579.50MHz
Part No: MP05601

Model: TA1621A
Rev No: 1

2. Tape Dimension

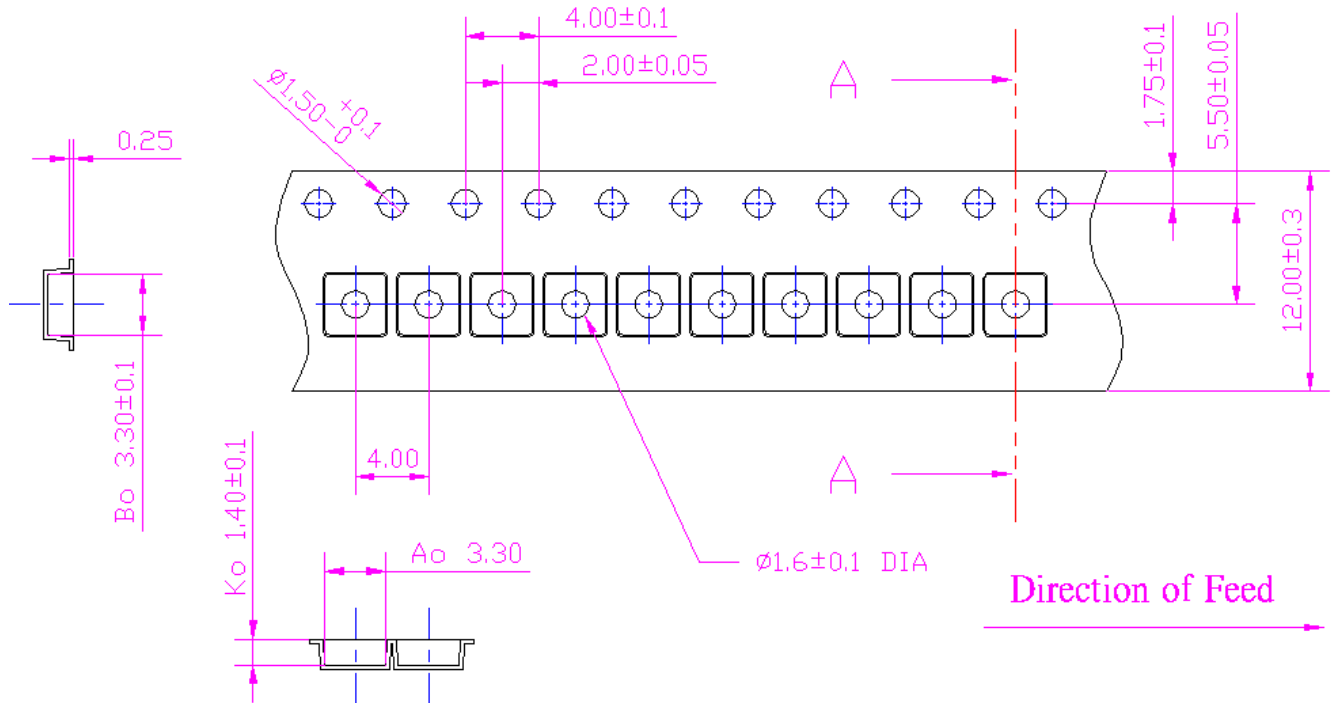

H. RECOMMENDED REFLOW PROFILE:

