

SAW Filter 827.40MHz
Part No: MP05960

Model: TB1023A
Rev No: 1

A. MAXIMUM RATING:

Electrostatic Sensitive Device

1. Operating temperature range: -20°C to 70°C
2. Storage temperature range: -40°C to 85°C
3. Input Power Level: 10 dBm
4. Maximum DC Voltage: 10V

B. CHARACTERISTICS:

Ambient Temperature: 25°C

Characteristics	Value		
	Min.	Typ.	Max.
Center frequency MHz	-	827.4	-
Maximum Insertion loss IL dB	-	18.0	22.0
1dB Band Width MHz	4.5	5.4	-
20dB Band Width MHz	-	8.0	-
Passband Ripple at $F_c \pm 2.25$ MHz dB	-	0.6	1.2
Absolute group Delay usec	-	0.8	-
Single Input Impedance Ω	-	50	-
Single Output Impedance Ω	-	50	-
Temperature Coefficient ppm/°C ²	-	-0.036	-

SAW Filter 827.40MHz
Part No: MP05960

Model: TB1023A
Rev No: 1

C. FREQUENCY RESPONSES:

1. Wide band response

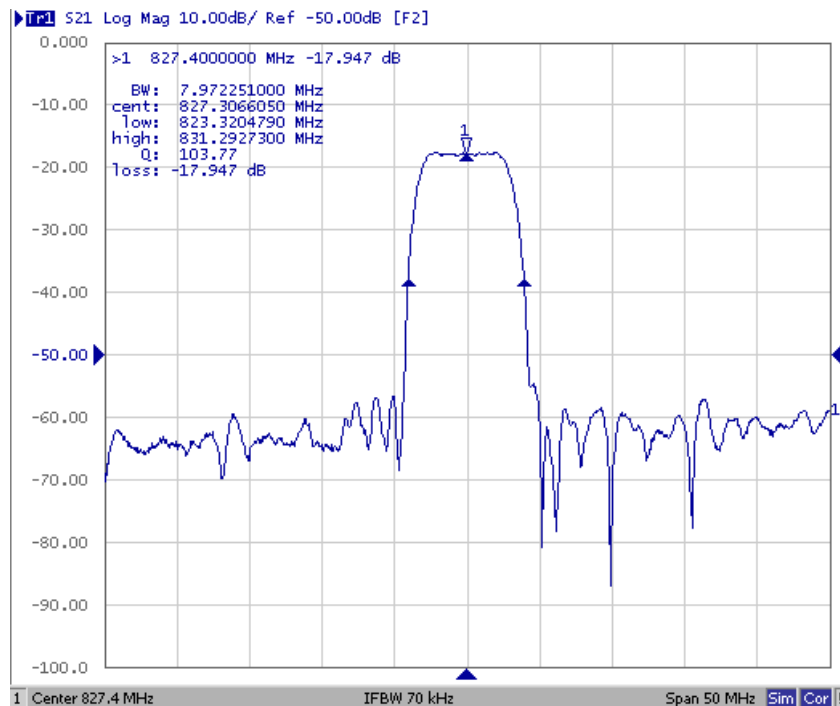

Fig.1: Horizontal: 5MHz / Div, Vertical: 10dB / Div

2. Pass band & Group Delay response

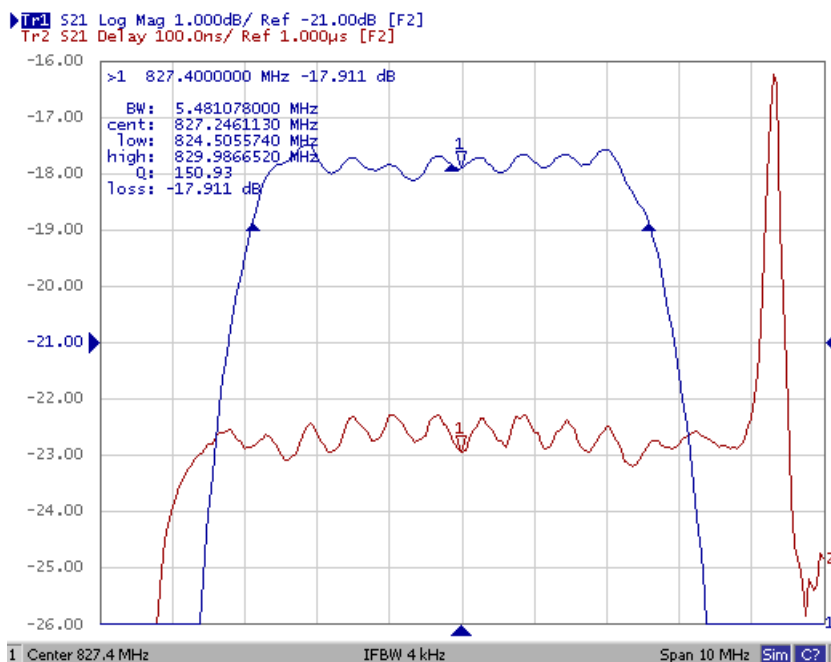
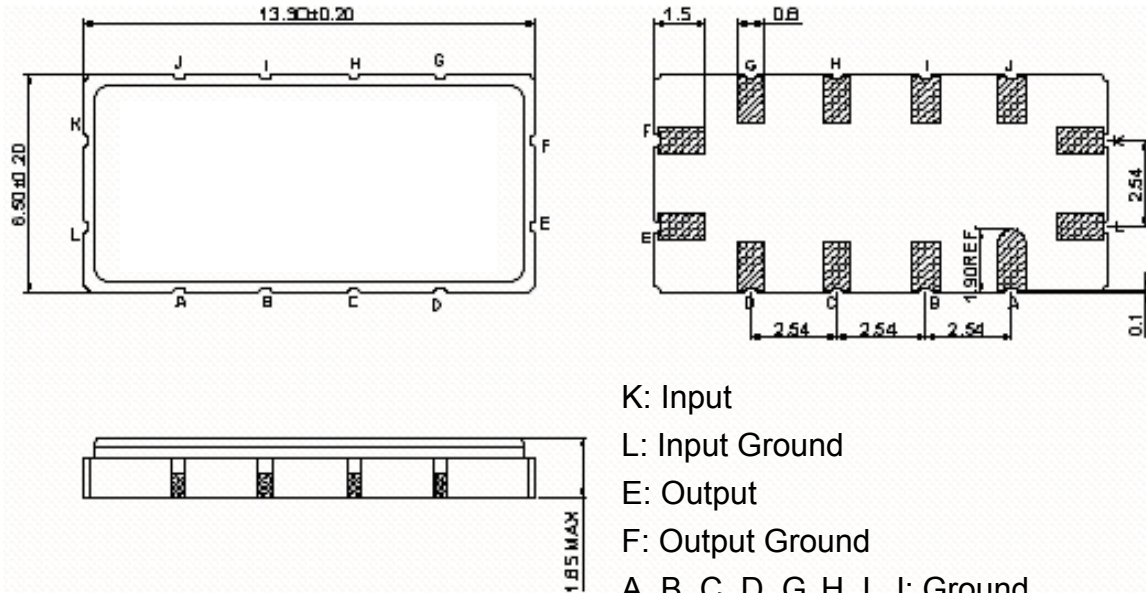

Fig 2: Horizontal: 1MHz / Div, Vertical: 1dB / Div, Vertical: 100ns / Div

SAW Filter 827.40MHz
Part No: MP05960

Model: TB1023A
Rev No: 1

D. OUTLINE DRAWING:



K: Input
 L: Input Ground
 E: Output
 F: Output Ground
 A, B, C, D, G, H, I, J: Ground
 Unit: mm

E. MATCHING CIRCUIT:

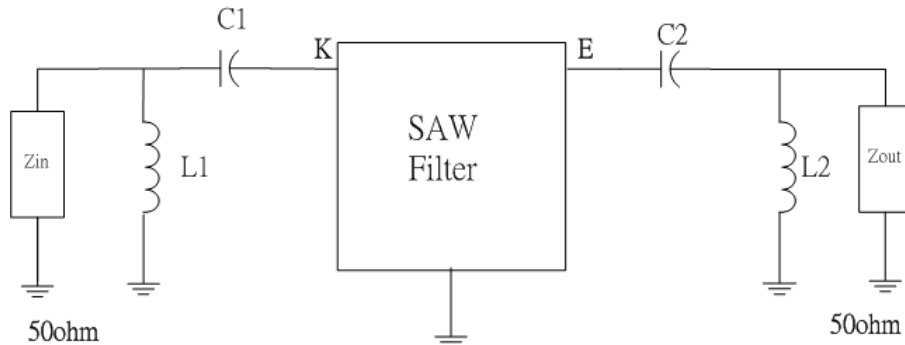

L1 = 3nH, L2 = 5.6nH, C1 = 4.7pF, C2 = 3.9pF

F. PCB FOOTPRINT:

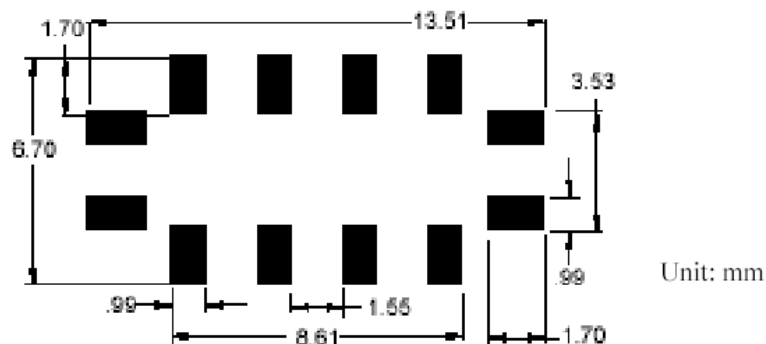

SAW Filter 827.40MHz
Part No: MP05960

Model: TB1023A
Rev No: 1

G. PACKING:

1. Reel Dimension

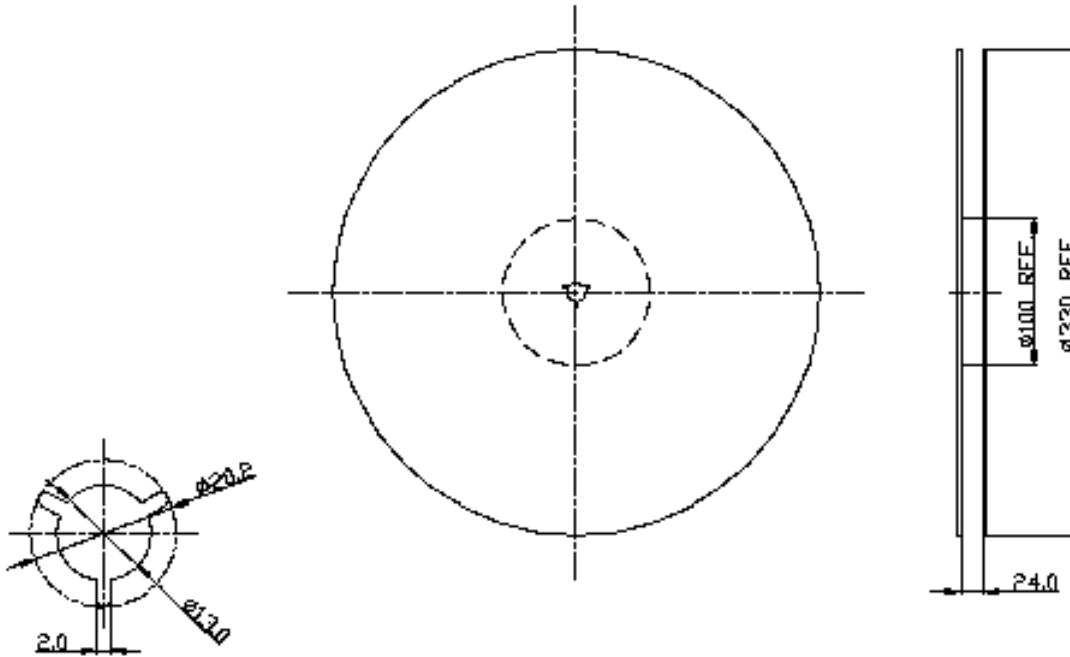

2. Tape Dimension

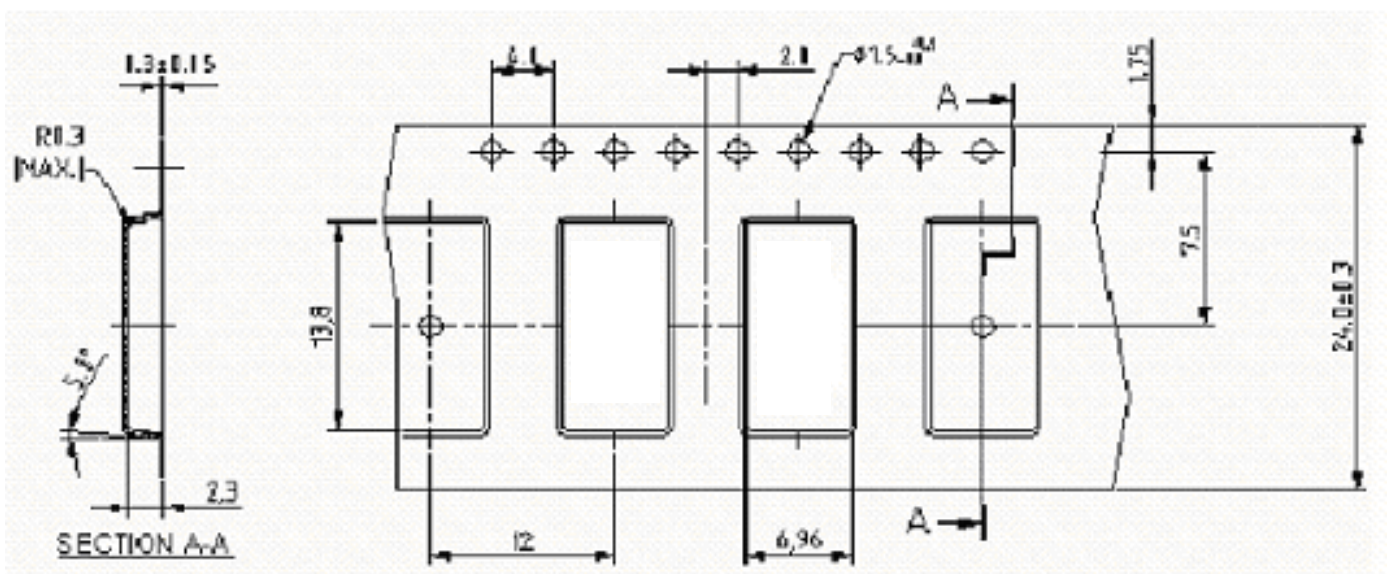

SAW Filter 827.40MHz
Part No: MP05960

Model: TB1023A
Rev No: 1

H. RECOMMENDED REFLOW PROFILE:

