

**SAW Filter 872.40MHz**  
**Part No: MP06156**

**Model: TB1024A**  
**Rev No: 2**

**A. MAXIMUM RATING:**

Electrostatic Sensitive Device

1. Operating temperature range: -20°C to 70°C
2. Storage temperature range: -40°C to 85°C
3. Input Power Level: 10 dBm
4. Maximum DC Voltage: 10V

**B. CHARACTERISTICS:**

Ambient Temperature: 25°C

Characteristics	Min.	Typ.	Max.
Center frequency MHz	-	872.4	-
Maximum Insertion loss IL dB	-	18.2	19.5
1dB Band Width MHz	4.5	5.0	-
20dB Band Width MHz	-	7.5	-
40dB Band Width MHz	-	8.6	-
Passband Ripple at $F_c \pm 2.25\text{MHz}$ dB	-	0.7	1.2
Absolute group Delay usec	-	0.9	-
Single Input Impedance Ohm	-	50	-
Single Output Impedance Ohm	-	50	-
Temperature Coefficient ppm/°C <sup>2</sup>	-	-0.036	-

**SAW Filter 872.40MHz**  
**Part No: MP06156**

**Model: TB1024A**  
**Rev No: 2**

**C. FREQUENCY RESPONSES:**

1. Wide band response

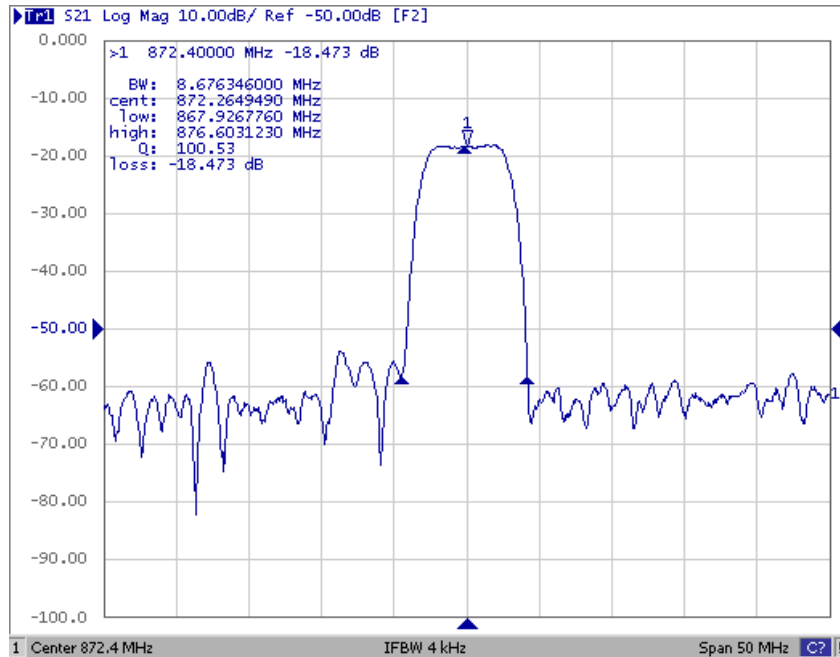

Fig. 1: Horizontal: 50MHz / Div, Vertical: 10dB / Div

2. Pass band & Group Delay response

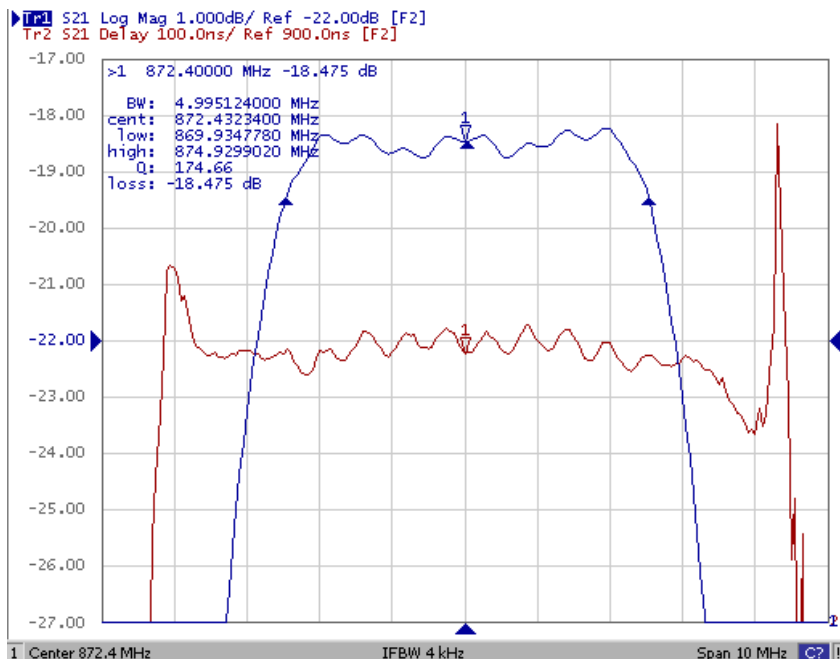
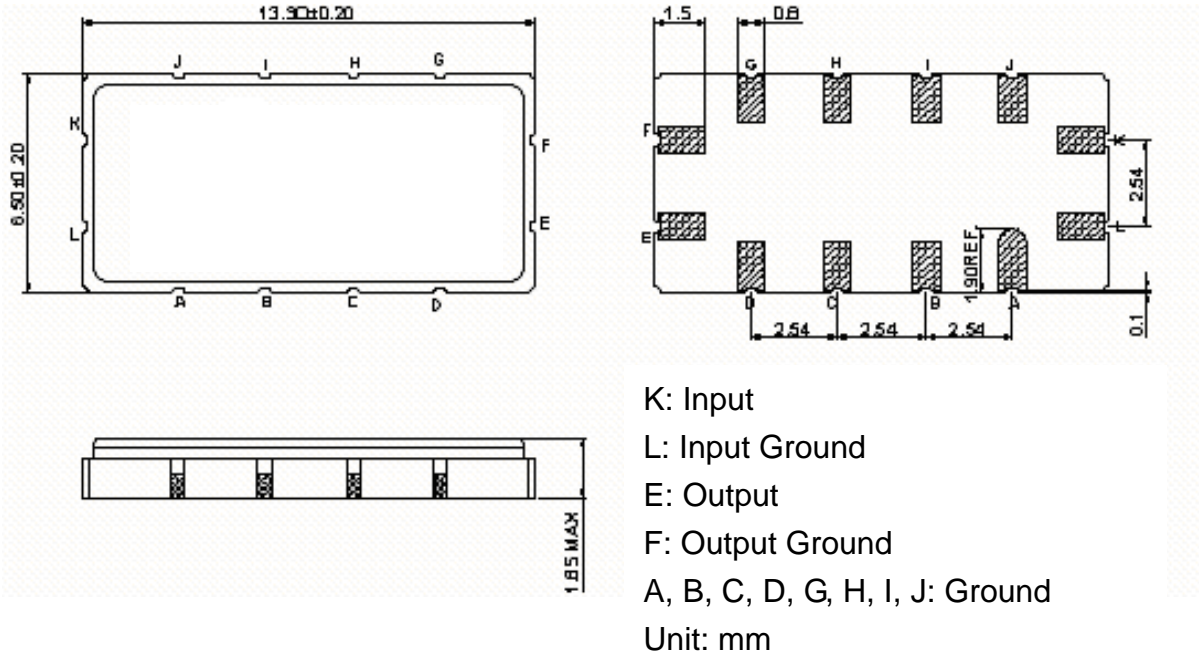

Fig. 2: Horizontal: 1MHz / Div, Vertical: 1dB / Div, Vertical: 100ns / Div

**SAW Filter 872.40MHz**  
**Part No: MP06156**

**Model: TB1024A**  
**Rev No: 2**

**D. OUTLINE DRAWING:**



**E. MEASUREMENT CIRCUIT:**

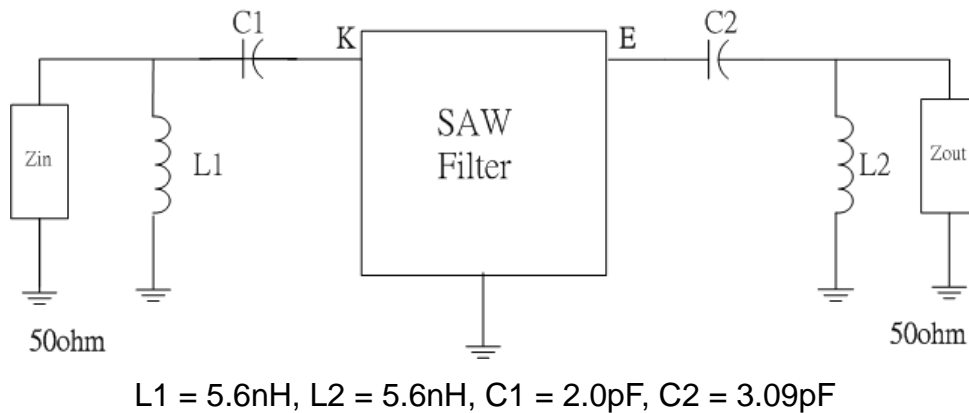

**F. PCB FOOTPRINT:**

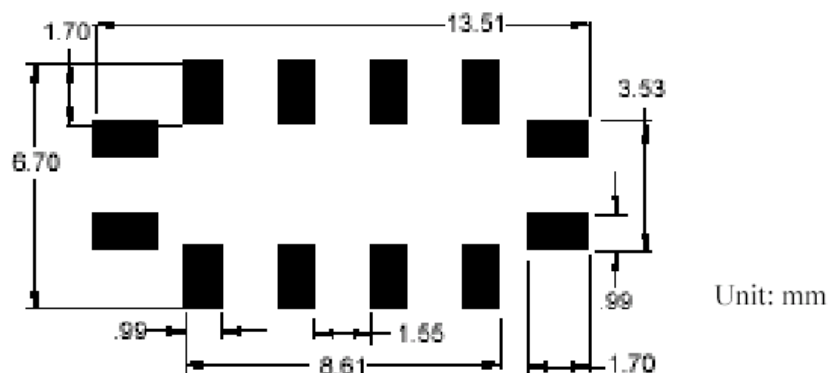

**SAW Filter 872.40MHz**  
**Part No: MP06156**

**Model: TB1024A**  
**Rev No: 2**

**G. PACKING:**

1. Reel Dimension

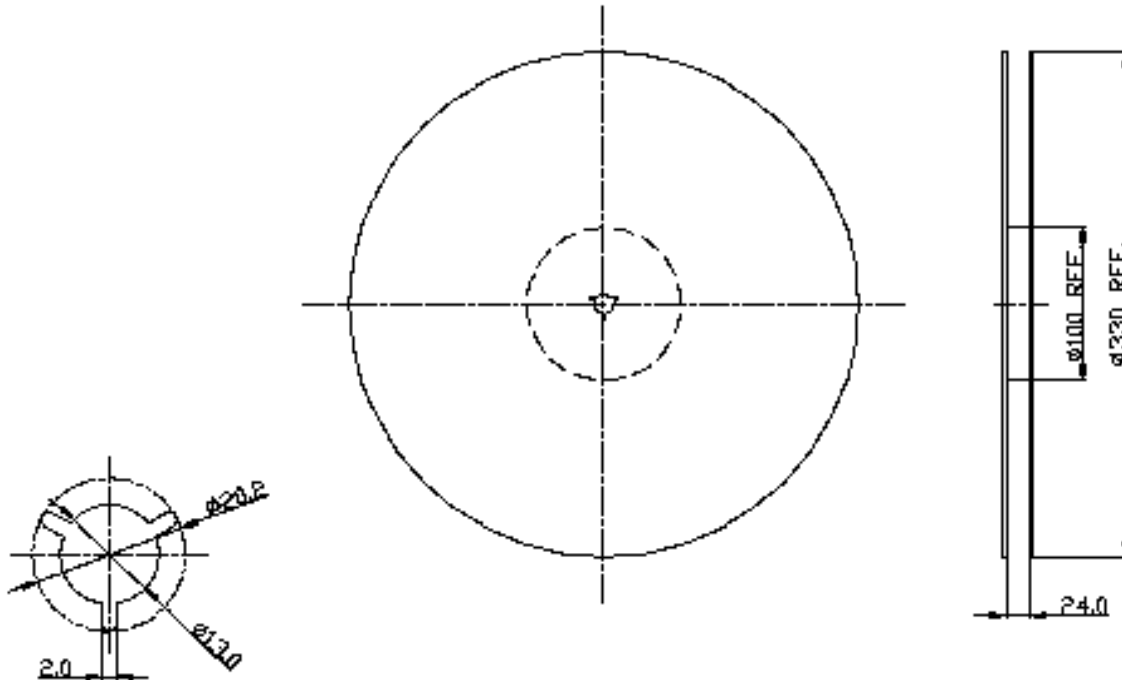

2. Tape Dimension

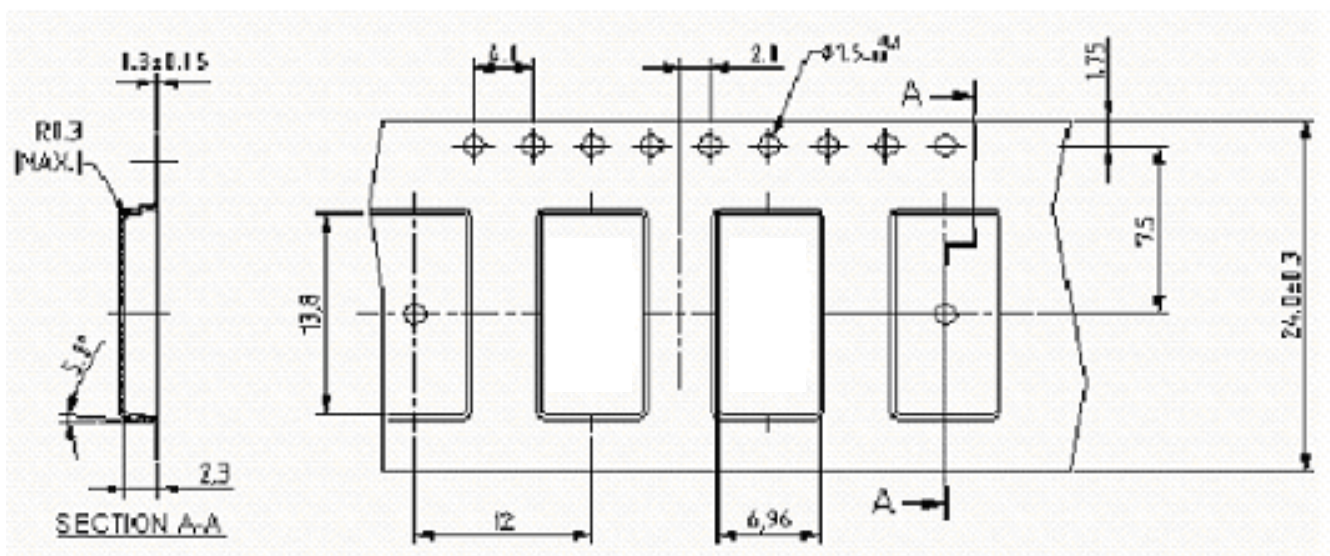

**SAW Filter 872.40MHz**  
**Part No: MP06156**

**Model: TB1024A**  
**Rev No: 2**

**H. RECOMMENDED REFLOW PROFILE:**

