

SAW Filter 1350.0MHz

Model: TA0322B

Part No: MP06329

Rev No: 1

A. MAXIMUM RATING:

Electrostatic Sensitive Device (ESD)

1. Input Power Level: 10dBm
2. DC voltage: 3V
3. Operating Temperature: -25°C to +85°C
4. Storage Temperature: -40°C to +85°C

B. ELECTRICAL CHARACTERISTICS:

Item	Unit	Min.	Typ.	Max.
Center frequency Fc	MHz	-	1350	-
Insertion Loss (1330 ~ 1372MHz) IL	dB	-	3.4	4.5
Absolute Group delay 1350MHz	ns	-	20	50
Group delay variation (1330 ~ 1372MHz)	ns	-	10	30
Phase variation (1330 ~ 1372MHz)	deg	-	5.5	15
Amplitude Ripple (1330 ~ 1372MHz)	dB	-	1.0	1.8
Attenuation (Reference from 0dB)				
Fc -41MHz	dB	10	30	-
Fc +41MHz	dB	10	18	-
Fc -60MHz	dB	30	57	-
Fc +60MHz	dB	26	35	-
Fc -140MHz	dB	30	60	-
Fc +140MHz	dB	30	54	-
Fc -250MHz	dB	38	62	-
Fc +250MHz	dB	38	52	-
Temperature Coefficient of Frequency TCR	ppm/°C	-	-36	-

C. MEASUREMENT CIRCUIT:

HP Network analyzer

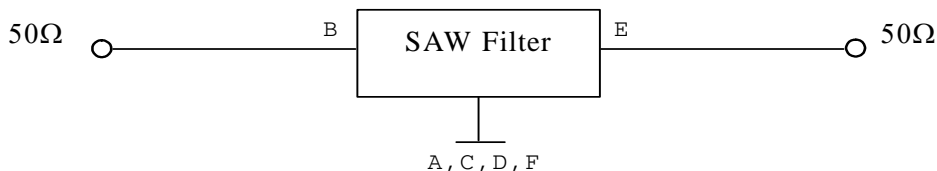

SAW Filter 1350.0MHz
Part No: MP06329

Model: TA0332B
Rev No: 1

D. FREQUENCY CHARACTERISTICS:

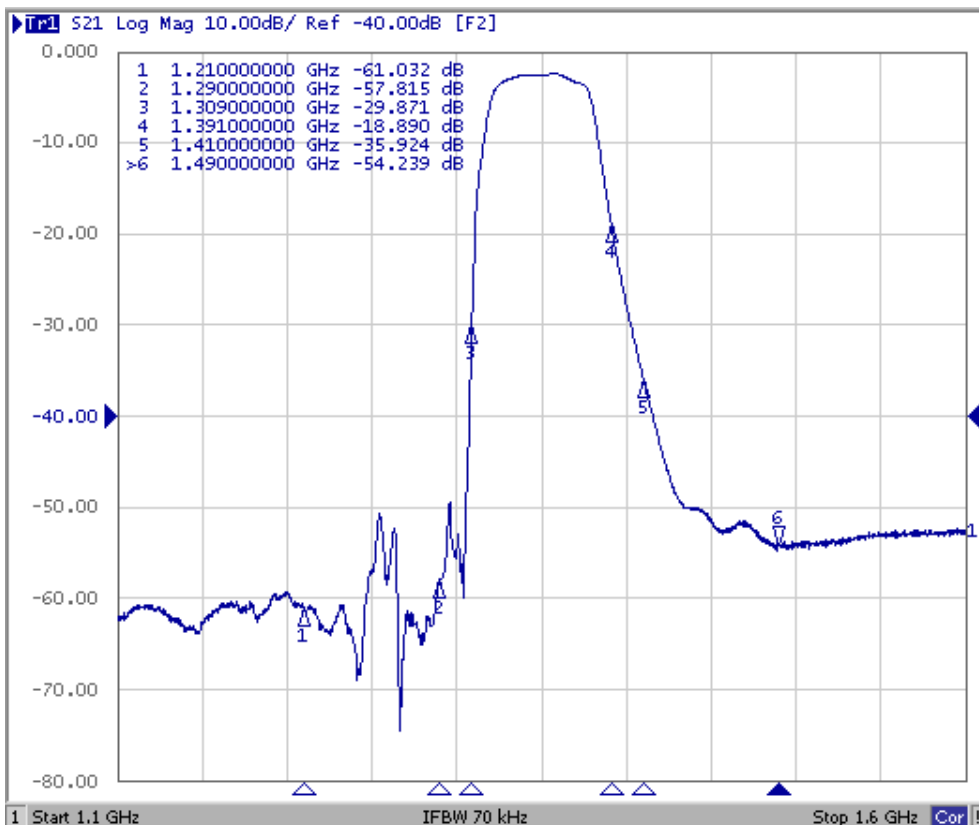
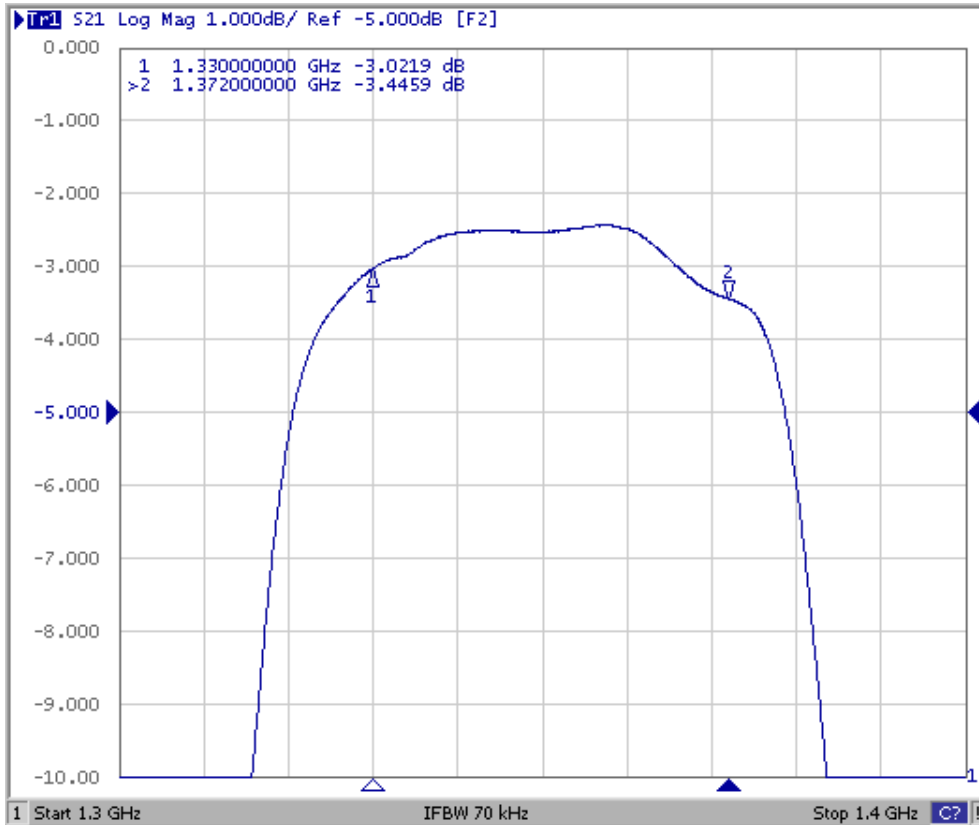

SAW Filter 1350.0MHz
Part No: MP06329

Model: TA0332B
Rev No: 1

E. OUTLINE DRAWING:

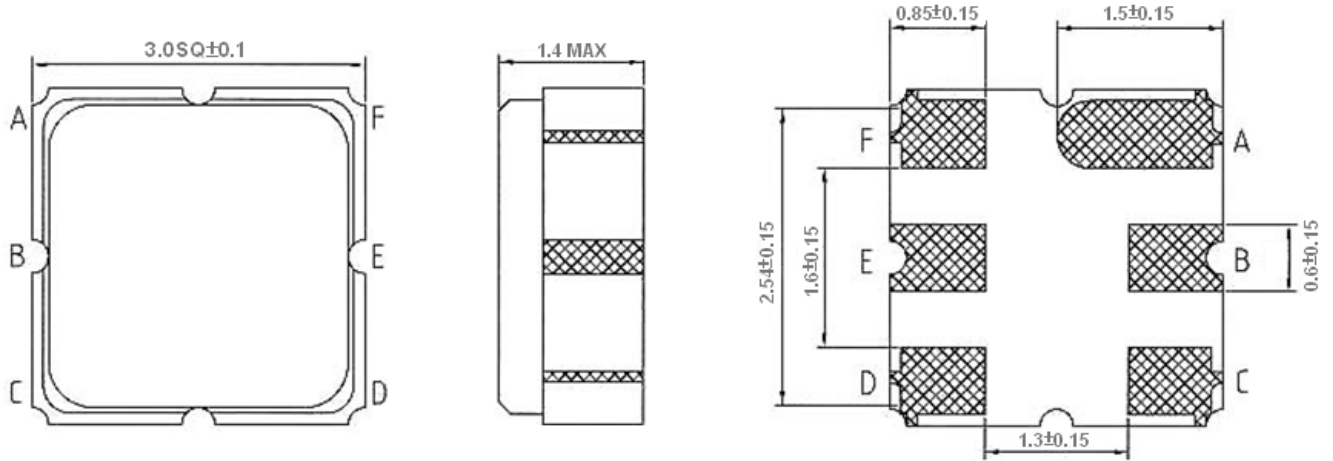

B: Input
E: Output
A, C, D, F: Ground
Unit: mm

F. PCB FOOTPRINT:

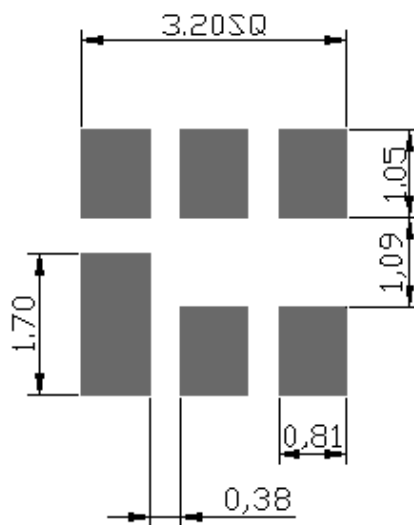

SAW Filter 1350.0MHz
Part No: MP06329

Model: TA0332B
Rev No: 1

G. PACKING:

1. Reel Dimension (Please refer to FR-75D10 for packing quantity)

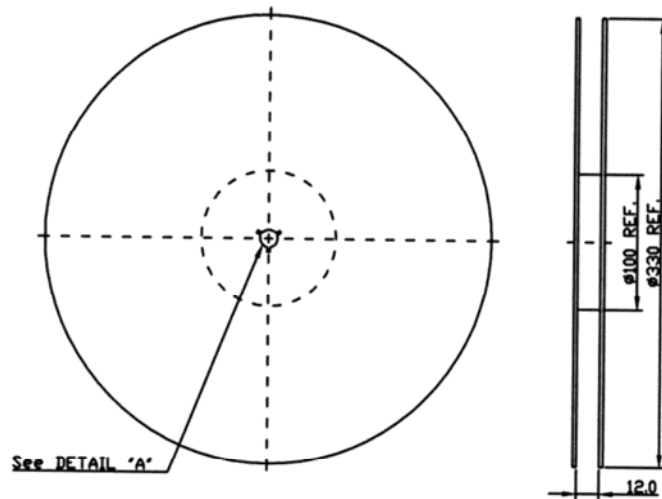

2. Tape Dimension

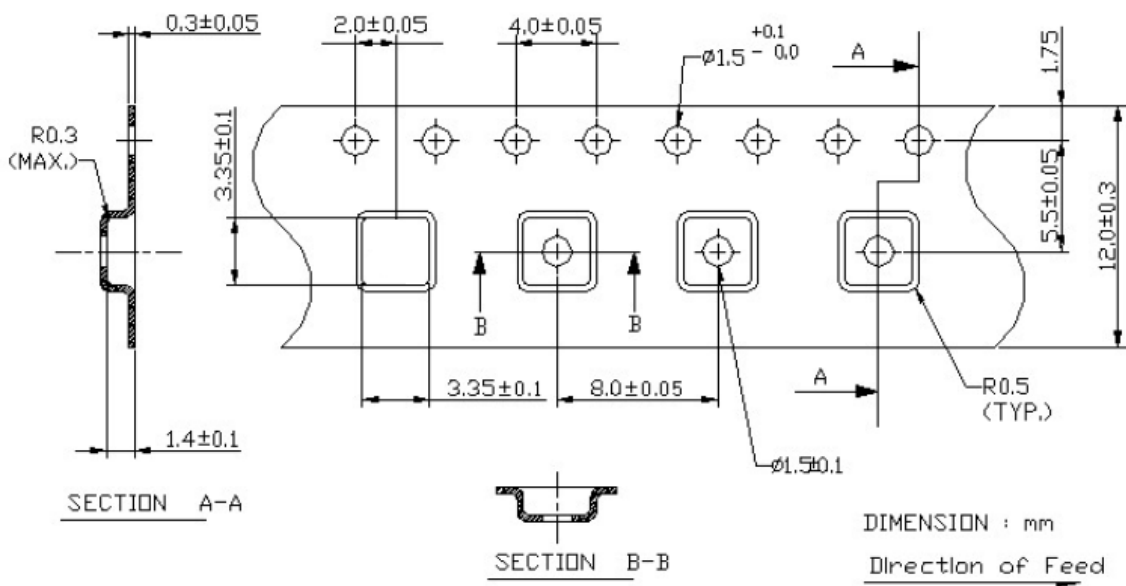

SAW Filter 1350.0MHz
Part No: MP06329

Model: TA0332B
Rev No: 1

H. RECOMMENDED REFLOW PROFILE:

