

SAW Filter 110.0MHz
Part No: MP01327

Model No: TB0681A
Rev No: 2

A. MAXIMUM RATING:

1. Operating Temperature: -10°C ~ 50°C
2. Storage Temperature: -40°C ~ +85°C
3. Input Power Level: 10dBm
4. Maximum DC Voltage: 10V

B. CHARACTERISTICS:

Ambient Temperature: 25°C

Characteristics	Min.	Typ.	Max.	Note
Center frequency Fc MHz	-	110	-	-
Minimum Insertion loss IL dB	-	7.7	12	-
1 dB Bandwidth kHz	-	297	-	-
3 dB Bandwidth kHz	200	450	-	-
Group Delay Ripple (Fc ±100kHz) nsec	-	70	400	-
Relative Rejection (Reference to Minimum Insertion loss)				
Fc ±1.0MHz dB	15	33	-	-
Fc ±4.0MHz dB	35	53	-	-
Temp Coefficient ppm/K ²	-	-0.036	-	-

SAW Filter 110.0MHz
Part No: MP01327

Model No: TB0681A
Rev No: 2

C. FREQUENCY CHARACTERISTICS:

1. S21 Response

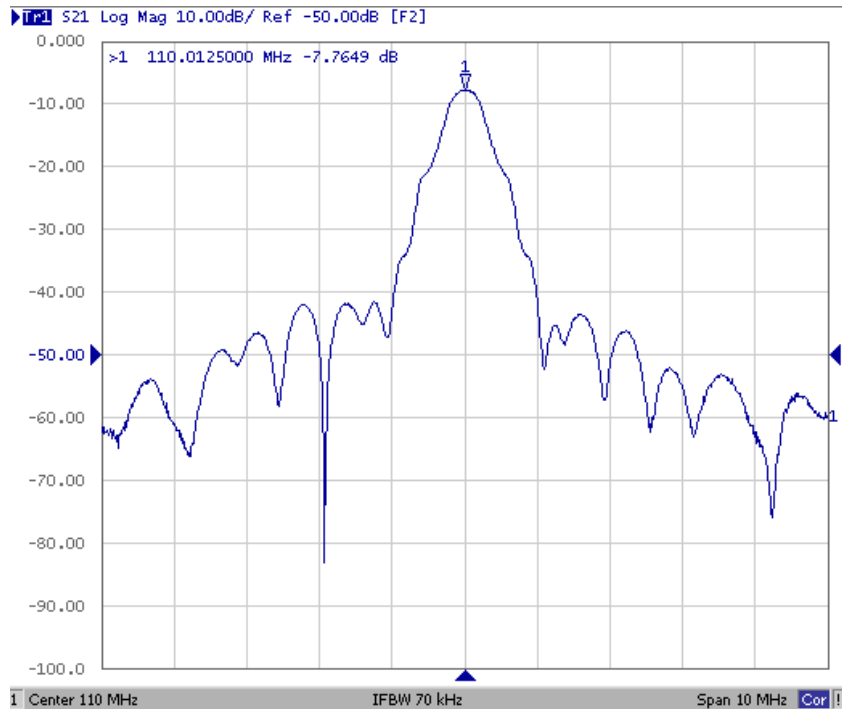

Fig. 1: Horizontal: 1MHz / Div, Vertical: 10dB / Div

2. Passband Response and Group Delay Response

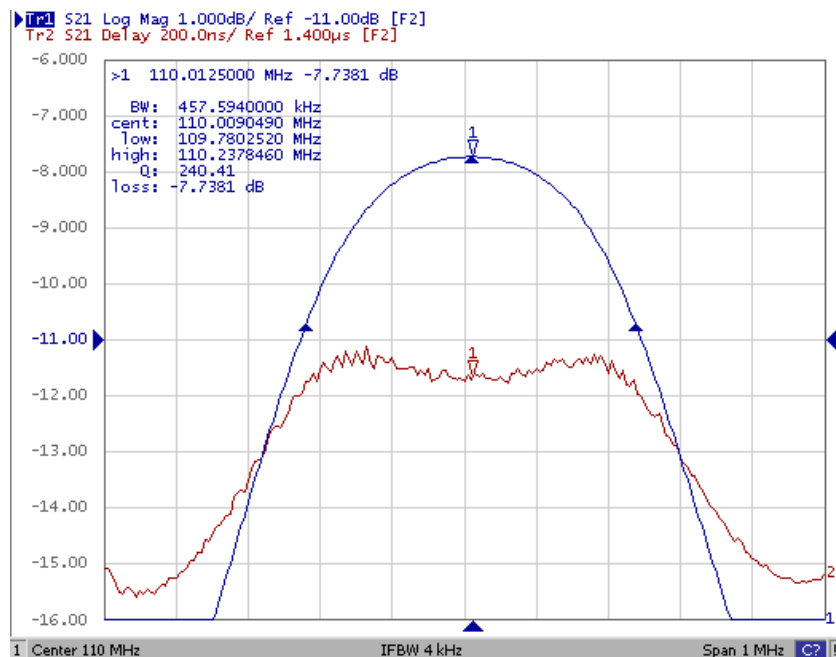
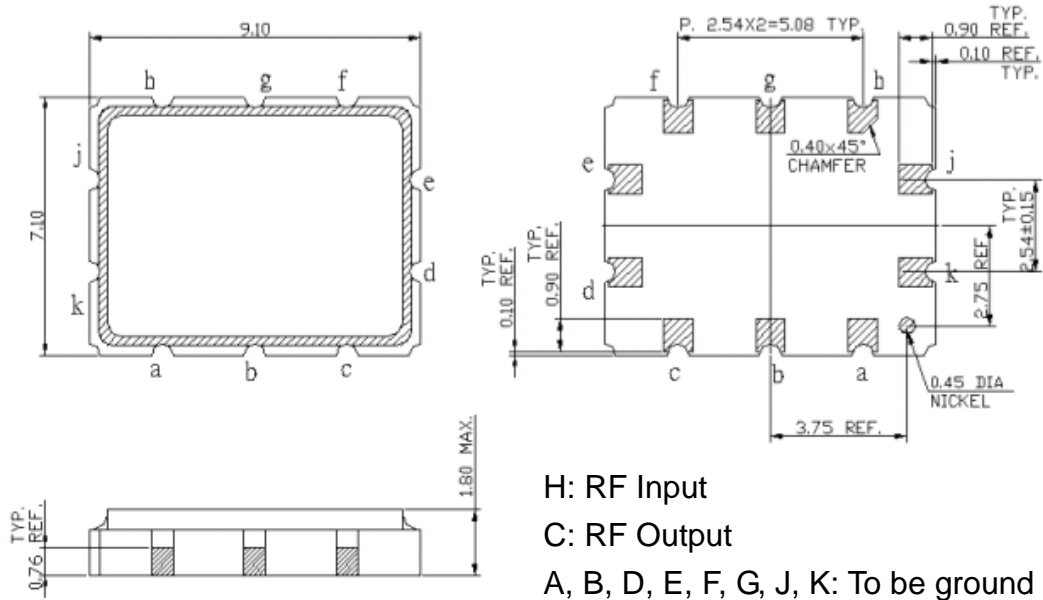

Fig. 2: Horizontal: 0.1MHz / Div, Vertical 1: 1dB / Div, Vertical 2: 200ns / Div

SAW Filter 110.0MHz
Part No: MP01327

Model No: TB0681A
Rev No: 2

D. OUTLINE DRAWING:



H: RF Input
 C: RF Output
 A, B, D, E, F, G, J, K: To be ground
 Unit: mm

E. MATCHING CIRCUIT:

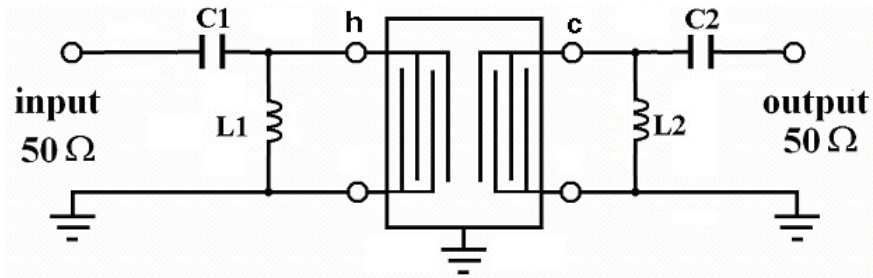

L1 = 82nH, C1 = 8pF, L2 = 100nH, C2 = 8pF

F. PCB FOOTPRINT:

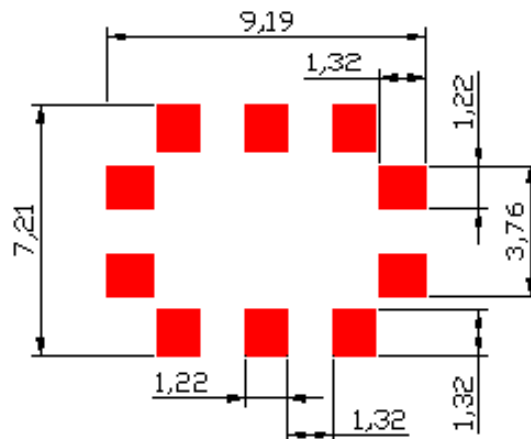

SAW Filter 110.0MHz
Part No: MP01327

Model No: TB0681A
Rev No: 2

G. PACKING:

1. Reel Dimension

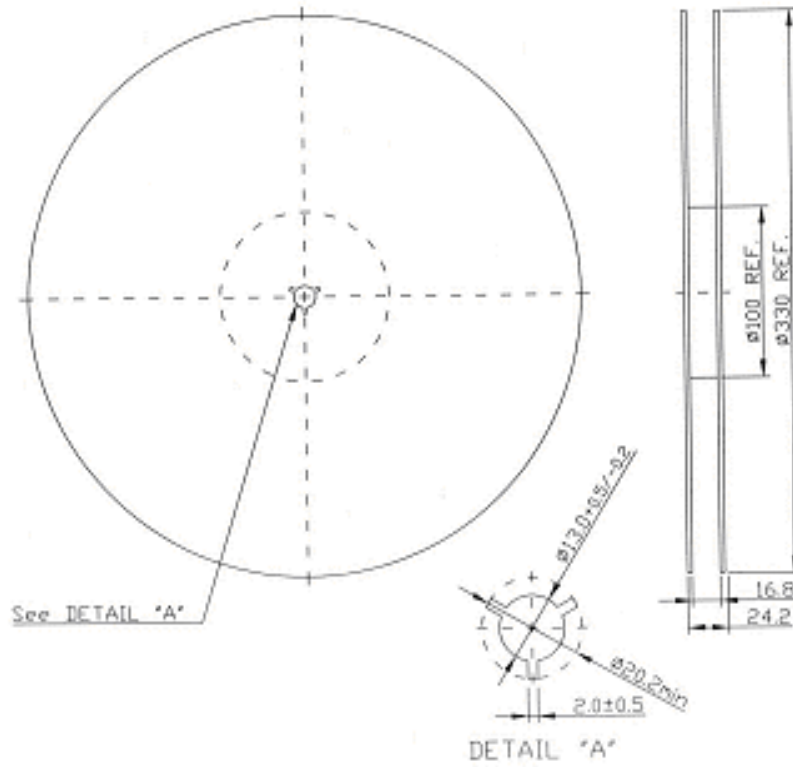

2. Tape Dimension

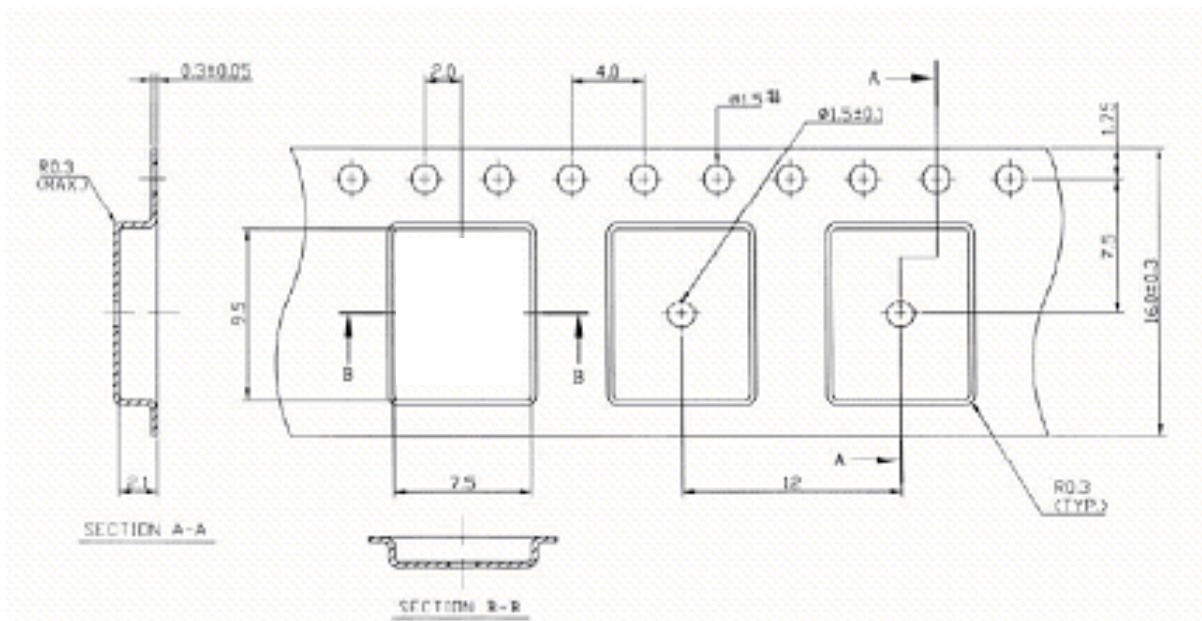

SAW Filter 110.0MHz
Part No: MP01327

Model No: TB0681A
Rev No: 2

H. RECOMMENDED REFLOW PROFILE:

