

SAW Filter 1217.0MHz
Part No: MP08169

Model: TA1903A
Rev No: 1

A. MAXIMUM RATING:

Electrostatic Sensitive Device (ESD)

1. Input Power Level: 10dBm
2. DC Voltage: 3V
3. Operating Temperature: -30°C to +80°C
4. Storage Temperature: -30°C to +85°C

B. ELECTRICAL CHARACTERISTICS:

1. Terminating source impedance: $Z_S = 50\Omega$
2. Terminating load impedance: $Z_L = 50\Omega$

Item	Unit	Min.	Typ.	Max.
Center Frequency F_c	MHz	-	1217	-
Insertion Loss (1195 ~ 1239MHz) IL	dB	-	2.4	4
Amplitude ripple (1195 ~ 1239MHz)	dB	-	1.2	3
Attenuation (Reference level from 0dB)				
1107 ~ 1167MHz	dB	30	38	-
1267 ~ 1280MHz	dB	26	35	-
1280 ~ 1310MHz	dB	35	49	-
1310 ~ 1327MHz	dB	40	45	-
Temperature coefficient of frequency	ppm/k	-	-36	-

SAW Filter 1217.0MHz
Part No: MP08169

Model: TA1903A
Rev No: 1

C. MEASUREMENT CIRCUIT:

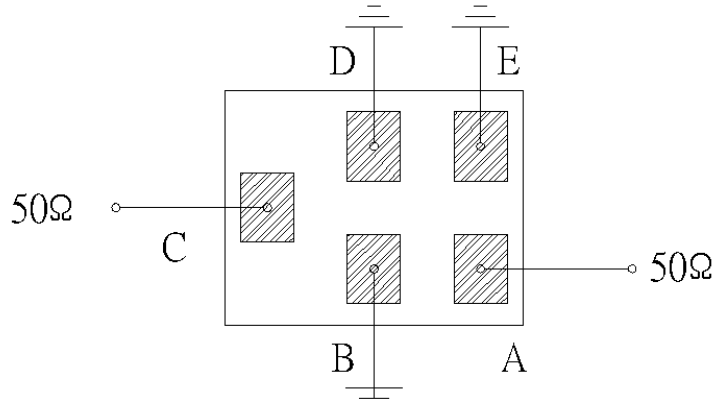

D. OUTLINE DRAWING:

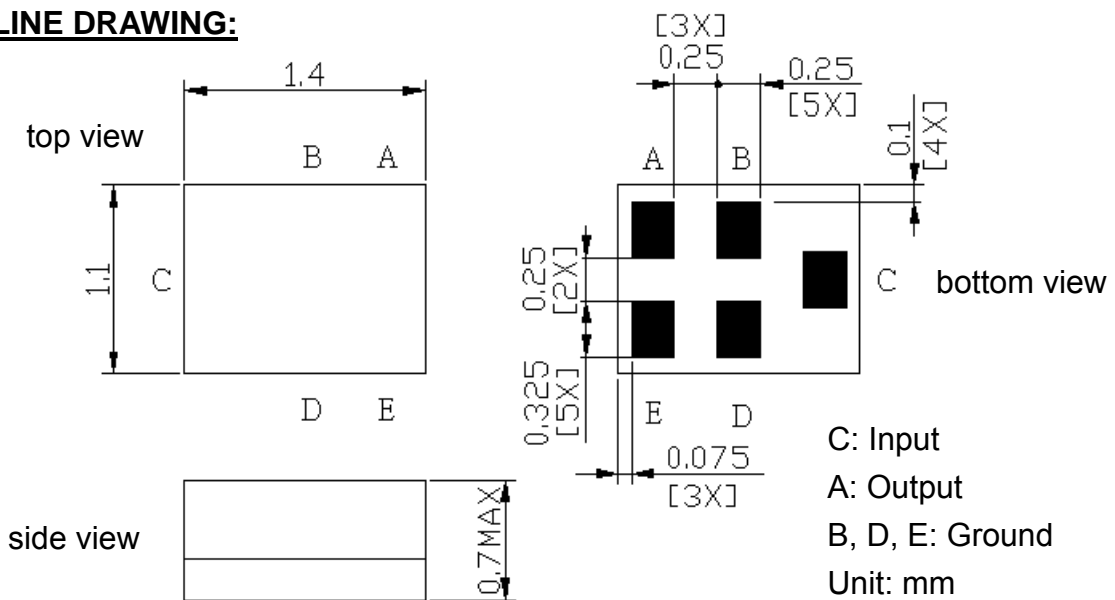

E. PCB FOOTPRINT:

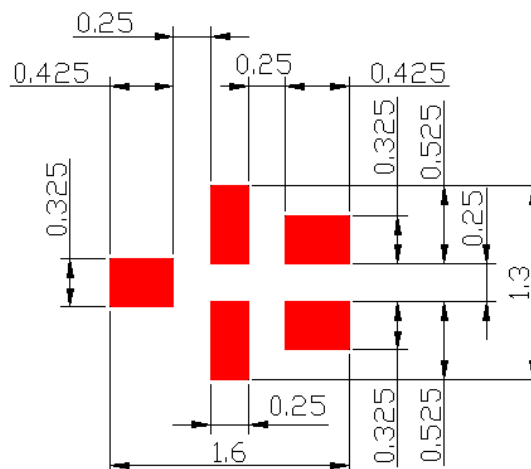

■ : Land Pattern
 Unit : mm

SAW Filter 1217.0MHz
Part No: MP08169

Model: TA1903A
Rev No: 1

F. FREQUENCY CHARACTERISTICS:

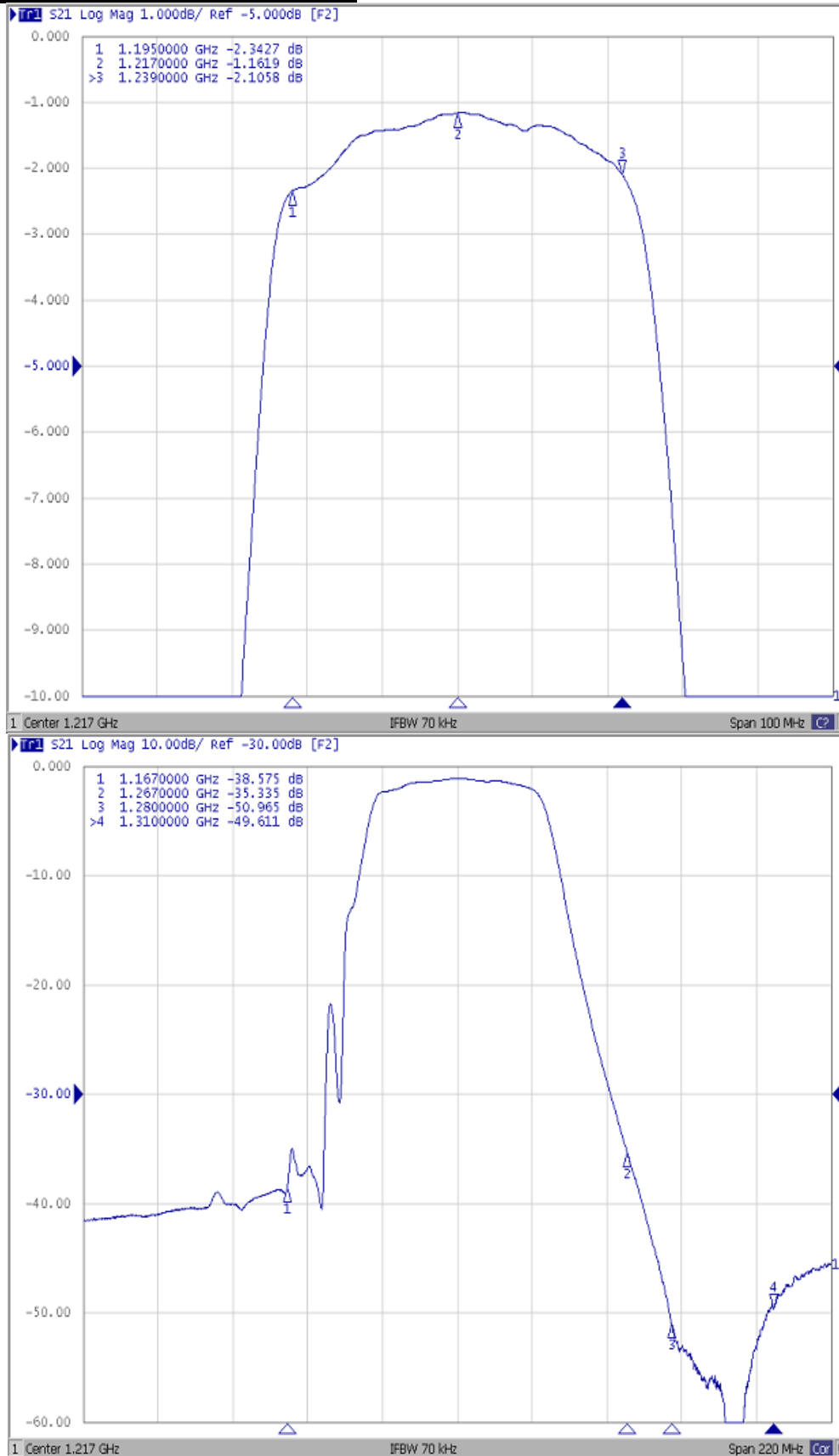

SAW Filter 1217.0MHz
Part No: MP08169

Model: TA1903A
Rev No: 1

G. PACKING:

1. Reel Dimension

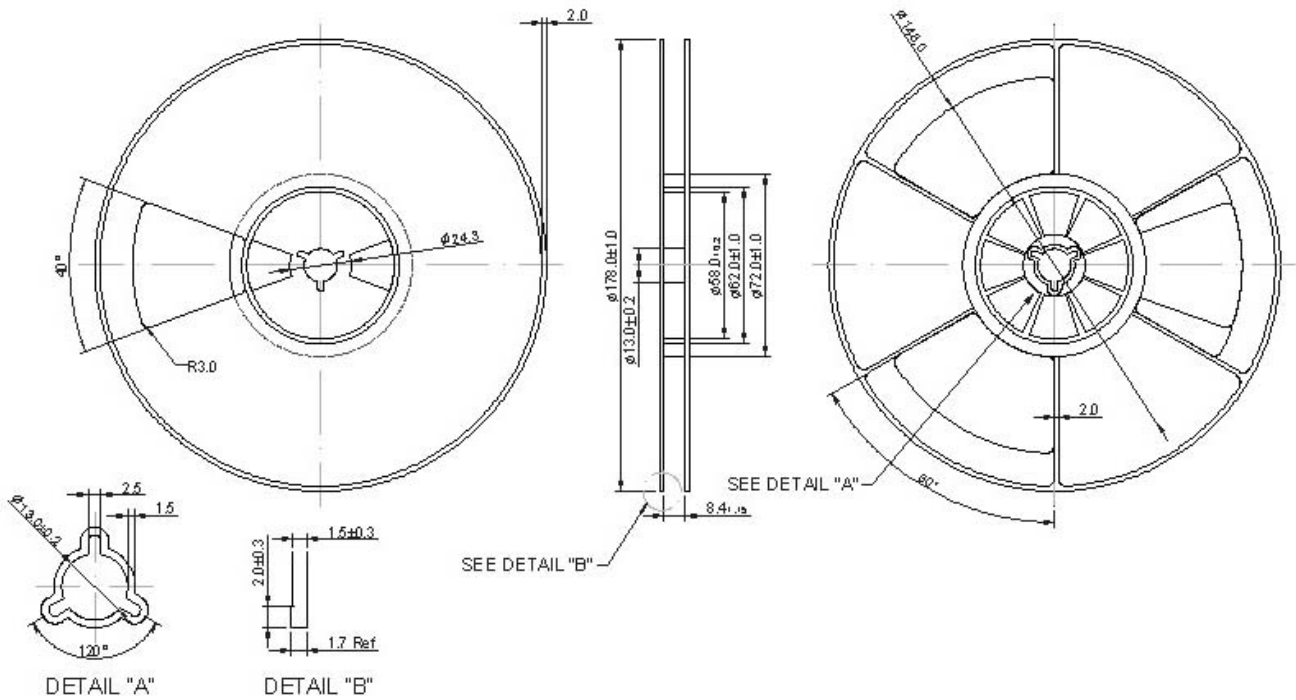

2. Tape Dimension

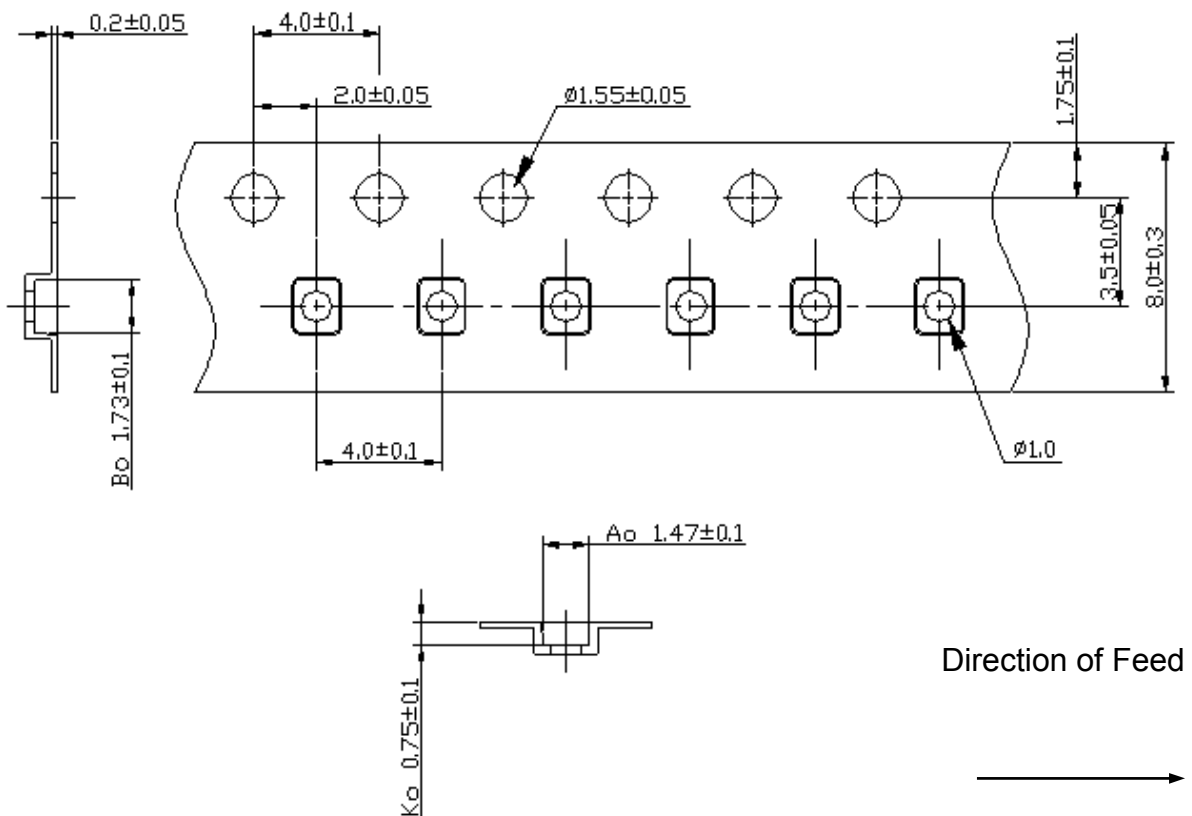

SAW Filter 1217.0MHz
Part No: MP08169

Model: TA1903A
Rev No: 1

H. RECOMMENDED REFLOW PROFILE:

1. Preheating shall be fixed at 150 ~ 180°C for 60 ~ 90 seconds.
2. Ascending time to preheating temperature 150°C shall be 30 seconds min.
3. Heating shall be fixed at 220°C for 50 ~ 80 seconds and at 260°C +0/-5°C peak (20 ~ 40 sec).
4. Time: 2 times.

