

**SAW Filter: 424.0MHz**  
**Part No: MA07597**

**Model: TA0418A**  
**Rev No: 2**

**A. MAXIMUM RATING:**

Electrostatic Sensitive Device

1. Input Power Level: 20dBm
2. DC voltage: 3V
3. Operating Temperature: 0°C to +50°C
4. Storage Temperature: -40°C to +85°C
5. Moisture Sensitivity Level: Level 1 (MSL1)

**B. ELECTRICAL CHARACTERISTICS:**

Reference temperature: 25°C

Item	Unit	Min.	Typ.	Max.
Center frequency Fc	MHz	-	424	-
Insertion Loss IL min (reference level)	dB	-	1.4	2.8
2dB Bandwidth BW -2dB	MHz	18	21.4	-
Absolute Attenuation: (Reference level from 0dB)				
Fc -45 to Fc -100MHz	dB	40	56	-
Fc +45 to Fc +55MHz	dB	30	56	-
Fc +55 to Fc +100MHz	dB	40	54	-
Temperature coefficient of frequency	ppm/k	-	-36	-
Source impedance Z <sub>s</sub>	Ω	-	50	-
Load impedance Z <sub>L</sub>	Ω	-	50	-

Note: IL min is the minimum of the pass band attenuation. The center frequency Fc is the mean value of the upper and lower frequencies at the 2dB filter attenuation level relative to the IL min.

**SAW Filter: 424.0MHz**  
**Part No: MA07597**

**Model: TA0418A**  
**Rev No: 2**

**C. FREQUENCY CHARACTERISTICS:**

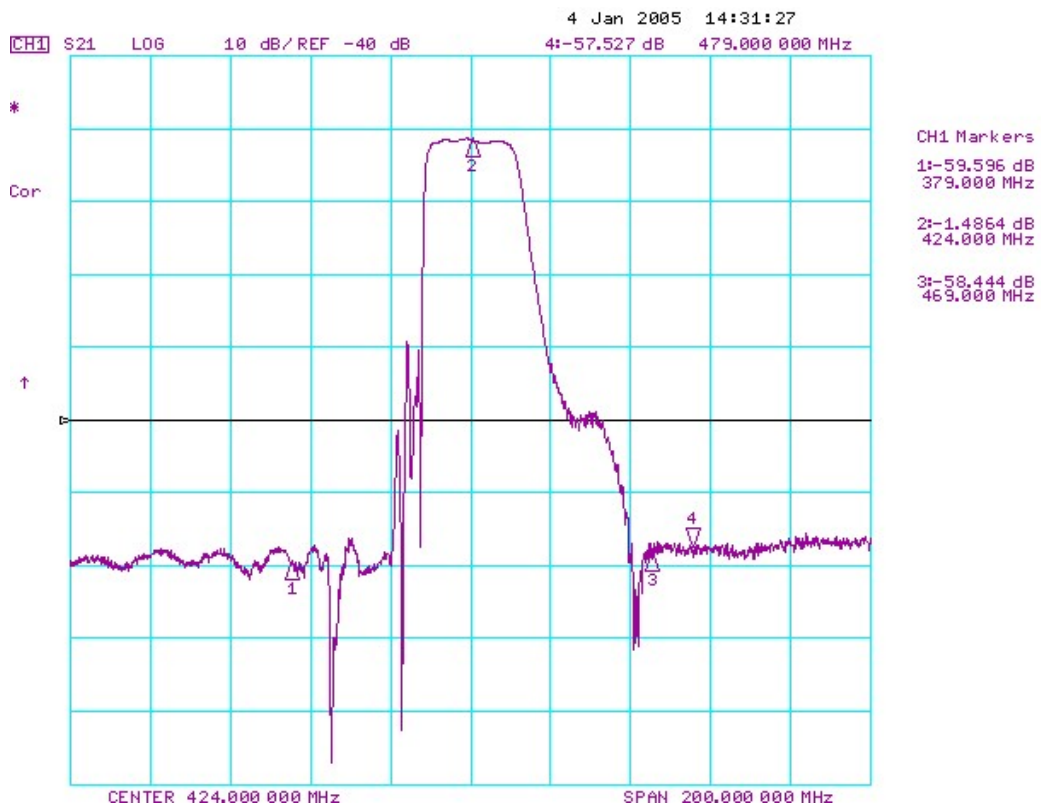
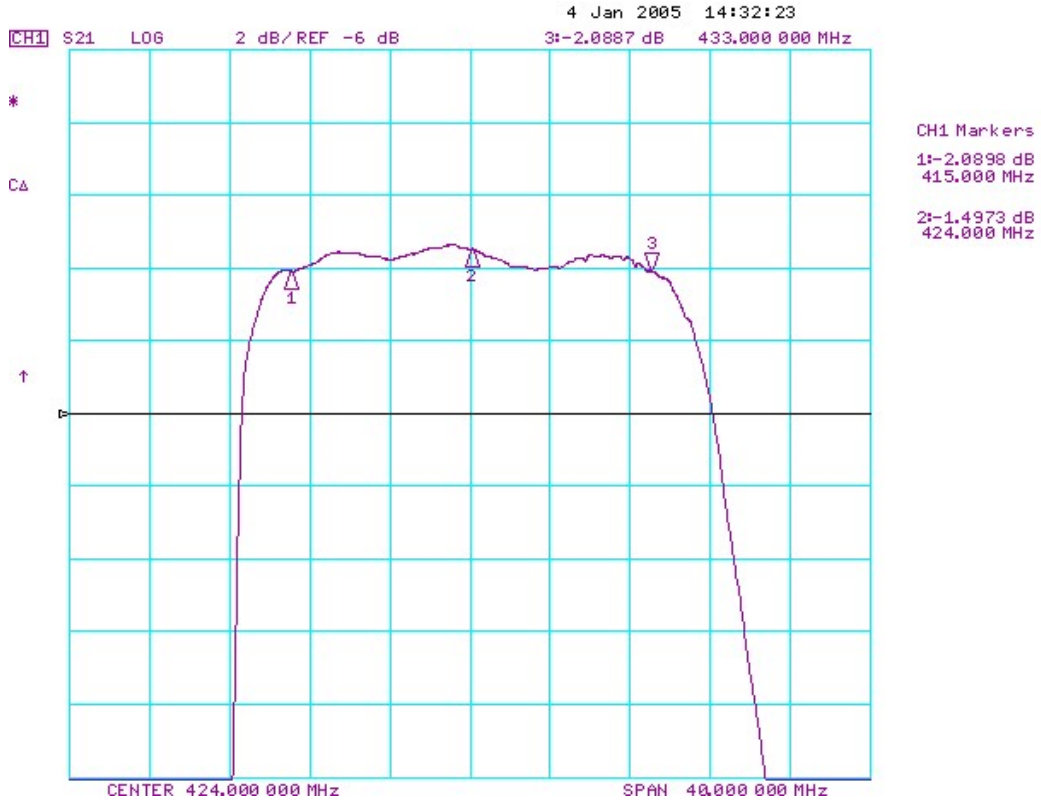

**SAW Filter: 424.0MHz**  
**Part No: MA07597**

**Model: TA0418A**  
**Rev No: 2**

**D. OUTLINE DRAWING:**

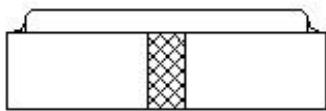
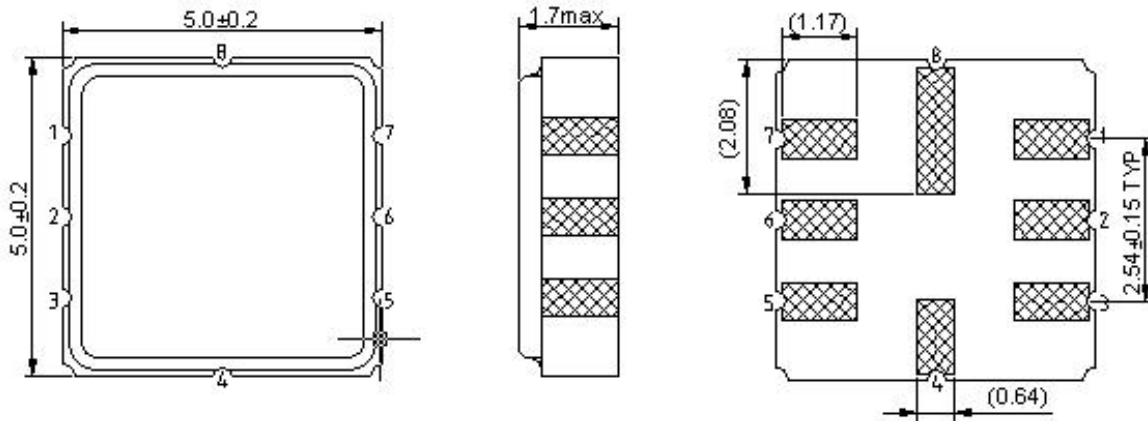

2: Input  
 6: Output  
 1, 3, 4, 5, 7, 8: Ground  
 Unit: mm

**E. MEASUREMENT CIRCUIT:**

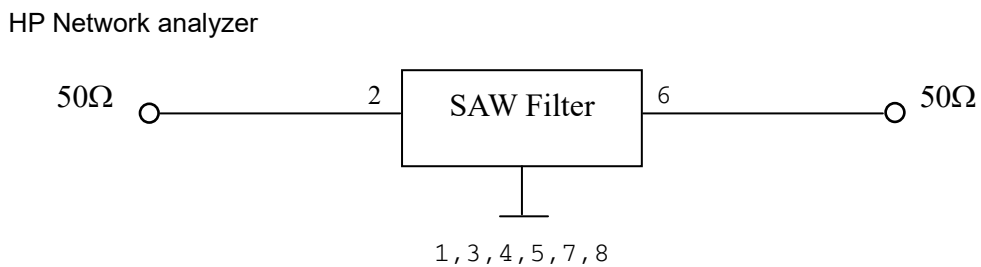

**F. PCB FOOTPRINT:**

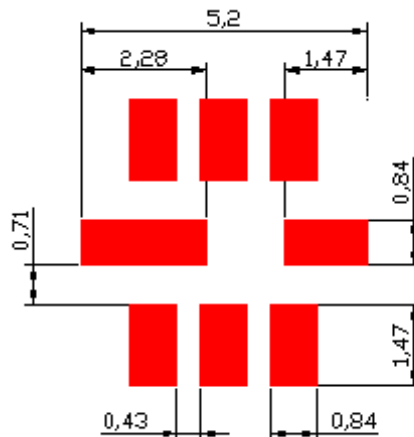

**SAW Filter: 424.0MHz**  
**Part No: MA07597**

**Model: TA0418A**  
**Rev No: 2**

**G. PACKING:**

1. Reel Dimensions

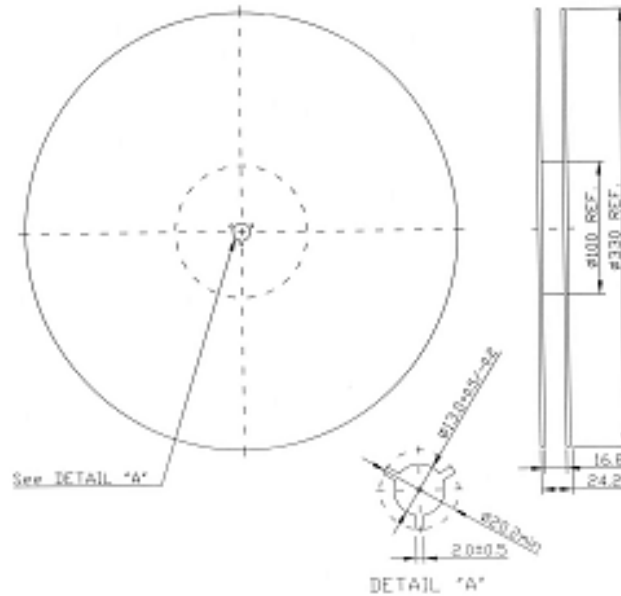

2. Tape Dimensions

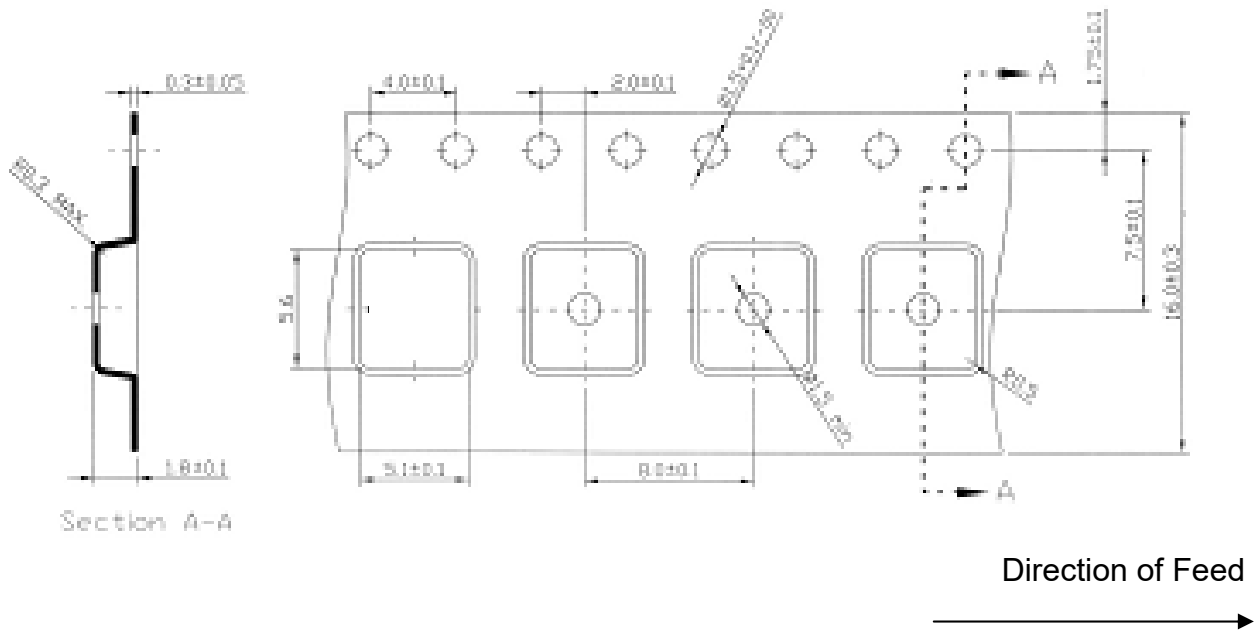

**SAW Filter: 424.0MHz**  
**Part No: MA07597**

**Model: TA0418A**  
**Rev No: 2**

**H. RECOMMENDED REFLOW PROFILE:**

1. Preheating shall be fixed at 150 ~ 180°C for 60 ~ 90 seconds.
2. Ascending time to preheating temperature 150°C shall be 30 seconds min.
3. Heating shall be fixed at 220°C for 50 ~ 80 seconds and at 260°C +0/-5°C peak (20 ~ 40 sec).
4. Time: 2 times.

