

SAW Filter 433.920MHz
Part No: MP07645

Model: TA0944C
Rev No: 2

A. MAXIMUM RATING:

Electrostatic Sensitive Device (ESD)

1. Input Power Level: 10dBm
2. DC voltage: 3V
3. Operating Temperature: -40°C to 85°C
4. Storage Temperature: -40°C to +85°C
5. Moisture Sensitivity Level: Level 1 (MSL1)

B. CHARACTERISTICS:

Item	Unit	Min.	Typ.	Max.
Center frequency Fc	MHz	-	433.92	-
Insertion loss (433.12 ~ 434.72MHz) IL	dB	-	1.8	2.9
Amplitude ripple (433.12 ~ 434.72MHz)	dB	-	0.4	1.0
VSWR (433.12 ~ 434.72MHz)	-	-	1.6	2.0
Attenuation (Reference level from 0 dB)				
10.0 ~ 380.00MHz	dB	58	61	-
380.00 ~ 423.42MHz	dB	46	50	-
443.42 ~ 453.42MHz	dB	25	30	-
453.42 ~ 460.00MHz	dB	35	40	-
460.00 ~ 700.00MHz	dB	50	54	-
700.00 ~ 1000.00MHz	dB	42	46	-
Source impedance Z _S	Ω	-	50	-
Load impedance Z _L	Ω	-	50	-

Note 1: No matching network required for operation at 50Ω

Note 2: For SiO₂ coating

C. MEASUREMENT CIRCUIT:

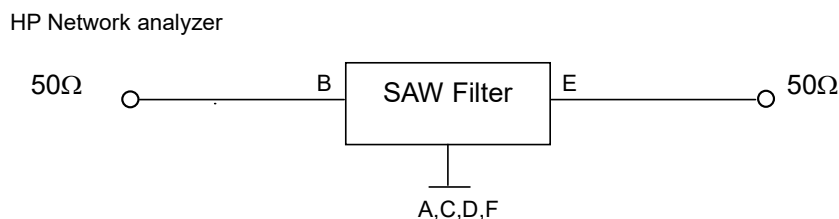

SAW Filter 433.920MHz
Part No: MP07645

Model: TA0944C
Rev No: 2

D. FREQUENCY CHARACTERISTICS:

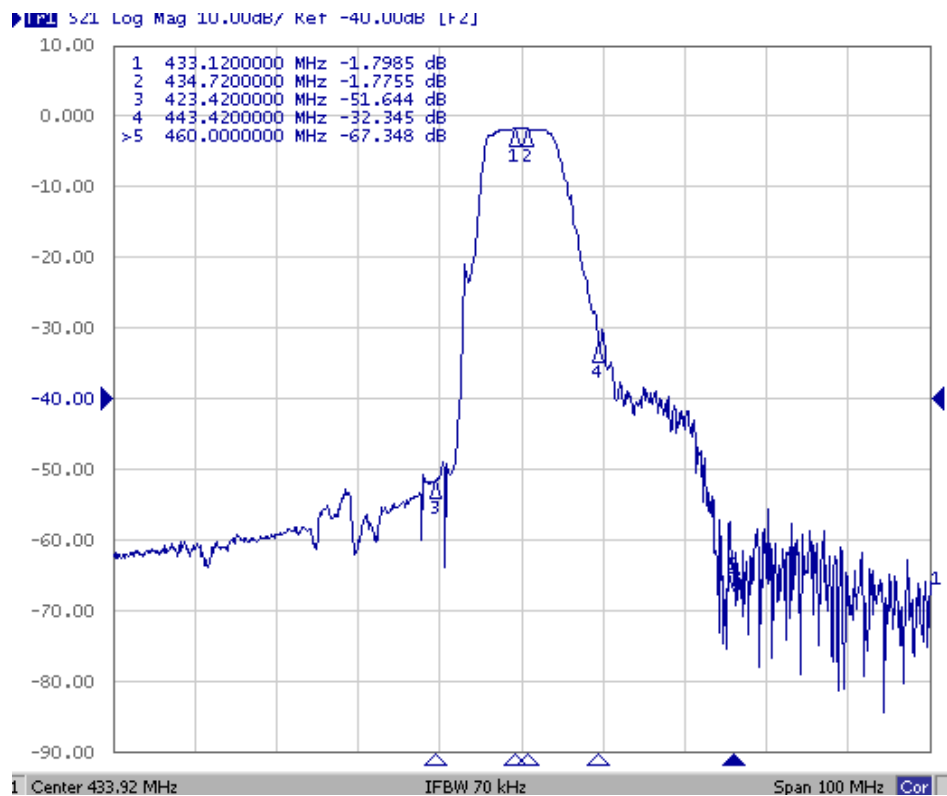
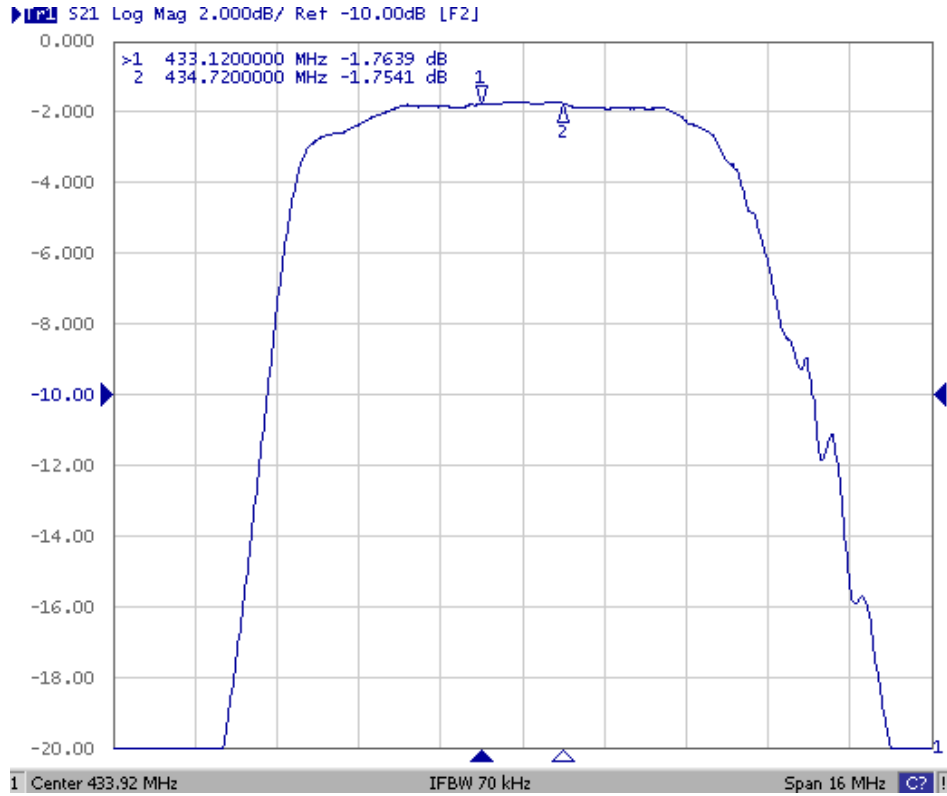

SAW Filter 433.920MHz
Part No: MP07645

Model: TA0944C
Rev No: 2

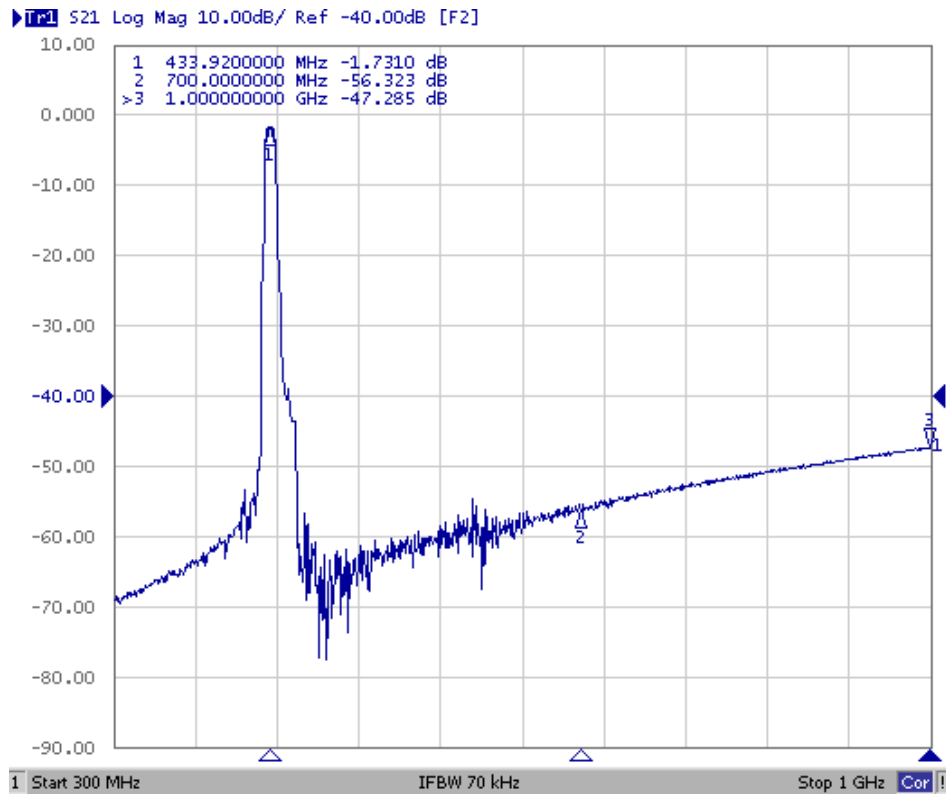

Reflection Functions:

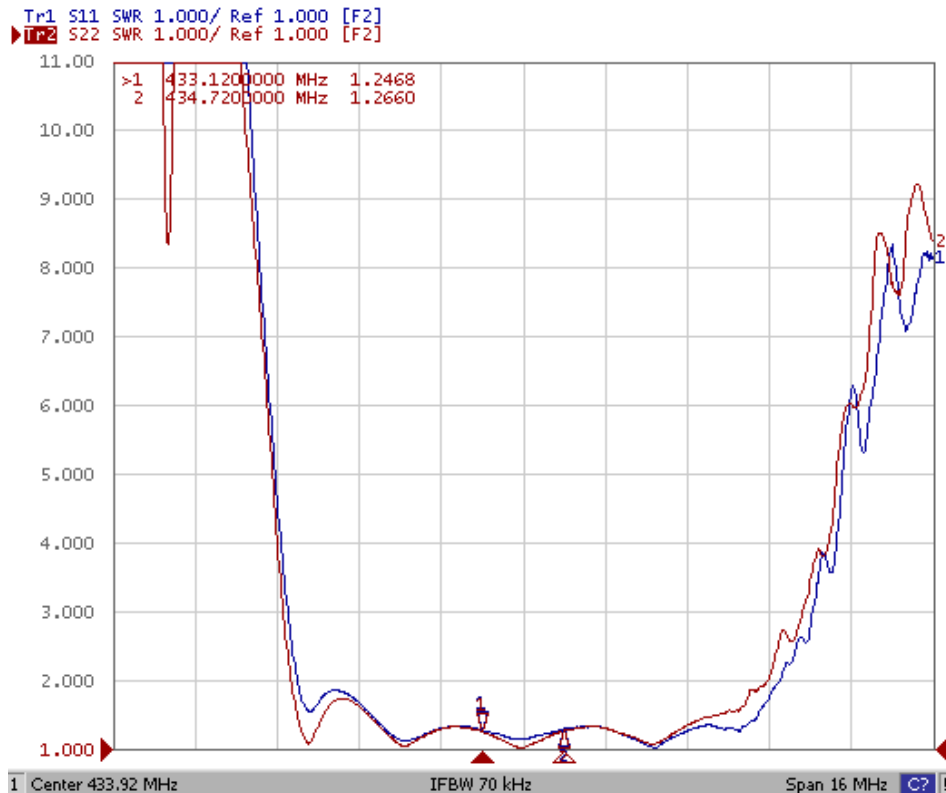

SAW Filter 433.920MHz
Part No: MP07645

Model: TA0944C
Rev No: 2

E. OUTLINE DRAWING:

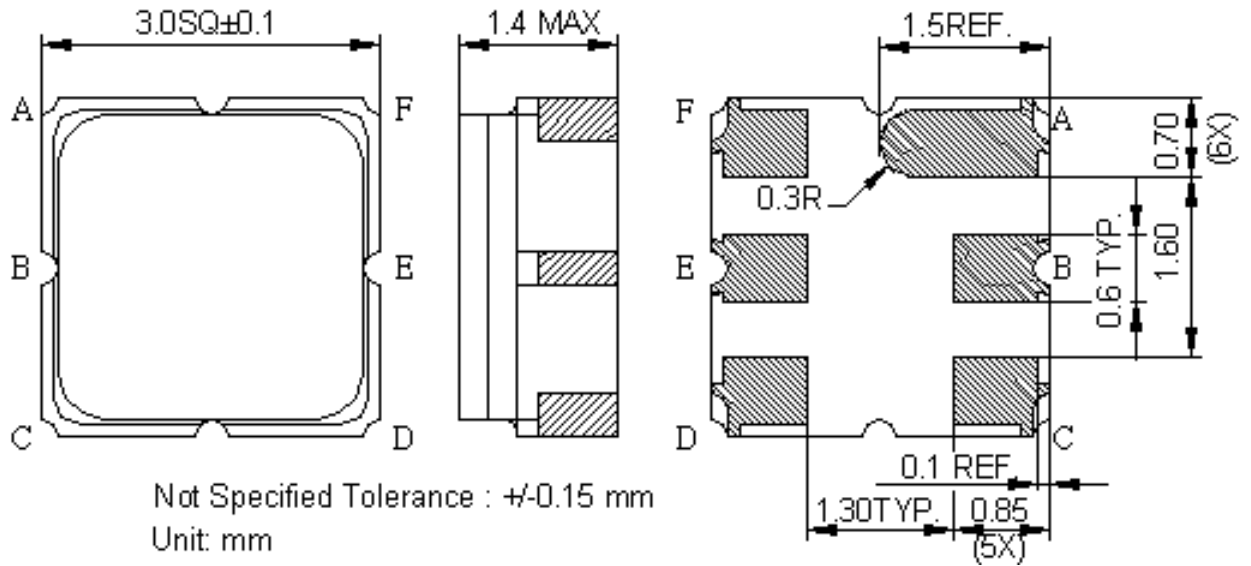

- B: Input
- E: Output
- A, C, D, F: Ground

F. PCB FOOTPRINT:

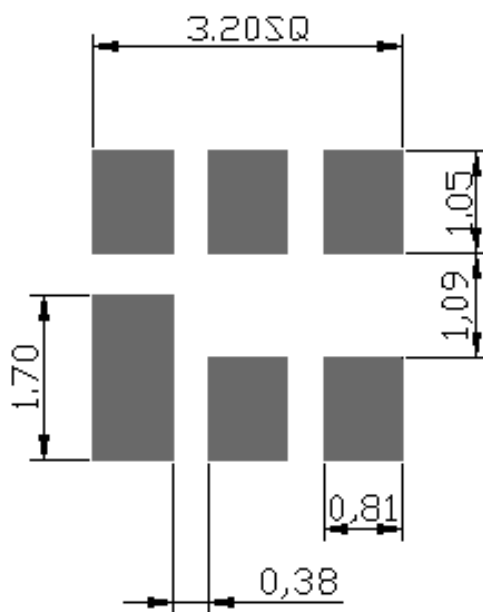

SAW Filter 433.920MHz
Part No: MP07645

Model: TA0944C
Rev No: 2

G. PACKING:

1. Reel Dimensions

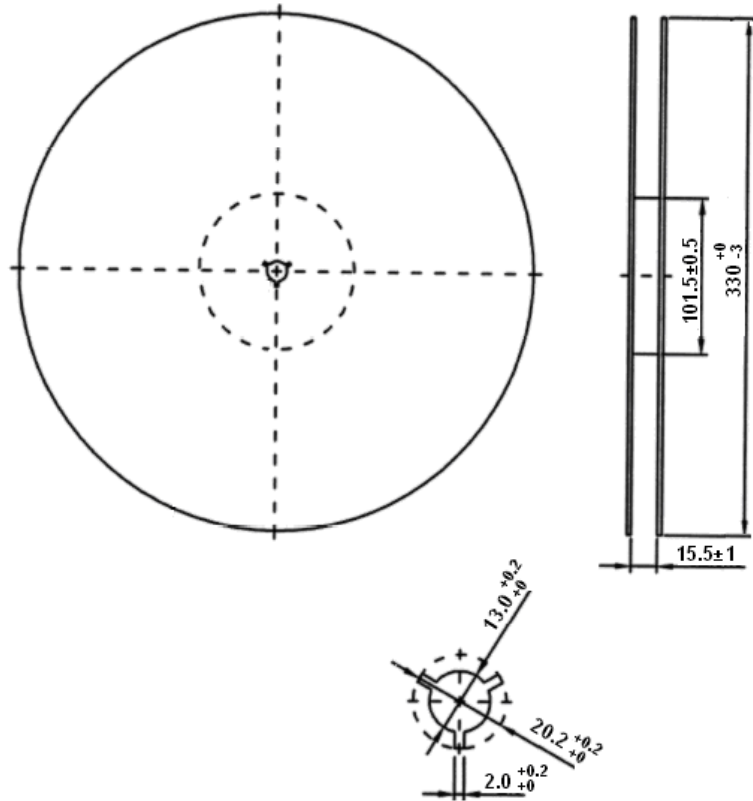

2. Tape Dimensions

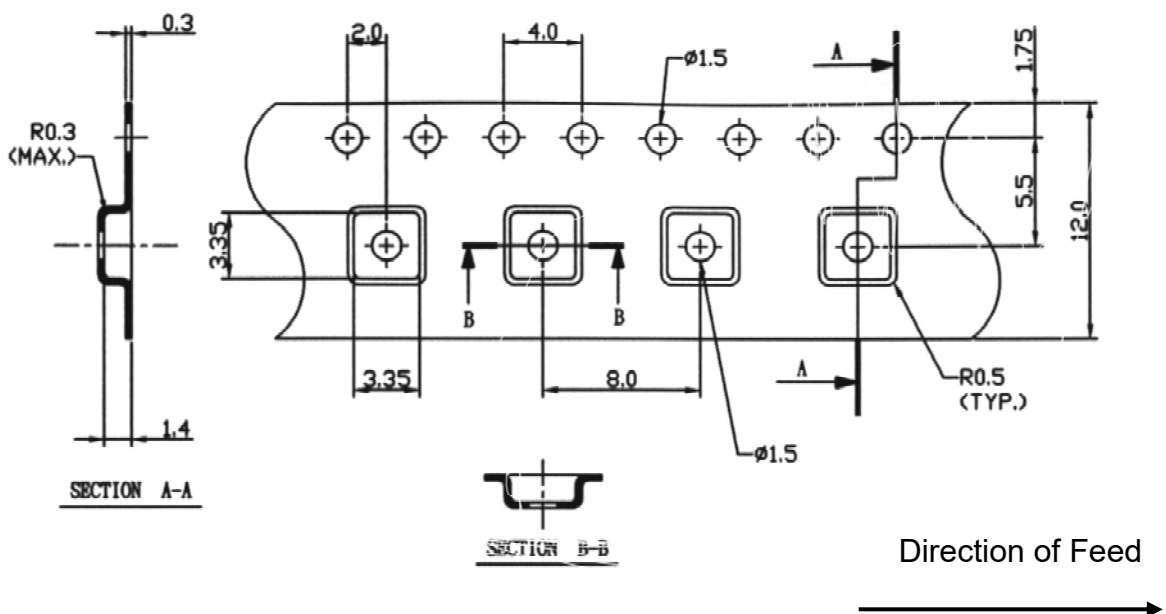

SAW Filter 433.920MHz
Part No: MP07645

Model: TA0944C
Rev No: 2

H. RECOMMENDED REFLOW PROFILE:

1. Preheating shall be fixed at 150~180°C for 60~90 seconds.
2. Ascending time to preheating temperature 150°C shall be 30 seconds min.
3. Heating shall be fixed at 220°C for 50~80 seconds and at 245~260°C peak (min. 10 sec).
4. Time: 2 times.

