

SAW Filter: 915MHz
Part No: MP02095

Model: TA0598A
Rev No: 1

A. MAXIMUM RATING:

1. Input Power Level: 15dBm
2. DC voltage: 5V
3. Operating Temperature: -40°C to 85°C
4. Storage Temperature: -40°C to +85°C

B. CHARACTERISTICS:

Item	Min.	Typ.	Max.
Center frequency F_c MHz	-	915	-
Insertion loss 902.0 ~ 928.0MHz IL (dB)	-	2.5	3.3
Amplitude ripple 902.0 ~ 928.0MHz (dB)	-	0.5	1.5
Attenuation (Reference level from 0dB)			
10 ~ 800MHz (dB)	45	54	-
800 ~ 845MHz (dB)	40	47	-
845 ~ 880MHz (dB)	35	45	-
947 ~ 992MHz (dB)	15	23	-
992 ~ 1020 MHz (dB)	35	45	-
1020 ~ 1200MHz (dB)	45	52	-
Source impedance Z_S (Ω)	-	50	-
Load impedance Z_L (Ω)	-	50	-

Note: No matching network required for operation at 50 Ω

C. MEASUREMENT CIRCUIT:

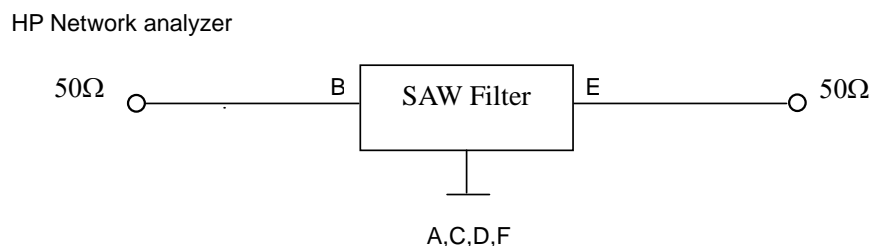

SAW Filter: 915MHz
Part No: MP02095

Model: TA0598A
Rev No: 1

D. FREQUENCY CHARACTERISTICS:

Transfer function

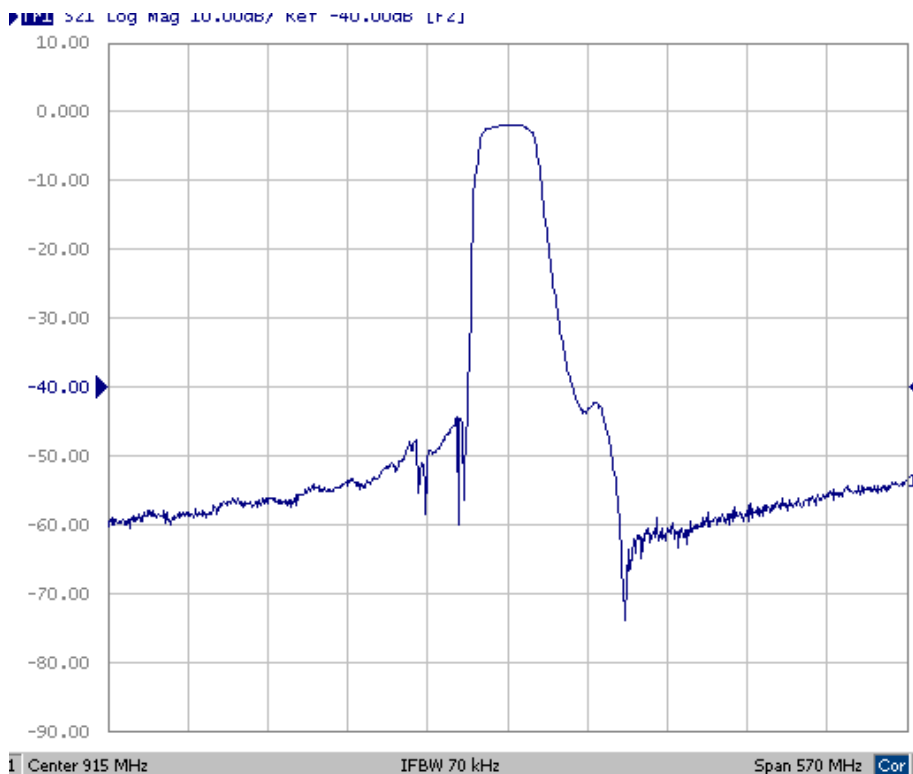
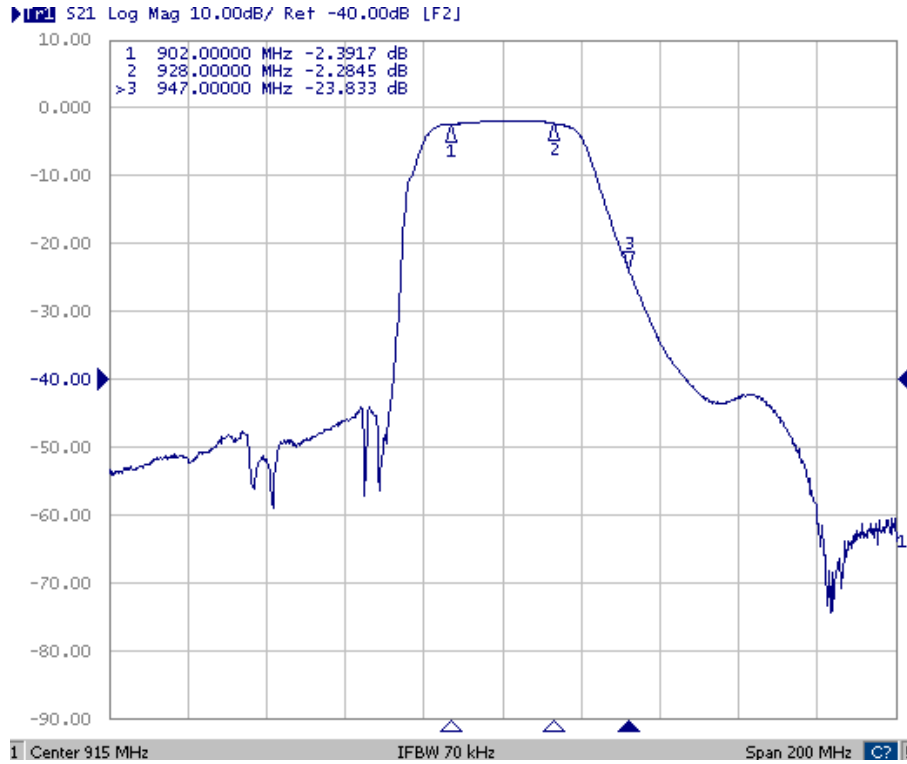

SAW Filter: 915MHz
Part No: MP02095

Model: TA0598A
Rev No: 1

E. OUTLINE DRAWING:

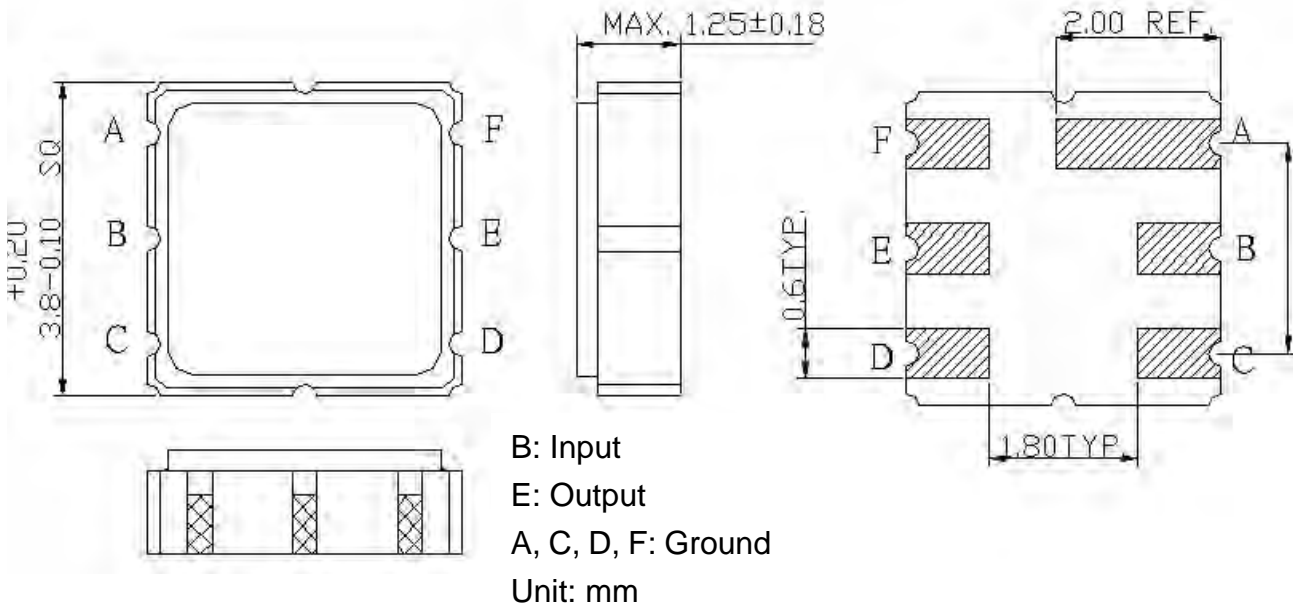

F. PCB FOOTPRINT:

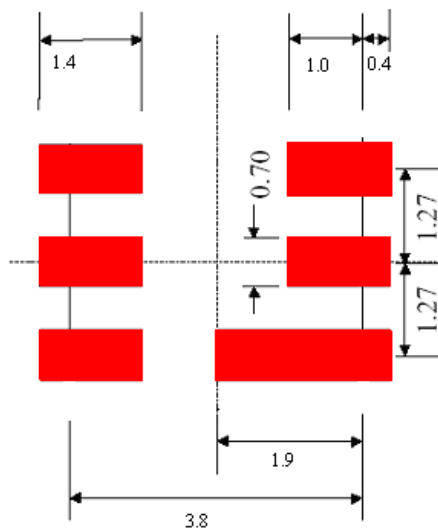

SAW Filter: 915MHz
Part No: MP02095

Model: TA0598A
Rev No: 1

G. PACKING:

1. Reel Dimension

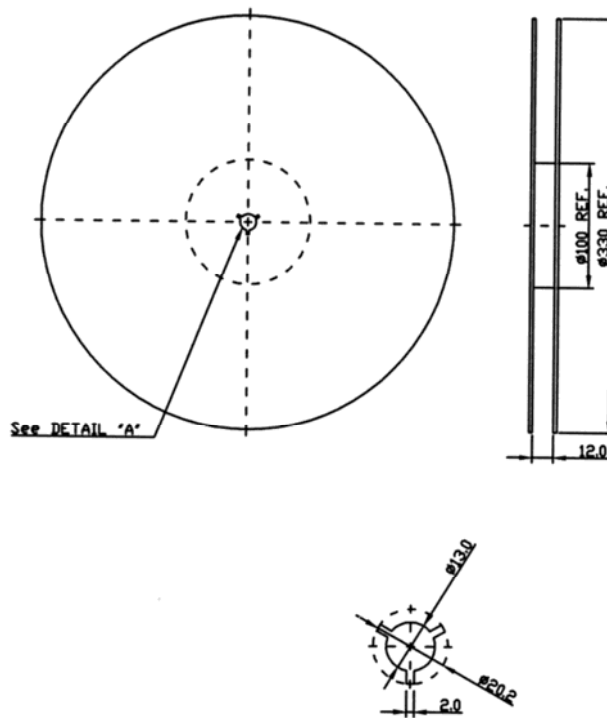

2. Tape Dimension

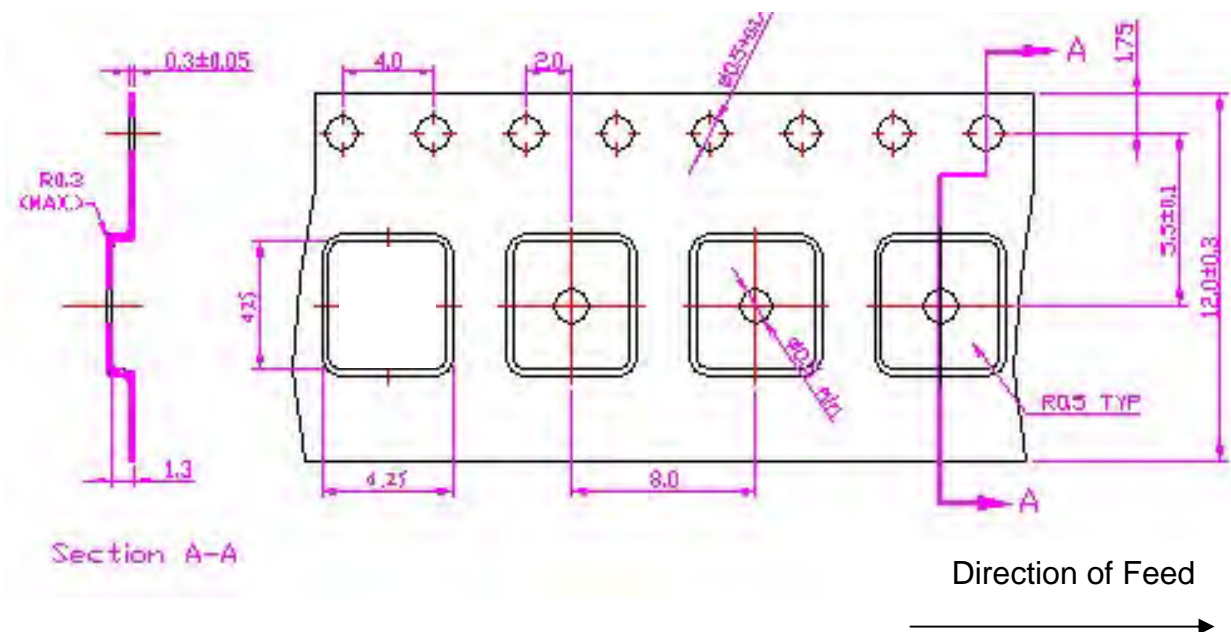

SAW Filter: 915MHz
Part No: MP02095

Model: TA0598A
Rev No: 1

H. RECOMMENDED REFLOW PROFILE:

