

SAW Filter 267.50MHz
Part No: MP03611

Model: TA1150A
Rev No: 1

A. MAXIMUM RATING:

1. Input Power Level: 10dBm
2. DC voltage: 5V
3. Operating Temperature: -10°C to +50°C
4. Storage Temperature: -40°C to +85°C

B. ELECTRICAL CHARACTERISTICS:

Item	Unit	Min.	Typ.	Max.
Center Frequency	MHz	-	267.5	-
Insertion Loss 260 ~ 275MHz	dB	-	3.2	5
Amplitude Ripple 260 ~ 275MHz	dB	-	1.4	3
Attenuation (reference from 0dB)				
192.5 ~ 240MHz	dB	35	42	-
310 ~ 342.5MHz	dB	40	47	-
Source impedance Z_S	Ω	-	50	-
Load impedance Z_L	Ω	-	50	-

C. MEASUREMENT CIRCUIT:

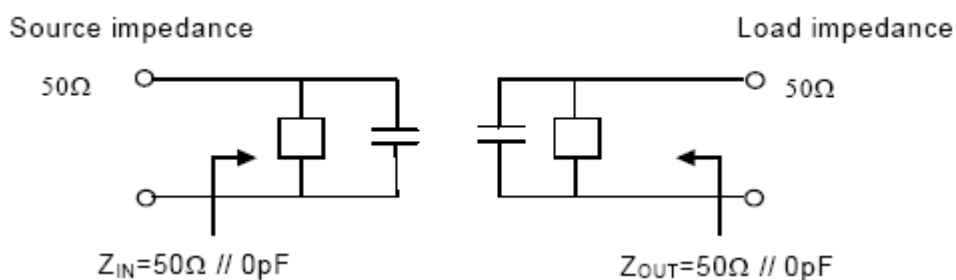

SAW Filter 267.50MHz
Part No: MP03611

Model: TA1150A
Rev No: 1

D. FREQUENCY CHARACTERISTICS:

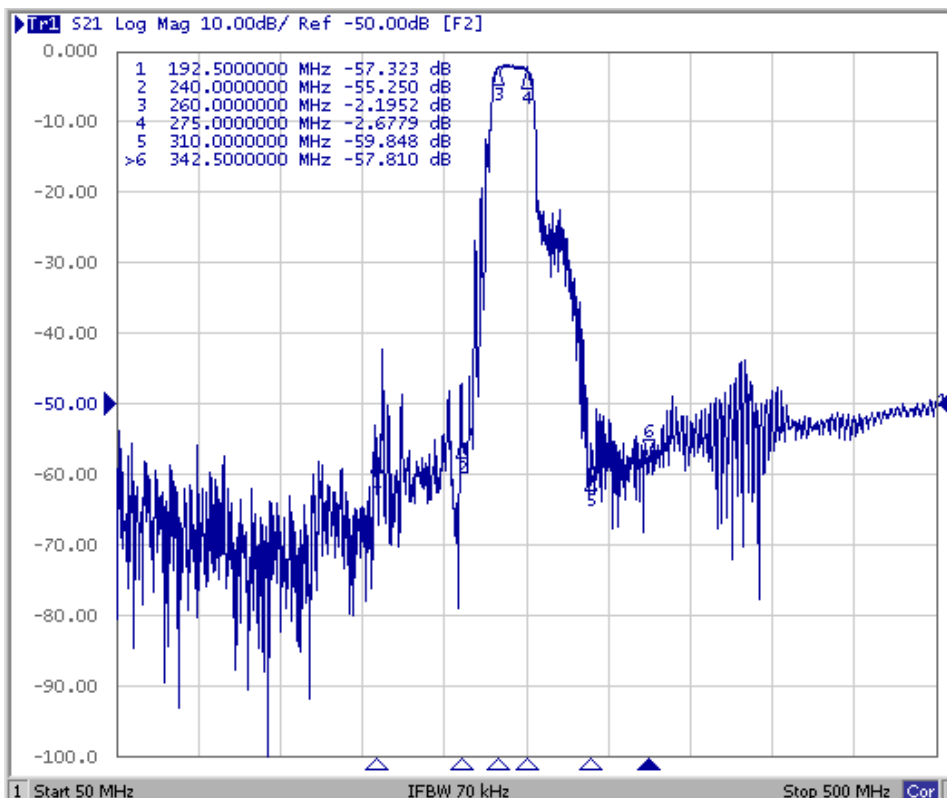
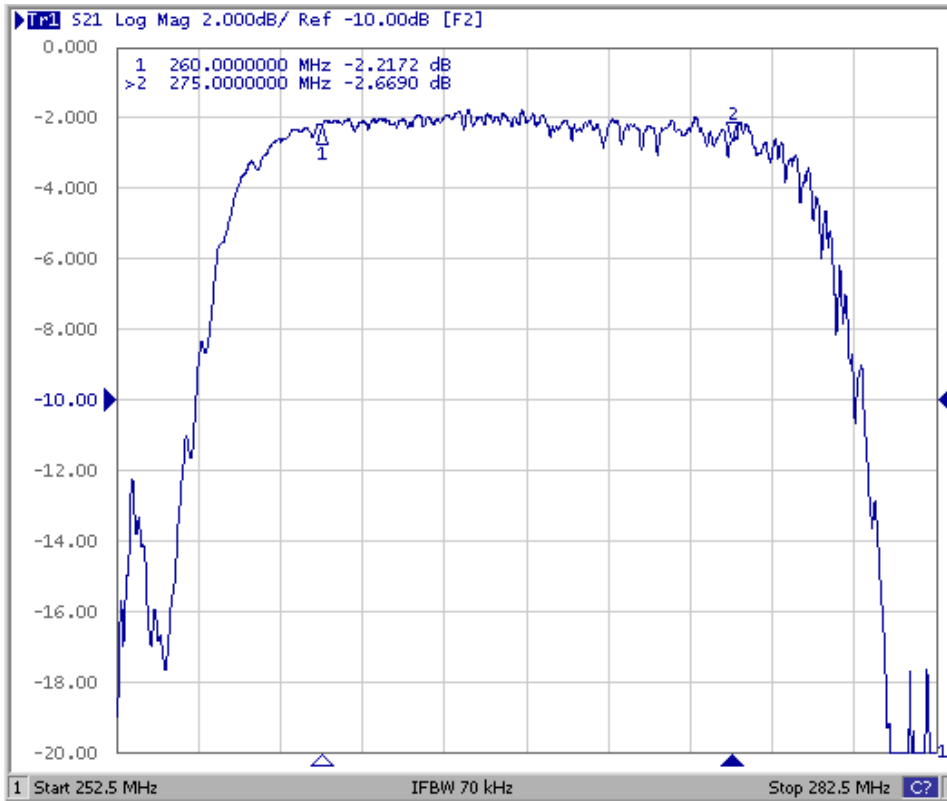

SAW Filter 267.50MHz
Part No: MP03611

Model: TA1150A
Rev No: 1

E. PCB FOOTPRINT:

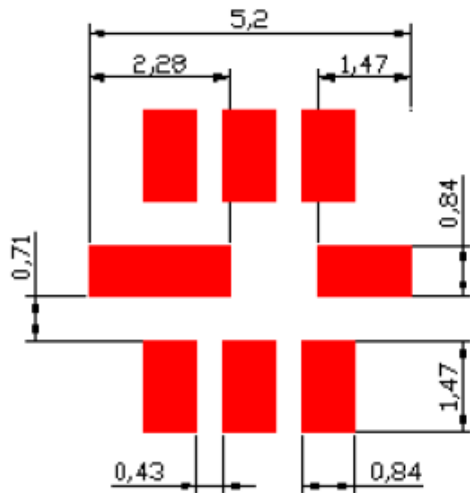

F. OUTLINE DRAWING:

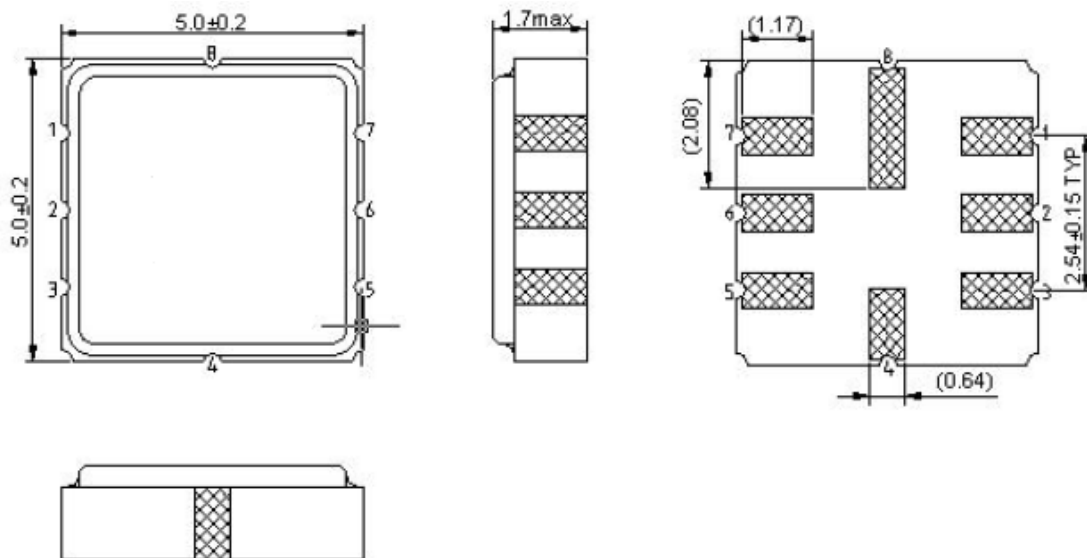

- #2: Input
- #6: Output
- #1,3,4,5,7,8: Ground

SAW Filter 267.50MHz
Part No: MP03611

Model: TA1150A
Rev No: 1

G. PACKING:

1. Reel Dimension

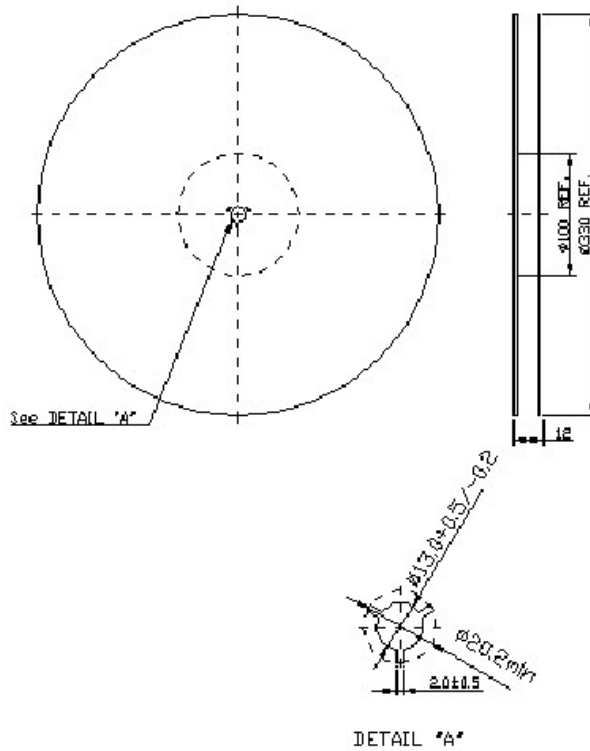

2. Tape Dimension

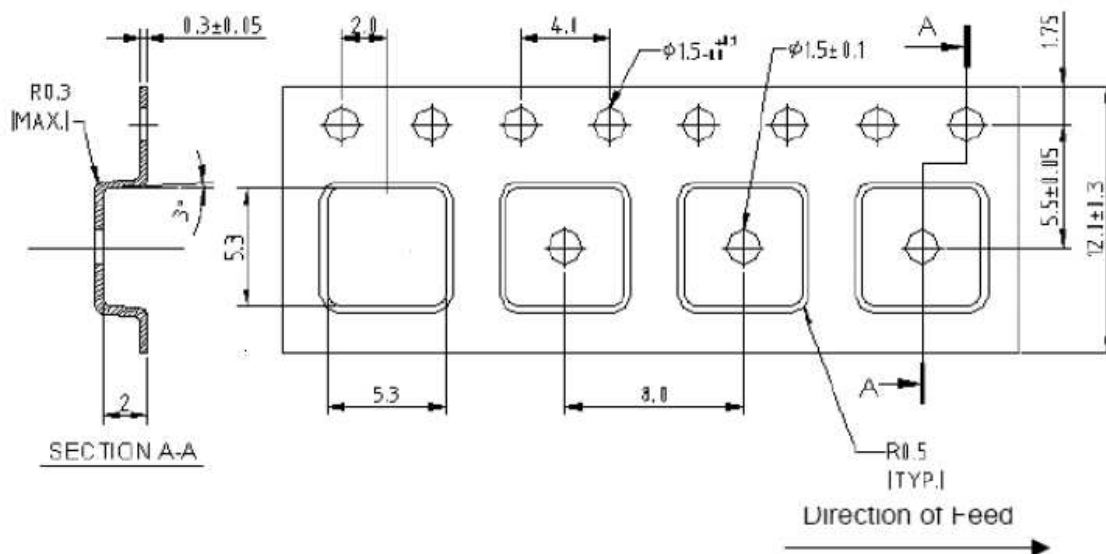

SAW Filter 267.50MHz
Part No: MP03611

Model: TA1150A
Rev No: 1

H. RECOMMENDED REFLOW PROFILE:

