

**SAW Filter 2185.0MHz**  
**Part No: MP01007**

**Model: TA0752A**  
**Rev No: 1**

**A. MAXIMUM RATING:**

1. Input Power Level: 10dBm
2. DC voltage: 3V
3. Operating Temperature: -30°C to +85°C
4. Storage Temperature: -40°C to +85°C

**B. ELECTRICAL CHARACTERISTICS:**

Item	Min.	Typ.	Max.
Center frequency Fc (MHz)	-	2185	-
Insertion loss within 2170 ~2200MHz IL (dB)	-	2.4	4
Amplitude ripple (p-p) within 2170 ~ 2200MHz (dB)	-	0.7	2.0
Attenuation (Reference level from 0dB)			
DC ~ 500MHz (dB)	20	32	-
500 ~ 1950MHz (dB)	18	28	-
1950 ~ 2090MHz (dB)	22	33	-
2270 ~ 2350MHz (dB)	24	36	-
2350 ~ 4000MHz (dB)	22	34	-
VSWR within 2170 ~ 2200MHz	-	1.7	2.5
Source impedance Z <sub>S</sub> (Ω)	-	50	-
Load impedance Z <sub>L</sub> (Ω)	-	50	-

**SAW Filter 2185.0MHz**  
**Part No: MP01007**

**Model: TA0752A**  
**Rev No: 1**

**C. FREQUENCY CHARACTERISTICS:**

1. Wide band Response: (span 800MHz)

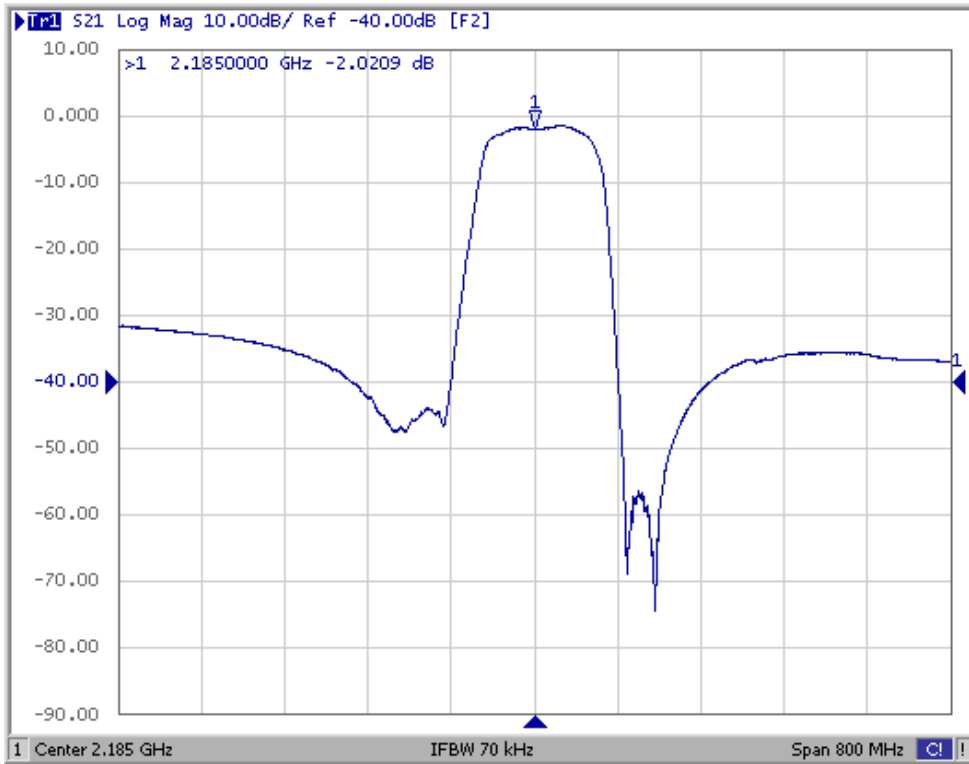

2. Pass band Response: (span 120MHz)

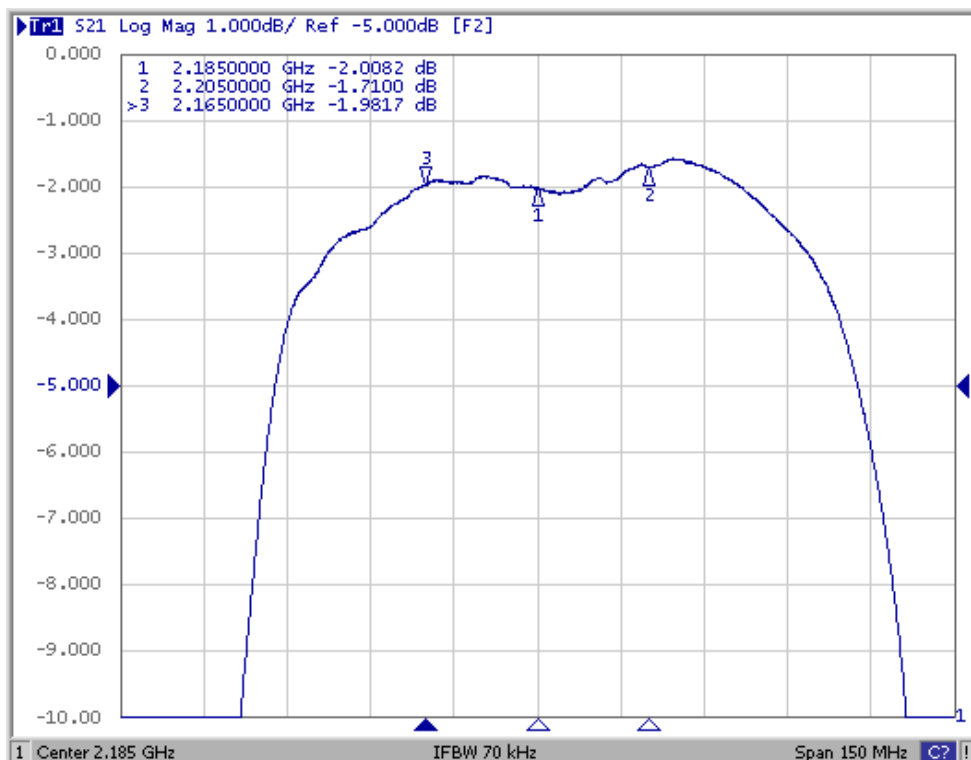

**SAW Filter 2185.0MHz**  
**Part No: MP01007**

**Model: TA0752A**  
**Rev No: 1**

**D. MEASUREMENT CIRCUIT:**

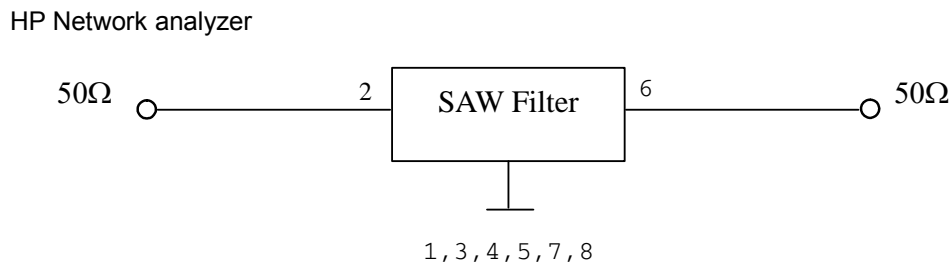

**E. OUTLINE DRAWING:**

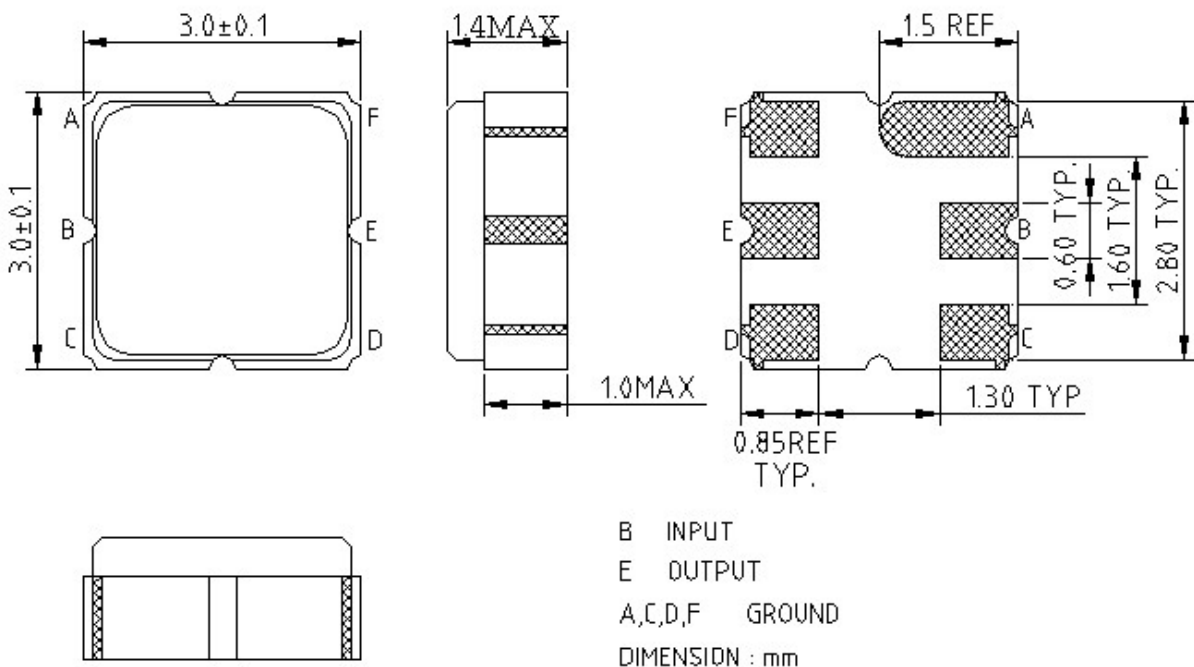

**SAW Filter 2185.0MHz**  
**Part No: MP01007**

**Model: TA0752A**  
**Rev No: 1**

**F. PACKING:**

1. Reel Dimension

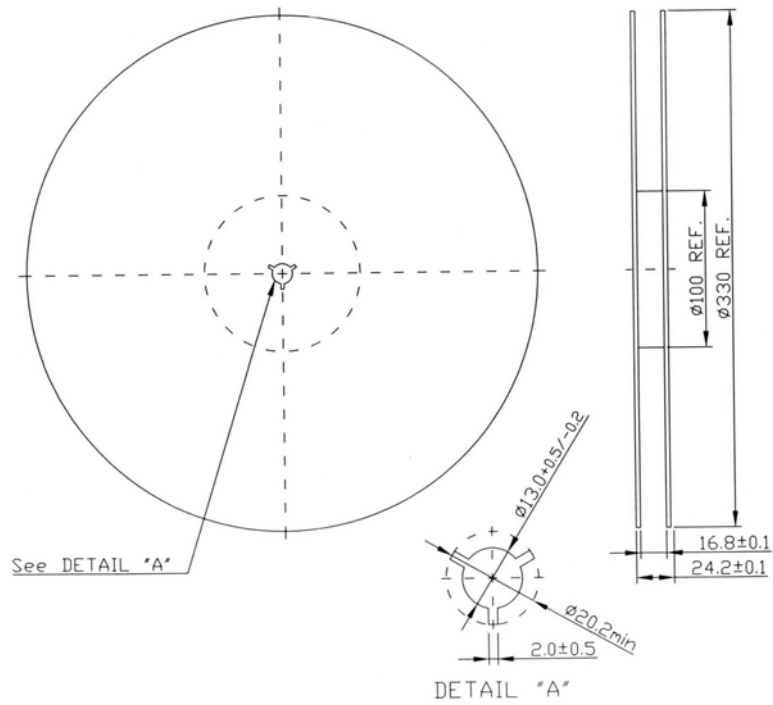

2. Tape Dimension

