

SAW Filter 400.0MHz
Part No: MP05824

Model: TA0591A
Rev No: 1

A. MAXIMUM RATING:

1. Input Power Level: 10dBm
2. DC voltage: 3V
3. Operating Temperature: -55°C to +85°C
4. Storage Temperature: -55°C to +85°C

B. ELECTRICAL CHARACTERISTICS:

| Item | Unit | Min. | Typ. | Max. |
|--|------|------|------|------|
| Center frequency Fc | MHz | - | 400 | - |
| Insertion Loss IL min (reference level) | dB | - | 1.3 | 2.8 |
| 2dB Bandwidth BW -2dB | MHz | 17 | 21.4 | - |
| Absolute Attenuation: (Reference level from 0dB) | | | | |
| Fc -45 to Fc -100MHz | dB | 40 | 55 | - |
| Fc +45 to Fc +55MHz | dB | 30 | 55 | - |
| Fc +55 to Fc +100MHz | dB | 40 | 50 | - |
| Fc +100 to Fc +1000MHz | dB | 30 | 38 | - |
| Source impedance Z _S | Ω | - | 50 | - |
| Load impedance Z _L | Ω | - | 50 | - |

Note: IL min is the minimum of the pass band attenuation. The center frequency Fc is the mean value of the upper and lower frequencies at the 2dB filter attenuation level relative to the IL min.

SAW Filter 400.0MHz
Part No: MP05824

Model: TA0591A
Rev No: 1

C. FREQUENCY CHARACTERISTICS:

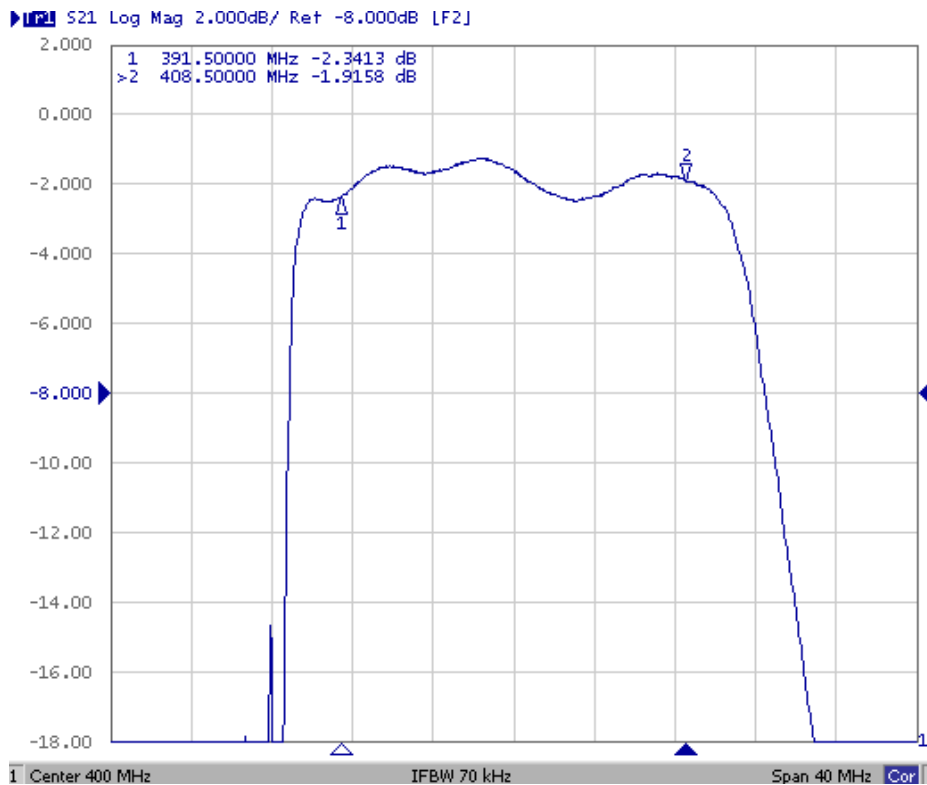
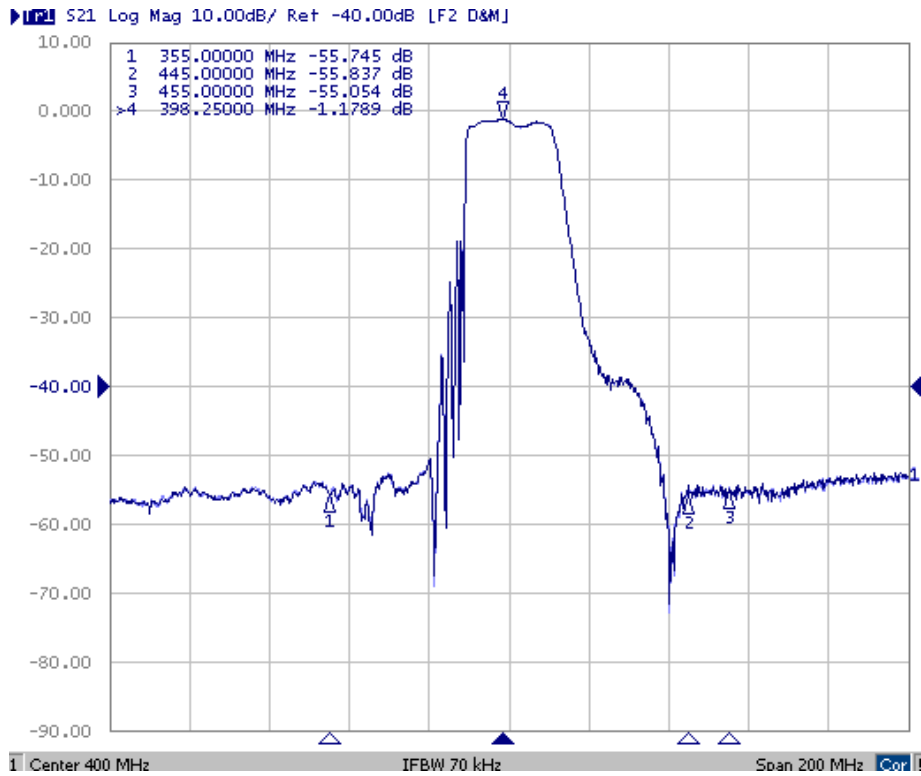

SAW Filter 400.0MHz
Part No: MP05824

Model: TA0591A
Rev No: 1

D. MEASUREMENT CIRCUIT:

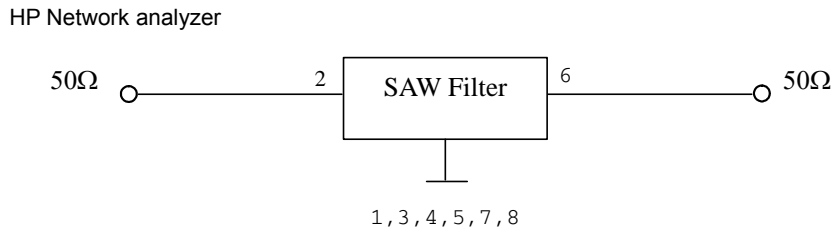

E. OUTLINE DRAWING:

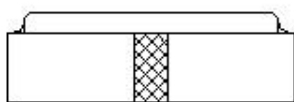
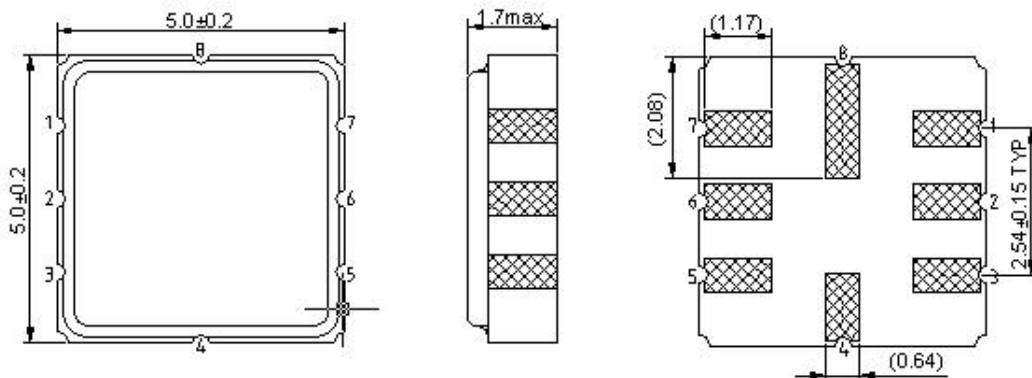

2: Input
 6: Output
 1, 3, 4, 5, 7, 8: Ground
 Unit: mm

F. PCB FOOTPRINT:

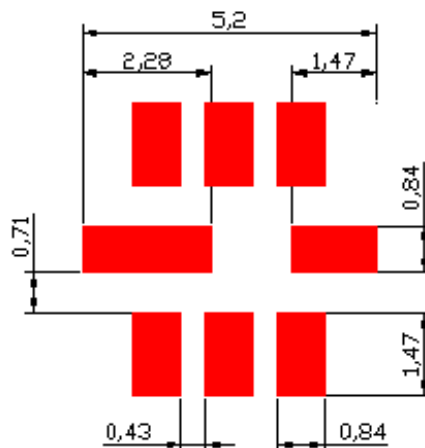

SAW Filter 400.0MHz
Part No: MP05824

Model: TA0591A
Rev No: 1

G. PACKING:

1. Reel Dimension

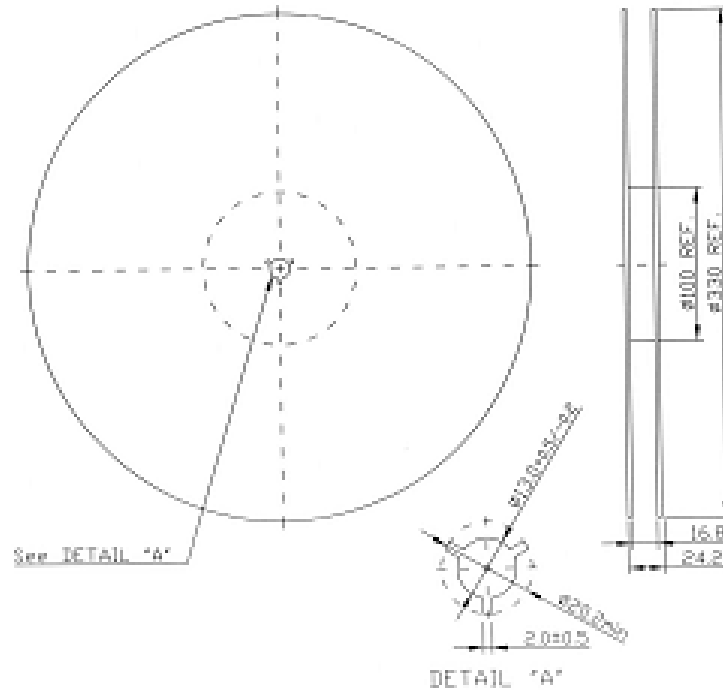

2. Tape Dimension

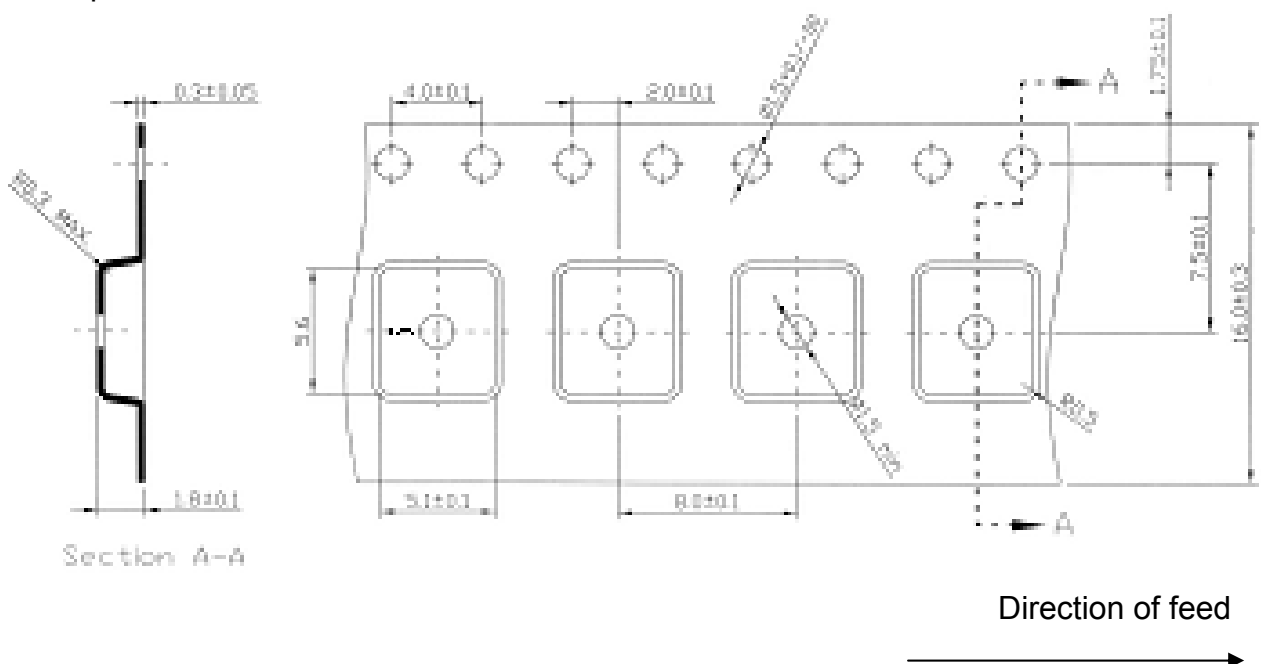

SAW Filter 400.0MHz
Part No: MP05824

Model: TA0591A
Rev No: 1

H. RECOMMENDED REFLOW PROFILE:

