

SAW Filter 806.0MHz
Part No: MP07855

Model: TA2041A
Rev No: 1

A. MAXIMUM RATING:

Electrostatic Sensitive Device (ESD)

1. Operating temperature range: -20°C to +85°C
2. Storage temperature range: -20°C to +85°C
3. Input power: 15dBm
4. Maximum DC Voltage: ±3V
5. Moisture Sensitivity Level: Level 1 (MSL 1)
6. ESD 100V (MM) 200V (HBM)

B. ELECTRICAL CHARACTERISTICS:

1. Terminating source impedance: $Z_S = 50\Omega$
2. Terminating load impedance: $Z_L = 50\Omega$

Parameters Description		Unit	Min	Typ	Max	Remarks
Insertion Loss	791~ 821MHz	dB(*1)	-	2.7	3.8	
Amplitude ripple	791~ 821MHz	dB	-	1.4	2.6	
VSWR	Input	791~ 821MHz	-	-	2.1	2.4
	Output	791~ 821MHz	-	-	2.1	2.4
Attenuation:						
832 ~ 862MHz		dB	37	41	-	
1559 ~ 1607MHz		dB	40	45	-	
1582 ~ 1642MHz		dB	40	45	-	
2373 ~ 2463MHz		dB	30	37	-	
2400 ~ 2500MHz		dB	30	37	-	
3164 ~ 3284MHz		dB	25	34	-	
3955 ~ 4105MHz		dB	20	31	-	
4746 ~ 4926MHz		dB	20	29	-	
4900 ~ 5950MHz		dB	20	26	-	
5537 ~ 5747MHz		dB	20	27	-	
6328 ~ 6568MHz		dB	20	25	-	
7119 ~ 7389MHz		dB	15	23	-	
Input impedance		Ω	50			single-ended
Output impedance		Ω	50			single-ended

(*1) Specification of insertion loss excludes loss that comes from the test board.

SAW Filter 806.0MHz
Part No: MP07855

Model: TA2041A
Rev No: 1

C. FREQUENCY CHARACTERISTICS:

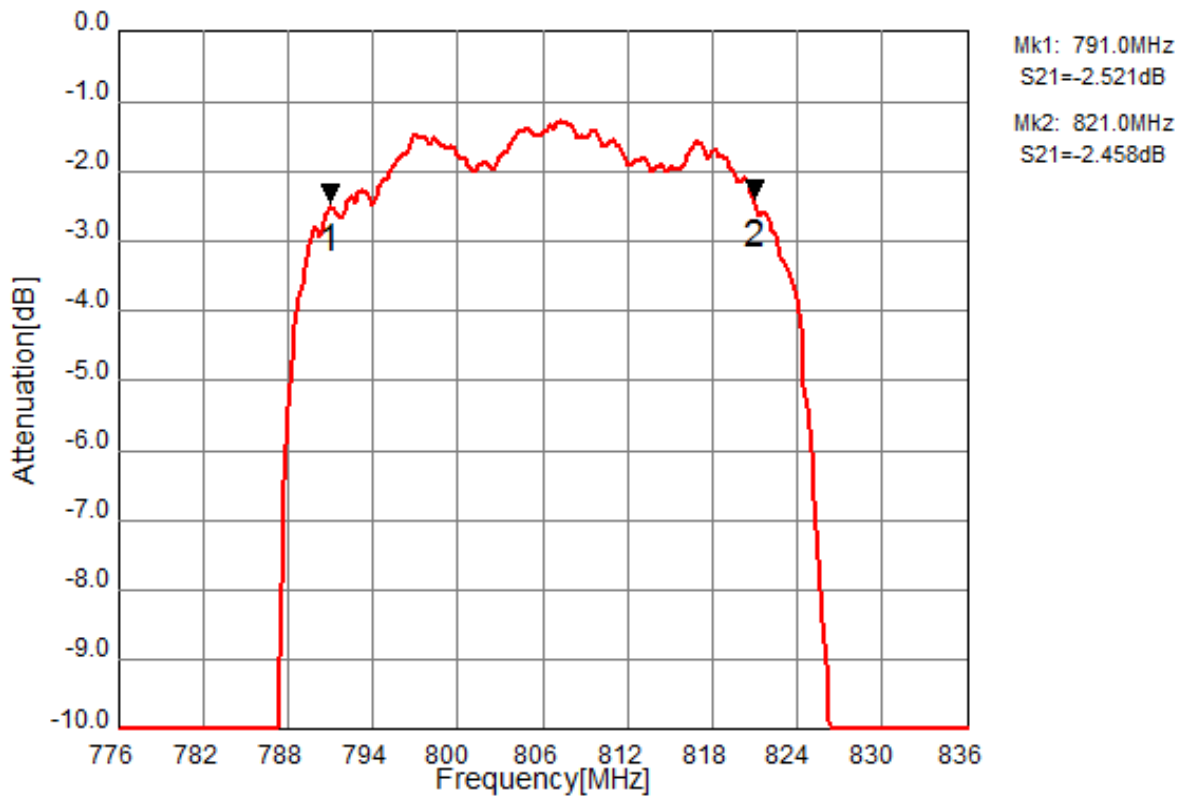
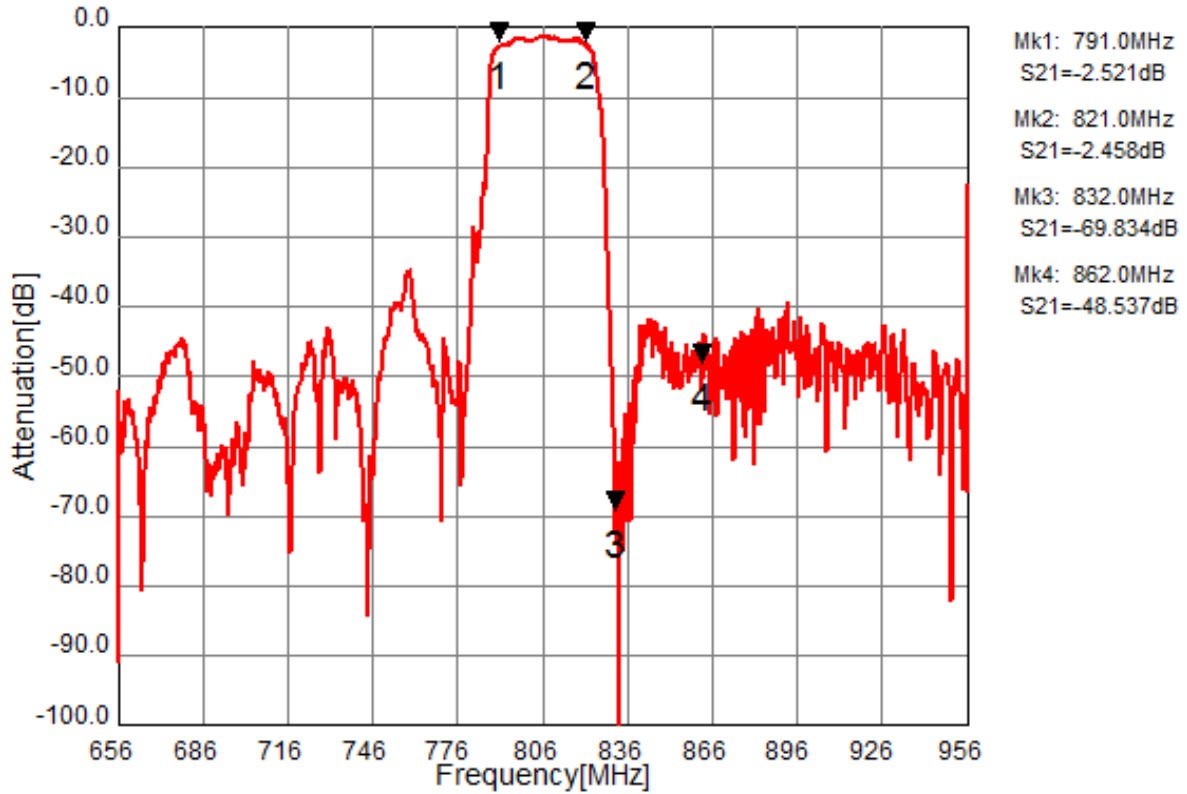

SAW Filter 806.0MHz
Part No: MP07855

Model: TA2041A
Rev No: 1

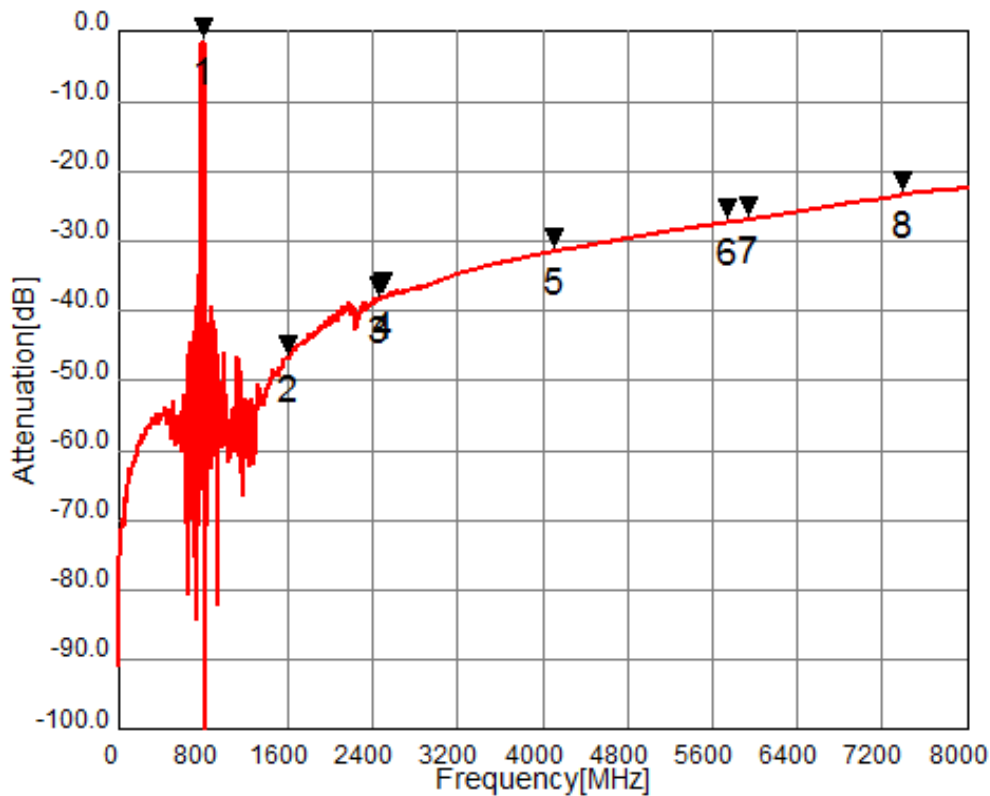
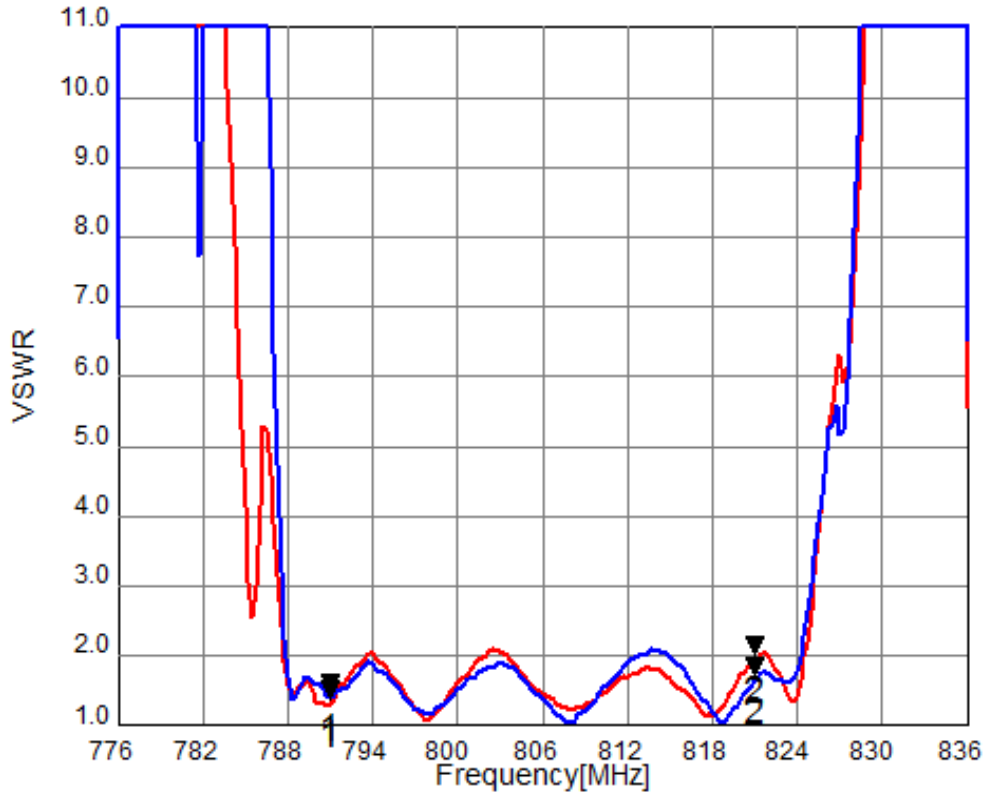

SAW Filter 806.0MHz
Part No: MP07855

Model: TA2041A
Rev No: 1

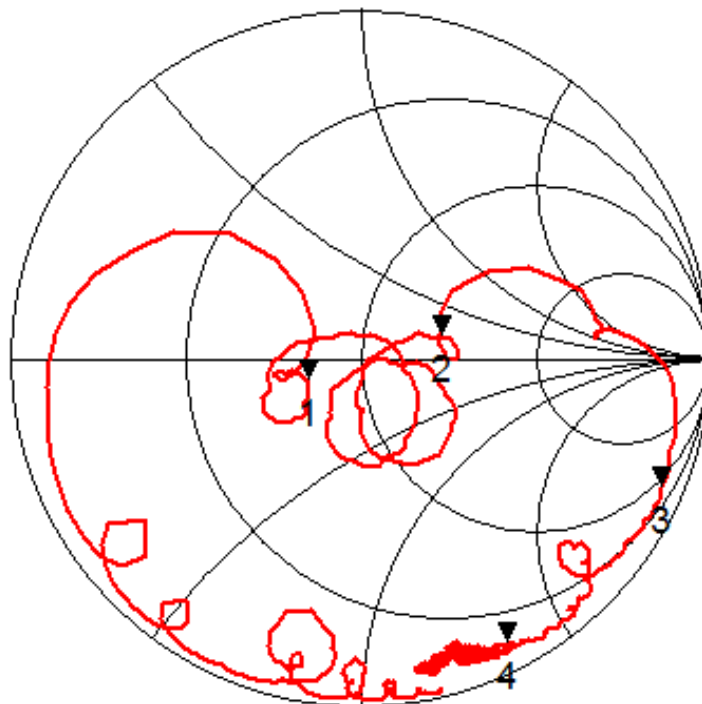
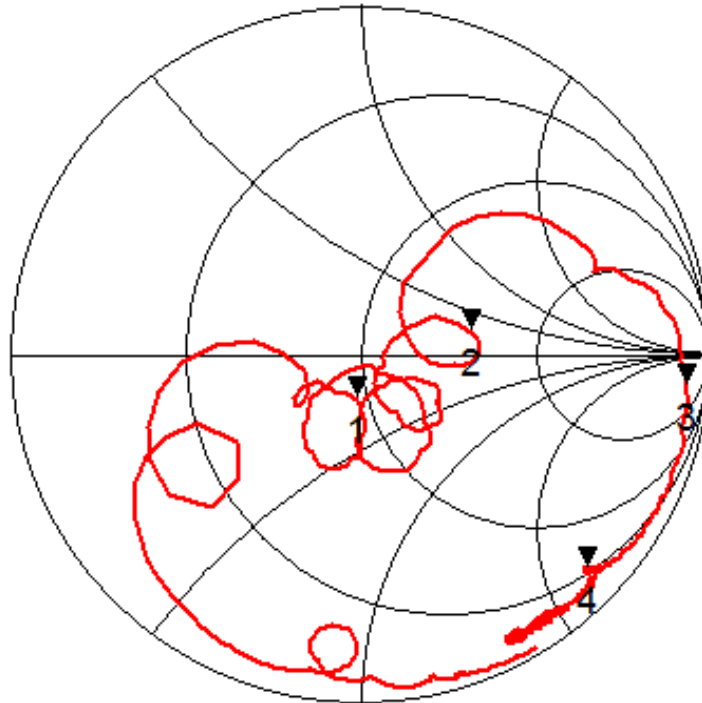

SAW Filter 806.0MHz
Part No: MP07855

Model: TA2041A
Rev No: 1

D. OUTLINE DRAWING:

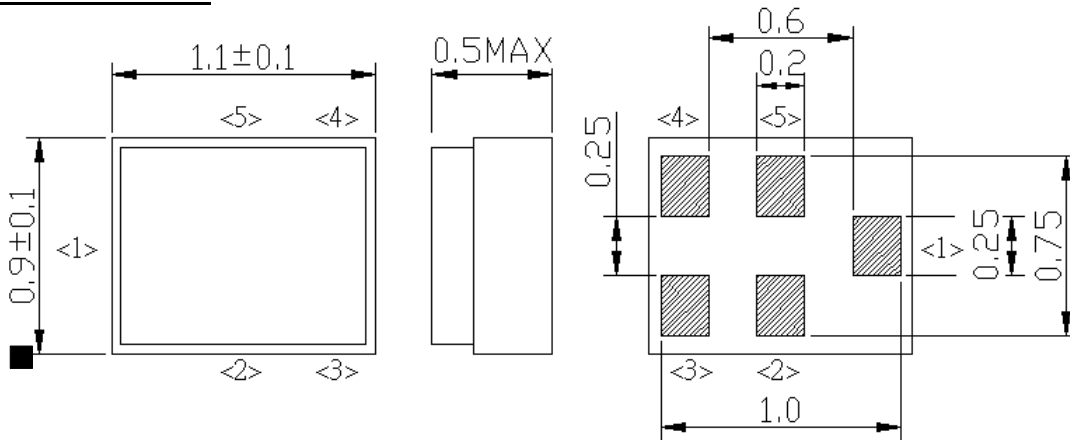

Unit: mm

Pin Configuration

Pin No.	Symbol	Function
1	IN	Single-ended pin
2	GND	Ground
3	GND	Ground
4	OUT	Single-ended pin
5	GND	Ground

E. EVALUATION CIRCUIT:

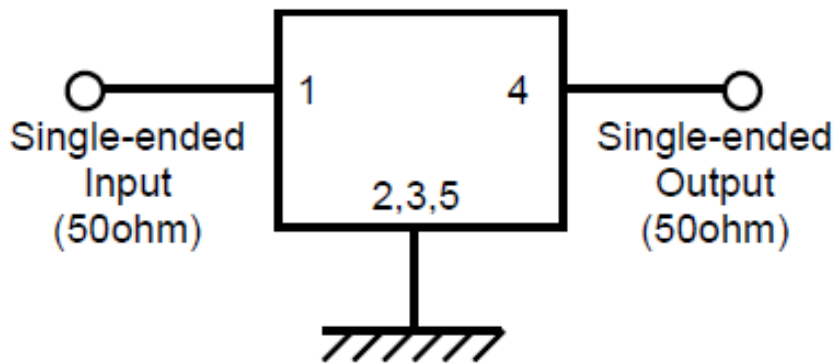

F. PCB FOOTPRINT:

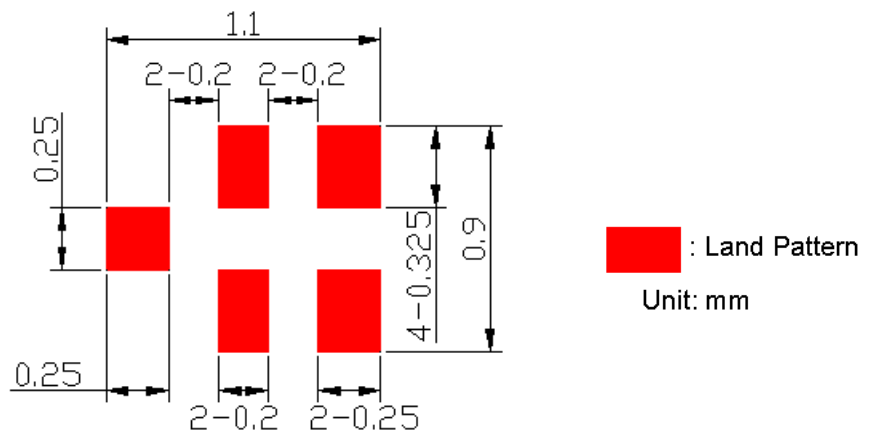

SAW Filter 806.0MHz
Part No: MP07855

Model: TA2041A
Rev No: 1

G. PACKING:

1. Reel Dimension (Please refer to FR-75D10 for packing quantity)

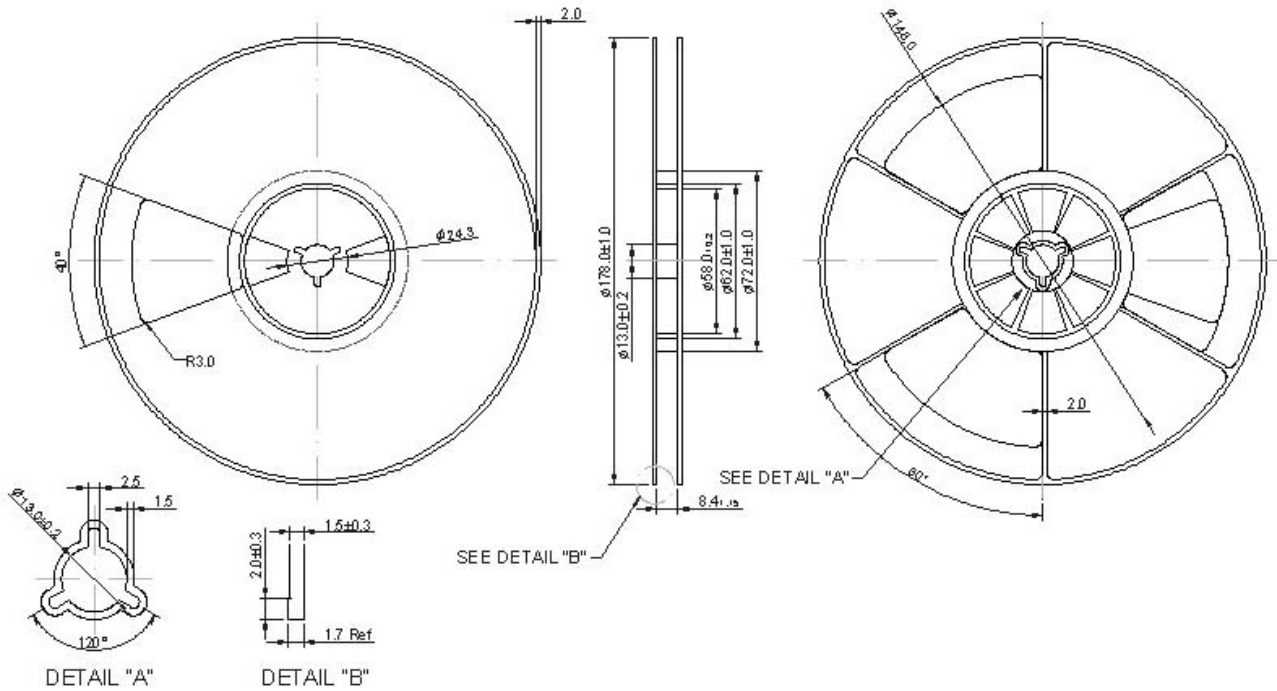

2. Tape Dimension

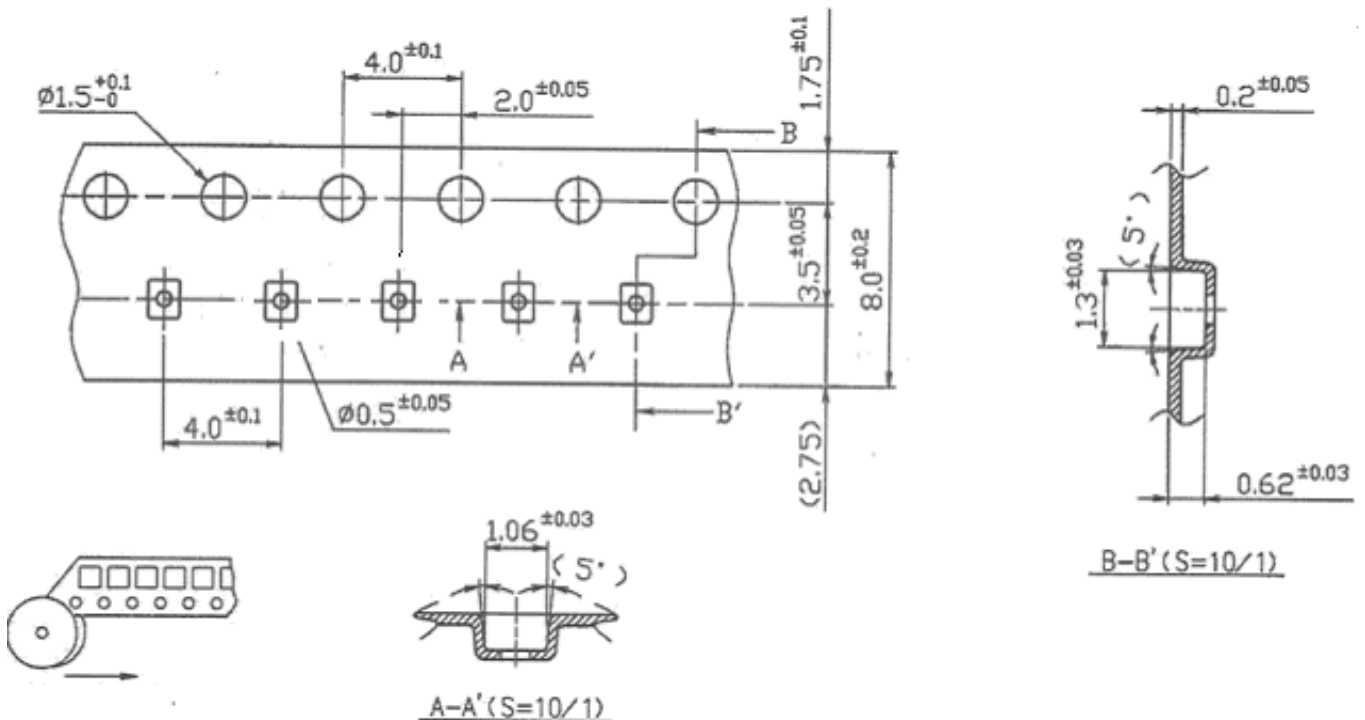

SAW Filter 806.0MHz
Part No: MP07855

Model: TA2041A
Rev No: 1

H. RECOMMENDED REFLOW PROFILE:

1. Preheating shall be fixed at 150 ~ 180°C for 60 ~ 90 seconds.
2. Ascending time to preheating temperature 150°C shall be 30 seconds min.
3. Heating shall be fixed at 220°C for 50 ~ 80 seconds and at 245 ~ 260°C peak (min. 10 sec).
4. Time: 2 times.

