

**SAW Filter 2535.0MHz**  
**Part No: MP07846**

**Model: TA1886A**  
**Rev No: 1**

**A. MAXIMUM RATING:**

Electrostatic Sensitive Device (ESD)

1. Power handling: +10dBm (CW tone)
2. Operating temperature: -30°C to +85°C

**B. ELECTRICAL CHARACTERISTICS:**

1. Terminating source impedance:  $Z_S = 50 \parallel 7.1\text{nH } \Omega$  (Single)
2. Terminating load impedance:  $Z_L = 50 \parallel 12\text{nH } \Omega$  (Single)

Parameters Description		Unit	Min.	Typ.	Max.
Center Frequency		MHz	-	2535	-
Insertion Loss	2500 ~ 2570MHz	dB(*1)	-	1.7	2.5
Amplitude ripple	2500 ~ 2570MHz	dB	-	0.5	1.5
VSWR(Input)	2500 ~ 2570MHz	-	-	1.3	2.0
VSWR(Output)	2500 ~ 2570MHz	-	-	1.3	2.0
Attenuation:					
0.3 ~ 960MHz		dB	20	27	-
1560 ~ 1610MHz		dB	17	20	-
1710 ~ 1995MHz		dB	17	21	-
1995 ~ 2170MHz		dB	17	21	-
2400 ~ 2472MHz		dB	15	18	-
2620 ~ 2690MHz		dB	25	29	-
5000 ~ 5140MHz		dB	15	29	-
7500 ~ 7710MHz		dB	5	17	-

(\*1) Specification of insertion loss includes loss that comes from the test board. (Value: 0.15dB).

**SAW Filter 2535.0MHz**  
**Part No: MP07846**

**Model: TA1886A**  
**Rev No: 1**

**C. FREQUENCY CHARACTERISTIC:**

1. Pass-band

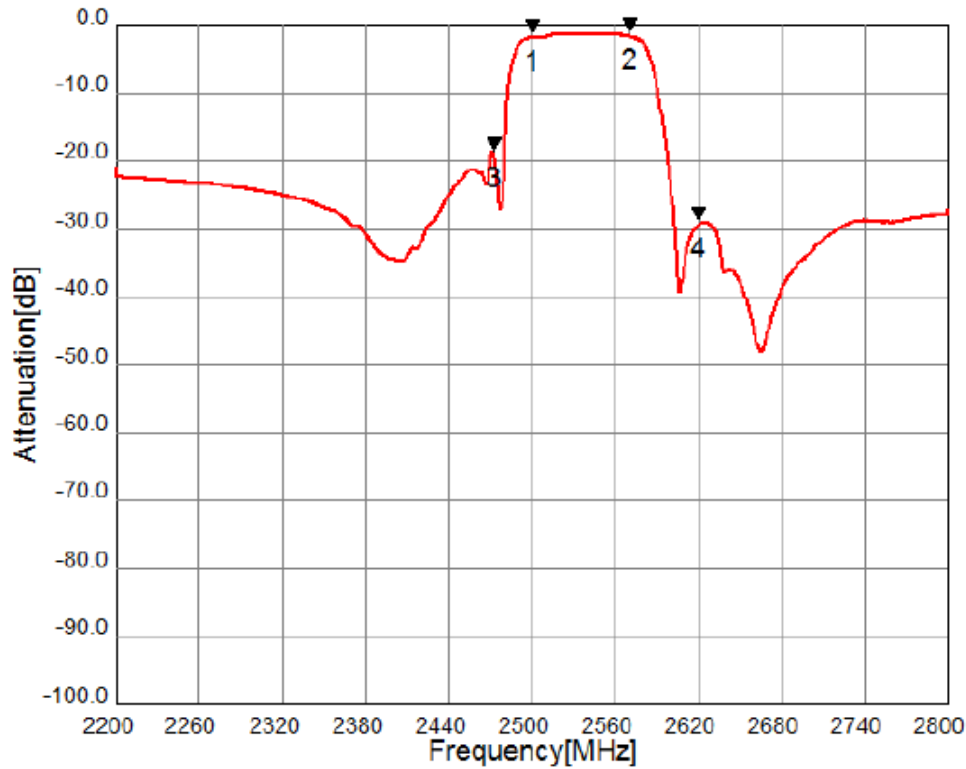

Mk1: 2500.0MHz  
S21=-1.709dB  
Mk2: 2570.0MHz  
S21=-1.615dB  
Mk3: 2472.0MHz  
S21=-19.062dB  
Mk4: 2620.0MHz  
S21=-29.418dB

2. In-band

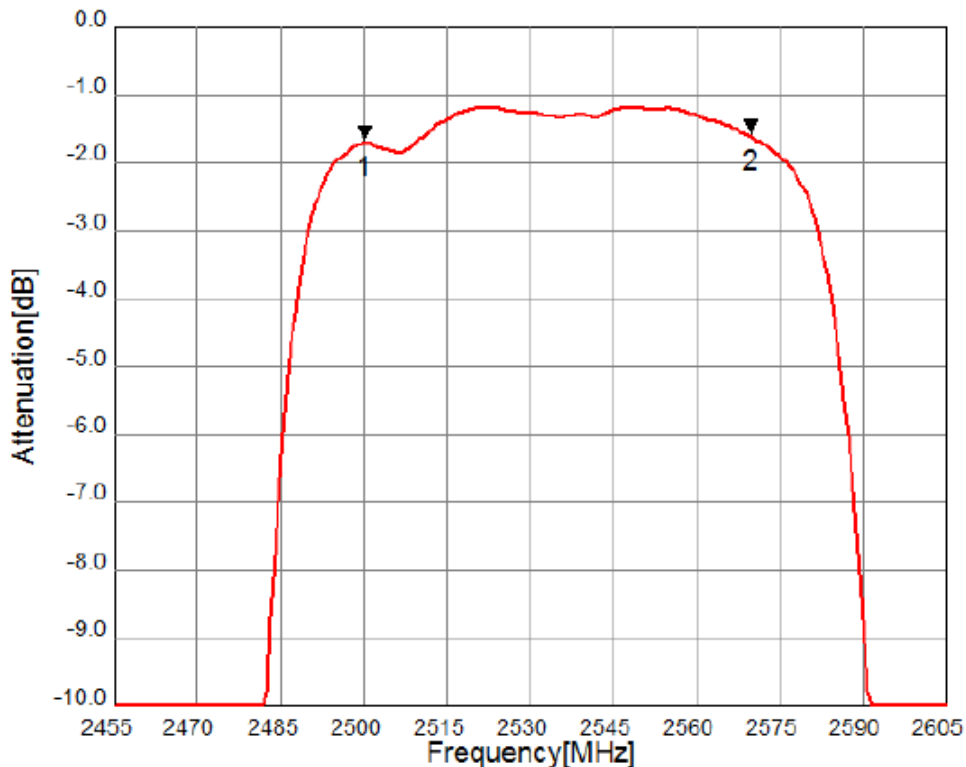

Mk1: 2500.0MHz  
S21=-1.709dB  
Mk2: 2570.0MHz  
S21=-1.615dB

**SAW Filter 2535.0MHz**  
**Part No: MP07846**

**Model: TA1886A**  
**Rev No: 1**

3. Wide-band

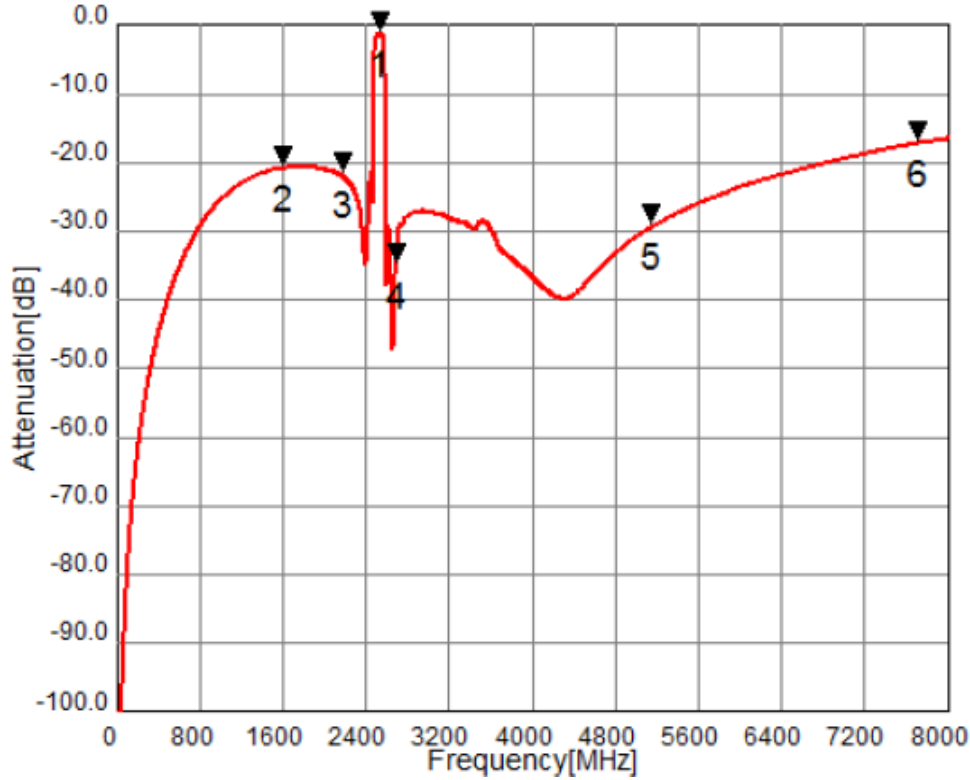

4. VSWR

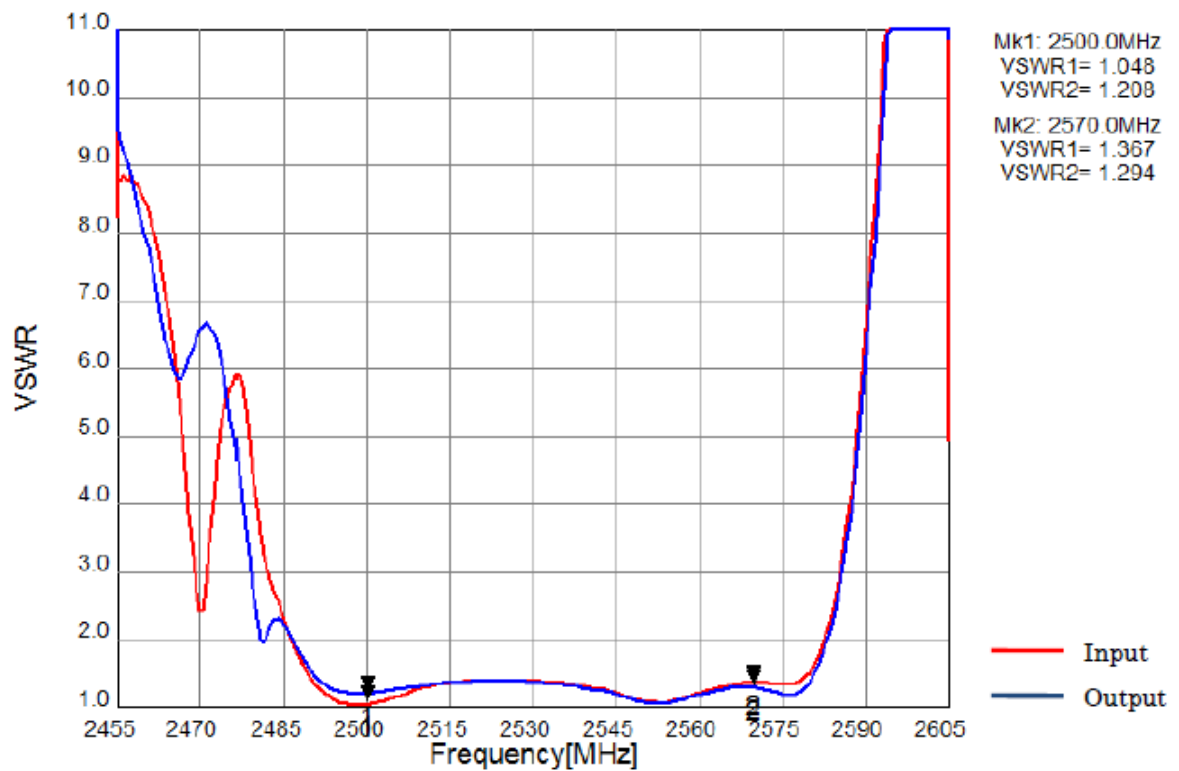

**SAW Filter 2535.0MHz**  
**Part No: MP07846**

**Model: TA1886A**  
**Rev No: 1**

### 5. Input Impedance

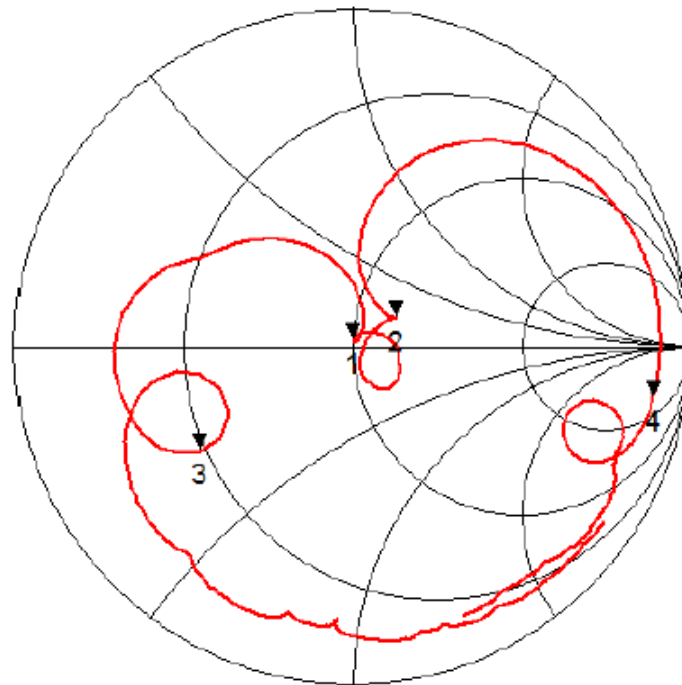

Mk1: 2500.0  
S11= 1.008 + j0.045  
Mk2: 2570.0  
S11= 1.269 + j0.229  
Mk3: 2472.0  
S11= 0.317 - j0.279  
Mk4: 2620.0  
S11= 5.096 - j8.520

### 6. Output Impedance

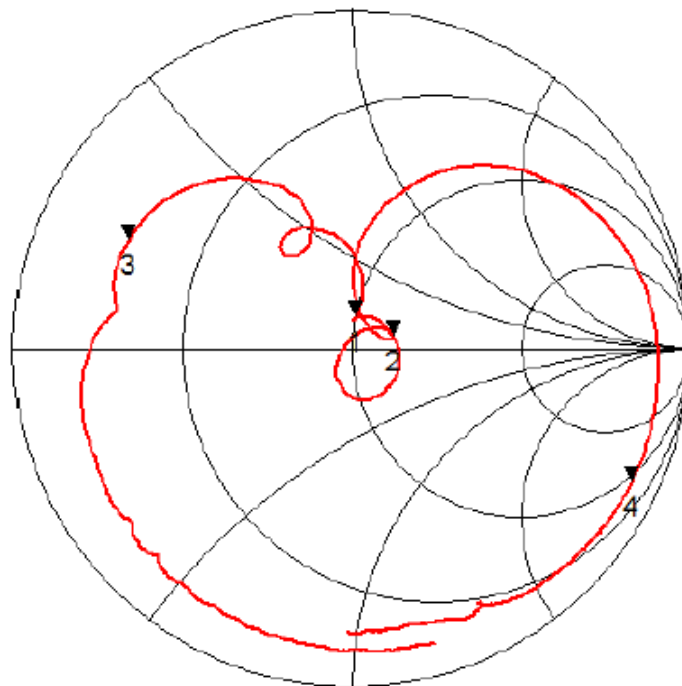

Mk1: 2500.0  
S22= 1.006 + j0.189  
Mk2: 2570.0  
S22= 1.277 + j0.097  
Mk3: 2472.0  
S22= 0.159 + j0.223  
Mk4: 2620.0  
S22= 0.853 - j4.220

**SAW Filter 2535.0MHz**  
**Part No: MP07846**

**Model: TA1886A**  
**Rev No: 1**

**D. MEASUREMENT CIRCUIT:**

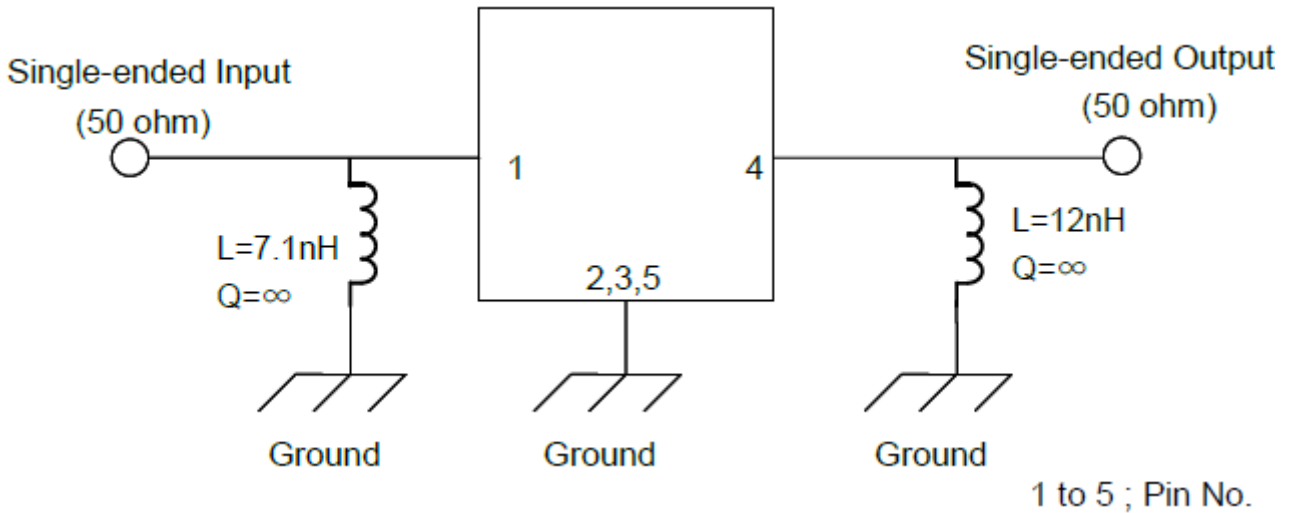

**E. OUTLINE DRAWING:**

Device size: 1.1mm typ. x 0.9mm typ. x 0.5mm max.

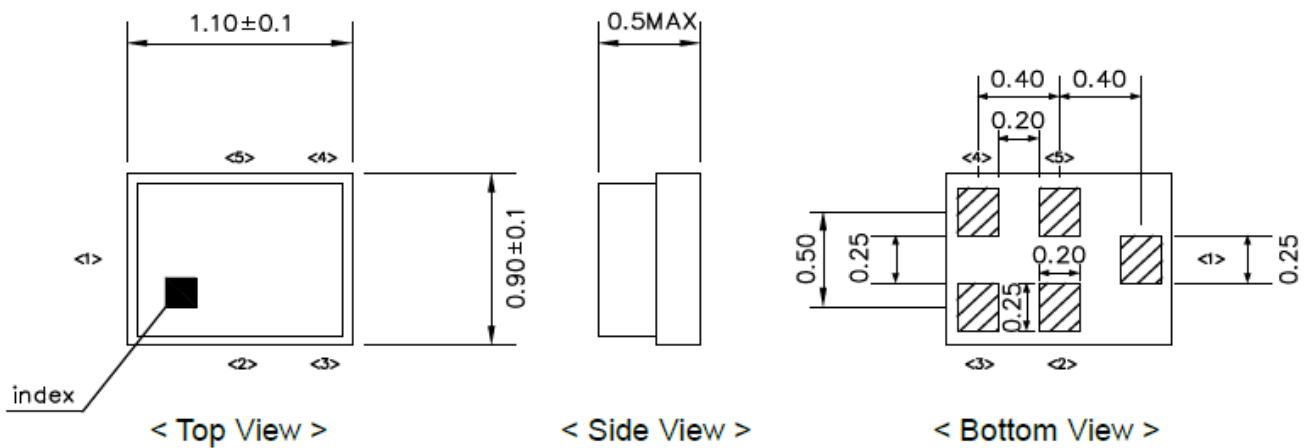

Unit : mm

**Pin Configuration**

Pin No.	Symbol	Function
1	IN	Single-ended pin
2	GND	Ground
3	GND	Ground
4	OUT	Single-ended pin
5	GND	Ground

**SAW Filter 2535.0MHz**  
**Part No: MP07846**

**Model: TA1886A**  
**Rev No: 1**

**F. PACKING:**

1. Reel Dimension

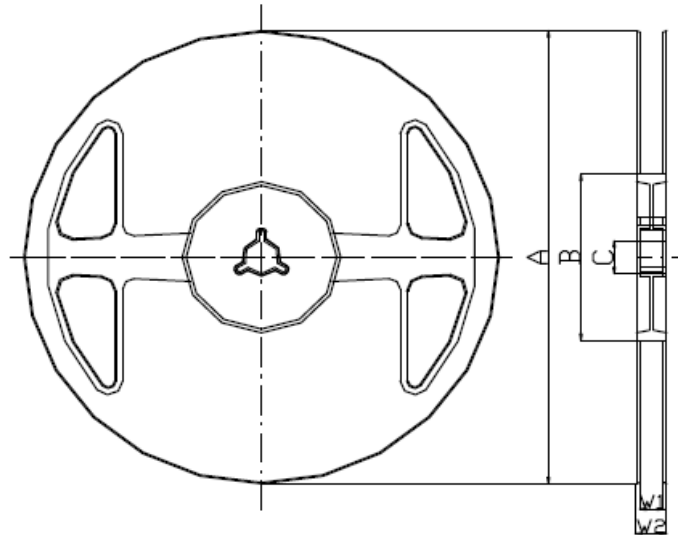

**Materials of Reel**

Material : Polystyrene + Carbon

Color : Black

Surface resistance (reference value) :  $10^9 \Omega/\text{sq}$  Max.

Unit : mm

Code	Quantity	A	B	C	W1	W2
J	5,000 pcs	$\phi 180.0 +0.0/-1.5$	$\phi 66.0 +/-0.5$	$\phi 13.0 +/-0.2$	$9.0 +1.0/-0.0$	$11.4 +/-1.0$

2. Tape Dimension

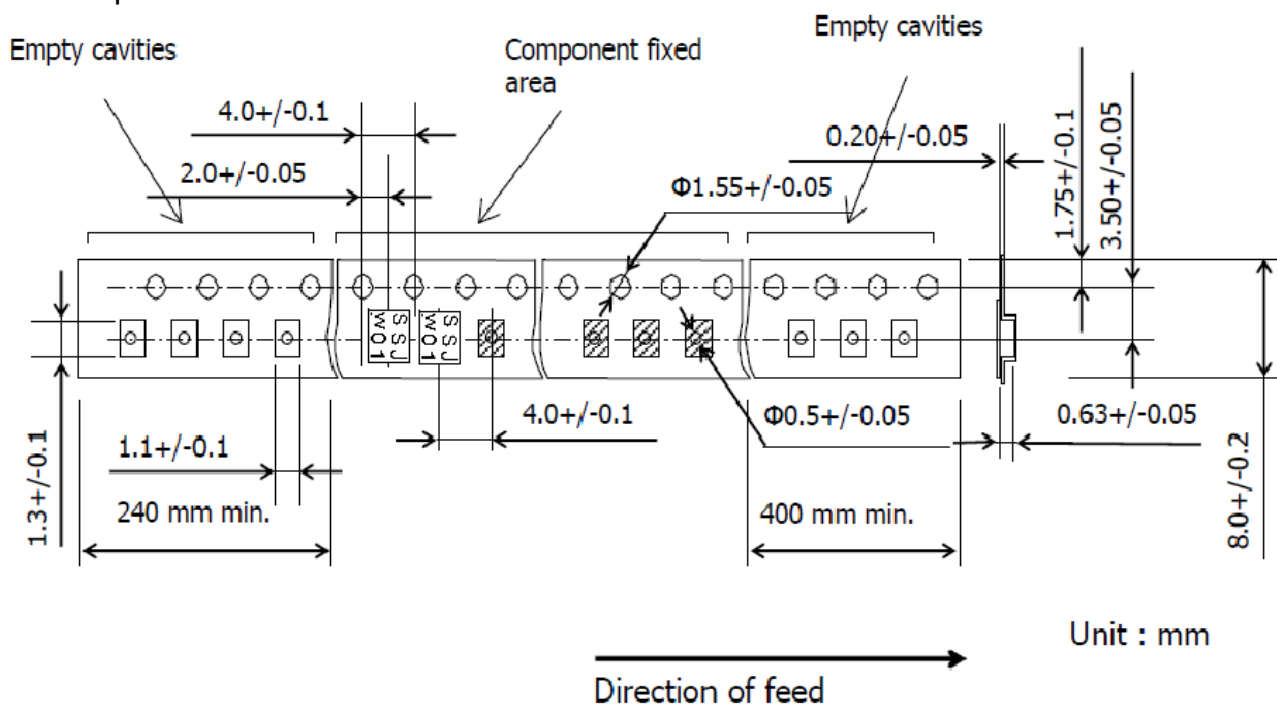

**SAW Filter 2535.0MHz**  
**Part No: MP07846**

**Model: TA1886A**  
**Rev No: 1**

**G. RECOMMENDED REFLOW PROFILE:**

