

SAW Filter 1955.0MHz

Model: TA1755A

Part No: MP08099

Rev No: 1

A. MAXIMUM RATING:

Electrostatic Sensitive Device (ESD)

1. Input Power Level: 15dBm
2. DC Voltage: 3V
3. Operating Temperature: -40°C to +85°C
4. Storage Temperature: -40°C to +85°C

B. ELECTRICAL CHARACTERISTICS:

Item	Unit	Min.	Typ.	Max.	Note
Center Frequency Fc	MHz	-	1955	-	-
Max. Insertion Loss (1940 ~ 1970MHz) IL	dB	-	1.7	4.0	-
Amplitude Ripple (1940 ~ 1970MHz)	dB	-	1.0	3.0	-
VSWR (1940 ~ 1970MHz)			1.6	2.4	
Source Impedance (single ended)	Ω	-	50	-	-
Load Impedance (single ended)	Ω	-	50	-	-
Attenuation					
1805 ~ 1880MHz	dB	20	34	-	-
2100 ~ 2170MHz	dB	20	50	-	-
Package size	mm	SMD 3.0x3.0			

SAW Filter 1955.0MHz
Part No: MP08099

Model: TA1755A
Rev No: 1

C. OUTLINE DRAWING:

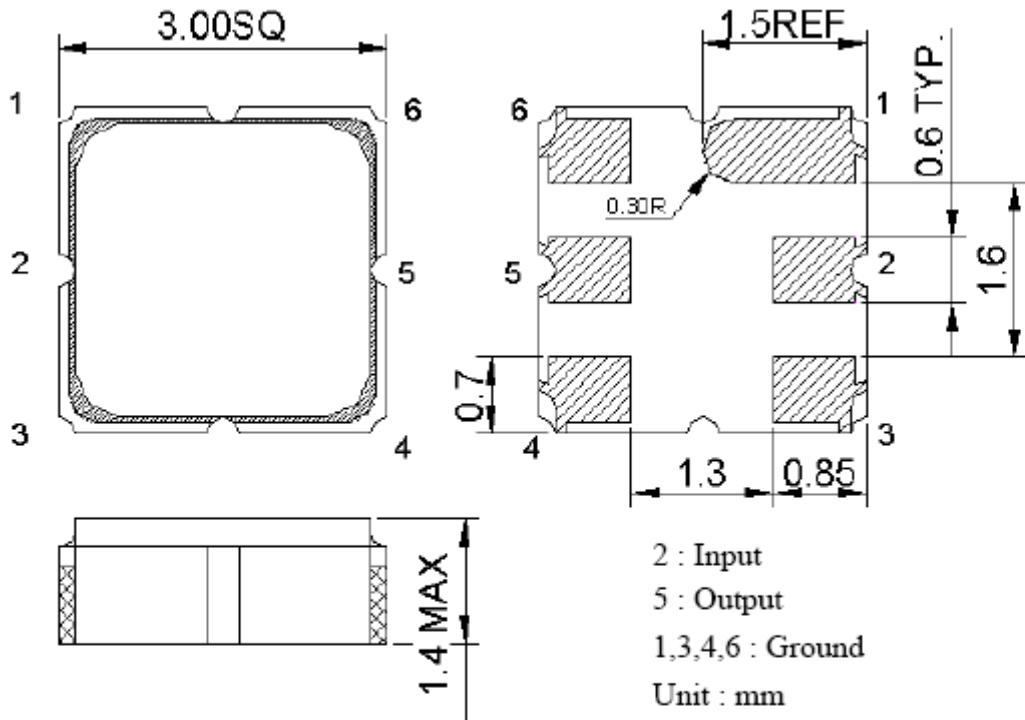

D. MEASUREMENT CIRCUIT

HP Network analyzer

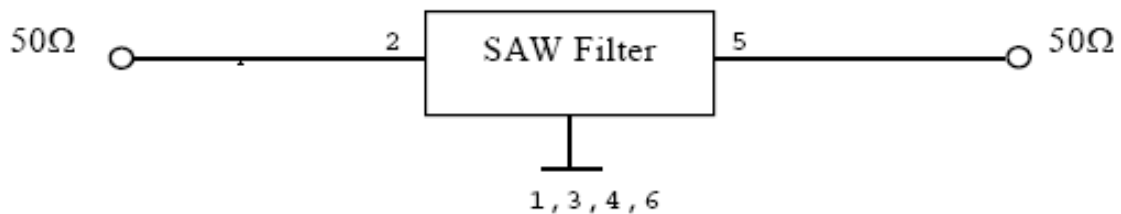

SAW Filter 1955.0MHz
Part No: MP08099

Model: TA1755A
Rev No: 1

E. FREQUENCY CHARACTERISTICS:

1. S21 response: (span 500MHz)

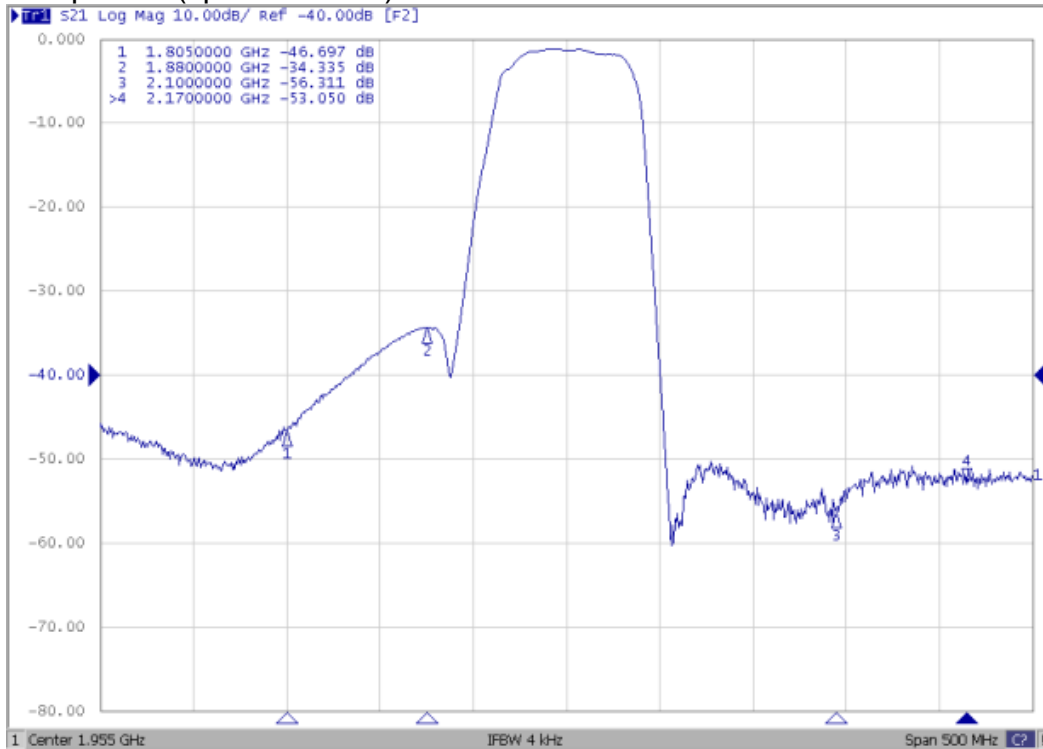

2. S21 response: (span 100MHz)

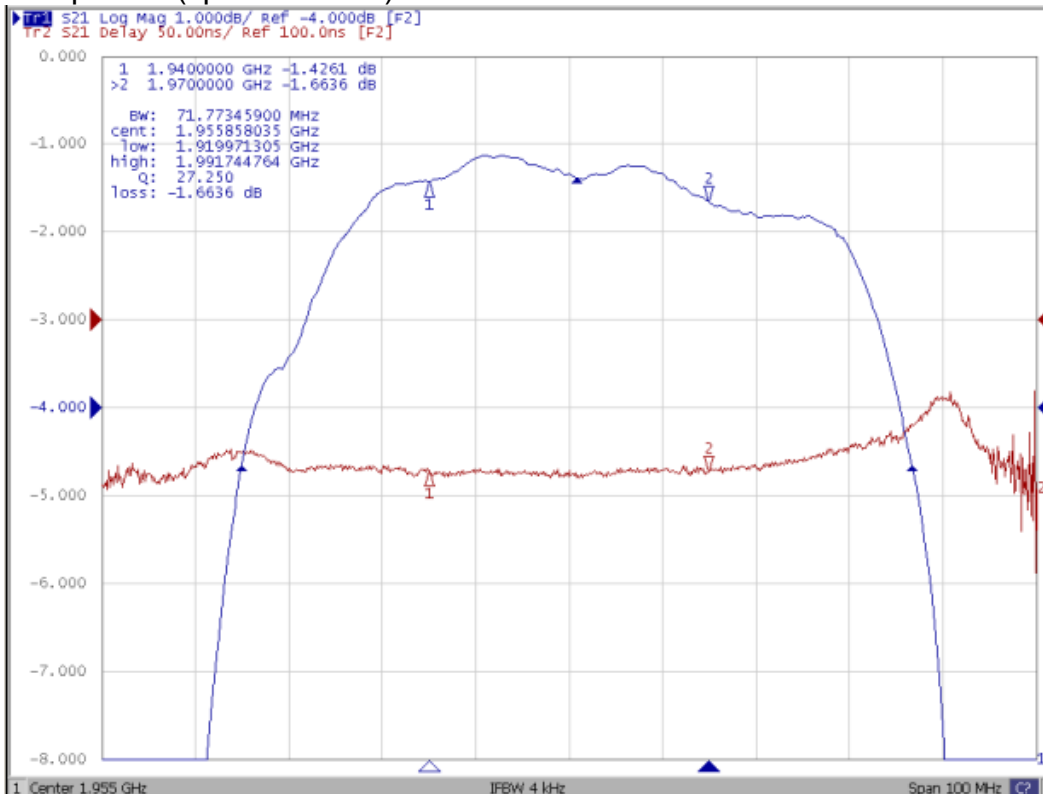

SAW Filter 1955.0MHz
Part No: MP08099

Model: TA1755A
Rev No: 1

3. S11&S22 VSWR: (span 100MHz)

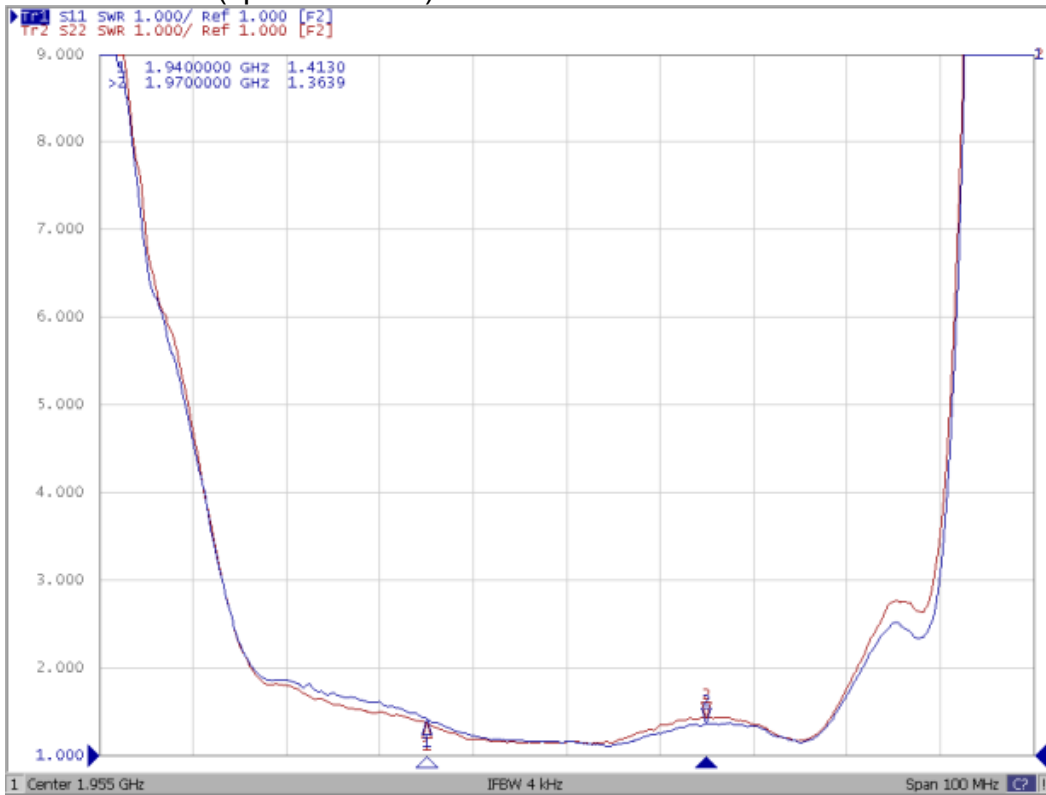

4. S11&S22 Smith Chart: (span 200MHz)

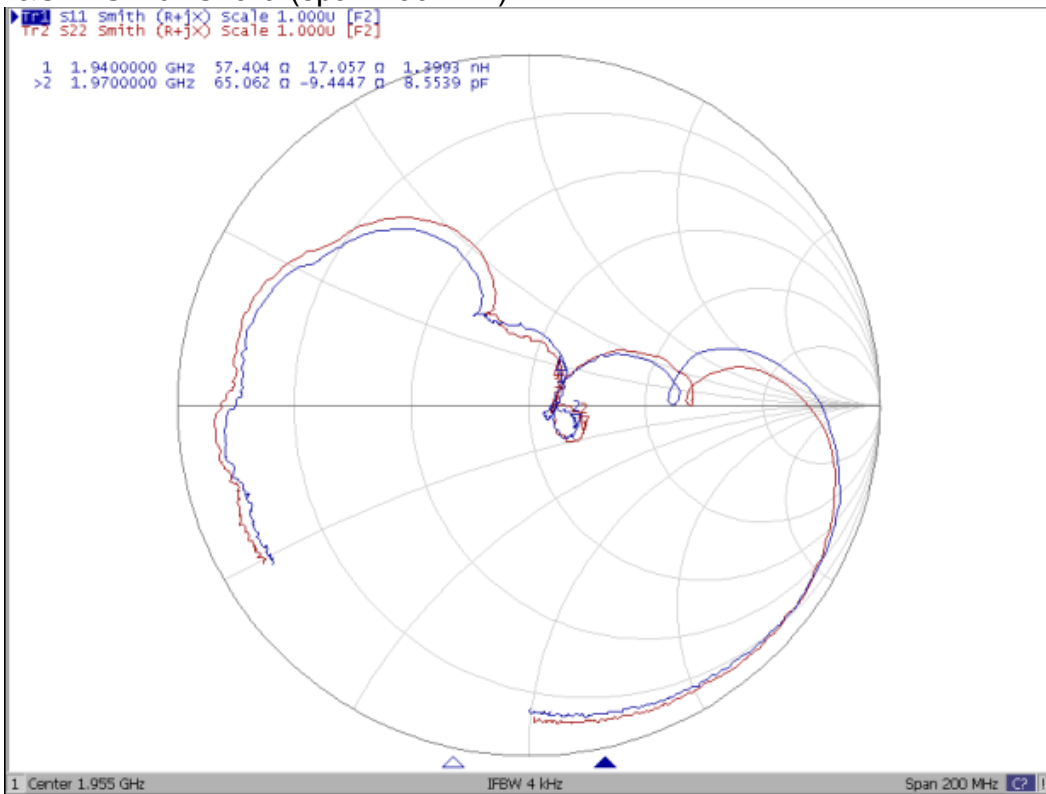

SAW Filter 1955.0MHz
Part No: MP08099

Model: TA1755A
Rev No: 1

G. PCB FOOTPRINT:

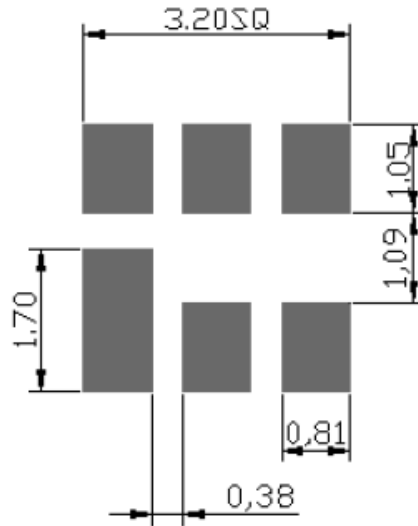

H. RECOMMENDED REFLOW PROFILE:

