

SAW Filter 2332.50MHz AEC-Q200 compliant
Part No: MP09090

Model No: TA2393A
Rev No: 1

A. MAXIMUM RATING:

Electrostatic Sensitive Device (ESD)

1. Input Power Level: 10dBm
2. DC Voltage: 3V
3. Operating Temperature: -40°C to +105°C
4. Storage Temperature: -40°C to +125°C
5. ESD Machine Mode: 50V
6. ESD Human Body Mode: 100V
7. Moisture Sensitive Level (MSL): Level 2a

B. ELECTRICAL CHARACTERISTICS:

1. Temperature range for specification: $T_{spec} = -40^{\circ}\text{C}$ to $+105^{\circ}\text{C}$
2. Terminating source impedance: $Z_S = 50\Omega$
3. Terminating load impedance: $Z_L = 50\Omega$

Item	Unit	Min.	Typ.	Max.
Center Frequency F_c	MHz	-	2332.5	-
Max. Insertion Loss (2320 ~ 2345MHz) IL	dB		0.35	0.61)
Max. Insertion Loss (2320 ~ 2345MHz) IL	dB	-	0.35	0.63
Amplitude Ripple (2320 ~ 2345MHz)	dB p-p	-	0.08	0.35
VSWR (2320 ~ 2345MHz)		-	1.15	1.5
Attenuation (refer to 0dB)				
698 ~ 894MHz	dB	7	10	-
1710 ~ 1750MHz	dB	5	8	-
1850 ~ 1990MHz	dB	5	8	-
2400 ~ 2484MHz	dB	7	10.5	-
2496 ~ 2690MHz	dB	6	9.5	-
3400 ~ 3500MHz	dB	9	10	-
Temperature Coefficient	ppm/K	-	-36	-

At room temperature 25°C only

SAW Filter 2332.50MHz AEC-Q200 compliant
Part No: MP09090

Model No: TA2393A
Rev No: 1

C. OUTLINE DRAWING:

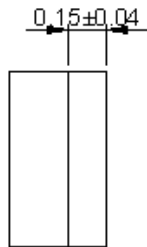
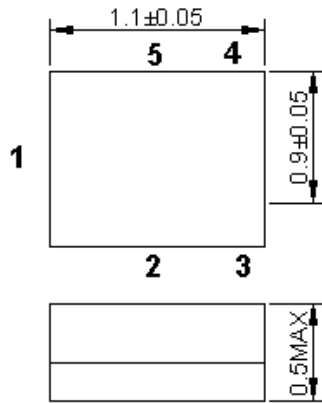

All tolerances are +/-0.05 mm unless otherwise specified
 Coplanarity : 0.1 mm max.
 1 to 5 : Pin No.
 Unit : mm

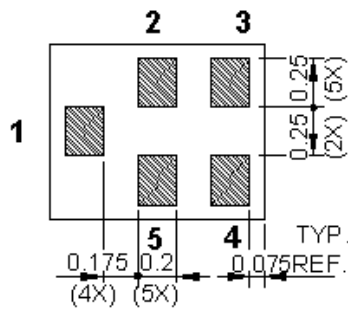

1: Input
 4: Output
 2, 3, 5: Ground

D. MEASUREMENT CIRCUIT:

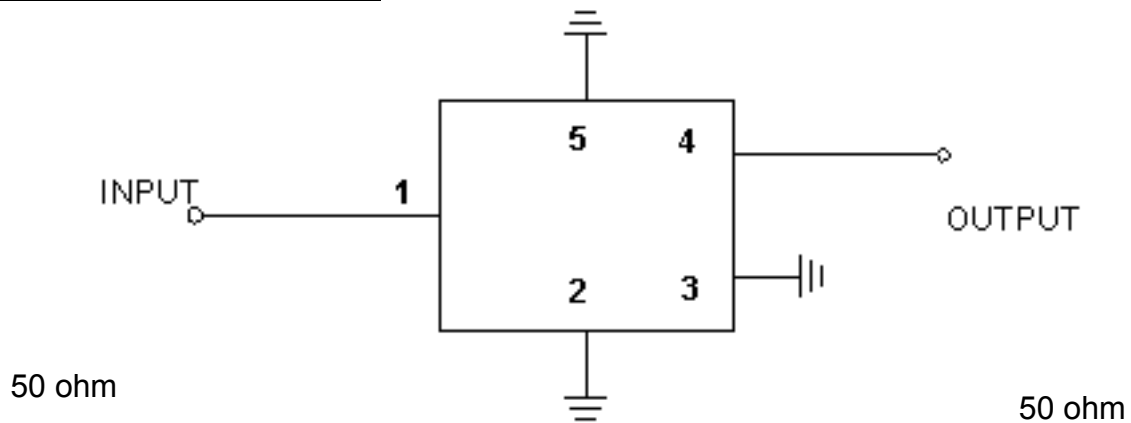

E. PCB FOOTPRINT:

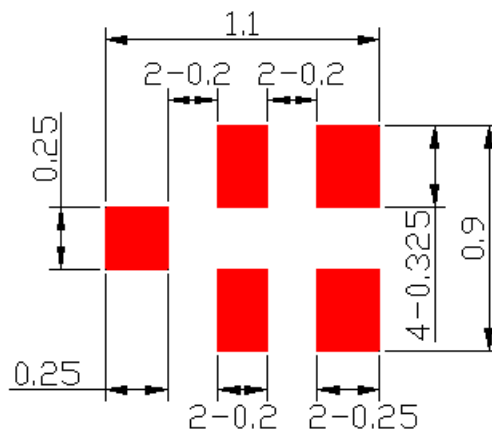

SAW Filter 2332.50MHz AEC-Q200 compliant
Part No: MP09090

Model No: TA2393A
Rev No: 1

F. FREQUENCY CHARACTERISTICS:

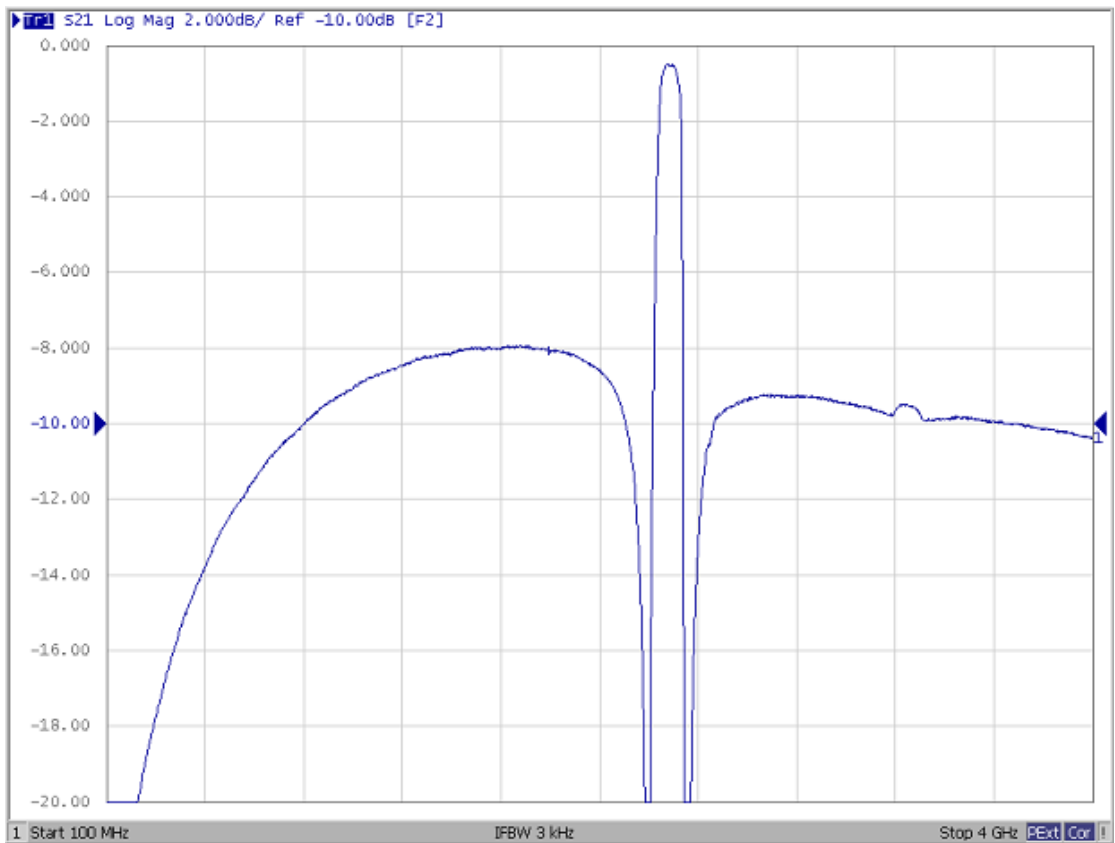
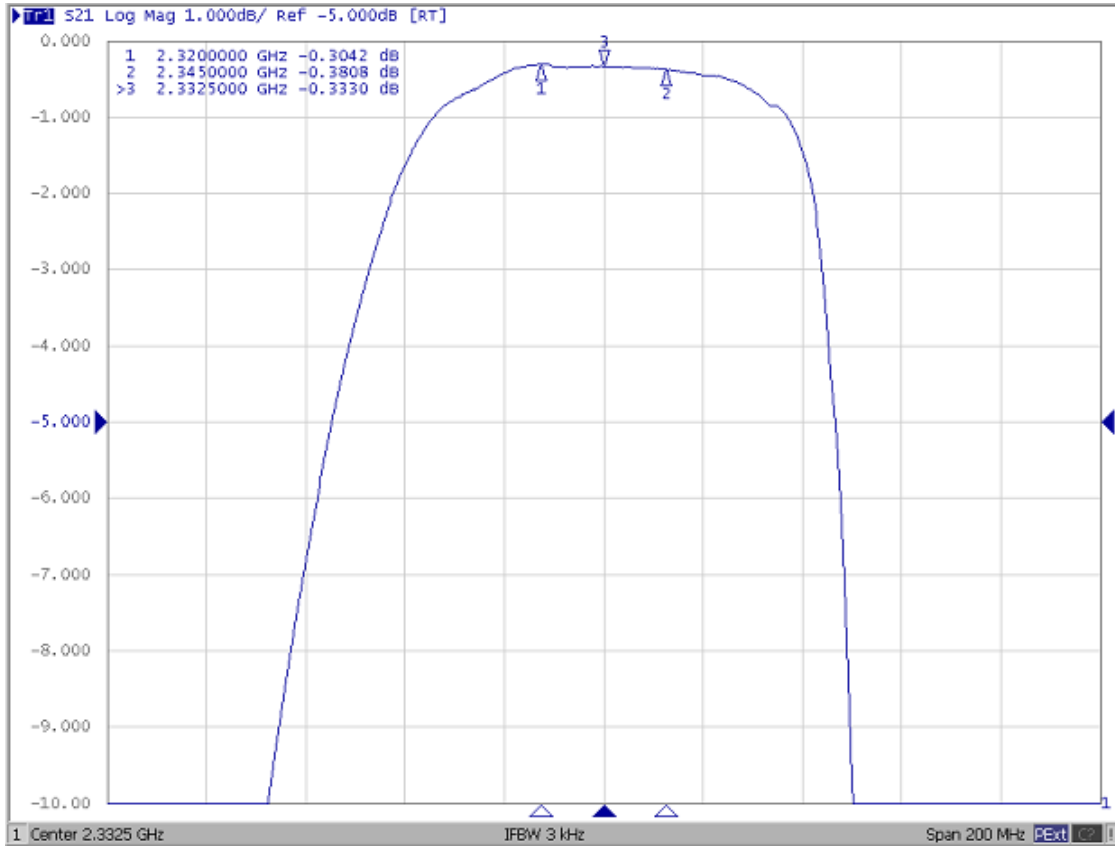

SAW Filter 2332.50MHz AEC-Q200 compliant
Part No: MP09090

Model No: TA2393A
Rev No: 1

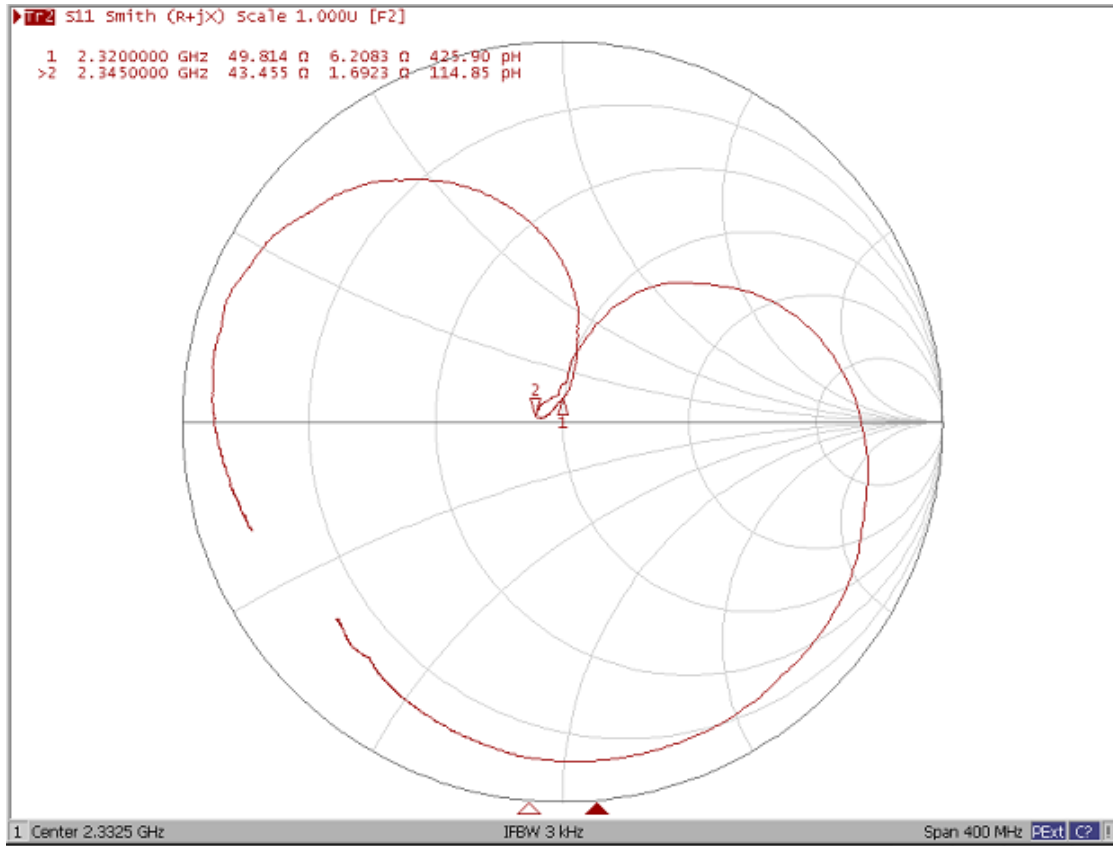

SAW Filter 2332.50MHz AEC-Q200 compliant
Part No: MP09090

Model No: TA2393A
Rev No: 1

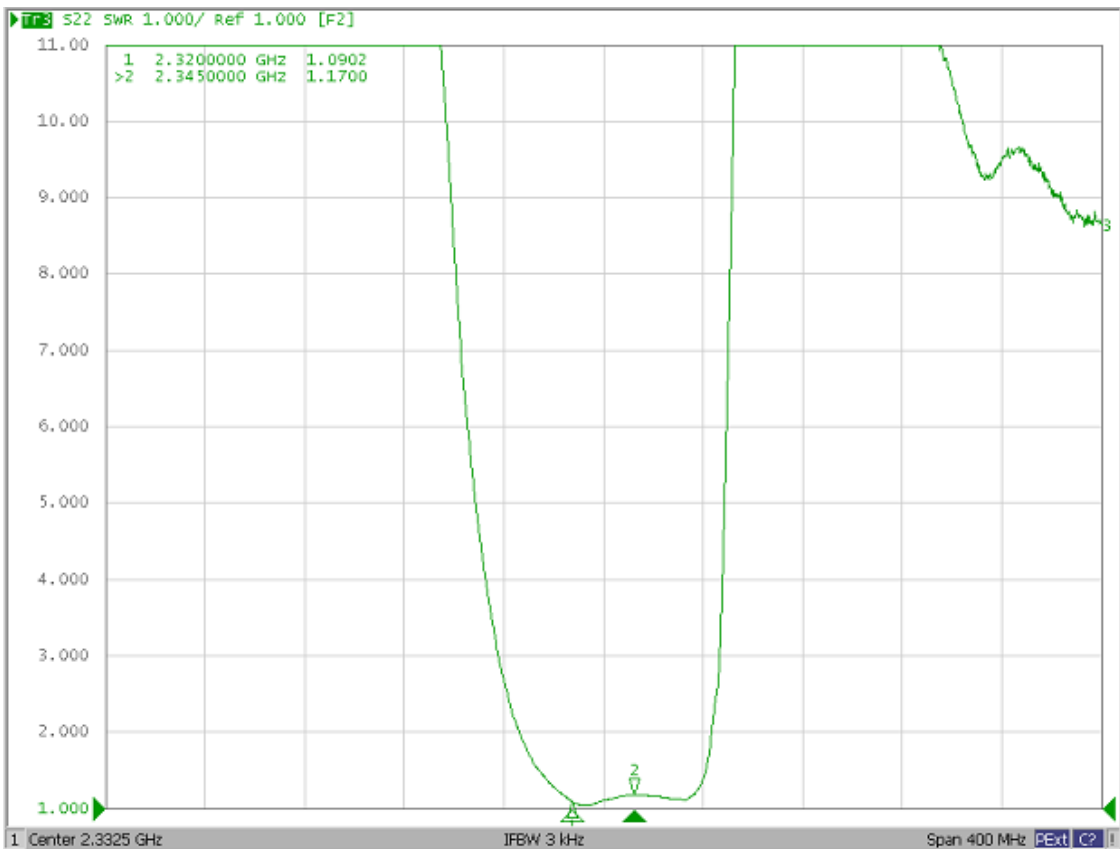
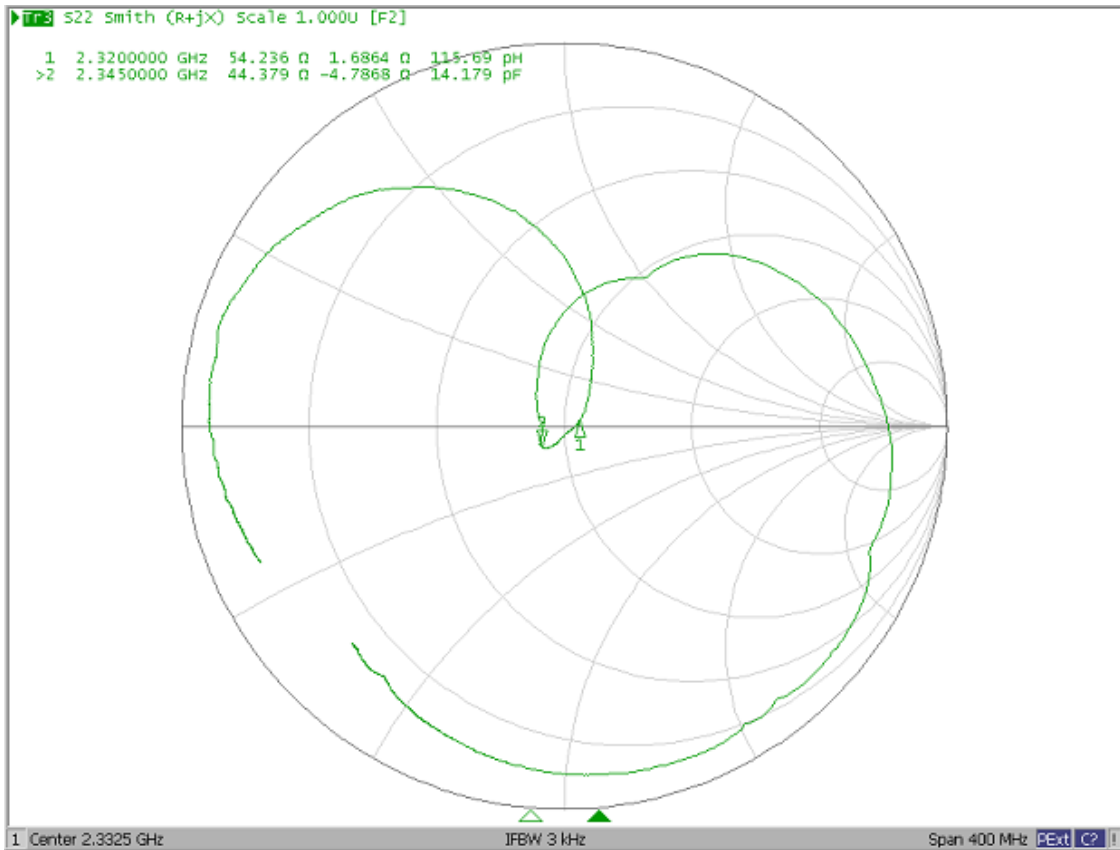

SAW Filter 2332.50MHz AEC-Q200 compliant
Part No: MP09090

Model No: TA2393A
Rev No: 1

G. PACKING:

1. Reel Dimension

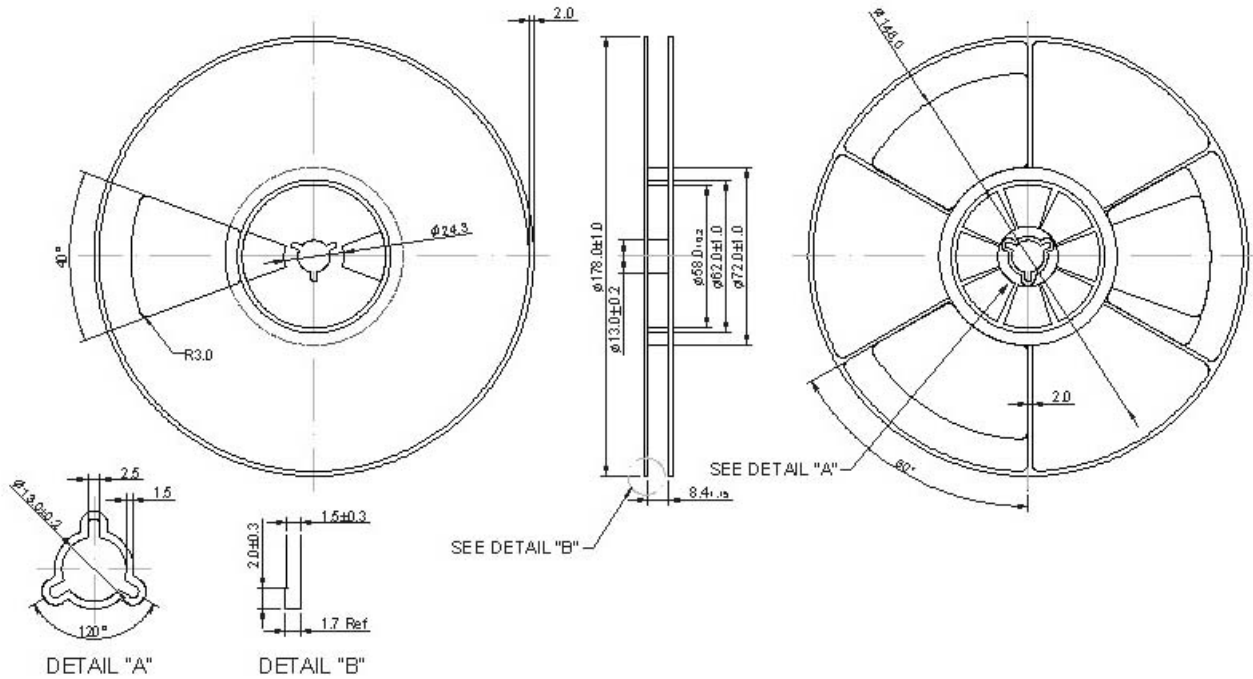

2. Tape Dimension

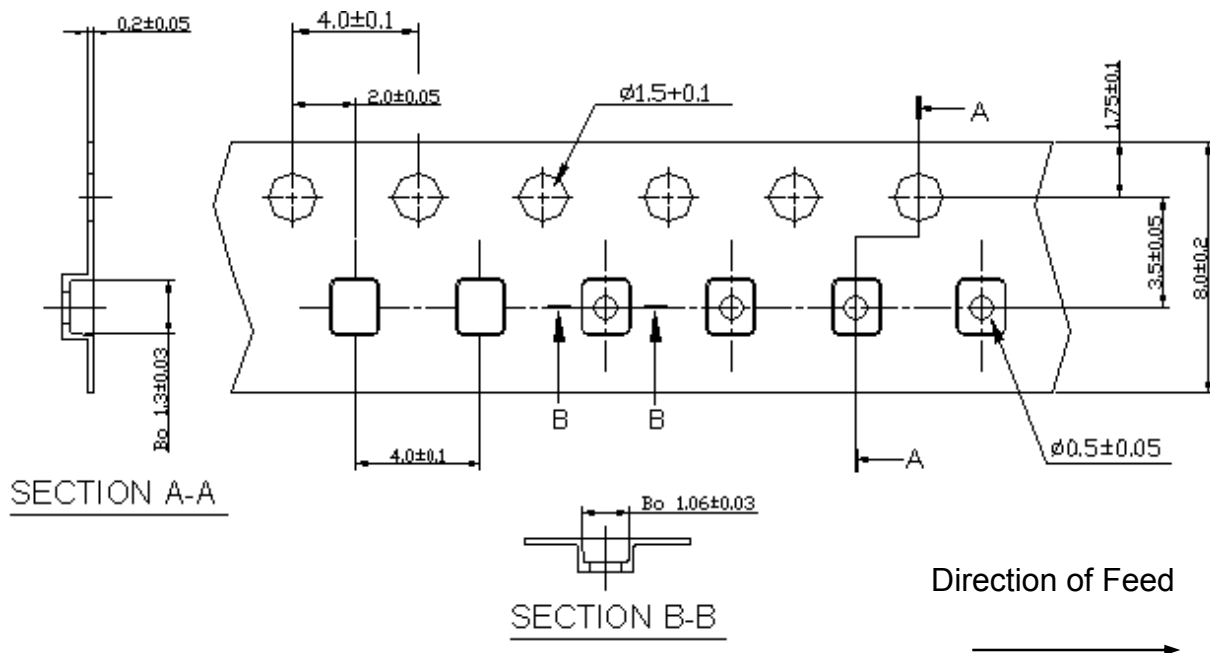

SAW Filter 2332.50MHz AEC-Q200 compliant
Part No: MP09090

Model No: TA2393A
Rev No: 1

H. RECOMMENDED REFLOW PROFILE:

1. Preheating shall be fixed at 150 ~ 180°C for 60 ~ 90 seconds.
2. Ascending time to preheating temperature 150°C shall be 30 seconds min.
3. Heating shall be fixed at 220°C for 50 ~ 80 seconds and at 245 ~ 260°C peak (min. 10 sec).
4. Time: 2 times.

