

SAW Filter 925.40MHz
Part No: MP09806

Model: TA2044A
Rev No: 1

A. MAXIMUM RATING:

Electrostatic Sensitive Device

1. Input Power Level: 13dBm
2. DC voltage: 6V
3. Operating Temperature: -30°C to +70°C
4. Storage Temperature: -40°C to +85°C

B. ELECTRICAL CHARACTERISTICS:

Item	Unit	Min.	Typ.	Max.
Center Frequency	MHz	-	925.4	-
Insertion loss (923.3 ~ 927.5MHz)	dB	-	3.2	5.0
Amplitude ripple (923.3 ~ 927.5MHz)	dB	-	0.6	1.2
VSWR (923.3 ~ 927.5MHz)	dB	-	1.4	2.2
Attenuation (Reference level from 0dB)				
10 ~ 791MHz	dB	45	55	-
791 ~ 875MHz	dB	40	50	-
857 ~ 915MHz	dB	30	40	-
935 ~ 943MHz	dB	35	38	-
943 ~ 1000MHz	dB	45	55	-
1000 ~ 2000MHz	dB	30	40	-
Temperature Coefficient of Frequency	ppm/k	-	-36	-

C. MEASUREMENT CIRCUIT:

HP Network analyzer

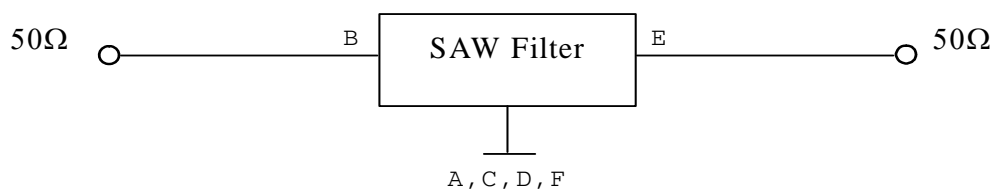

SAW Filter 925.40MHz
Part No: MP09806

Model: TA2044A
Rev No: 1

D. OUTLINE DRAWING:

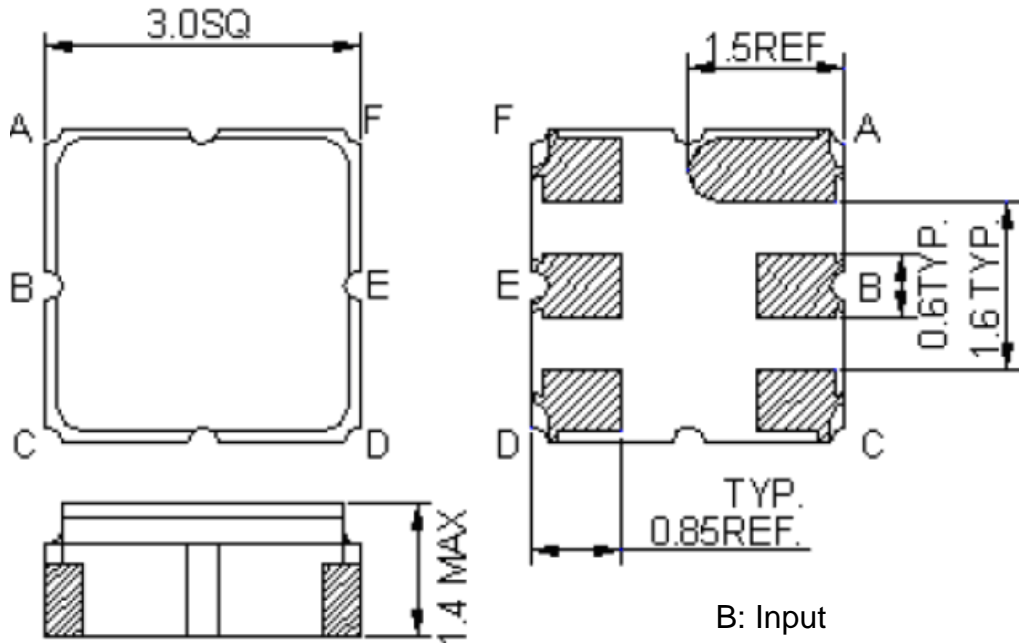

B: Input
E: Output
A, C, D, F: Ground
Unit: mm

E. PCB FOOTPRINT:

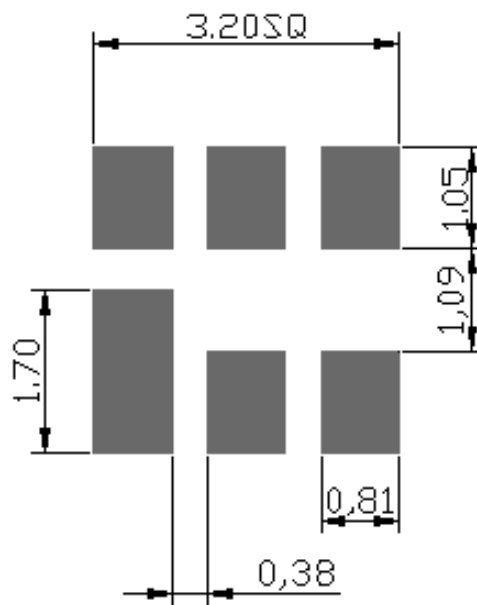

SAW Filter 925.40MHz
Part No: MP09806

Model: TA2044A
Rev No: 1

F. FREQUENCY CHARACTERISTICS:

1. Span 50MHz

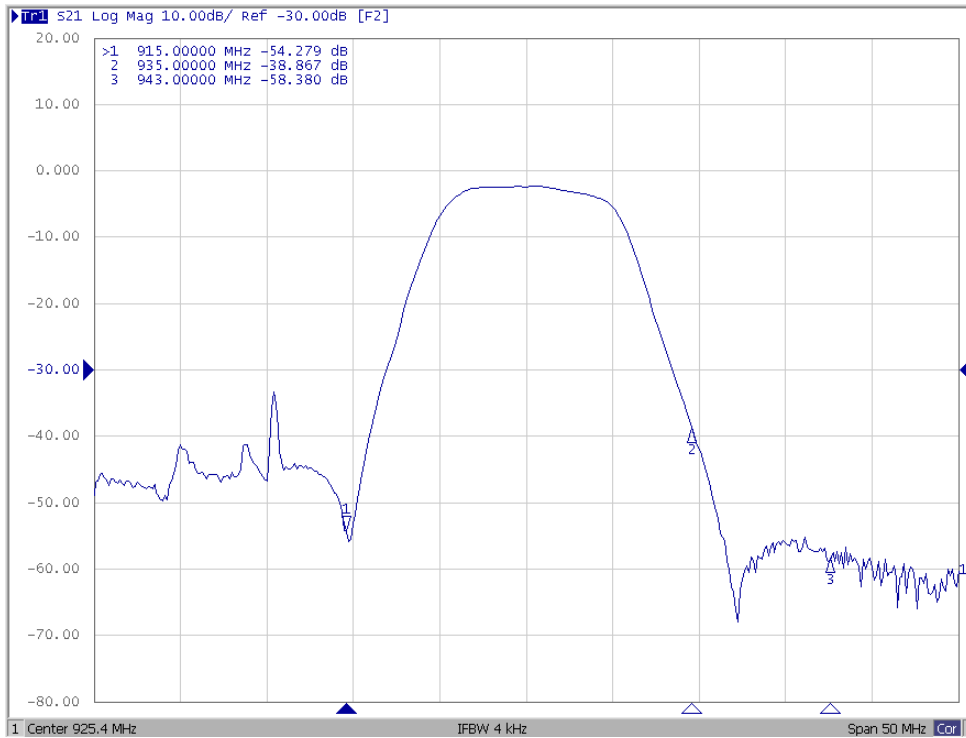

2. Span 2000MHz

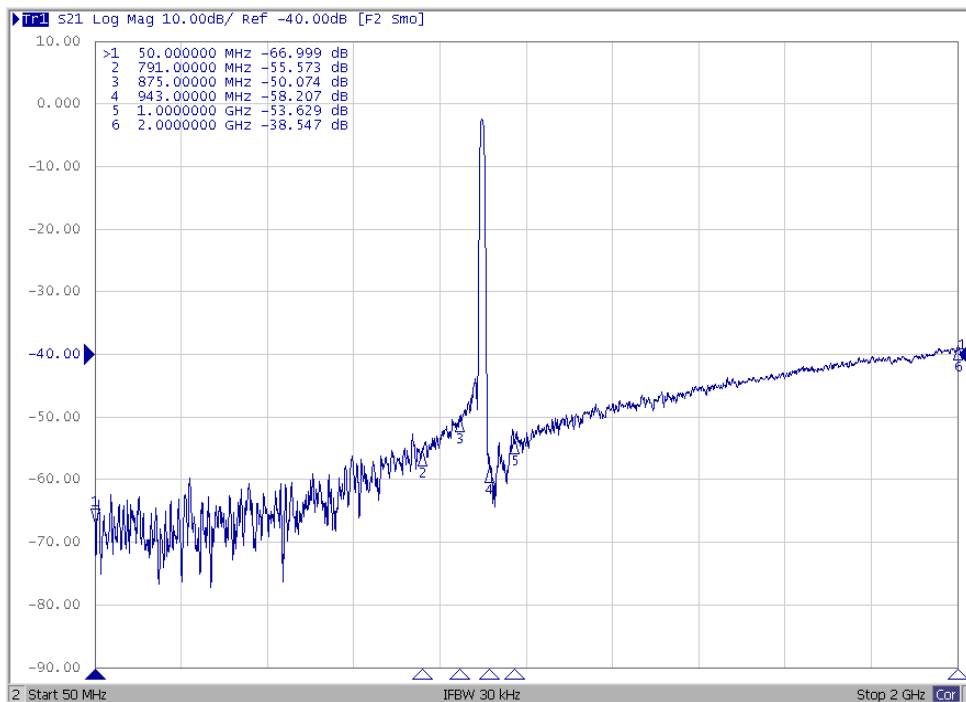

SAW Filter 925.40MHz
Part No: MP09806

Model: TA2044A
Rev No: 1

3. Span 10MHz

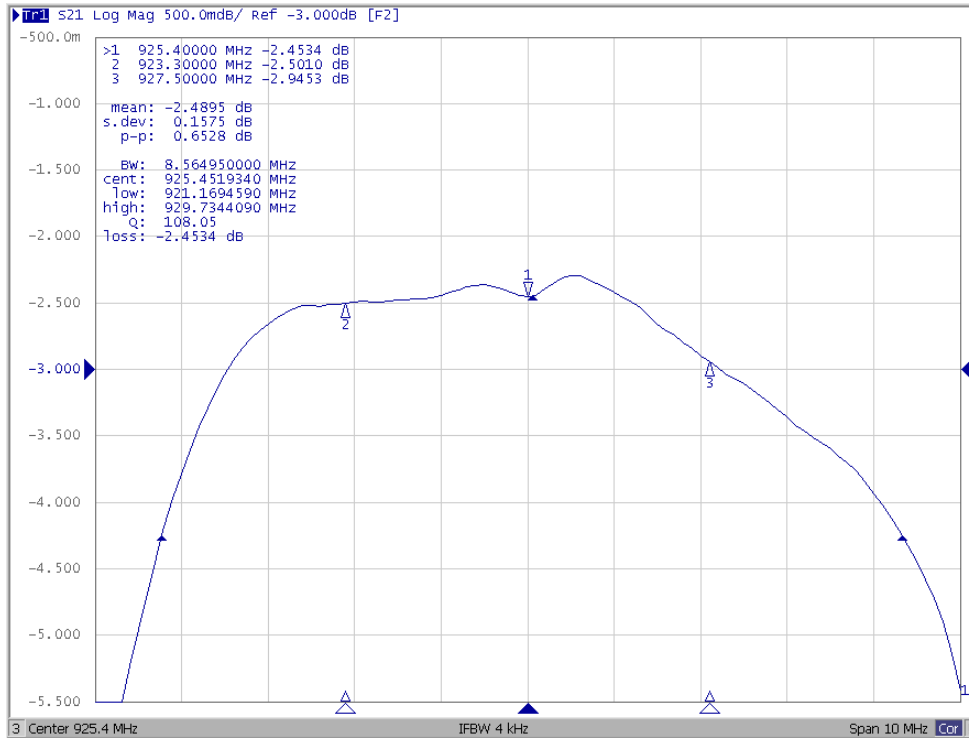

4. VWSR (Span 10)

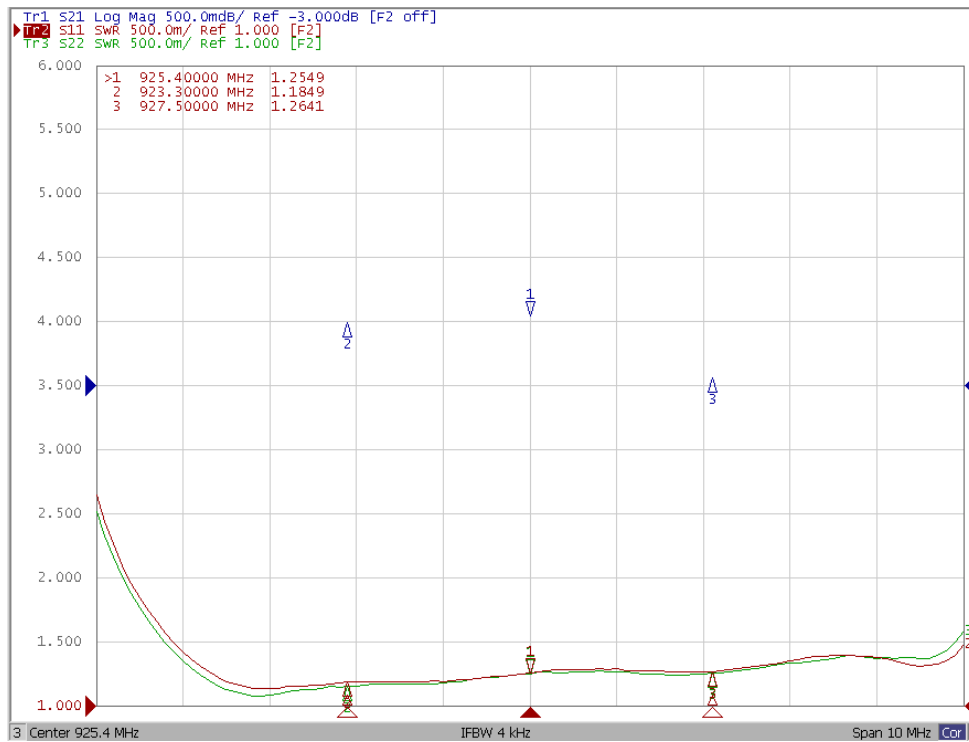

SAW Filter 925.40MHz
Part No: MP09806

Model: TA2044A
Rev No: 1

G. PACKING:

1. Reel Dimension

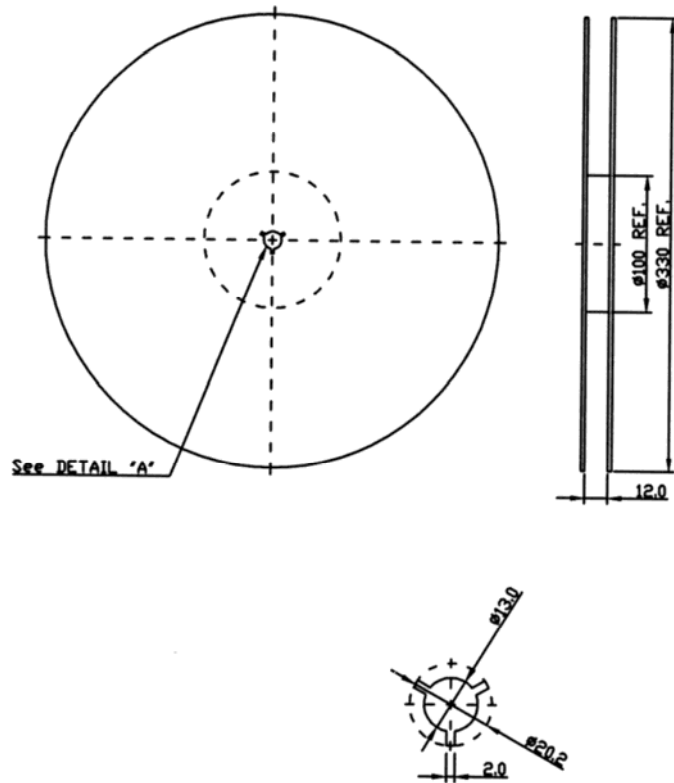

2. Tape Dimension

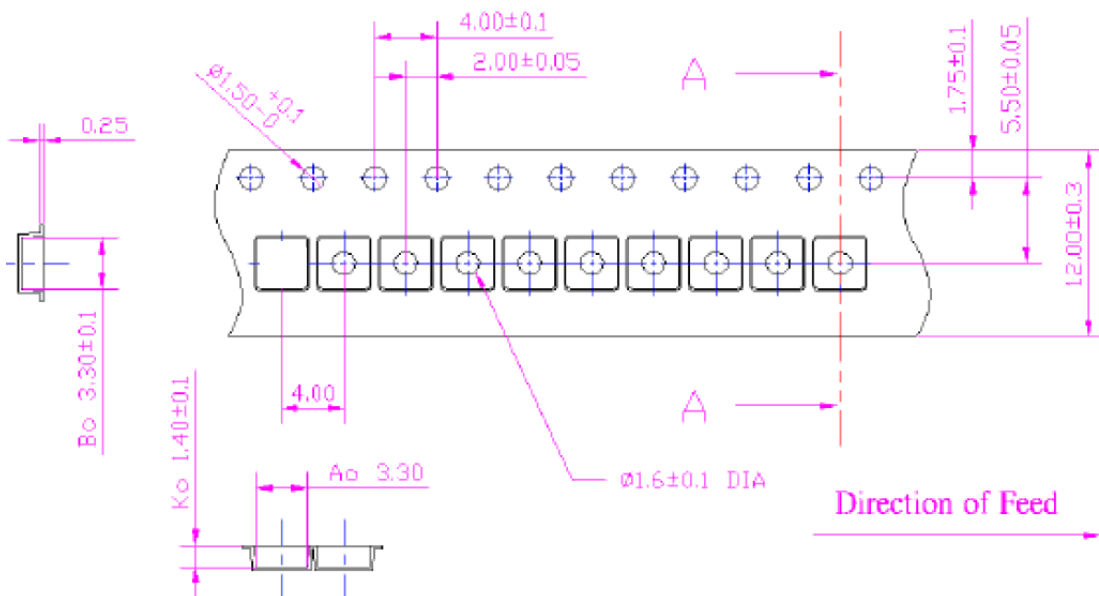

SAW Filter 925.40MHz
Part No: MP09806

Model: TA2044A
Rev No: 1

H. RECOMMENDED REFLOW PROFILE:

1. Preheating shall be fixed at 150 ~ 180°C for 60 ~ 90 seconds.
2. Ascending time to preheating temperature 150°C shall be 30 seconds min.
3. Heating shall be fixed at 220°C for 50 ~ 80 seconds and at 260°C +0/-5°C peak (20 ~ 40 sec).
4. Time: 2 times.

