

SAW Filter 1542.50MHz
Part No: MP10291

Model: TA1045C
Rev No: 1

A. MAXIMUM RATING:

Electrostatic Sensitive Device (ESD)

1. Input Power Level: 10dBm
2. DC Voltage: 3V
3. Operating Temperature: -40°C to +85°C
4. Storage Temperature: -40°C to +85°C
5. Moisture Sensitivity Level: Level 1 (MSL1)

B. ELECTRICAL CHARACTERISTICS:

1. Terminating source impedance (single ended): $Z_S = 50\Omega$
2. Terminating load impedance (single ended): $Z_L = 50\Omega$

Item	Unit	Min.	Typ.	Max.	Note
Center Frequency F_c	MHz	-	1542.5	-	-
Insertion Loss (1525 ~ 1560MHz)	dB	-	3	4.3	-
Amplitude ripple (1525 ~ 1560MHz)	dB	-	0.7	2.1	-
VSWR (1525 ~ 1560MHz)		-	1.5	2.2	-
Attenuation (reference level from 0dB)					
DC ~ 1480MHz	dB	21	49	-	-
1630 ~ 1660MHz	dB	26	44	-	-
1660 ~ 2050MHz	dB	30	45	-	-
2050 ~ 3500MHz	dB	25	44	-	-
Temperature Coefficient of Frequency	ppm/°C	-	-36	-	-

SAW Filter 1542.50MHz
Part No: MP10291

Model: TA1045C
Rev No: 1

F. FREQUENCY CHARACTERISTICS:

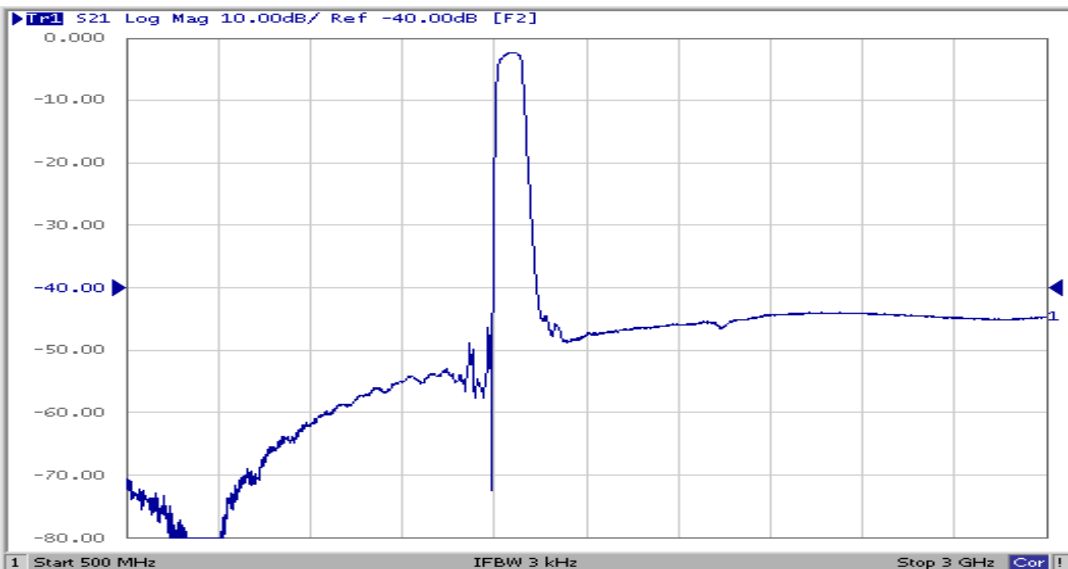
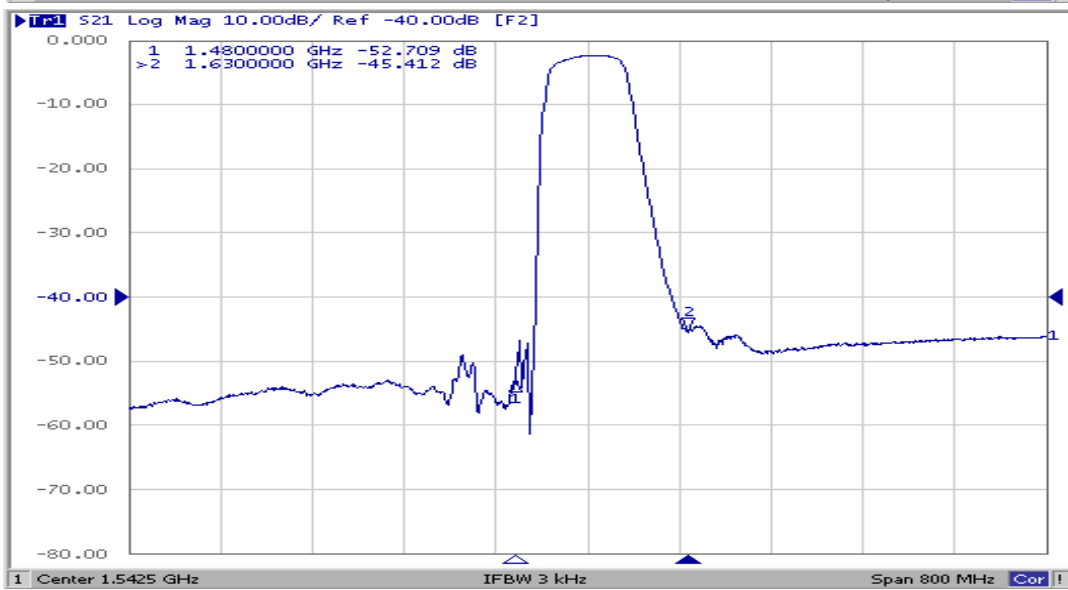
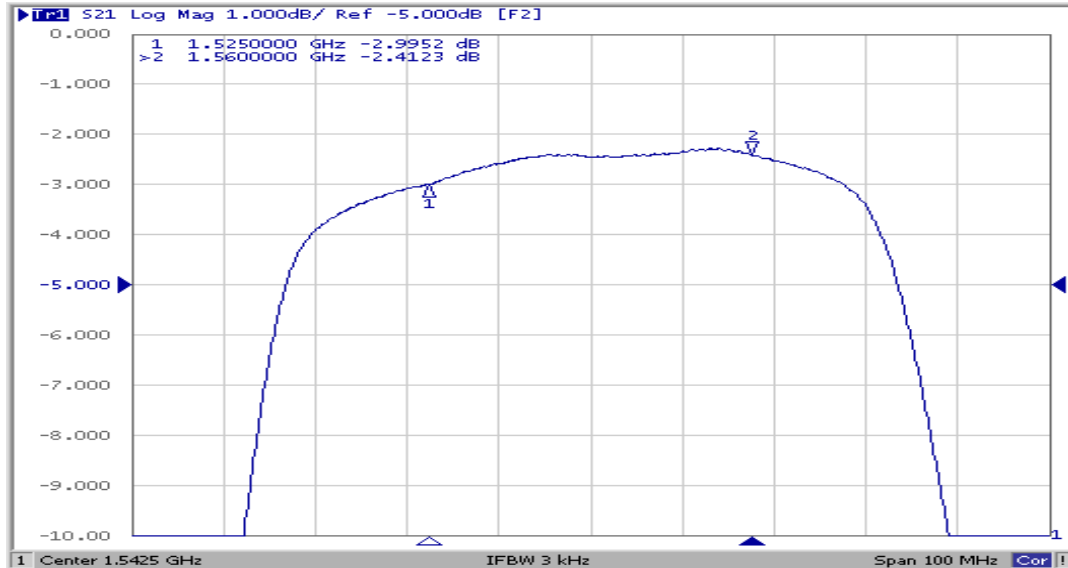

SAW Filter 1542.50MHz
Part No: MP10291

Model: TA1045C
Rev No: 1

Reflection Functions

S11

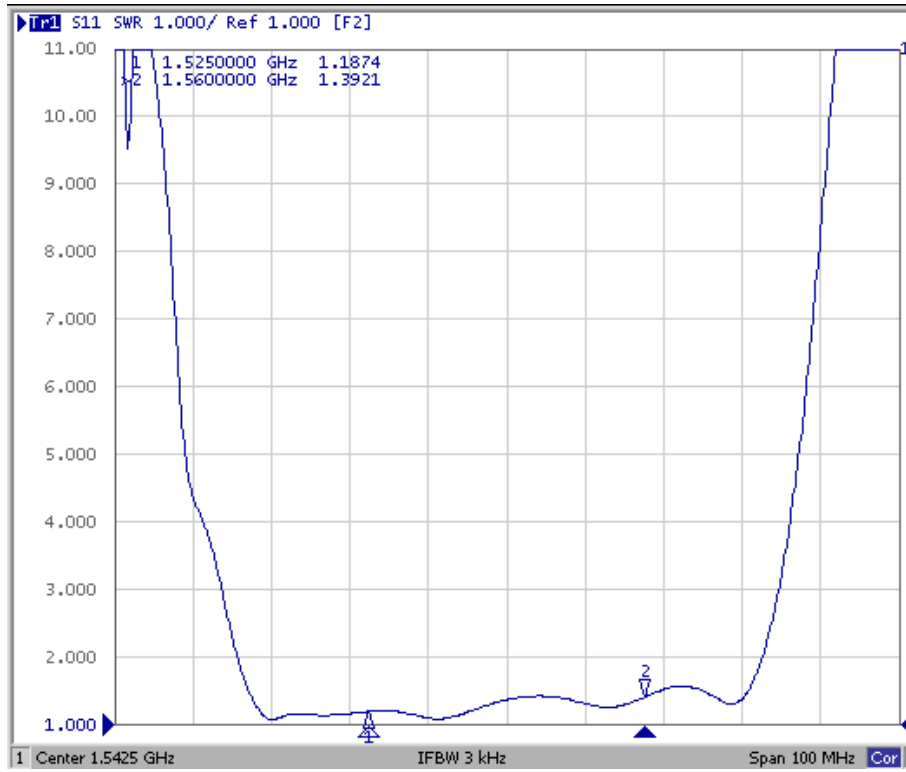

S22

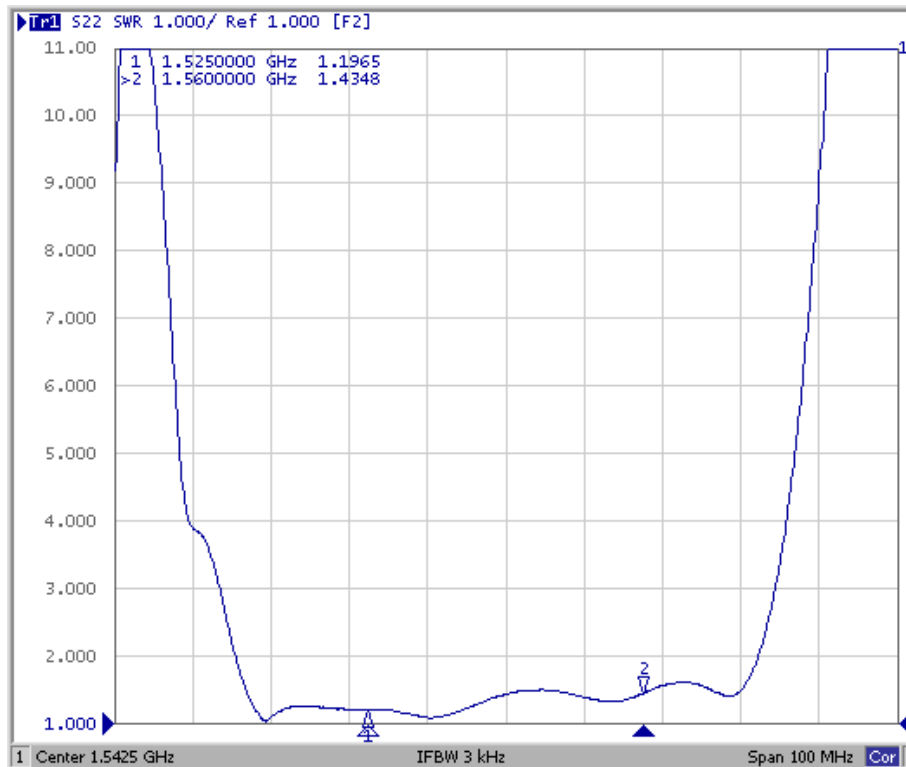

SAW Filter 1542.50MHz
Part No: MP10291

Model: TA1045C
Rev No: 1

G. PACKING:

1. Reel Dimension

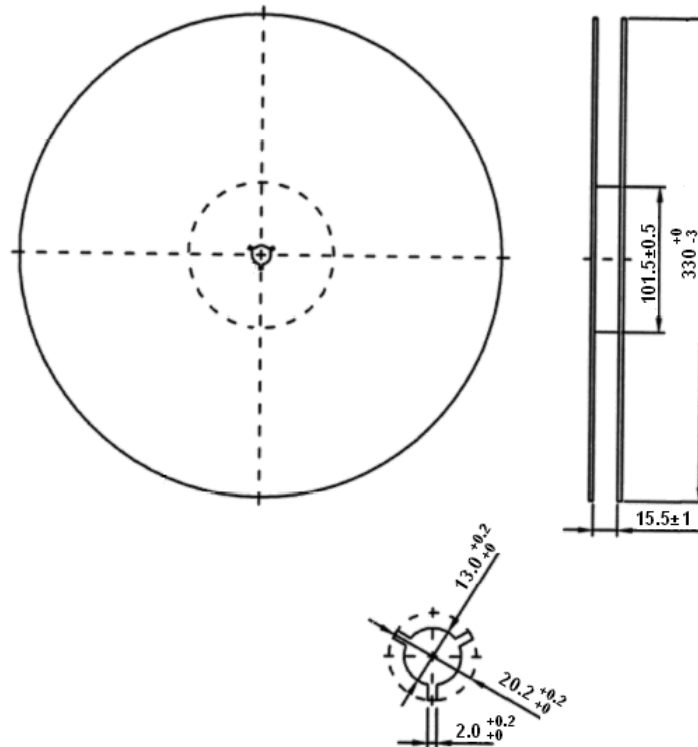

2. Tape Dimension

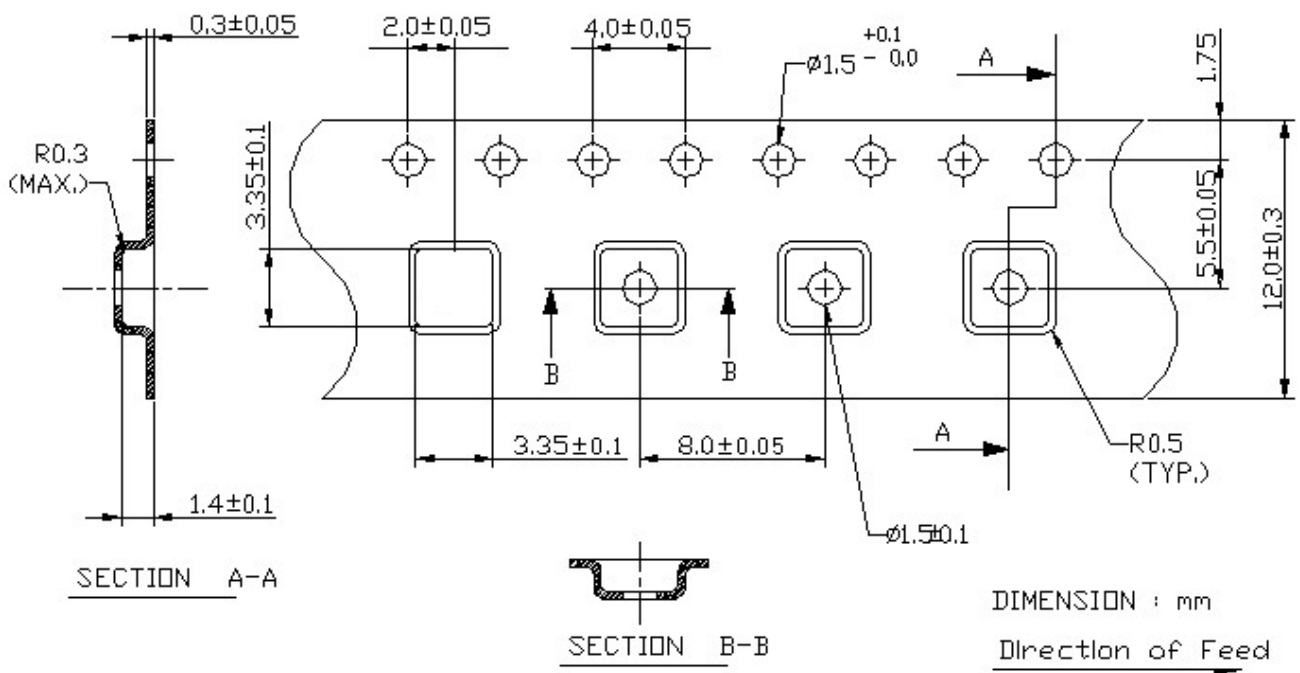

SAW Filter 1542.50MHz
Part No: MP10291

Model: TA1045C
Rev No: 1

H. RECOMMENDED REFLOW PROFILE:

1. Preheating shall be fixed at 150 ~ 180°C for 60 ~ 90 seconds.
2. Ascending time to preheating temperature 150°C shall be 30 seconds min.
3. Heating shall be fixed at 220°C for 50 ~ 80 seconds and at 245 ~ 260°C peak (min. 10 sec).
4. Time: 2 times.

