

SAW Filter 175.0MHz

Model: TB0927A

Part No: MP05337

Rev No: 1

A. MAXIMUM RATING:

1. Operating temperature range: -5°C to 70°C
2. Storage temperature range: -40°C to 85°C
3. Input Power Level : 10 dBm
4. Maximum DC Voltage : 10V

RoHS Compliant
Lead free
Lead-free soldering

Electrostatic Sensitive Device

B. CHARACTERISTICS:

Item	Unit	Min.	Type.	Max.
Center frequency, Fc	MHz	-	175	-
Insertion Loss, IL	dB	-	7.0	10.0
-2dB bandwidth	MHz	0.66	0.96	-
-3dB bandwidth	MHz	0.8	1.14	-
-5dB bandwidth	MHz	-	1.33	1.70
-17dB bandwidth	MHz	-	1.76	2.10
-30dB bandwidth	MHz	-	2.00	2.50
Passband Ripple Fc +/- 0.12MHz	dB	-	0.15	1.0
Group Delay variation Fc +/- 0.12MHz	nsec	-	189	260
Absolute Delay	unec	-	1.05	1.50
Ultimate Rejection	dB	50	54	-
Temperature Coefficient	ppm/°C ²	-	-0.036	-
Source Impedance	Ohm	-	50	-
Load Impedance	Ohm	-	50	-

SAW Filter 175.0MHz
Part No: MP05337

Model: TB0927A
Rev No: 1

C. FREQUENCY CHARACTERISTICS:

(1) Wide band Response:(span 100MHz)

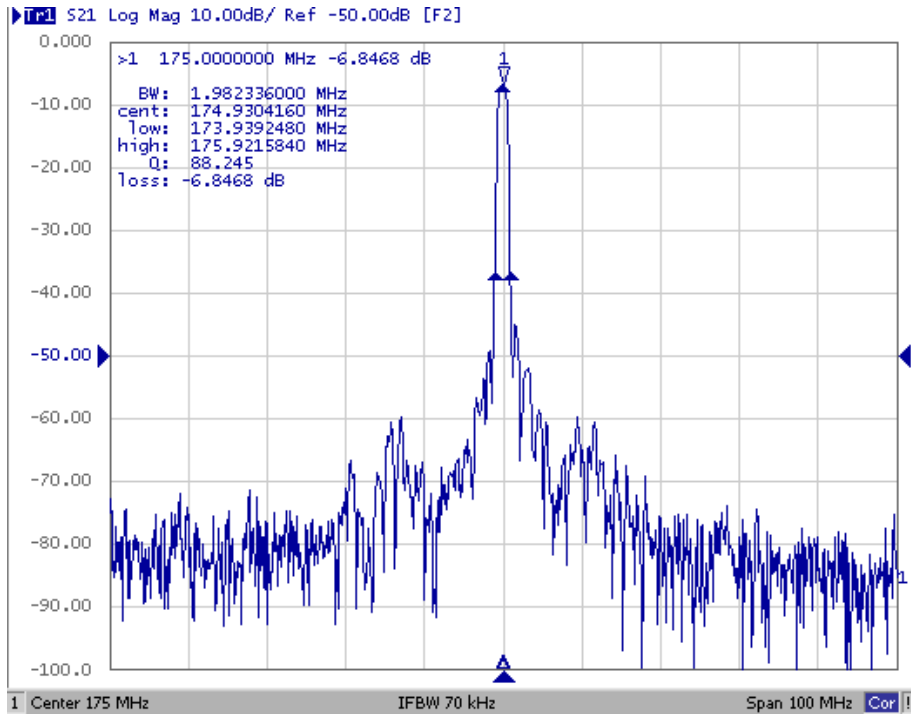

Fig1. Horizontal: 10MHz/Div Vertical: 10dB/Div

(2) Wide band Response:(span 50MHz)

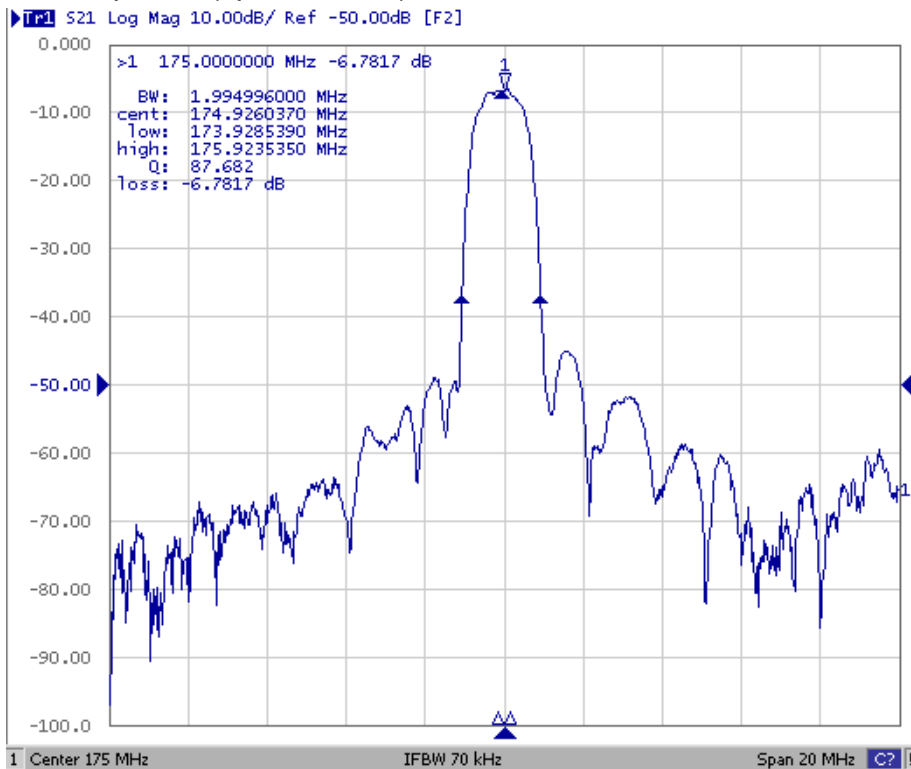

Fig2. Horizontal: 2MHz/Div Vertical: 10dB/Div

SAW Filter 175.0MHz
Part No: MP05337

Model: TB0927A
Rev No: 1

(3) Pass band Response and Group Time Delay response:

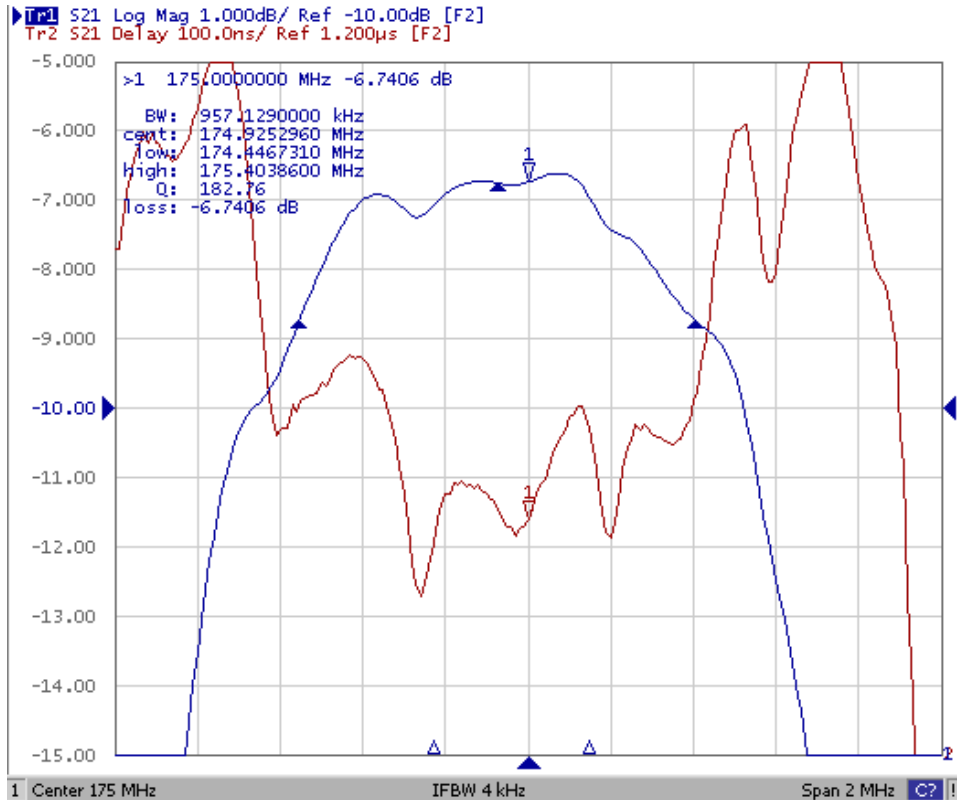
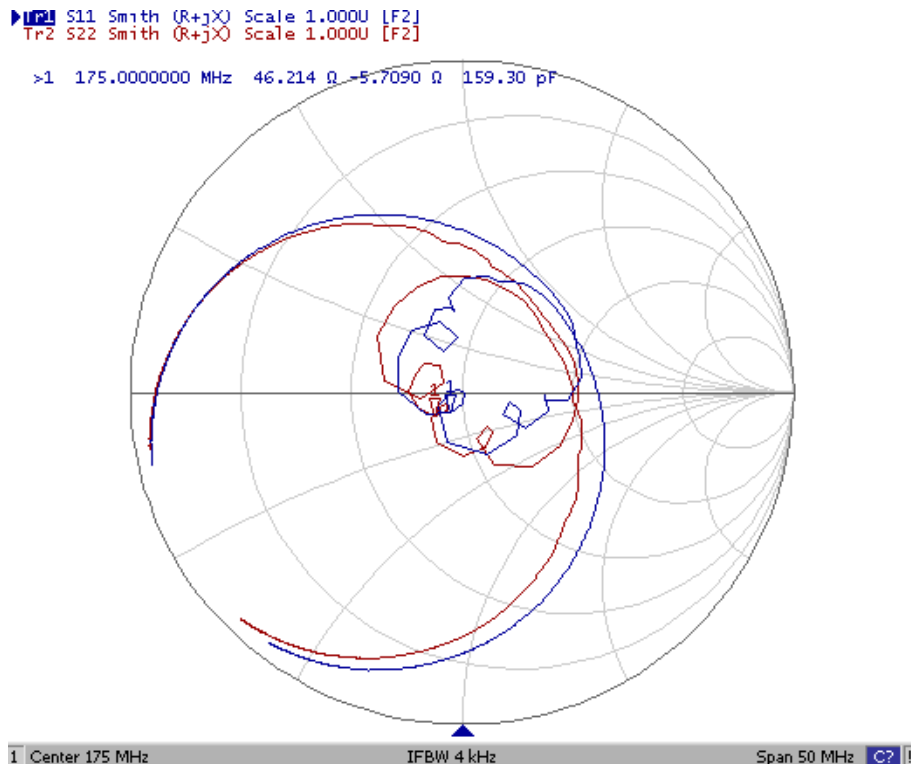

Fig2. Horizontal: 0.2MHz/Div Vertical: 1dB/Div. Vertical: 100ns/Div

(4) Smith Chart:



SAW Filter 175.0MHz
Part No: MP05337

Model: TB0927A
Rev No: 1

D. MATCHING CIRCUIT:

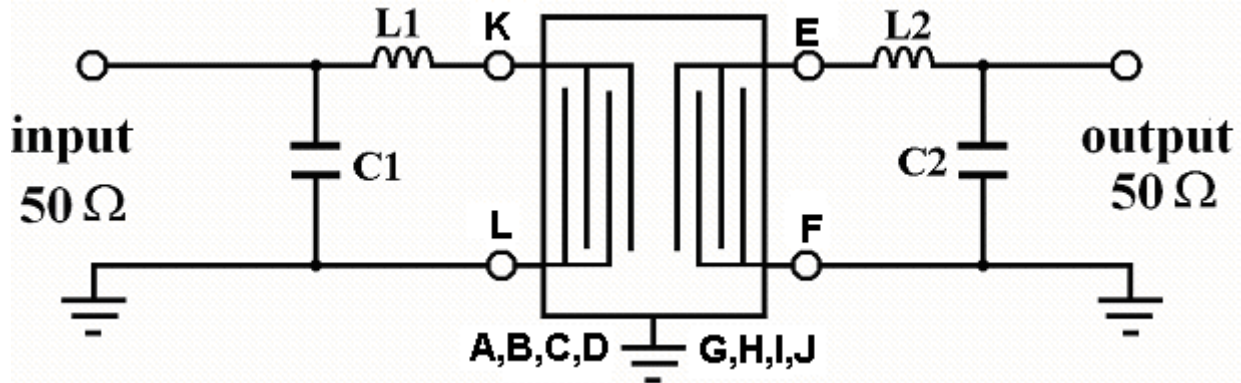

L1=92nH C1=36pF L2=85nH C2=47pF

E. OUTLINE DRAWING:

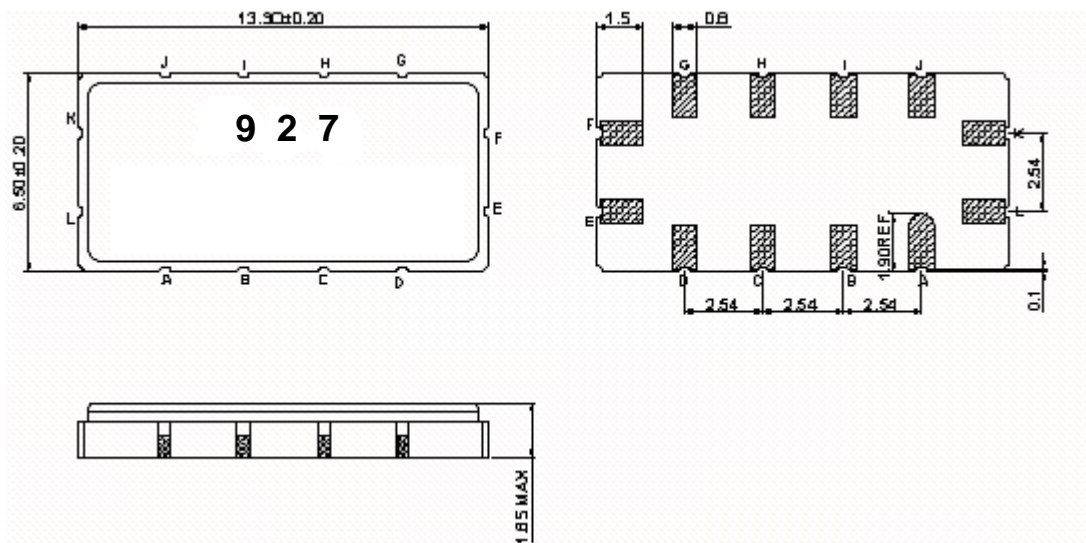

- #K : Input
- #L : Input Ground
- #E : Output
- #F : Output Ground
- #A,B,C,D,G,H,I,J : Ground

F. PCB FOOTPRINT:

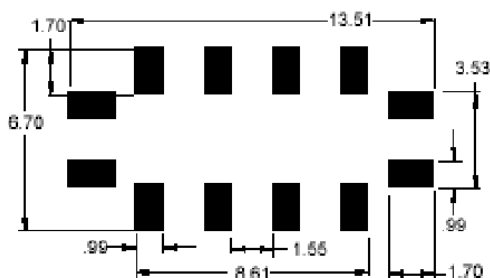

Unit: mm

SAW Filter 175.0MHz
Part No: MP05337

Model: TB0927A
Rev No: 1

G. PACKING:

1. REEL DIMENSION

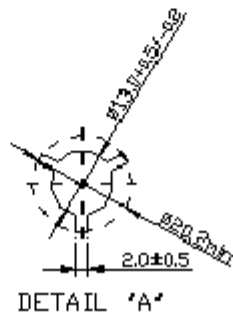
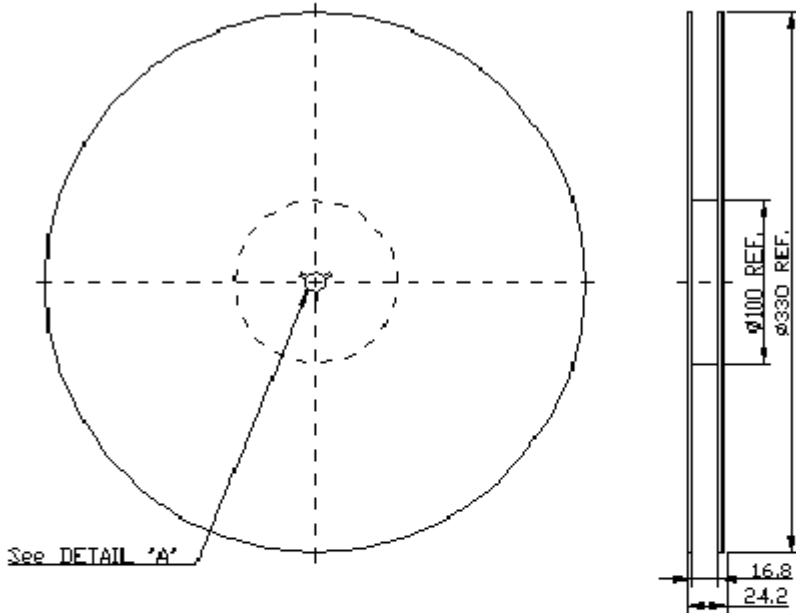

2. TAPE DIMENSION

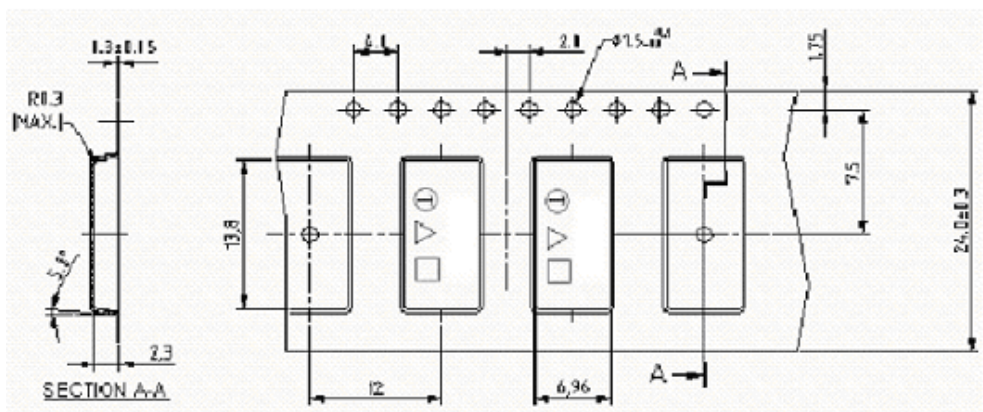

SAW Filter 175.0MHz
Part No: MP05337

Model: TB0927A
Rev No: 1

H. RECOMMENDED REFLOW PROFILE:

