

SAW Filter 70.0MHz
Part No: MP03410

Model: TB0856A
Rev No: 1

A. MAXIMUM RATING:

1. Operating temperature range: -40°C to 85°C
2. Storage temperature range: -40°C to 85°C
3. Input Power Level: 10dBm
4. Maximum DC Voltage: 10V

B. CHARACTERISTICS:

Item	Unit	Min.	Typ.	Max.
Center frequency Fc	MHz	-	70	-
Insertion Loss IL	dB	-	18.3	20.0
-1dB bandwidth	MHz	-	23.7	-
-3dB bandwidth	MHz	24.0	24.7	-
-35dB bandwidth	MHz	-	30.0	31.0
Passband Ripple Fc ± 8MHz	dB	-	0.6	1.0
Group Delay variation Fc ± 8MHz	nsec	-	23	60
Absolute Delay	unec	-	0.9	-
Temperature Coefficient	ppm/°C	-	-78	-
Source Impedance	Ω	-	50	-
Load Impedance	Ω	-	50	-

SAW Filter 70.0MHz
Part No: MP03410

Model: TB0856A
Rev No: 1

C. FREQUENCY CHARACTERISTICS:

1. Wide band Response (span 100MHz)

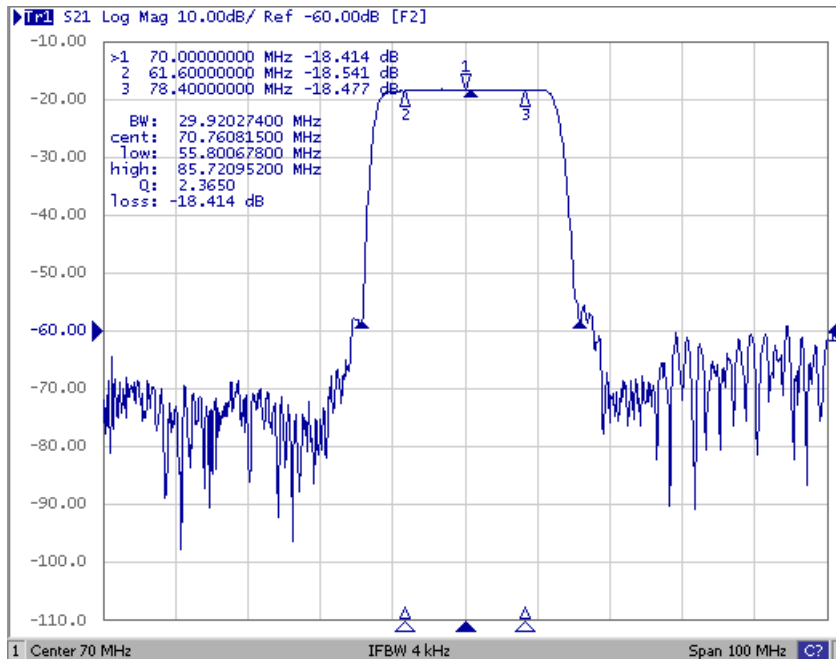

Fig. 1. Horizontal: 10MHz/Div, Vertical: 10dB/Div

2. Pass band Response and Group Time Delay response

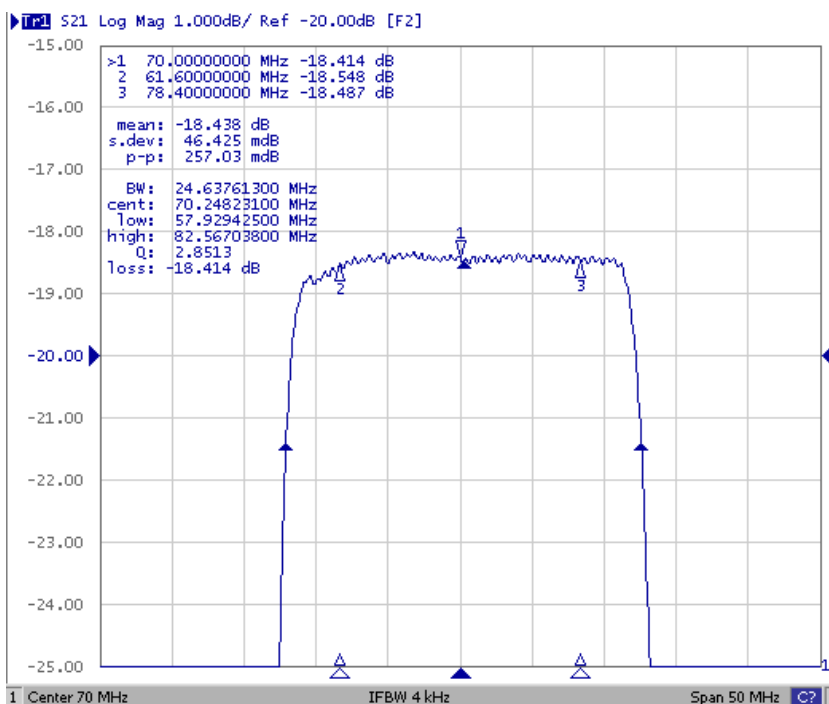

Fig. 2. Horizontal: 4MHz/Div, Vertical: 1dB/Div

SAW Filter 70.0MHz
Part No: MP03410

Model: TB0856A
Rev No: 1

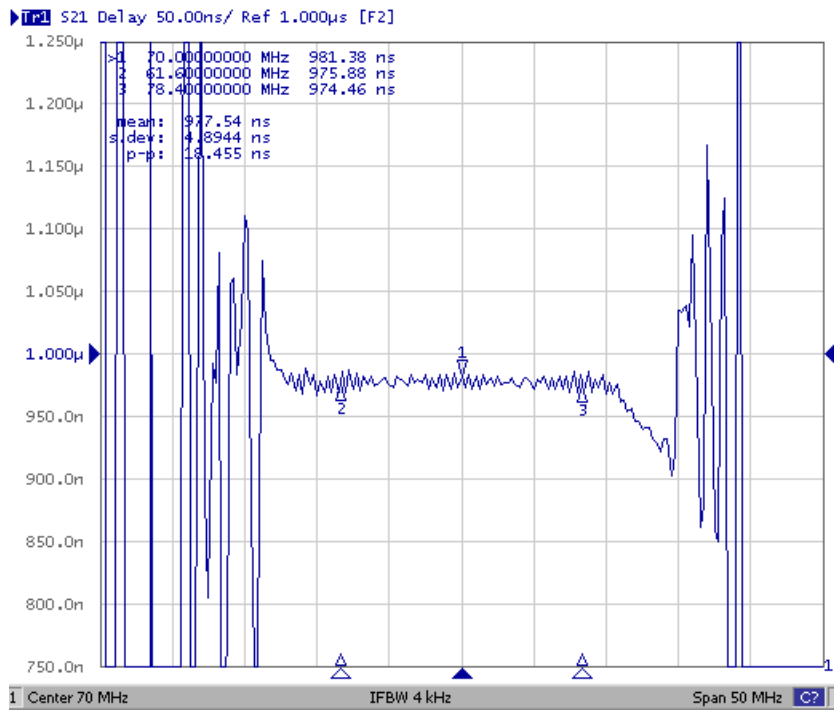
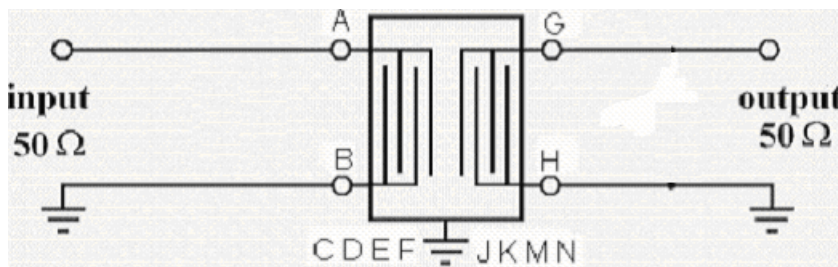
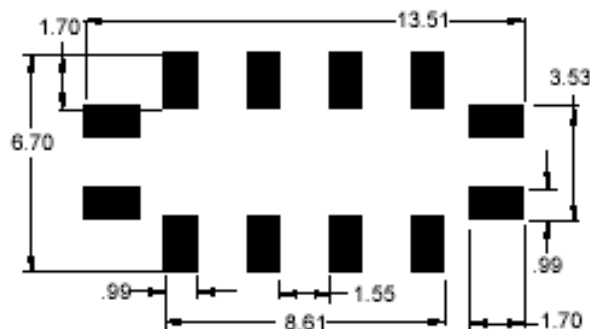

Fig. 3. Horizontal: 5MHz/Div, Vertical: 50ns/Div

D. MATCHING CIRCUIT:



E. PCB FOOTPRINT:



SAW Filter 70.0MHz
Part No: MP03410

Model: TB0856A
Rev No: 1

F. OUTLINE DRAWING:

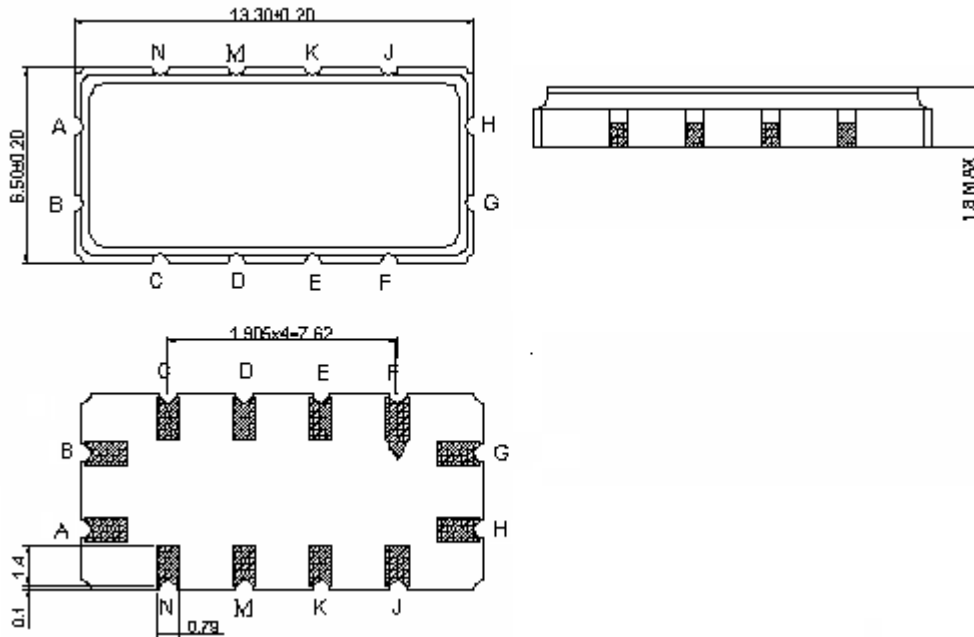

- A - RF input
 - B - RF input ground
 - G - RF output
 - H - RF output ground
 - C, D, E, F, J, K, M, N - Ground
- Unit: mm

SAW Filter 70.0MHz
Part No: MP03410

Model: TB0856A
Rev No: 1

G. PACKING:

1. REEL DIMENSION

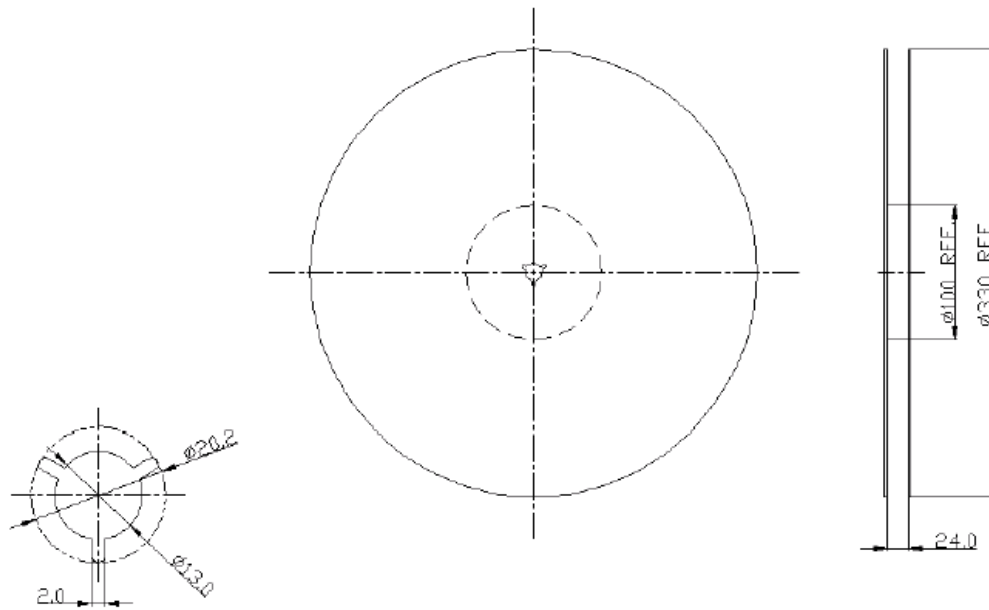

2. TAPE DIMENSION

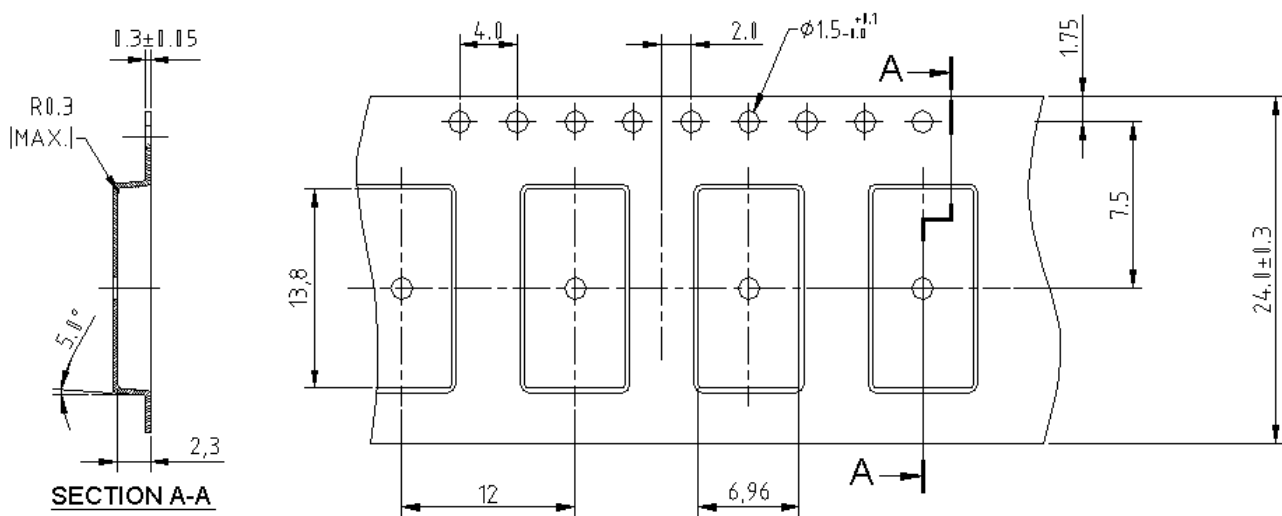

SAW Filter 70.0MHz
Part No: MP03410

Model: TB0856A
Rev No: 1

H. RECOMMENDED REFLOW PROFILE:

